

3. Ignition Switch

A: REMOVAL AND INSTALLATION

- 1) Disconnect ground cable from battery.
- 2) Remove instrument panel lower cover. <Ref. to 5-4 [W1A0].>
- 3) Remove screws, separate upper column cover and lower column cover.

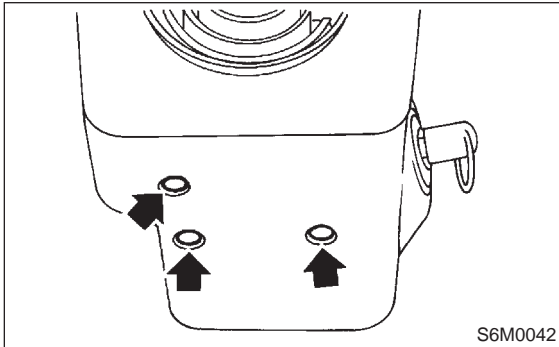

- 4) Remove knee protector.
- 5) Remove meter visor.
- 6) Disconnect ignition switch connector from body harness.
- 7) Using a drift and hammer, hit the torn bolt head to loosen and remove the ignition switch.

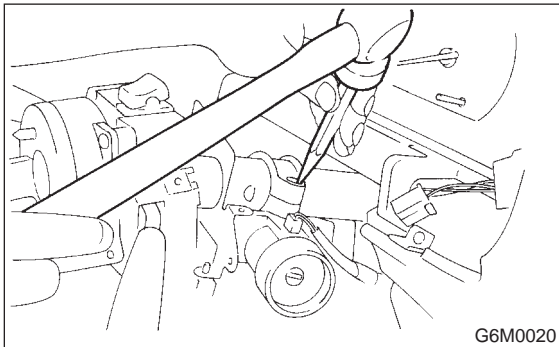

- 8) Install in the reverse order of removal.

NOTE:

When installing, tighten the connecting bolt (A) until its head twists off.

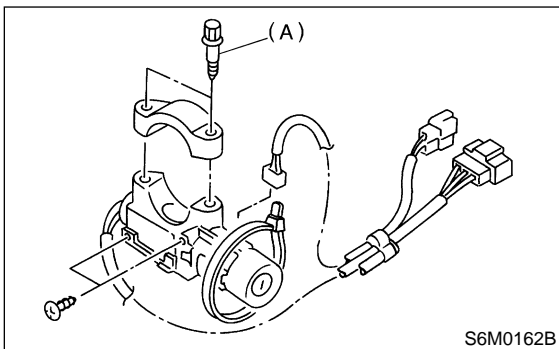

4. Lighting

A: ADJUSTMENT

1. HEADLIGHT AIMING

NOTE:

As this headlight is the "VISUAL AIMING TYPE", it is possible to adjust aiming only in the vertical direction. It cannot be adjusted in the horizontal direction.

CAUTION:

Turn off the light before adjusting headlight aiming. If the light is necessary to check aiming, do not turn on for more than two minutes.

NOTE:

Before checking the headlight aiming, be sure of the following:

- The area around the headlight has not sustained any accident, damage or other type of deformation.
- Vehicle is parked on level ground.
- The inflation pressure of tires is correct.
- Vehicle's gas tank is fully charged.
- Bounce the vehicle several times to normalize the suspension.
- Make certain that someone is seated in the driver's seat.

- 1) Place a cloth over the headlight that does not require aiming adjustment.

4. Lighting

2) Turn the headlights on. Perform the aiming adjustment for the other headlight as follows:

CAUTION:

Do not perform lateral headlight aiming adjustment.

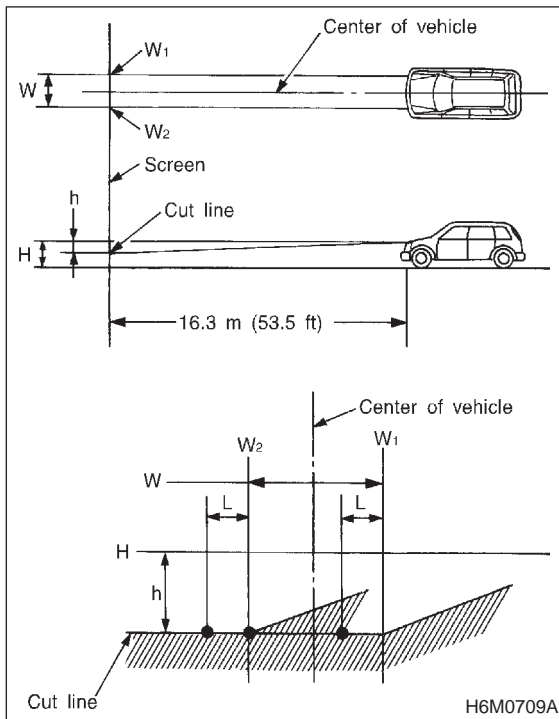

W	H	L	h
1,060 mm (41.73 in)	710 mm (27.95 in)	712 mm (28.03 in)	114 mm (4.49 in)

B: REMOVAL AND INSTALLATION**1. HEADLIGHT AND SIDE MARKER LIGHT**

- 1) Disconnect ground cable from battery.
- 2) Remove front grille <Ref. to 5-1 [W12A0].> and disconnect connector from headlight.
- 3) Remove screw (A) then remove side marker light while disconnecting connector.
- 4) Remove extension (B) <Ref. to 5-1 [W3A0].>
- 5) Remove bolts (C) which secure headlight and remove headlight.

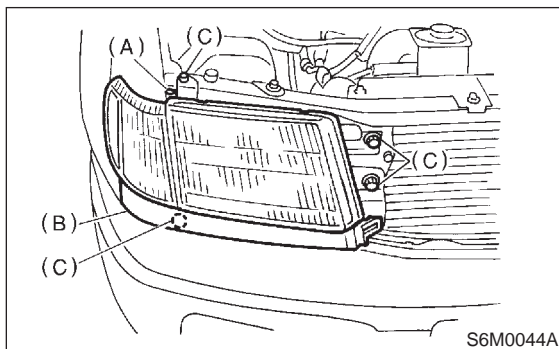

- 6) Install in the reverse order of removal.

Tightening torque:

$6.4 \pm 0.5 \text{ N}\cdot\text{m}$ ($0.65 \pm 0.05 \text{ kg}\cdot\text{m}$, $4.7 \pm 0.4 \text{ ft}\cdot\text{lb}$)

NOTE:

When installing, securely fit clip (on fender side) into locating (on front turn signal light side).

2. REAR COMBINATION LIGHT

- 1) Disconnect ground cable from battery.
- 2) Remove rear quarter upper and lower trim.
- 3) Remove nuts and disconnect connector.

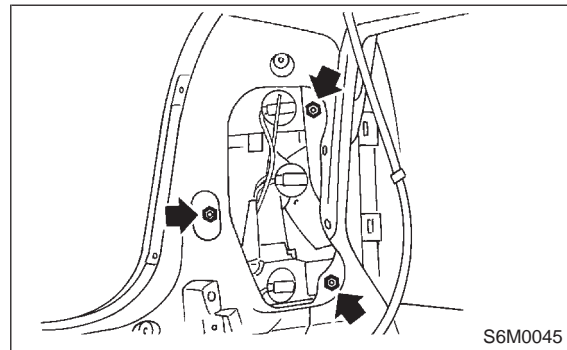

- 4) Attach adhesive cloth tape to body area around rear combination light.
- 5) Using a standard screwdriver, carefully pry rear combination light off and away from the front of the vehicle.
- 6) Install in the reverse order of removal.

Tightening torque:

$6.4 \pm 0.5 \text{ N}\cdot\text{m}$ ($0.65 \pm 0.05 \text{ kg}\cdot\text{m}$, $4.7 \pm 0.4 \text{ ft}\cdot\text{lb}$)

CAUTION:

- Do not pry on the rear combination light forcefully as this may scratch the vehicle body.
- Remove all traces of adhesive tape from body before installation.
- Attach butyl rubber tape to back of rear combination light before installing rear combination light on body for sealing purposes.

3. REAR FINISHER LIGHT

- 1) Disconnect ground cable from battery.
- 2) Remove rear gate trim access hole cover.
- 3) Remove the four nuts.

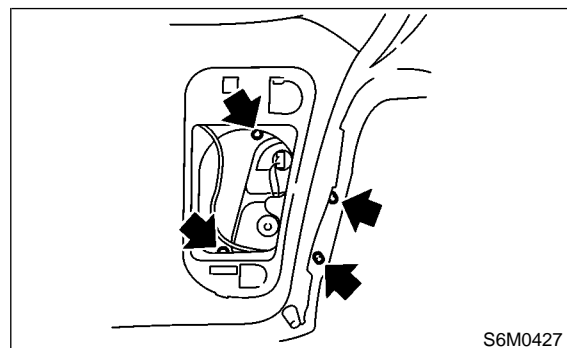

- 4) Detach rear finisher light while disconnecting connector.

5) Install in the reverse order of removal.

4. HIGH-MOUNTED STOP LIGHT

- 1) Disconnect ground cable from battery.
- 2) Remove cap (A) by prying on the edge with a screwdriver.
- 3) Remove screws (B) and then detach cover (C).
- 4) Remove screws (D) and then detach high-mounted stop light while disconnecting connector.

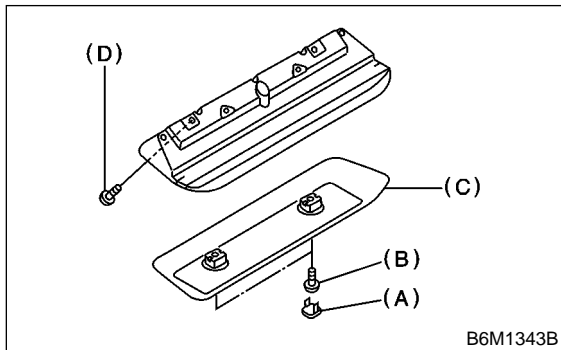

5) Install in the reverse order of removal.

5. COMBINATION SWITCH

- 1) Disconnect ground cable from battery.
- 2) Remove instrument panel lower cover. <Ref. to 5-4 [W1A0].>
- 3) Remove screws which secure upper column cover to lower column cover.

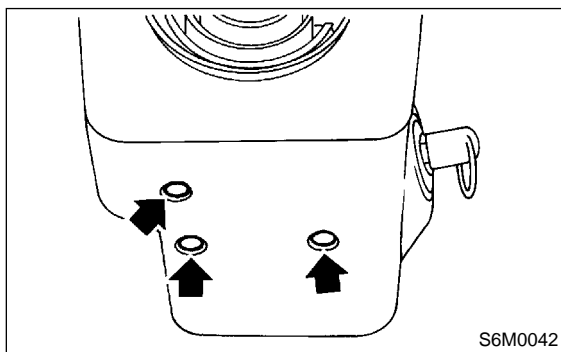

- 4) Disconnect connector from combination switch.
- 5) Remove screws which secure switch and remove switch.

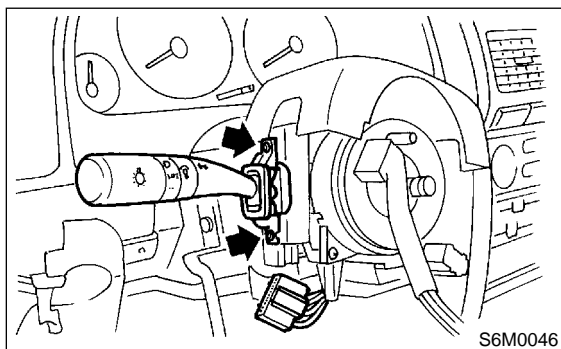

6) Install in the reverse order of removal.

C: INSPECTION

1. COMBINATION SWITCH (LIGHTING)

Move combination switch to respective positions and check continuity between terminals.

• LIGHTING SWITCH

Terminal	16	14	13
Switch position			
OFF			
Tail	○	○	
Head	○	○	○

• PARKING SWITCH

Terminal	19	21	18
Switch position			
OFF	○	○	
ON		○	○

• DIMMER AND PASSING SWITCH

Terminal	16	17	7	8
Switch position				
Flash	○		○	○
Low beam	○	○		
HI-beam	○		○	

H6M0500B

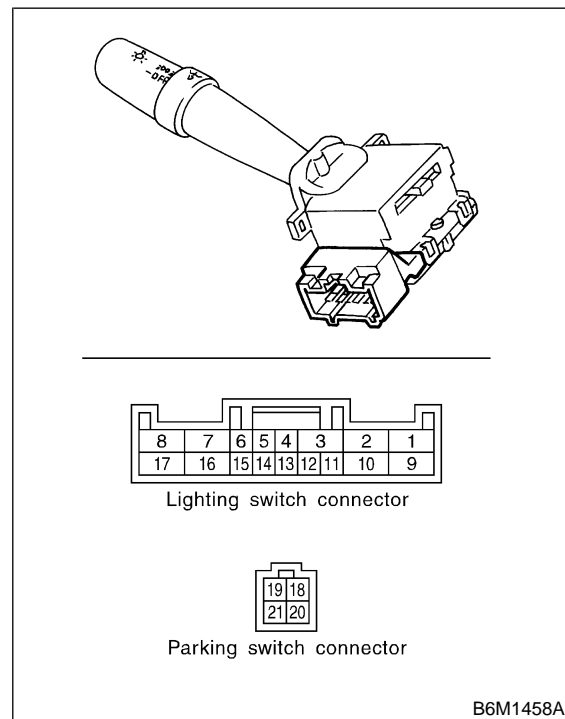

2. HEADLIGHT RELAY

Check continuity between terminals when terminal No. 4 is connected to battery and terminal No. 3 is grounded.

When current flows	Between terminals No. 1 and No. 2	Continuity exists.
When current does not flow	Between terminals No. 1 and No. 2	Continuity does not exist.
	Between terminals No. 3 and No. 4	Continuity exists.

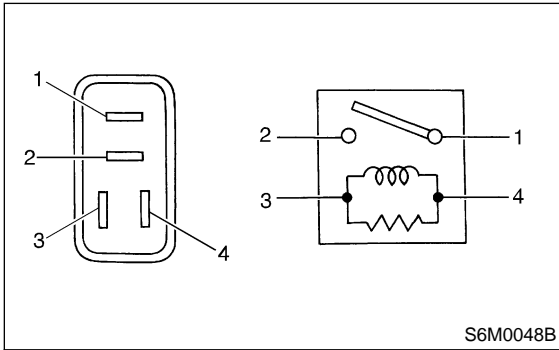

3. TAIL AND ILLUMINATION RELAY

Check continuity between terminals (indicated in table below) when terminal No. 4 is connected to battery and terminal No. 3 is grounded.

When current flows	Between terminals No. 1 and No. 2	Continuity exists.
When current does not flow	Between terminals No. 1 and No. 2	Continuity does not exist.
	Between terminals No. 3 and No. 4	Continuity exists.

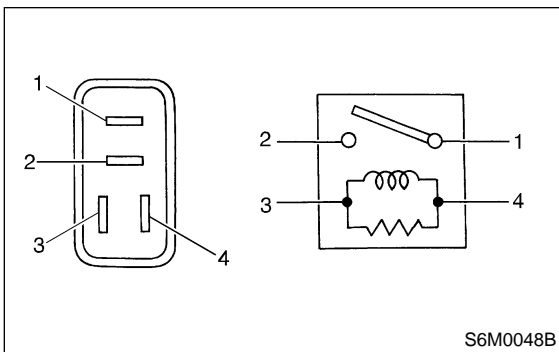

5. Front Wiper and Washer

A: ADJUSTMENT

- 1) Turn the wiper switch to OFF position.
- 2) Adjust so that the blades meet the ceramic print point mark (A).

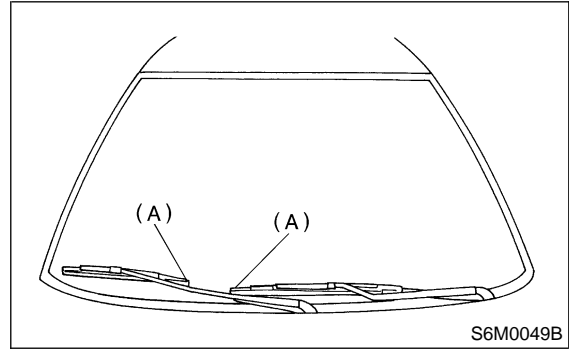

- 3) Adjust washer ejecting area on windshield glass as shown in the figure when vehicle stops.

Ejecting area:

- A: 350 mm (13.78 in)**
- B: 100 mm (3.94 in)**
- C: 60 mm (2.36 in)**

