

8) Installation is in the reverse order of removal.

Do the following:

- (1) Install fuel sub level sensor.

**Tightening torque:**

**T:  $4.4 \pm 1.5$  N·m ( $0.45 \pm 0.15$  kg·m,  $3.3 \pm 1.1$  ft·lb)**

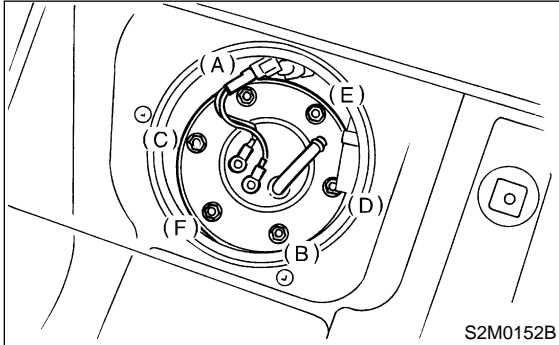

- (2) Connect connector to fuel pump relay.

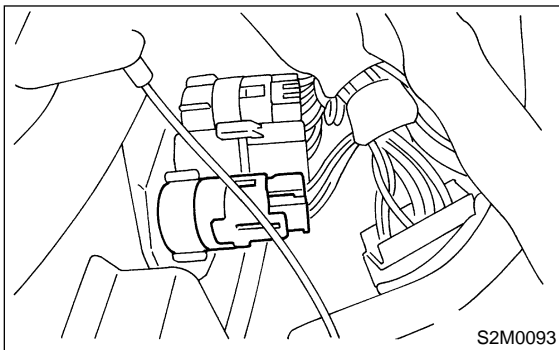

## 11. Vent Valve

### A: REMOVAL AND INSTALLATION

- 1) Remove fuel tank. <Ref. to 2-8 [W2A0].>

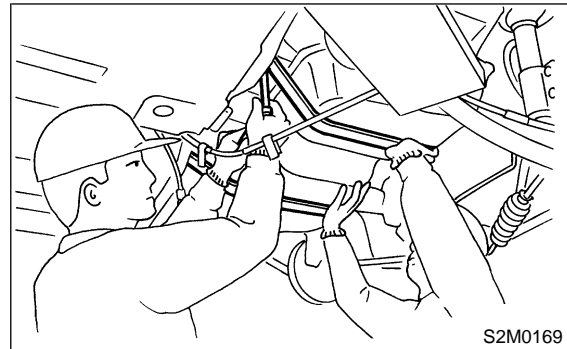

- 2) Remove protector cover.

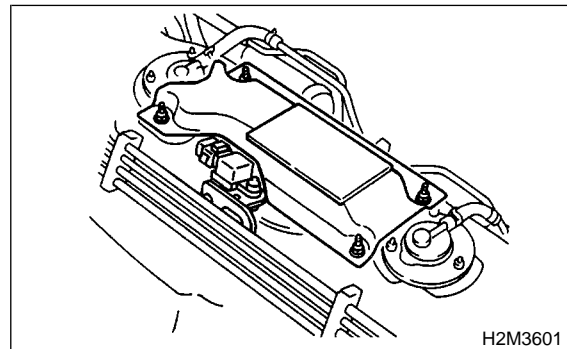

- 3) Move clips, and disconnect hoses from vent valve.

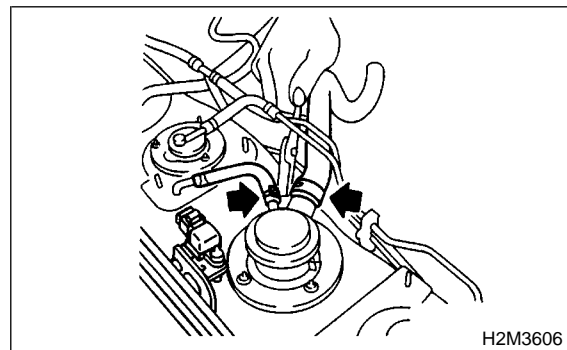

- 4) Remove nuts which install vent valve on fuel tank.

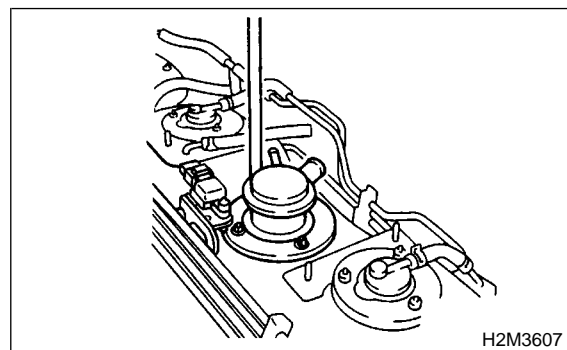

5) Installation is in the reverse order of removal.

**CAUTION:**

Replace rubber seat with a new one.

**Tightening torque:**

**T:  $4.4 \pm 1.5$  N·m ( $0.45 \pm 0.15$  kg·m,  $3.3 \pm 1.1$  ft·lb)**

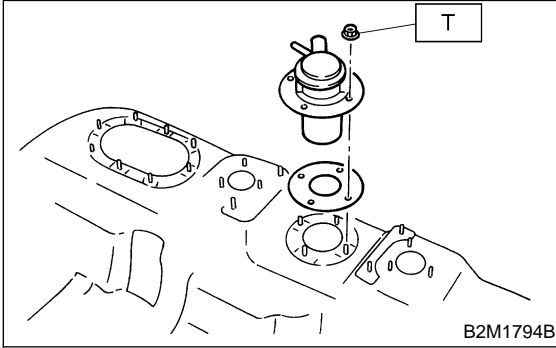

## 12. Shut Valve

### A: REMOVAL AND INSTALLATION

1) Disconnect battery ground cable.

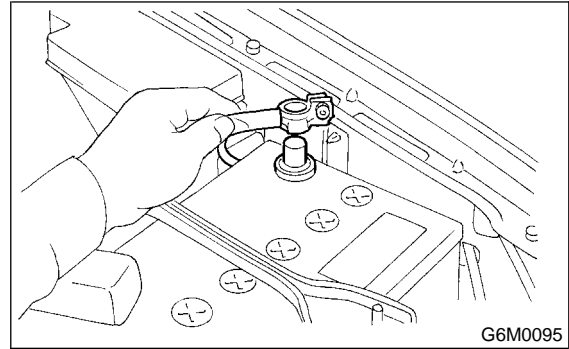

2) Drain fuel from fuel tank. <Ref. to 2-8 [W1C0].>

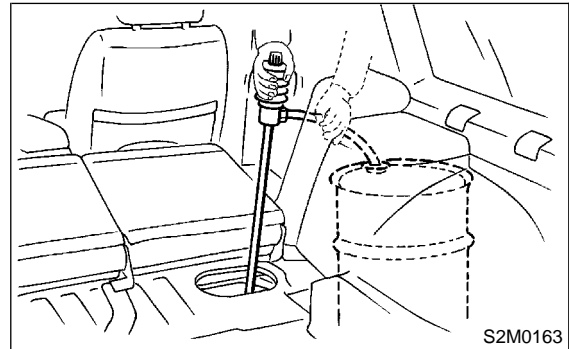

3) Remove fuel filler pipe. <Ref. to 2-8 [W3A1].>

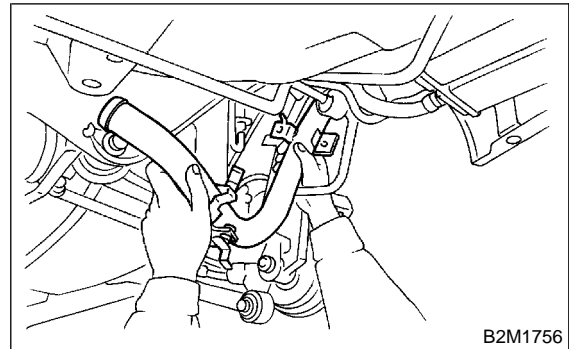

4) Disconnect evaporation hoses from shut valve.

