

5) Installation is in the reverse order of removal.

CAUTION:

Replace rubber seat with a new one.

Tightening torque:

T: 4.4 ± 1.5 N·m (0.45 ± 0.15 kg·m, 3.3 ± 1.1 ft·lb)

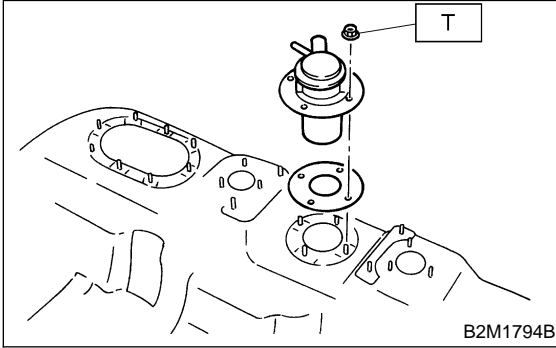

12. Shut Valve

A: REMOVAL AND INSTALLATION

1) Disconnect battery ground cable.

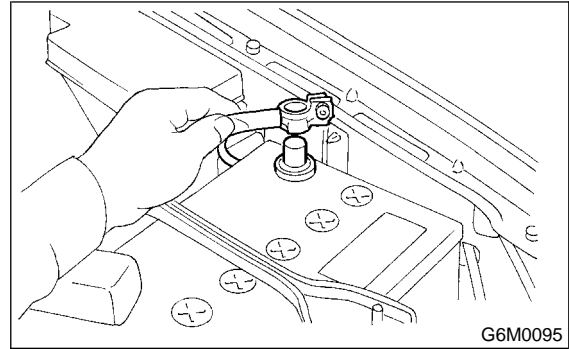

2) Drain fuel from fuel tank. <Ref. to 2-8 [W1C0].>

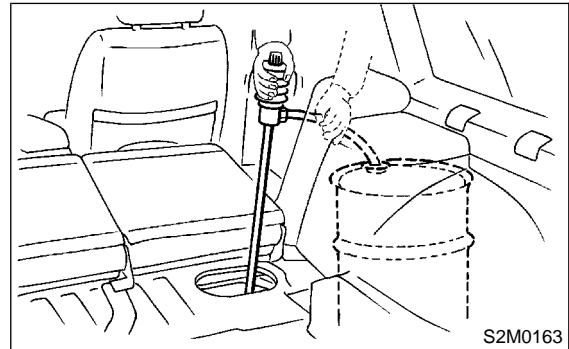

3) Remove fuel filler pipe. <Ref. to 2-8 [W3A1].>

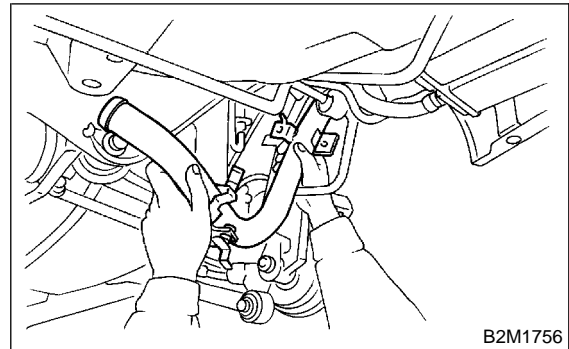

4) Disconnect evaporation hoses from shut valve.

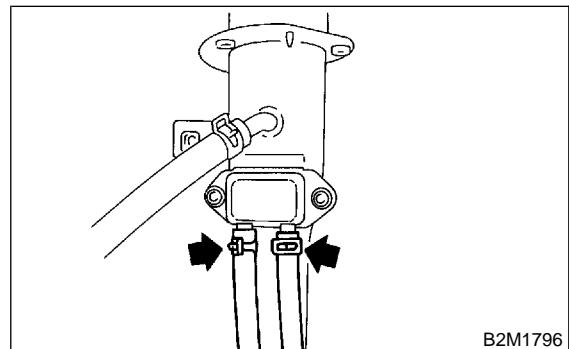

5) Remove shut valve from fuel filler pipe.

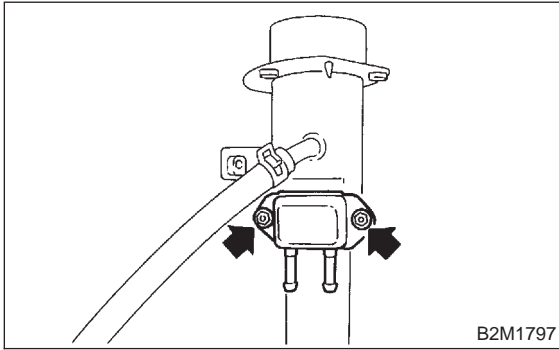

6) Install in the reverse order of removal.

Tightening torque:

$4.4 \pm 1.5 \text{ N}\cdot\text{m}$ ($0.45 \pm 0.15 \text{ kg}\cdot\text{m}$, $3.3 \pm 1.1 \text{ ft}\cdot\text{lb}$)

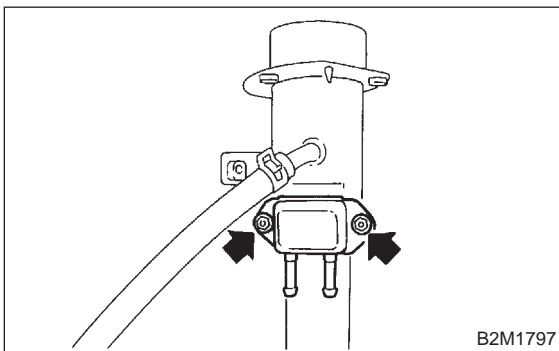

13. Drain Valve

A: REMOVAL AND INSTALLATION

1) Disconnect battery ground cable.

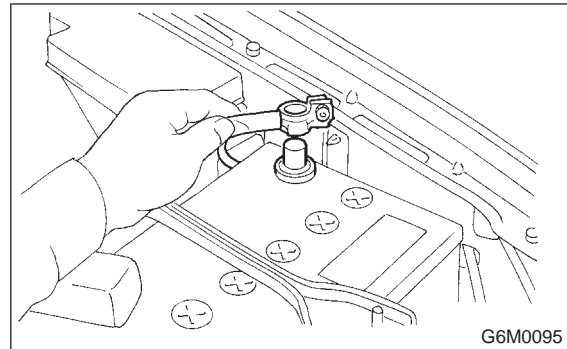

2) Lift-up the vehicle.

3) Remove canister. <Ref. to 2-1 [W3A0].>

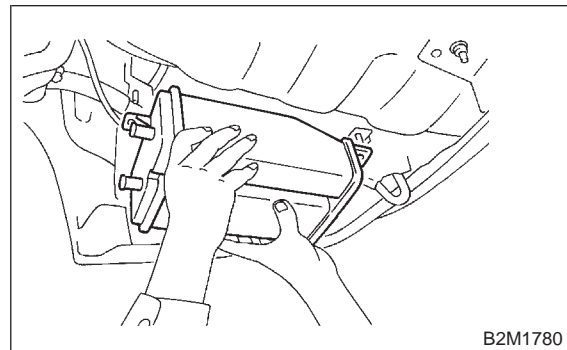

4) Disconnect connector from drain valve.

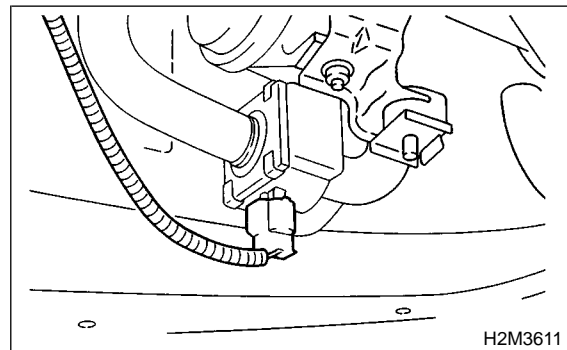

5) Disconnect evaporation hoses from drain valve.

