

14. Intake Unit with Evaporator

A: REMOVAL AND INSTALLATION

- 1) Disconnect battery negative terminal.
- 2) Discharge refrigerant using refrigerant recovery system. <Ref. to 4-7 [W600].>
- 3) Remove bolt then disconnect discharge pipe and suction pipe.

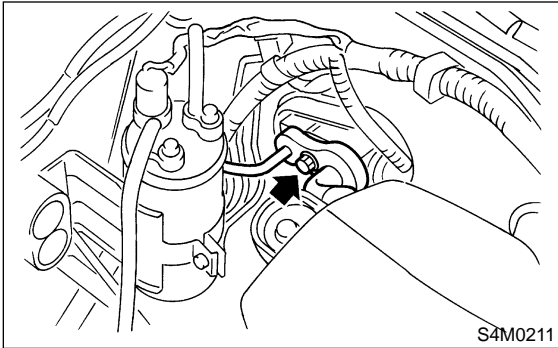

- 4) Remove glove box.

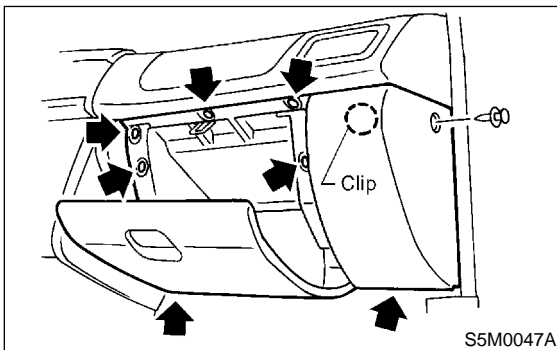

- 5) Disconnect the harness connector from intake unit.
- 6) Disconnect drain hose.
- 7) Remove intake unit mounting bolt and nut.

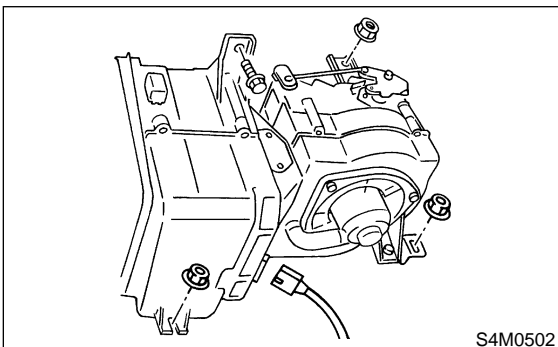

- 8) Install the intake unit in the reverse order of removal.
- 9) Charge refrigerant. <Ref. to 4-7 [W700].>

B: DISASSEMBLY AND ASSEMBLY

- 1) Remove thermistor (A) from intake unit case.
- 2) Remove some screws then separate intake unit case.
- 3) Remove thermistor from clip with the evaporator.

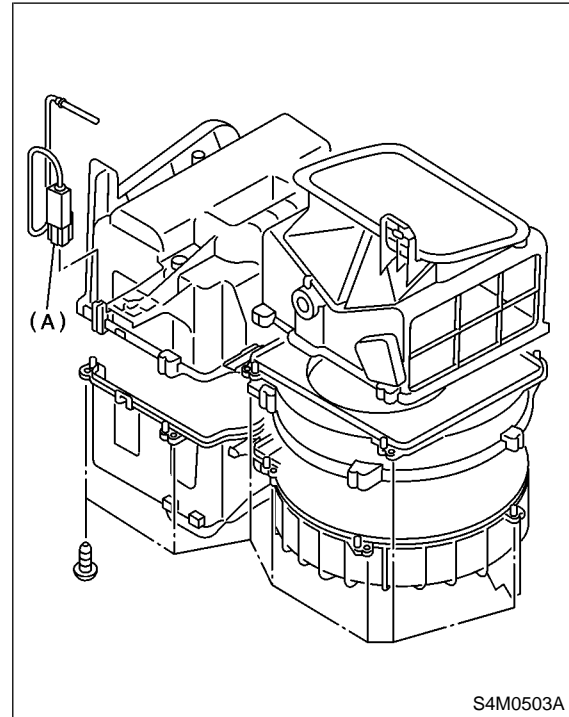

- 4) Remove the block expansion valve (A) from pipes.

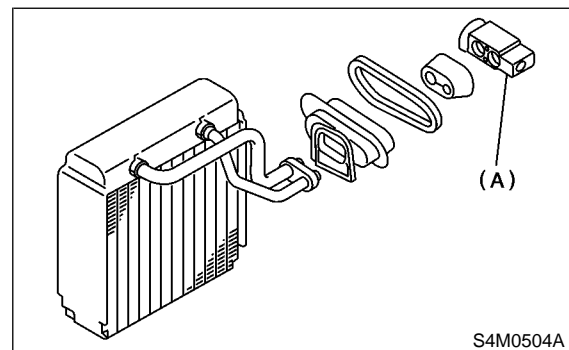

- 5) Check to see if the evaporator fins are clogged. If they are, clean them with compressed air.

CAUTION:
Water must never be used to clean the evaporator.

- 6) Check parts that have been removed for cracks or scratches, and repair or replace them with new ones, if necessary.
- 7) Reassemble the intake unit in the reverse order of disassembly.

NOTE:

Confirm that the O-ring is inserted in the specified position.

15. Condenser Fan Assembly

A: REMOVAL AND INSTALLATION

- 1) Disconnect battery negative terminal.
- 2) Disconnect harness connector from fan motor.
- 3) Remove condenser fan bolt from radiator.

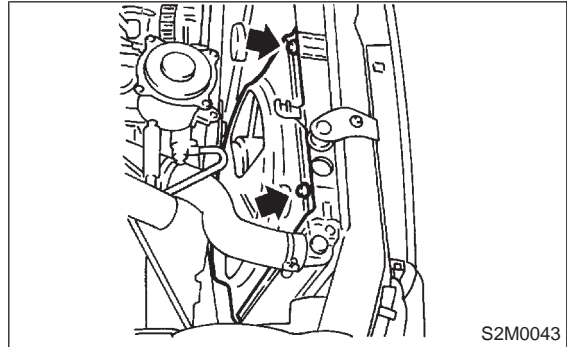

- 4) Pull condenser fan assembly.
- 5) Install the condenser fan assembly in the reverse order of removal.