

2. Power Steering System

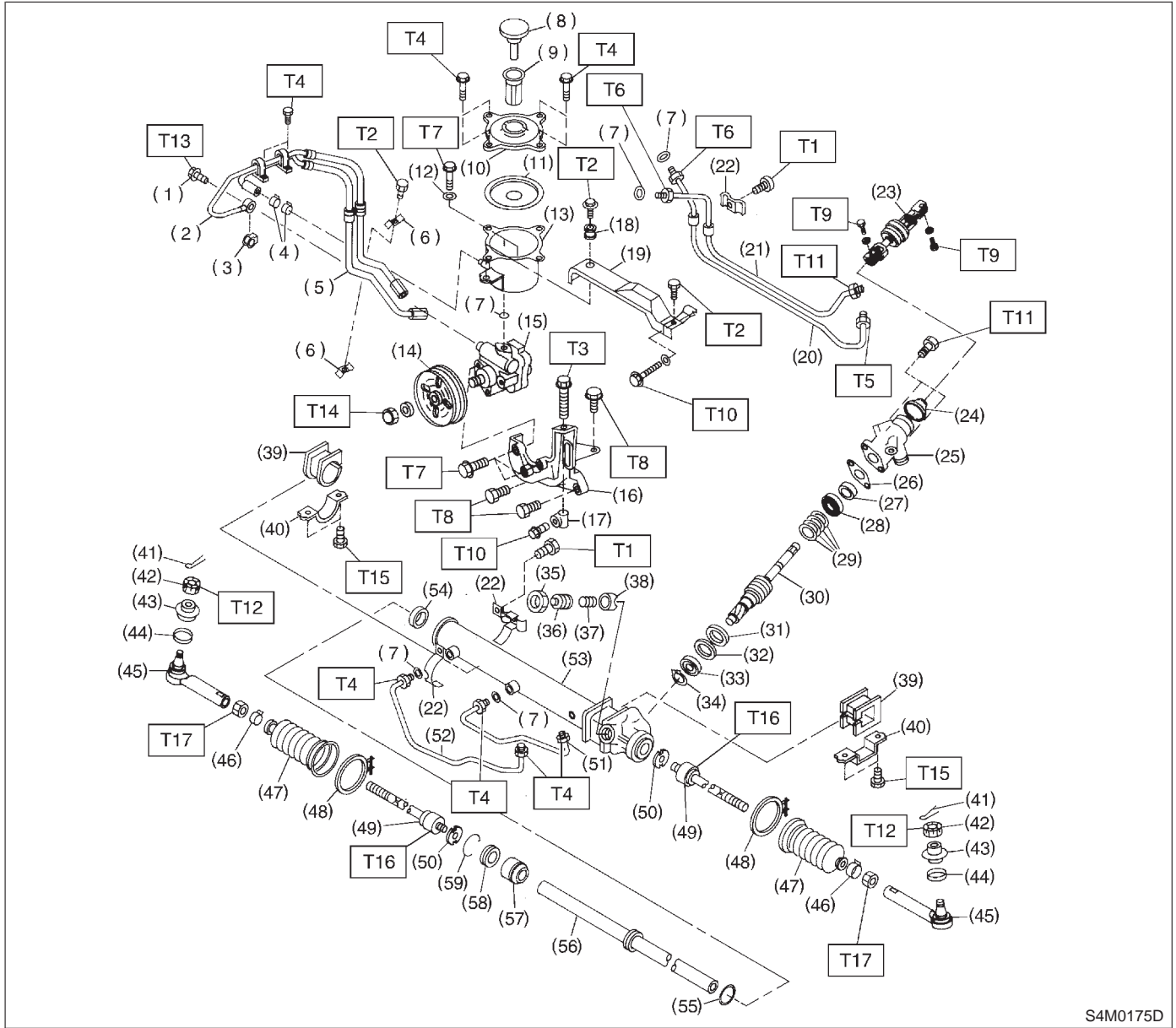

S4M0175D

(1) Eye bolt	(28) Special bearing	(55) Piston ring
(2) Pipe C	(29) Seal ring	(56) Rack
(3) Gasket	(30) Pinion and valve ASSY	(57) Rack bushing
(4) Clip	(31) Oil seal	(58) Rack stopper
(5) Pipe D	(32) Back-up washer	(59) Circlip
(6) Clamp E	(33) Ball bearing	
(7) O-ring	(34) Snap ring	
(8) Cap	(35) Lock nut	
(9) Strainer	(36) Adjusting screw	
(10) Upper shell	(37) Spring	
(11) Baffle	(38) Sleeve	
(12) Seal washer	(39) Adapter	
(13) Lower shell	(40) Clamp	
(14) Pulley	(41) Cotter pin	
(15) Oil pump	(42) Castle nut	
(16) Bracket	(43) Dust seal	
(17) Belt tension nut	(44) Clip	
(18) Bush	(45) Tie-rod end	
(19) Belt cover	(46) Clip	
(20) Pipe E	(47) Boot	
(21) Pipe F	(48) Band	
(22) Clamp plate	(49) Tie-rod	
(23) Universal joint	(50) Lock washer	
(24) Dust cover	(51) Pipe B	
(25) Valve housing	(52) Pipe A	
(26) Gasket	(53) Housing ASSY	
(27) Oil seal	(54) Oil seal	

Tightening torque: N-m (kg-m, ft-lb)

T1: 6±1 (0.6±0.1, 4.3±0.7)

T2: 7.4±2.0 (0.75±0.20, 5.4±1.4)

T3: 8±2 (0.8±0.2, 5.8±1.4)

T4: 13±3 (1.3±0.3, 9.4±2.2)

T5: 15±3 (1.5±0.3, 10.8±2.2)

T6: 15±5 (1.5±0.5, 10.8±3.6)

T7: 18⁺⁵/₀ (1.8^{+0.5}/₀, 13.0^{+3.6}/₀)

T8: 22±2 (2.2±0.2, 15.9±1.4)

T9: 24±3 (2.4±0.3, 17.4±2.2)

T10: 25±2 (2.5±0.2, 18.1±1.4)

T11: 25±5 (2.5±0.5, 18.1±3.6)

T12: 27.0±2.5 (2.75±0.25, 19.9±1.8)

T13: 39±5 (4.0±0.5, 28.9±3.6)

T14: 52±10 (5.3±1.0, 38±7)

T15: 59±12 (6.0±1.2, 43±9)

T16: 78±10 (8.0±1.0, 58±7)

T17: 83±5 (8.5±0.5, 61.5±3.6)
