

10. Rear Crossmember

A: REMOVAL

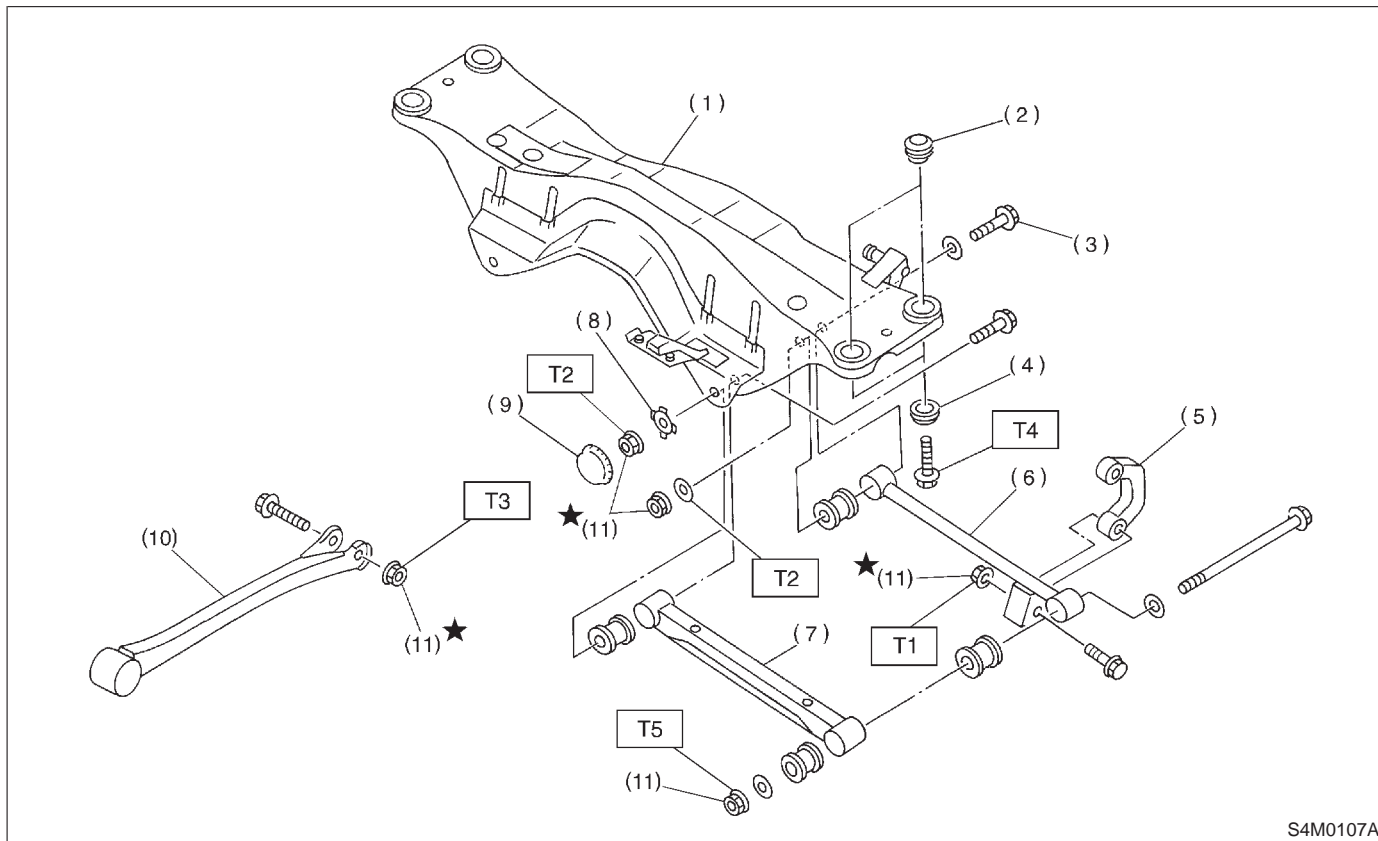

S4M0107A

- | | |
|------------------------|-----------------------|
| (1) Crossmember | (8) Washer |
| (2) Floating bushing | (9) Cap (Protection) |
| (3) Adjusting bolt | (10) Trailing link |
| (4) Stopper | (11) Self-locking nut |
| (5) Stabilizer link | |
| (6) Rear lateral link | |
| (7) Front lateral link | |

Tightening torque: N·m (kg·m, ft·lb)**T1: 44±6 (4.5±0.6, 32.5±4.3)****T2: 98±15 (10.0±1.5, 72±11)****T3: 113±15 (11.5±1.5, 83±11)****T4: 127±20 (13.0±2.0, 94±14)****T5: 137±20 (14.0±2.0, 101±14)****CAUTION:**

Do not subject ABS sensor harness to excessive tension.

- 1) Separate front exhaust pipe and rear exhaust pipe.
- 2) Remove rear exhaust pipe and muffler.
- 3) Remove rear differential. <Ref. to 3-4 [W2B0].> or <Ref. to 3-4 [W3B0].>

- 4) Place transmission jack under rear crossmember.

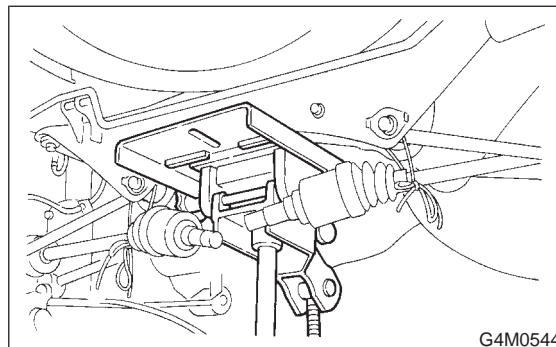

G4M0544

- 5) Remove bolts securing crossmember to vehicle body, and remove crossmember.

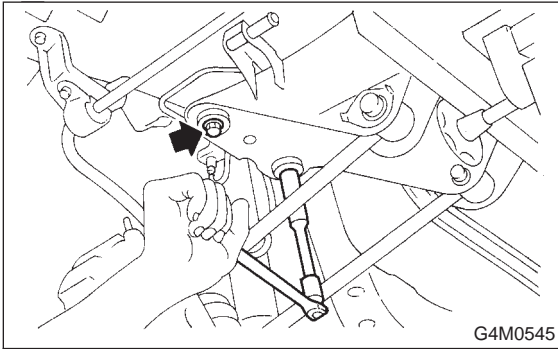

- 6) Scribe an alignment mark on rear lateral link cam bolt and crossmember.
7) Remove front and rear lateral links by loosening nuts.

B: INSPECTION

Check removed parts for wear, damage and cracks, and correct or replace if defective.

C: INSTALLATION

- 1) Install in the reverse order of removal.
- 2) For installation and tightening torque of rear differential; <Ref. to 3-4 [W2F0].> or <Ref. to 3-4 [W3F0].>
- 3) Always tighten rubber bushing when wheels are in full contact with the ground and vehicle is curb weight.

NOTE:

Check wheel alignment and adjust if necessary.