

2. Rear Axle

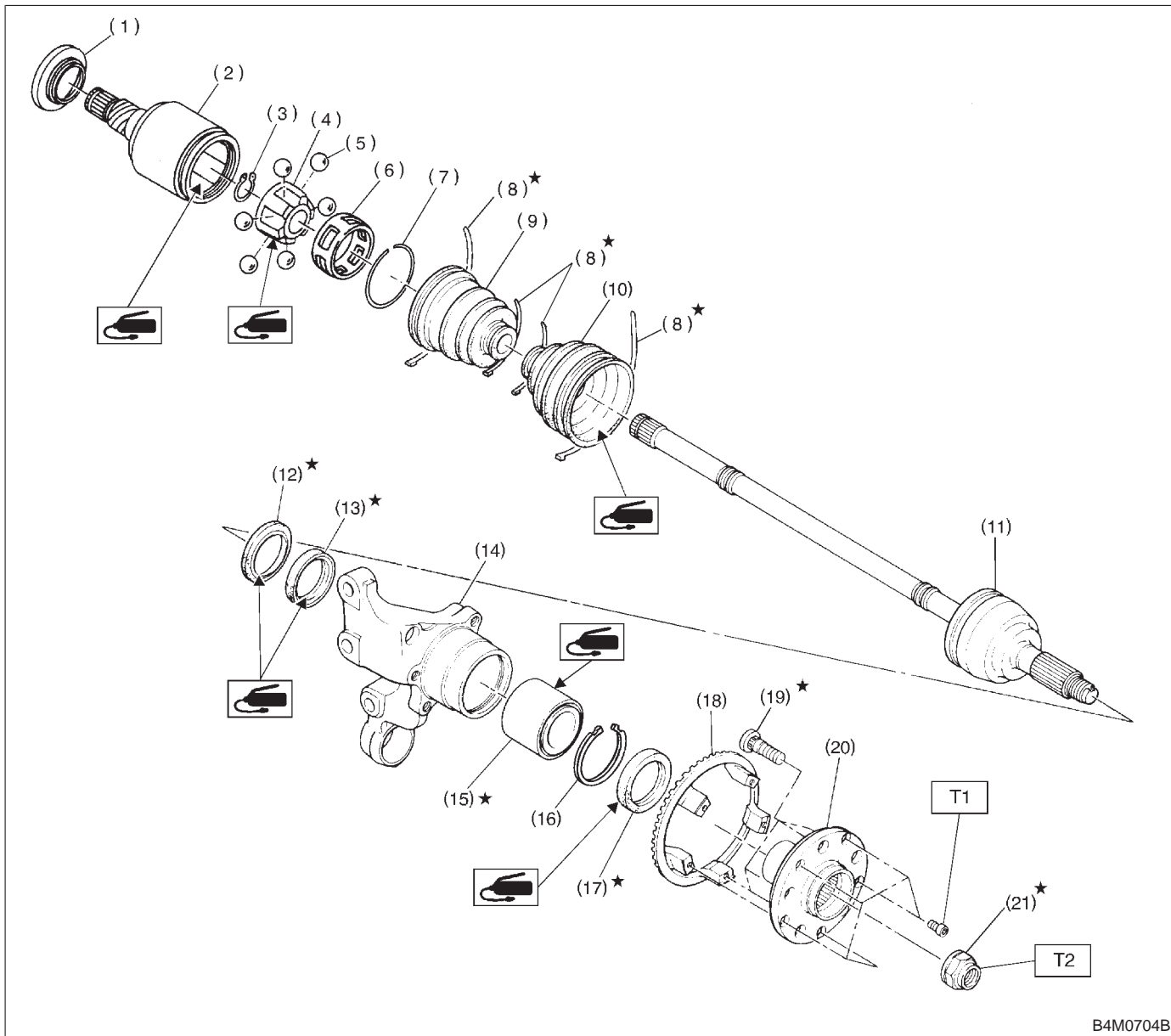

B4M0704B

- (1) Baffle plate (DOJ)
- (2) Outer race (DOJ)
- (3) Snap ring
- (4) Inner race
- (5) Ball
- (6) Cage
- (7) Circlip
- (8) Boot band
- (9) Boot (DOJ)

- (10) Boot (BJ)
- (11) BJ ASSY
- (12) Oil seal (IN. No. 2)
- (13) Oil seal (IN)
- (14) Housing
- (15) Bearing
- (16) Snap ring
- (17) Oil seal (OUT)
- (18) Tone wheel

- (19) Hub bolt
- (20) Hub
- (21) Axle nut

Tightening torque: N-m (kg-m, ft-lb)

T1: 13±3 (1.3±0.3, 9.4±2.2)

T2: 186±20 (19±2, 137±14)