

### 4. Control Valve and Harness Routing

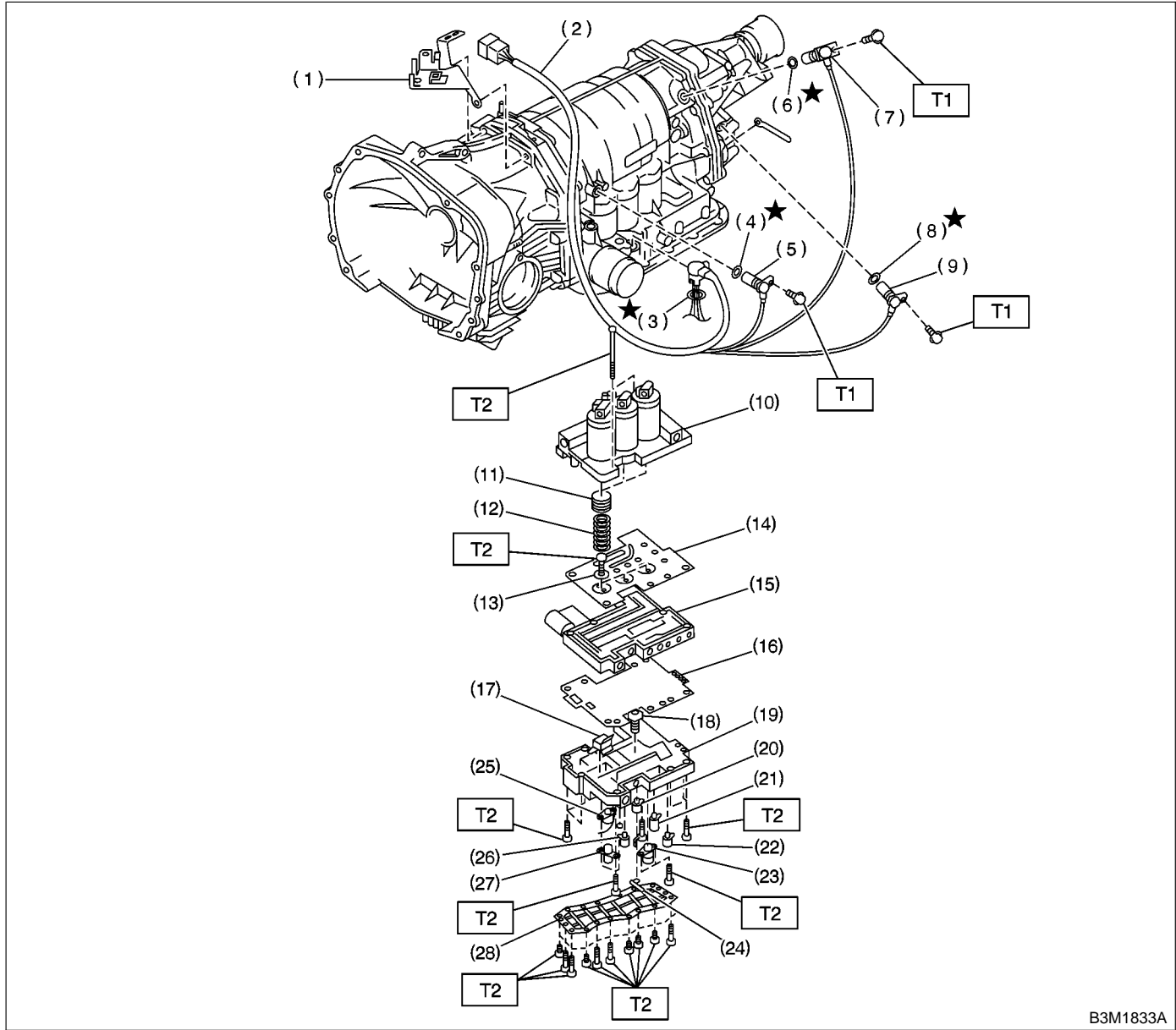

B3M1833A

- (1) Stay
- (2) Transmission harness
- (3) O-ring
- (4) O-ring
- (5) Torque converter turbine speed sensor
- (6) O-ring
- (7) Vehicle speed sensor 2 (Front)
- (8) O-ring
- (9) Vehicle speed sensor 1 (Rear)
- (10) Upper valve body
- (11) Accumulator piston

- (12) Accumulator spring
- (13) Side plate
- (14) Separate plate
- (15) Middle valve body
- (16) Separate plate
- (17) Fluid filter
- (18) Fluid filter
- (19) Lower valve body
- (20) Shift solenoid 2
- (21) Shift solenoid 1
- (22) 2-4 brake timing solenoid
- (23) 2-4 brake duty solenoid

- (24) ATF temperature sensor
- (25) Line pressure duty solenoid
- (26) Low clutch timing solenoid
- (27) Lock-up duty solenoid
- (28) Oil strainer

**Tightening torque: N-m (kg-m, ft-lb)**

**T1: 7±1 (0.7±0.1, 5.1±0.7)**

**T2: 8±1 (0.8±0.1, 5.8±0.7)**