

WHEEL BEARING

PERIODIC MAINTENANCE SERVICES

23. Wheel Bearing

A: INSPECTION

1. FRONT WHEEL BEARING

NOTE:

Inspect the condition of front wheel bearing grease.

- 1) Lift-up the front of vehicle.
- 2) While holding the front wheel by hand, swing it in and out to check bearing free play.
- 3) Loosen the wheel nuts and remove front wheel.
- 4) If bearing free play exists in step 2) above, attach a dial gauge to the hub and measure axial displacement in axial direction.

Service limit:

Straight-ahead position within 0.05 mm (0.0020 in)

- 5) Remove the bolts and self-locking nuts, and extract transverse link from front crossmember.
 - 6) Remove the AARi of front drive shaft from transmission. <Ref. to DS-19, Front Axle.>
 - 7) While supporting the front drive shaft horizontally with one hand, turn the hub with the other to check for noise or binding.
- If the hub is noisy or binds, disassemble the front axle and check condition of oil seals, bearing, etc.

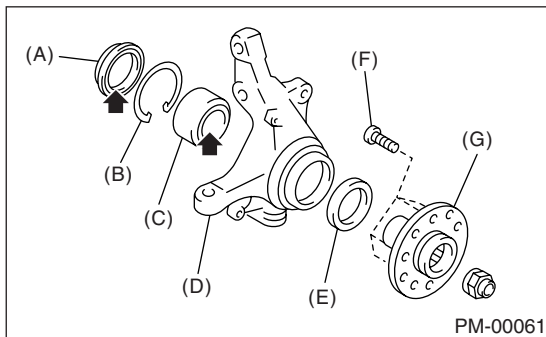

- (A) Inner oil seal
- (B) Snap ring
- (C) Bearing
- (D) Housing
- (E) Outer oil seal
- (F) Hub bolt
- (G) Hub

2. REAR WHEEL BEARING

- 1) Lift-up the rear of vehicle.
- 2) While holding the rear wheel by hand, swing it in and out to check bearing free play.
- 3) Loosen the wheel nuts and remove rear wheel.
- 4) If the bearing free play exists in step 2) above, attach a dial gauge to the hub COMPL and measure axial displacement in axial direction.

Service limit:

Straight-ahead position within 0.05 mm (0.0020 in)

- 5) Remove the DOJ of rear drive shaft from rear differential. <Ref. to DS-39, Rear Drive Shaft.>

- 6) While supporting the rear drive shaft horizontally with one hand, turn the hub COMPL with the other to check for noise or binding.

If the hub COMPL is noisy or binds, disassemble the rear axle and check condition of oil seals, bearings, etc.

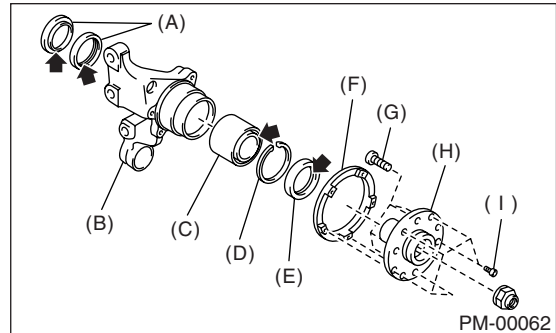

- (A) Inner oil seal
- (B) Rear housing
- (C) Bearing
- (D) Snap ring
- (E) Outer oil seal
- (F) Tone wheel
- (G) Hub bolt
- (H) Hub
- (I) Socket bolt