

3. Datum Dimensions

A: MEASUREMENT

Refer to LOCATION for details on measurement points. <Ref. to BS-3, LOCATION, Datum Points.>

NOTE:

- Using a tram tracking gauge, measure all dimensions.
- When using a tape measure, carefully measure dimensions without letting the tape measure sag or twist.
- Measure the linear dimensions between cores of holes.
- Suffixes “RH” and “LH” indicate right-hand and left-hand.

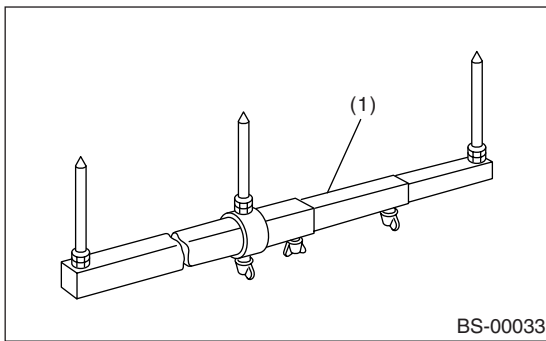

(1) Tram tracking gauge

- Measure at the center of the circle around the outside of the body panel.

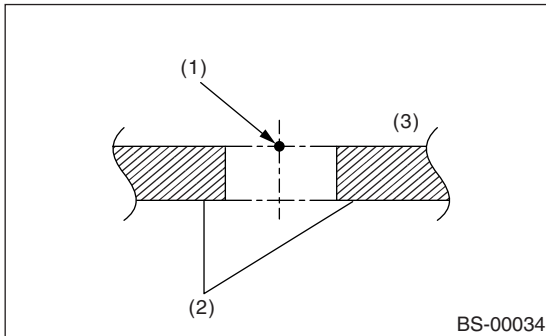

- (1) Datum point
- (2) Body panel
- (3) Outside

DATUM DIMENSIONS

BODY STRUCTURE

1. CENTER STRUCTURE

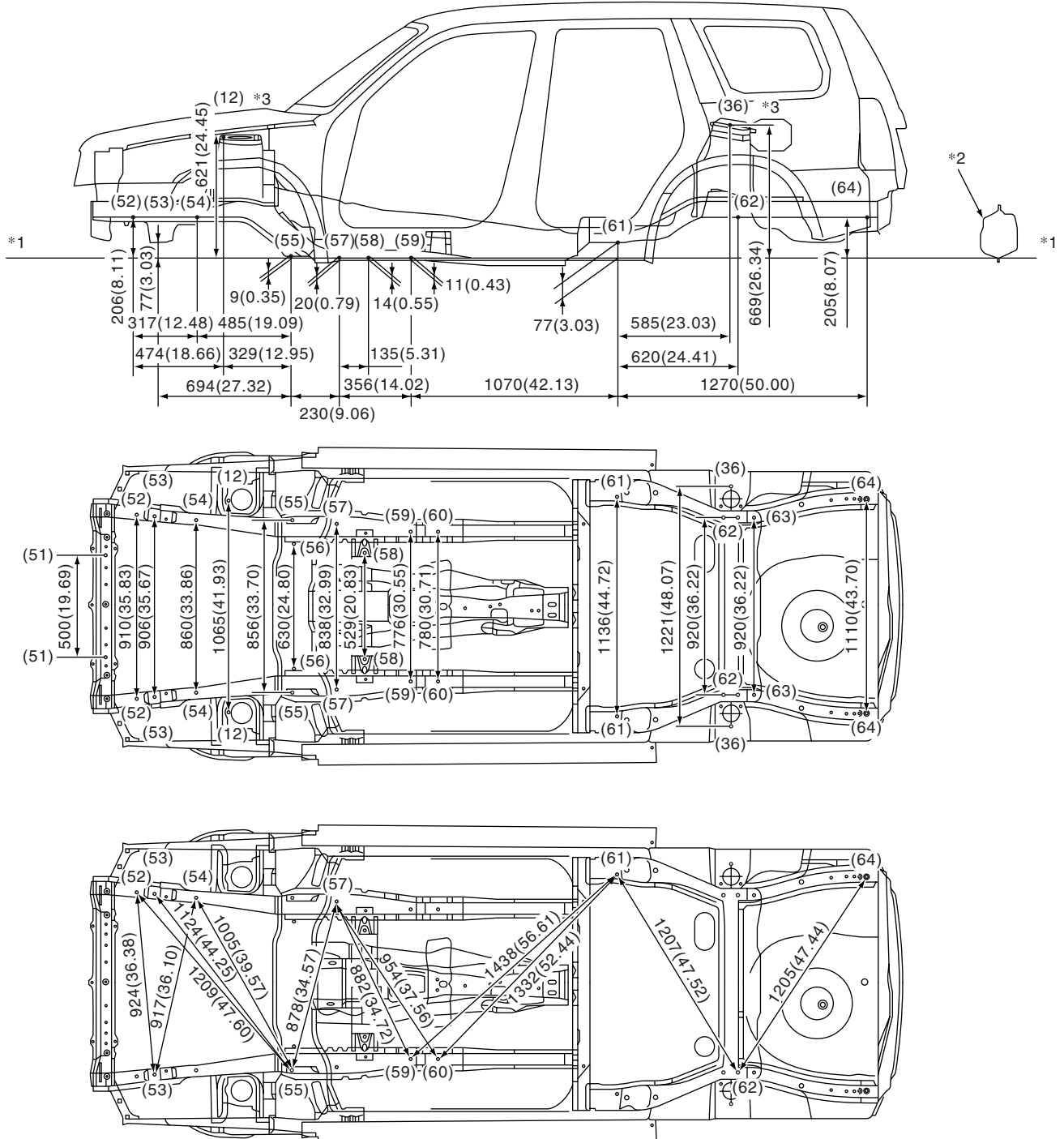

- *1: Standard line
 - *2: Side sill
 - *3: Upper surface
- Unit: mm (in)

BS-00035

2. SUSPENSION CROSSMEMBER

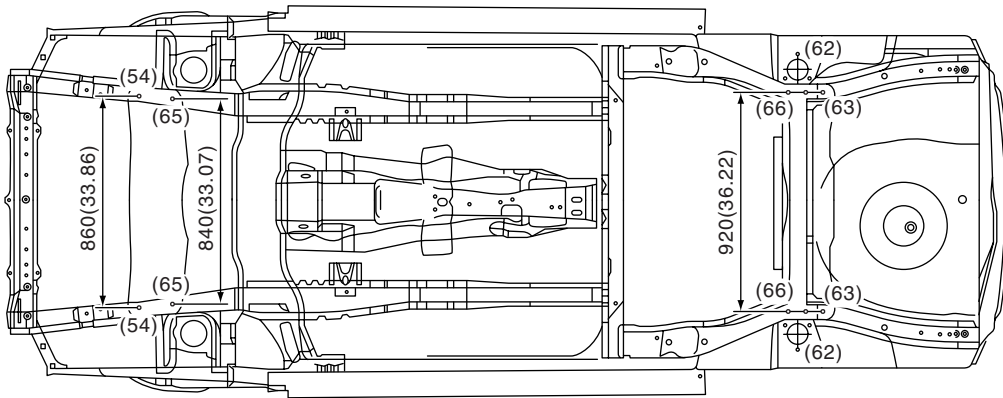
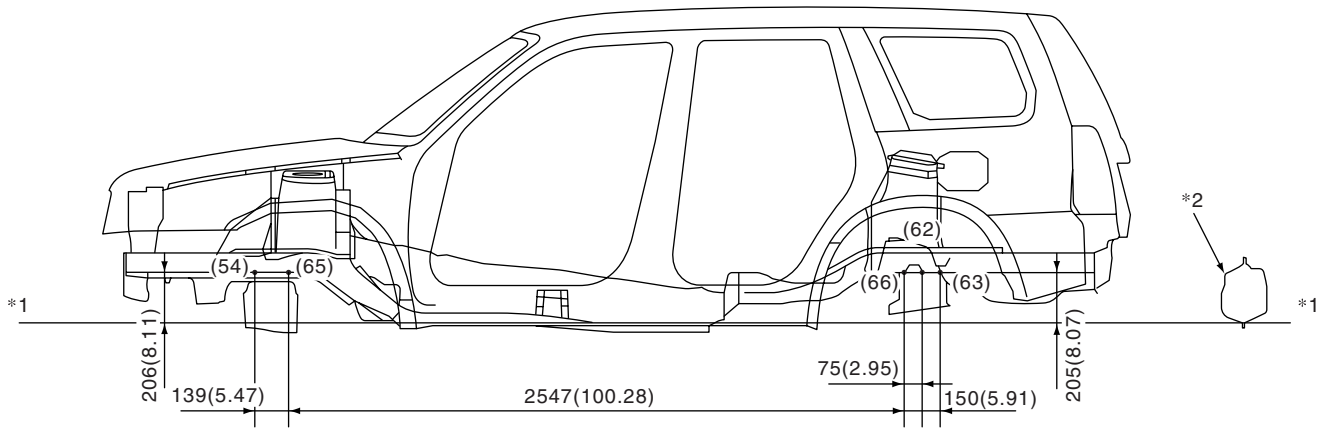

*1: Standard line
 *2: Side sill
 Unit: mm (in)

BS-00036

DATUM DIMENSIONS

BODY STRUCTURE

3. FRONT STRUCTURE

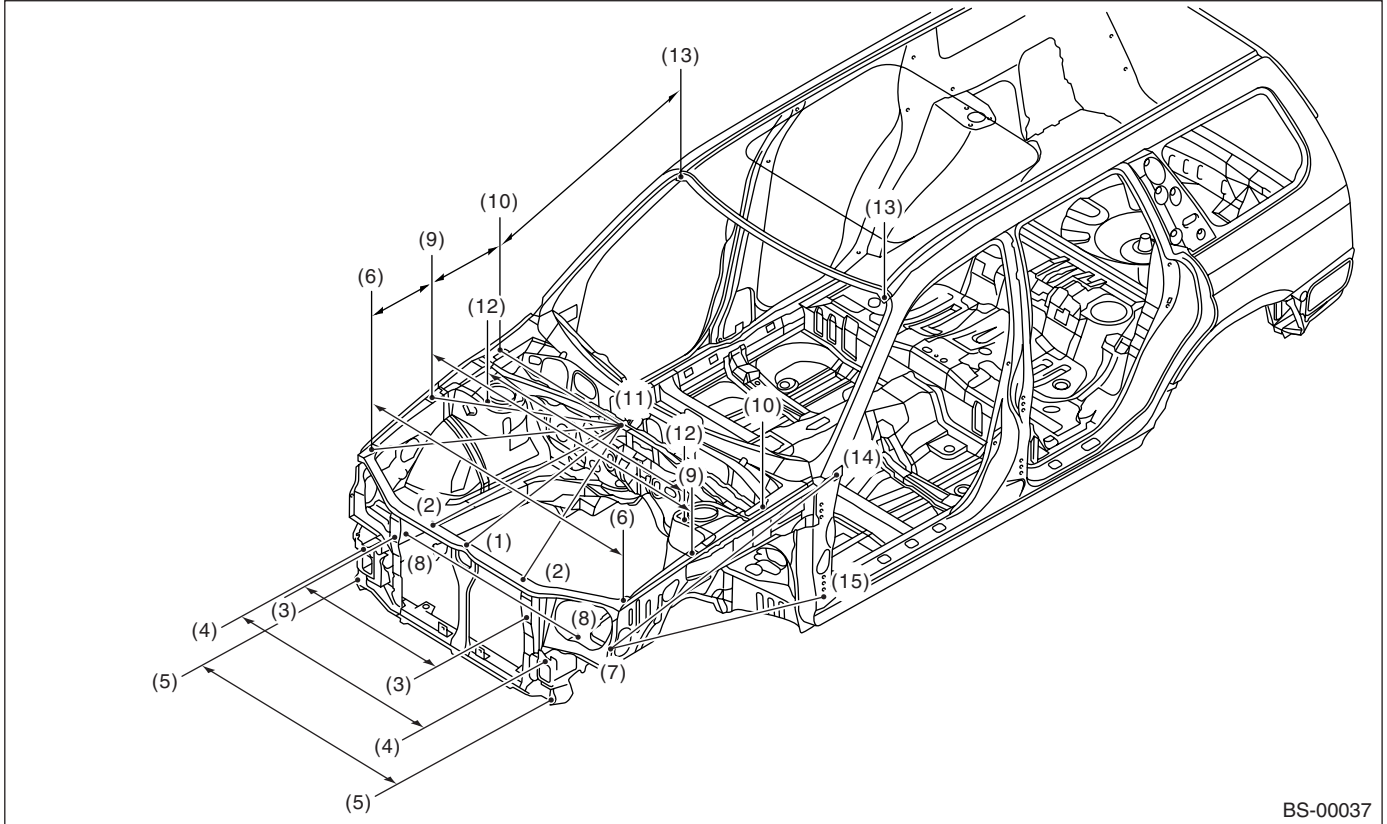

BS-00037

Unit: mm (in)

Point to point	Dimension	Point to point	Dimension
(1) to (11)	822 (32.36)	(7) LH to (15) LH	1,067 (42.01)
(2) RH to (11)	842 (33.15)	(8) RH to (8) LH	921 (36.26)
(2) LH to (11)	875 (34.45)	(9) RH to (9) LH	1,396 (54.96)
(3) RH to (3) LH	716 (28.19)	(9) RH to (10) RH	398 (15.67)
(4) RH to (4) LH	978 (38.50)	(9) LH to (10) LH	398 (15.67)
(5) RH to (5) LH	1,049 (41.30)	(9) RH to (11)	767 (30.20)
(6) RH to (6) LH	1,341 (52.80)	(9) LH to (11)	767 (30.20)
(6) RH to (9) RH	349 (13.74)	(10) RH to (11)	722 (28.43)
(6) LH to (9) LH	349 (13.74)	(10) LH to (11)	722 (28.43)
(6) RH to (11)	944 (37.17)	(10) RH to (13) RH	907 (35.71)
(6) LH to (11)	944 (37.17)	(10) LH to (13) LH	907 (35.71)
(7) RH to (14) RH	1,155 (45.47)	(11) to (12) RH	565 (22.24)
(7) LH to (14) LH	1,155 (45.47)	(11) to (12) LH	565 (22.24)
(7) RH to (15) RH	1,067 (42.01)	(12) RH to (12) LH	1,065 (41.93)

DATUM DIMENSIONS

BODY STRUCTURE

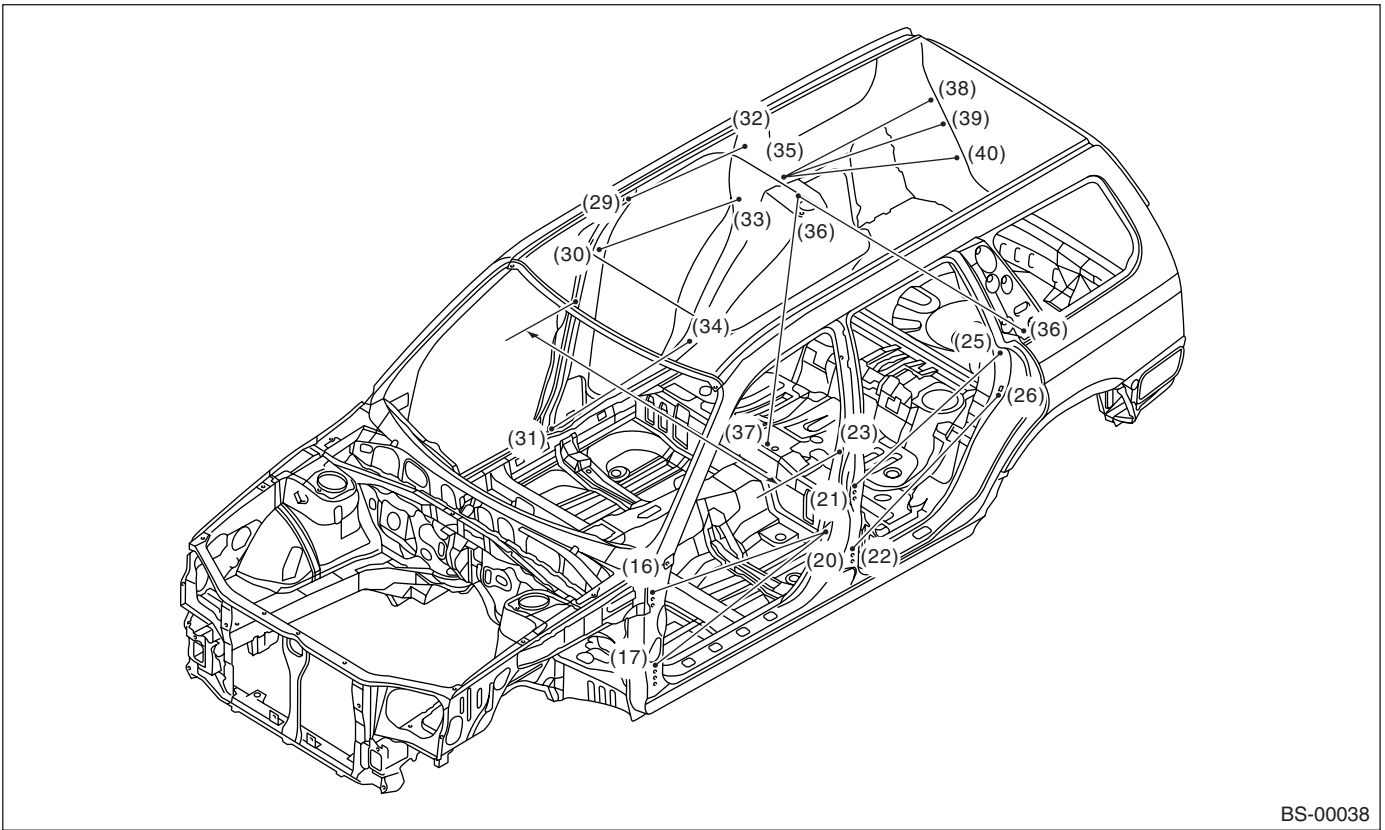

BS-00038

Unit: mm (in)

Point to point	Dimension	Point to point	Dimension
(16) RH to (20) RH	980 (38.58)	(30) LH to (33) LH	796 (31.34)
(16) LH to (20) LH	980 (38.58)	(31) RH to (34) RH	759 (29.88)
(17) RH to (20) RH	982 (38.66)	(31) LH to (34) LH	759 (29.88)
(17) LH to (20) LH	982 (38.66)	(35) RH to (38) RH	665 (26.18)
(21) RH to (25) RH	853 (33.58)	(35) LH to (38) LH	665 (26.18)
(21) LH to (25) LH	853 (33.58)	(35) RH to (39) RH	711 (27.99)
(22) RH to (26) RH	895 (35.24)	(35) LH to (39) LH	711 (27.99)
(22) LH to (26) LH	895 (35.24)	(35) RH to (40) RH	784 (30.87)
(23) LH to (23) RH	1,429 (56.26)	(35) LH to (40) LH	784 (30.87)
(29) RH to (32) RH	674 (26.54)	(36) LH to (36) RH	1,221 (48.07)
(29) LH to (32) LH	674 (26.54)	(36) RH to (37) RH	1,067 (42.01)
(30) RH to (33) RH	796 (31.34)	(36) LH to (37) LH	1,067 (42.01)

DATUM DIMENSIONS

BODY STRUCTURE

4. REAR STRUCTURE

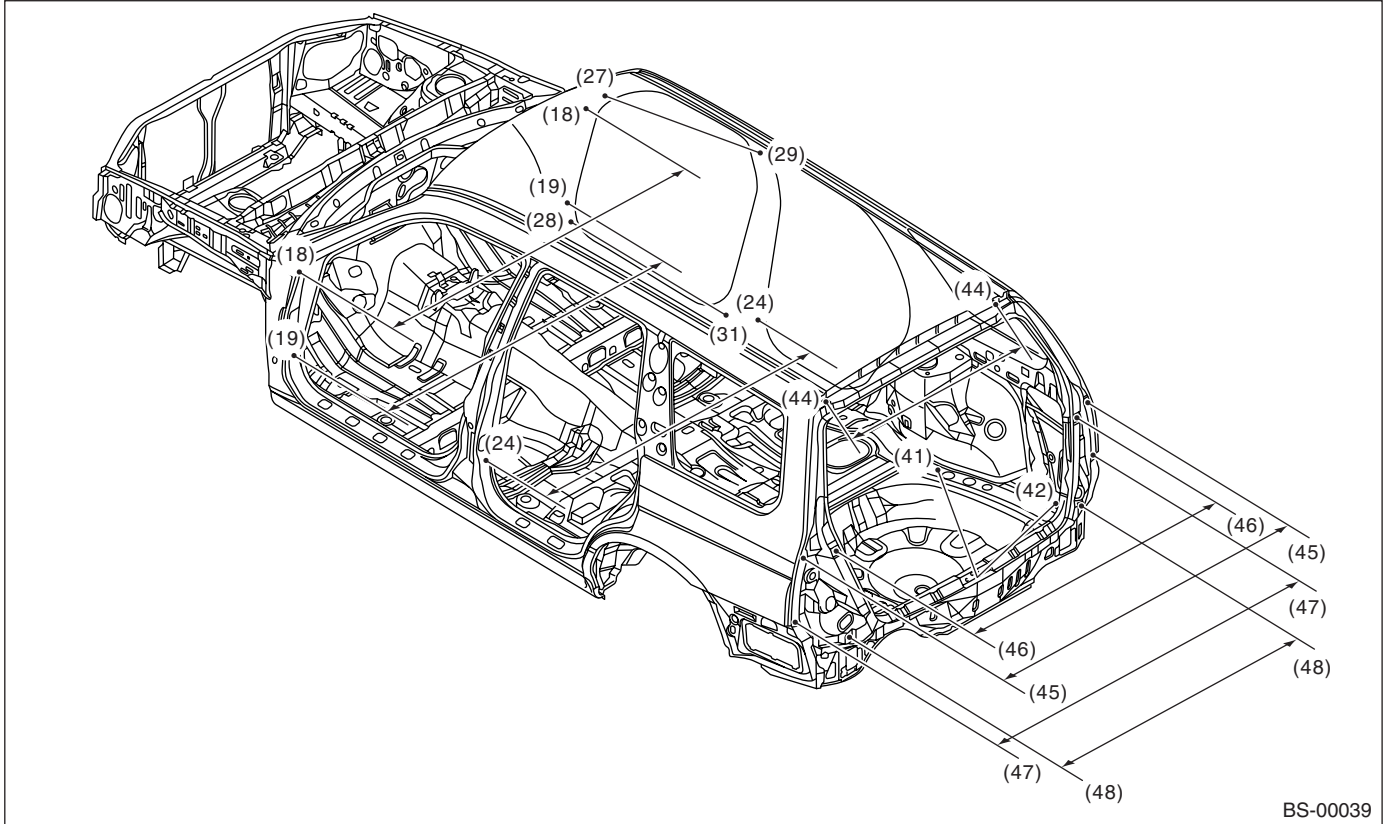

Unit: mm (in)

Point to point	Dimension	Point to point	Dimension
(18) RH to (18) LH	1,449 (57.05)	(41) RH to (43) RH	794 (31.26)
(19) RH to (19) LH	1,459 (57.44)	(41) LH to (43) LH	805 (31.69)
(27) RH to (29) RH	1,007 (39.65)	(42) RH to (42) LH	1,110 (43.70)
(27) LH to (29) LH	1,007 (39.65)	(44) RH to (44) LH	878 (34.57)
(28) RH to (31) RH	813 (32.01)	(45) RH to (45) LH	1,474 (58.03)
(28) LH to (31) LH	813 (32.01)	(46) RH to (46) LH	1,252 (49.29)
(24) RH to (24) LH	1,438 (56.61)	(47) RH to (47) LH	1,552 (61.10)
(41) RH to (41) LH	950 (37.40)	(48) RH to (48) LH	1,210 (47.64)