

INHIBITOR SWITCH (AT MODEL)

CRUISE CONTROL SYSTEM

8. Inhibitor Switch (AT model)

A: REMOVAL

- 1) Disconnect the ground cable from battery.
- 2) Disconnect the connector from inhibitor switch, and then remove the switch. <Ref. to 4AT-50, REMOVAL, Inhibitor Switch.>

B: INSTALLATION

Install in the reverse order of removal.

C: INSPECTION

Measure the inhibitor switch resistance.

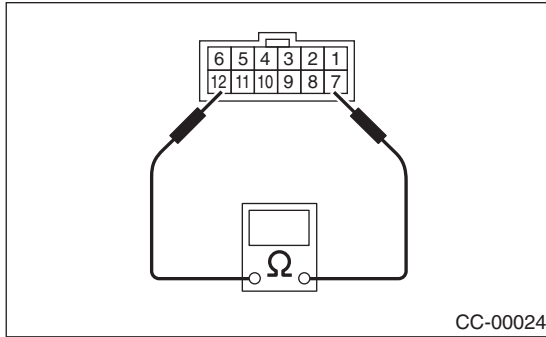

Selector lever position	Terminal No.	Standard
P	7 and 12	Less than 1 Ω
N		Less than 1 Ω
Except P and N		More than 1 M Ω

If NG, replace the inhibitor switch.

9. Neutral Position Switch (MT model)

A: REMOVAL

- 1) Disconnect the ground cable from battery.
- 2) Disconnect the connector from neutral position switch, and then remove the switch. <Ref. to 5MT-38, BACK-UP LIGHT AND NEUTRAL POSITION SWITCH, REMOVAL, Switches and Harness.>

B: INSTALLATION

Install in the reverse order of removal.

C: INSPECTION

Measure the neutral position switch resistance.

- Non-turbo model

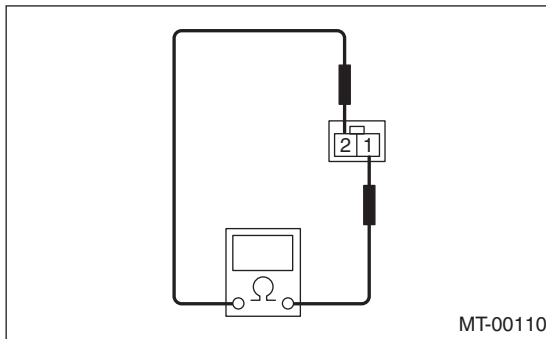

Gear shift position	Terminal No.	Specified resistance
Neutral position	1 and 2	Less than 1 Ω
Other positions		More than 1 M Ω

- Turbo model

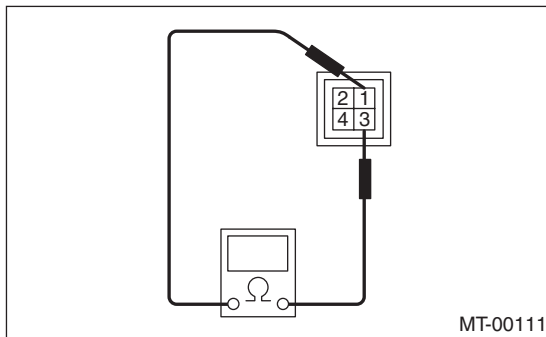

Gear shift position	Terminal No.	Specified resistance
Neutral position	1 and 3	Less than 1 Ω
Other positions		More than 1 M Ω

If NG, replace the neutral position switch.