

# REAR WIRING HARNESS AND REAR GATE CORD

WIRING SYSTEM

## 54. Rear Wiring Harness and Rear Gate Cord

### A: LOCATION

Connector				Connecting to	
No.	Pole	Color	Area	No.	Name
R16	3	★	C-5		Rear door switch RH
R26	6	★	C-4		Rear combination light RH
R28	6	★	C-1		Rear combination light LH
R30	2	Black	C-4		Diode (Luggage room light)
R32	2	★	C-4		Rear accessory power supply socket
R38	4	★	C-4	D33	Rear gate cord
R39	4	★	C-4	D34	Rear gate cord
R79	6	★	D-3		Trailer connector
R97	2	★	C-1		Antenna amp
R116	8	★	C-4		Rear wiper intermittent module
R117	2	★	C-2		Sub woofer
R122	10	★	C-4		Fuel pump control module (Turbo Model)
R147	5	★	C-3		Ground joint connector

★: Non-colored

Connector				Connecting to	
No.	Pole	Color	Area	No.	Name
D33	2	★	C-4	R38	Rear wiring harness
D34	4	★	C-4	R39	Rear wiring harness
D39	2	★	B-3		High-mounted stop light
D40	1	★	B-3		Rear defogger
D43	4	★	A-2		Rear wiper motor
D44	2	★	A-2		License plate light
D46	2	Black	A-2		Rear gate latch switch
D47	2	★	A-1		Rear gate lock actuator cord
D79	1	Black	B-2		Rear defogger
D80	8	★	A-3	D81	Rear gate cord
D81	8	★	A-3	D80	Rear gate cord
D82	3	★	B-3		Luggage room light

★: Non-colored

# REAR WIRING HARNESS AND REAR GATE CORD

WIRING SYSTEM

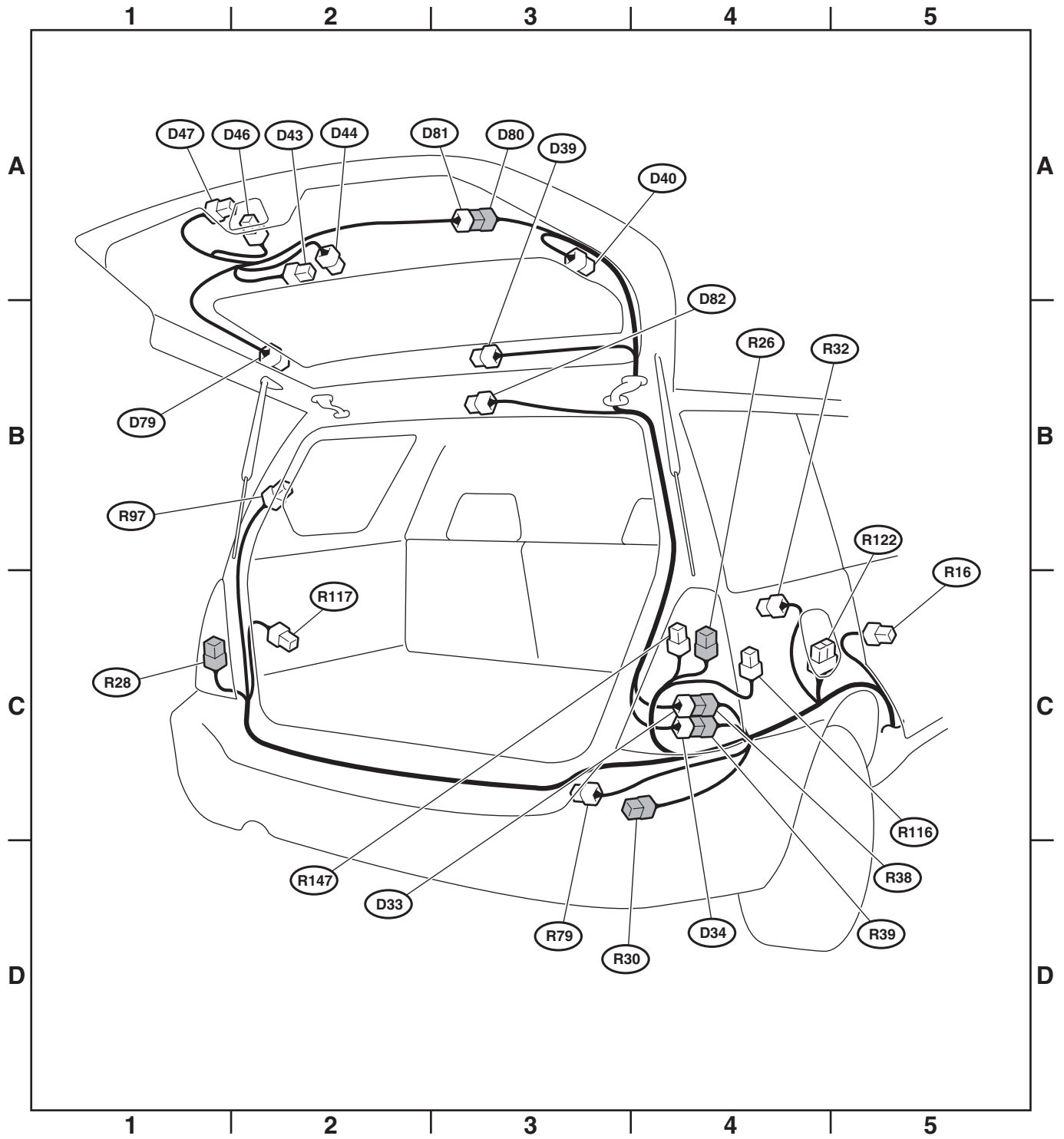

WI-03105