

# Electrical Component Location

HVAC SYSTEM (AUTO A/C) (DIAGNOSTICS)

## 3. Electrical Component Location

### A: LOCATION

#### 1. ENGINE COMPARTMENT

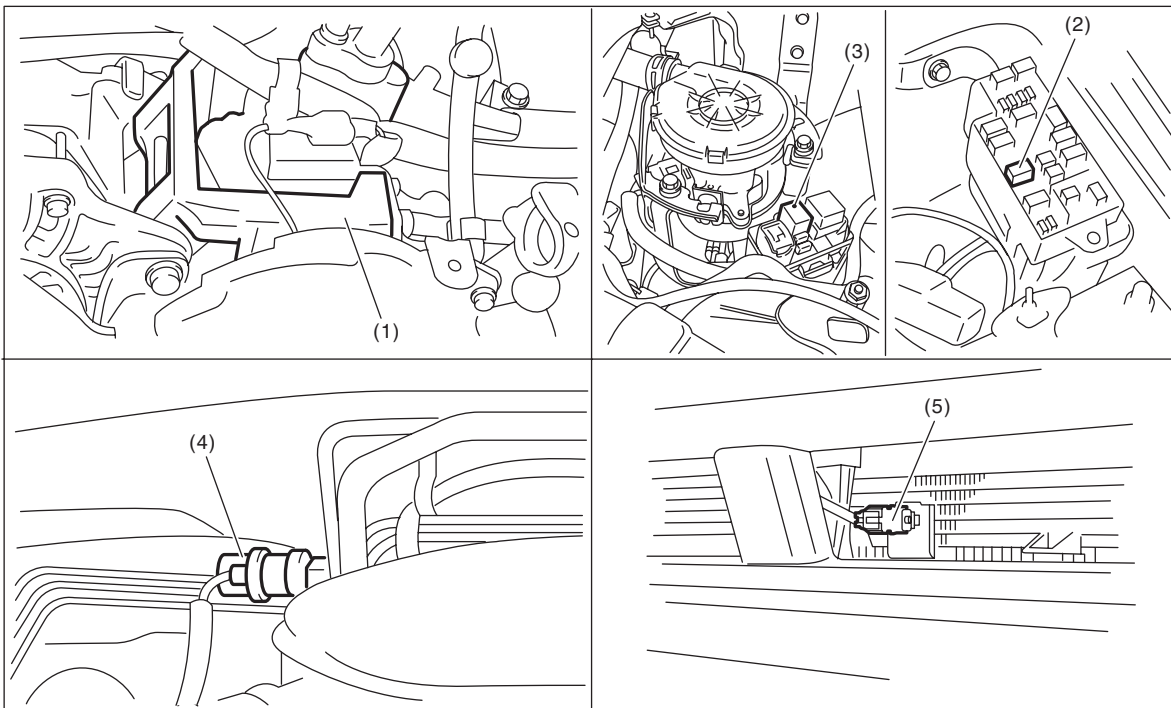
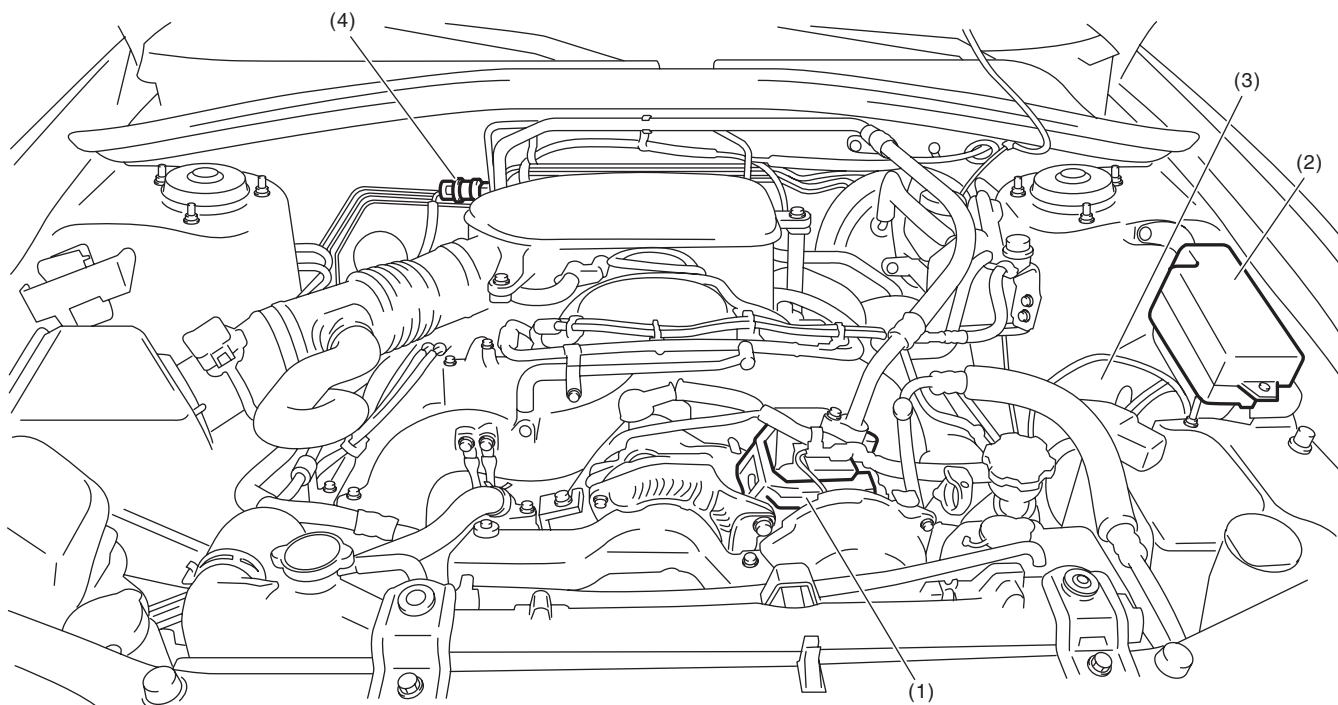

AC-01368

(1) A/C compressor

(3) A/C relay (Turbo model)

(5) Ambient sensor

(2) A/C relay (Non-turbo model)

(4) Pressure switch

# Electrical Component Location

HVAC SYSTEM (AUTO A/C) (DIAGNOSTICS)

## 2. PASSENGER COMPARTMENT

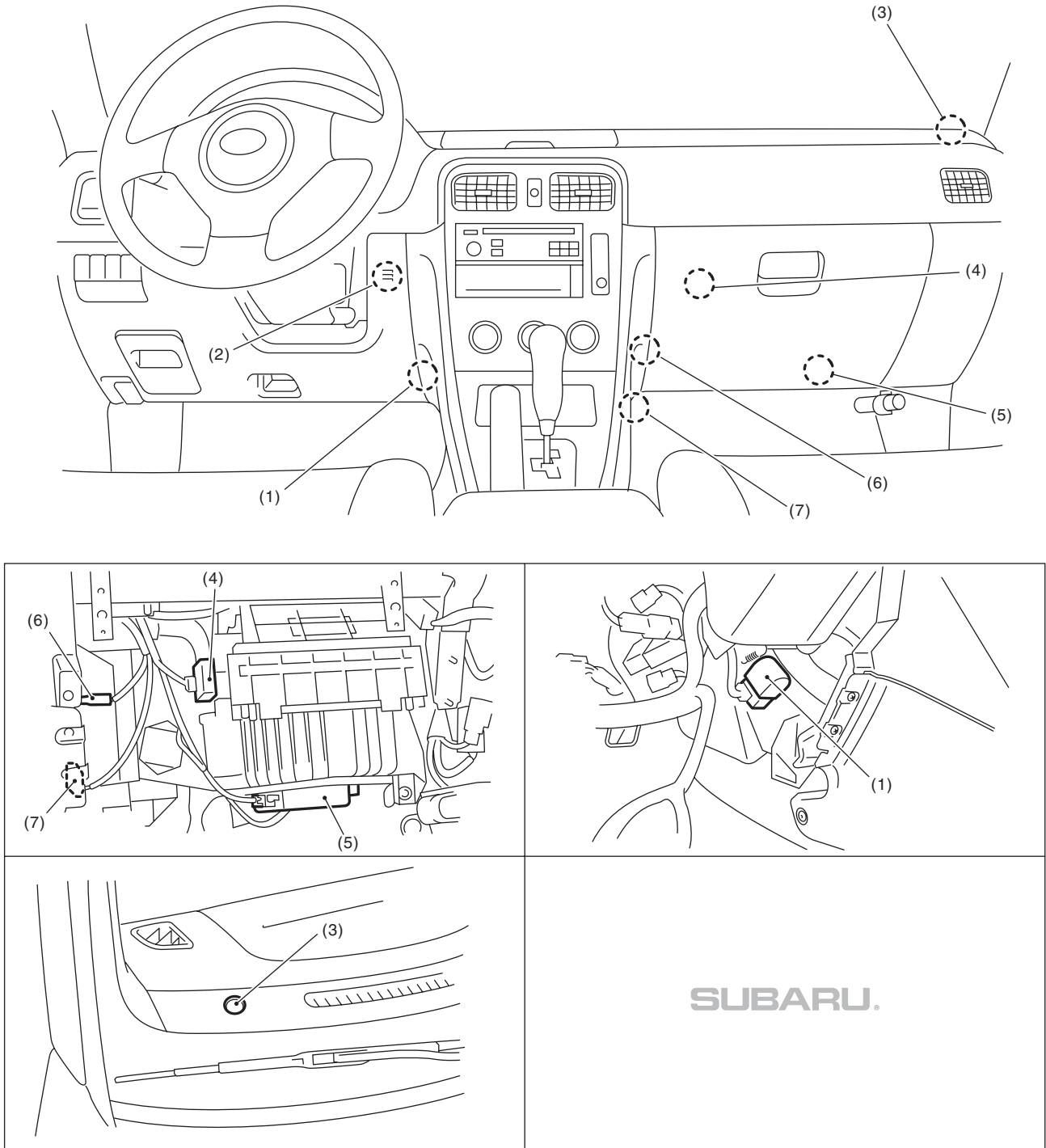

AC-01189

- |                        |                          |                           |
|------------------------|--------------------------|---------------------------|
| (1) Mode door actuator | (4) Intake door actuator | (6) Evaporator sensor     |
| (2) In-vehicle sensor  | (5) Blower motor         | (7) Air mix door actuator |
| (3) Sunload sensor     |                          |                           |