

# General Description

## AIRBAG SYSTEM

### 1. General Description

#### A: COMPONENT

#### 1. SRS AIRBAG

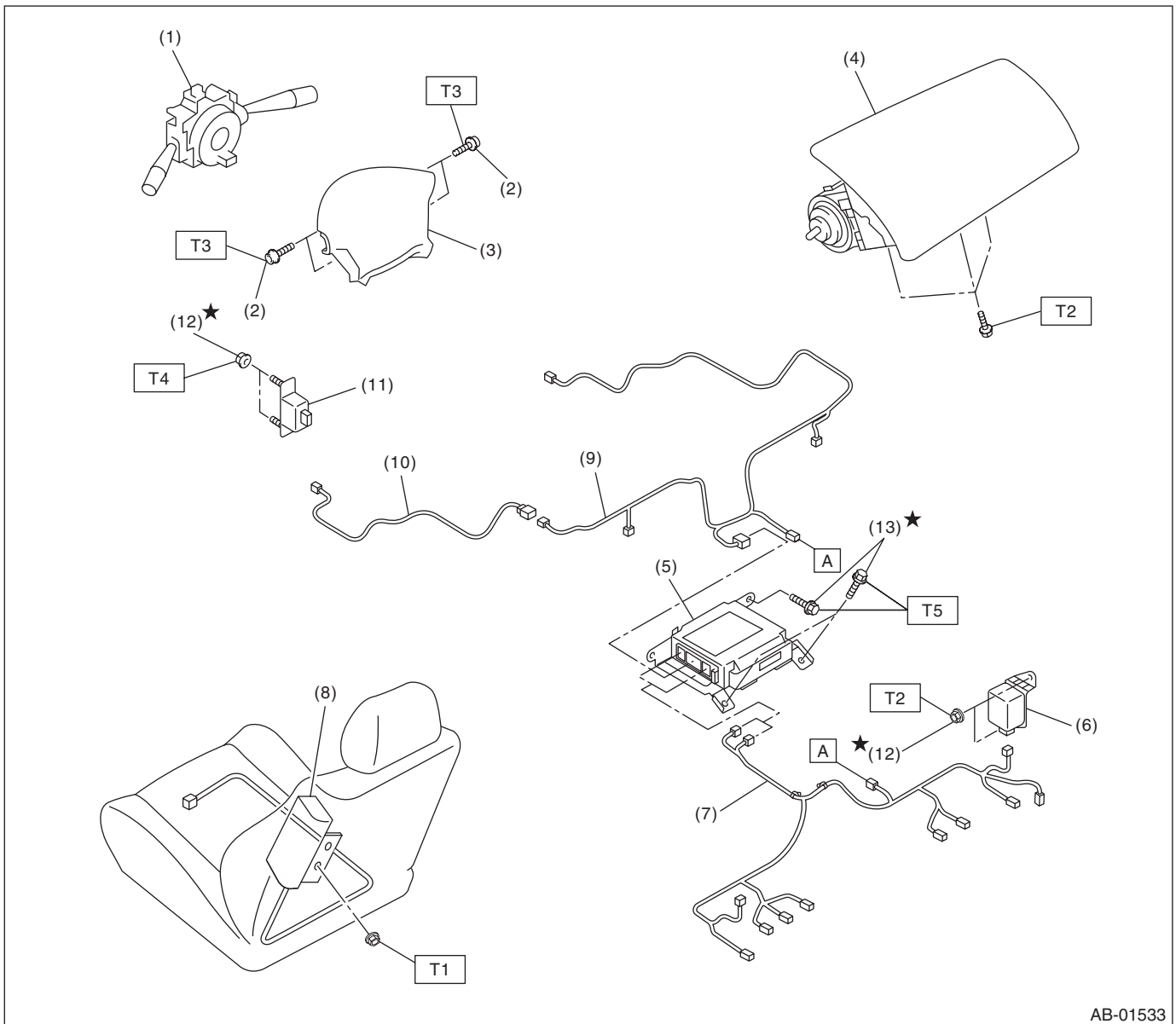

AB-01533

- |   |                           |
|---|---------------------------|
| (1) Combination switch ASSY with roll connector | (7) Wiring harness rear   |
| (2) TORX® bolt T30                              | (8) Side airbag module    |
| (3) Airbag module ASSY (Driver)                 | (9) Wiring harness center |
| (4) Airbag module ASSY (Passenger)              | (10) Wiring harness front |
| (5) Airbag control module                       | (11) Front sub sensor     |
| (6) Side airbag sensor                          | (12) Nut                  |
|   | (13) Bolt                 |

#### **Tightening torque: N·m (kgf·m, ft·lb)**

**T1: 7.5 (0.8, 5.5)**

**T2: 7.4 (0.75, 5.4)**

**T3: 10 (1.0, 7.2)**

**T4: 20 (2.0, 14.5)**

**T5: 25 (2.5, 18.1)**

## 2. SEAT POSITION SENSOR

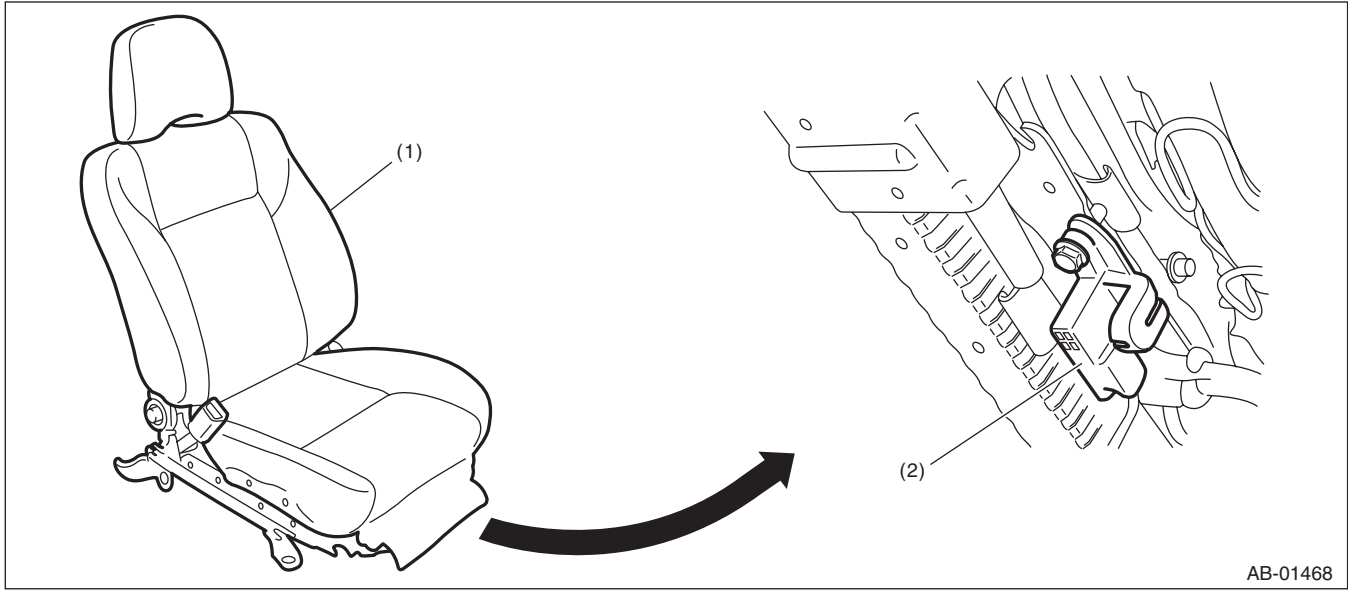

AB-01468

(1) Driver's seat

(2) Seat position sensor

# General Description

## AIRBAG SYSTEM

### B: CAUTION

- When servicing a vehicle, be sure to turn the ignition switch to OFF, disconnect the ground cable from battery, and wait for more than 20 seconds before starting work.
- The airbag system is fitted with a backup power source. Be careful that the airbag may deploy after disconnecting the battery ground cable, if you do not wait for more than 20 seconds before starting the service of airbag system.

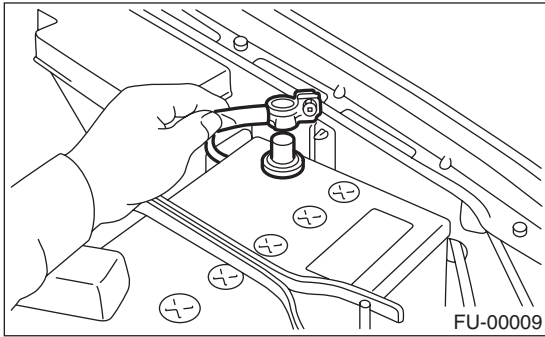

- If the airbag warning light illuminates, repair the vehicle immediately. Be careful that the airbag or pretensioner may inflate incorrectly, or not inflate in collision without repair.
- If sensors, airbag module, airbag control module, pretensioner or harness is deformed or damaged, replace with new parts.

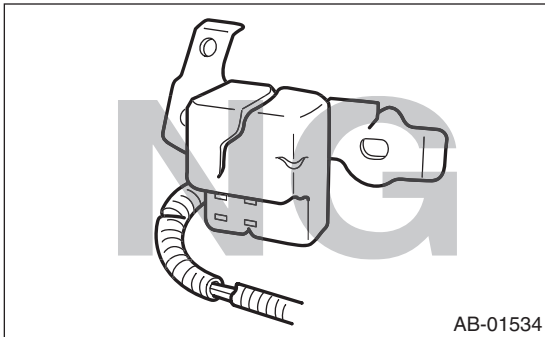

- When checking the airbag system, be sure to use a digital circuit tester. Use of an analog circuit tester may cause the airbag to activate erroneously due to a minimal current inside tester.

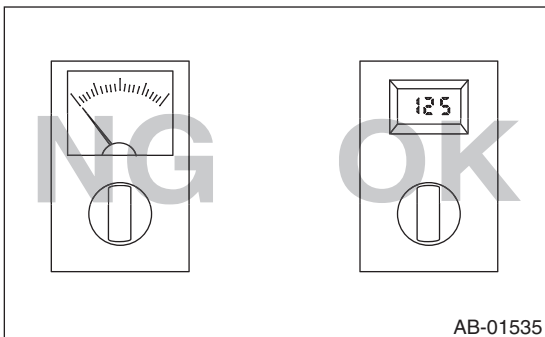

- When checking, use a test harness (1). Damage to connector terminal cause malfunction. Do not directly apply the tester probe to connector terminal of airbag.

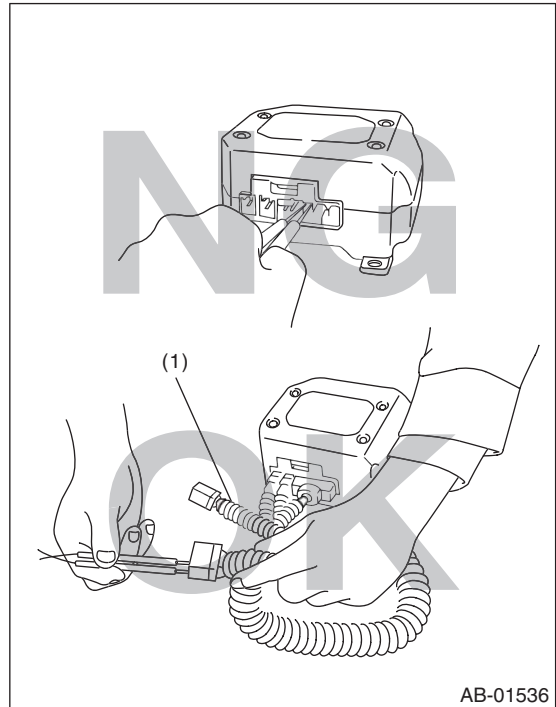

- Do not check continuity of the airbag modules for driver's side, passenger's side, or pretensioner.

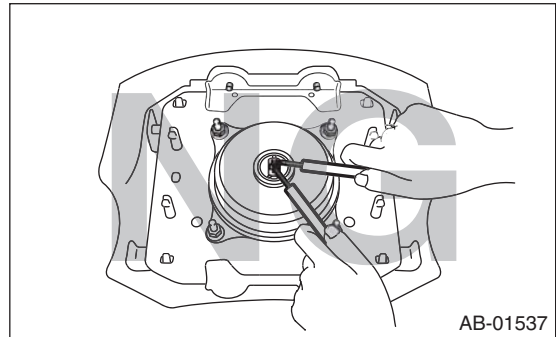

- Do not drop any parts of the airbag system, subject them to high temperature over 93°C (199°F), or let water, oil or grease get on them; the internal parts may be damaged and reliability greatly lowered.



- If damage, open circuit or rust is found on airbag system wiring harness, do not use a soldering equipment to repair. Replace the faulty harness with a new genuine part.

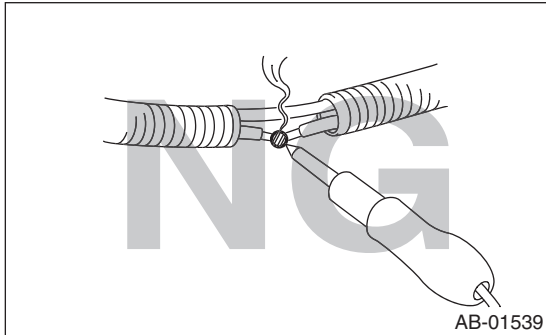

- Do not allow water or oil to come in contact with the connector terminals. Also, do not touch the connector terminals.

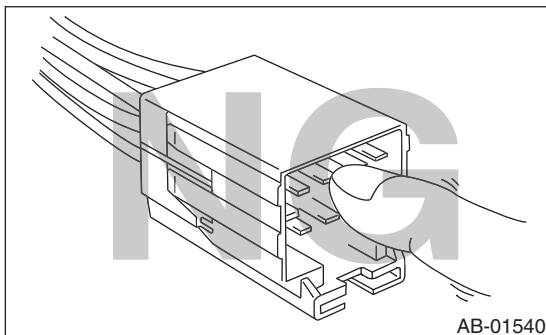

- When airbag control module, front sub sensor, side airbag sensor and curtain airbag sensor are removed, do not reuse the bolts and nuts. Always use new bolts and nuts.
- Either of the airbag modules for driver's, passenger's and side or the pretensioner must not be disassembled.

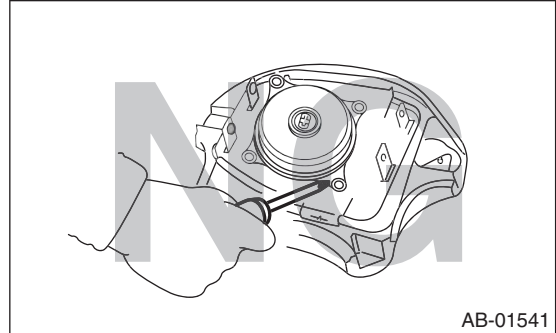

- The removed front seat with airbag module must be kept at least 200 mm (8 in) away from walls and other objects.

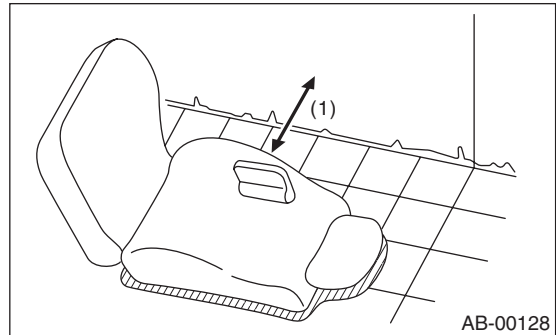

(1) 200 mm (8 in) or more

- Do not use the airbag or pretensioner parts from other vehicles. Always replace the defective parts with new parts.
- Never reuse a deployed airbag and pretensioner.
- When painting or performing sheet metal work on the front part of the vehicle, including the front wheel apron, front fender and front side frame, remove the front sub sensors and wiring harness of airbag system.

## General Description

### AIRBAG SYSTEM

---

- When painting or performing sheet metal work on the side of the vehicle, including the side sill, center pillar and front and rear doors, remove the side airbag sensors and wiring harness of the airbag system.

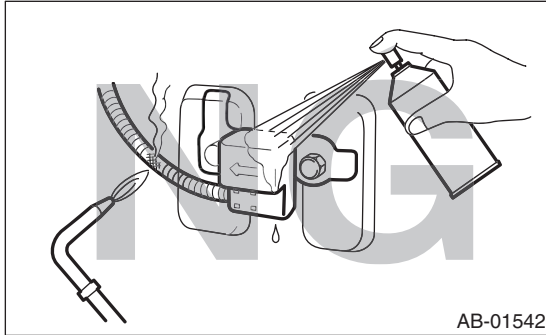

- Do not discard an undeployed airbag module or pretensioner.
- After removing the parts of airbag system, keep them with the pad facing upward on a dry, clean, and flat surface away from heat and light sources, and moisture and dust.

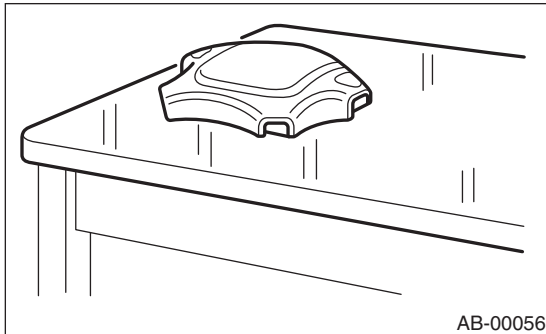

- When airbag control module, front sub sensor and side airbag sensor are removed, do not reuse the bolts and nuts. Always use new bolts and nuts.

- When storing the removed airbag module, do not place with the pad side facing down. Do not place any objects on top of the airbag module. Do not stack other airbag modules on top of each other. If the airbag module pads are in contact with other objects, it may lead to a major accident when the airbag is deployed unexpectedly.

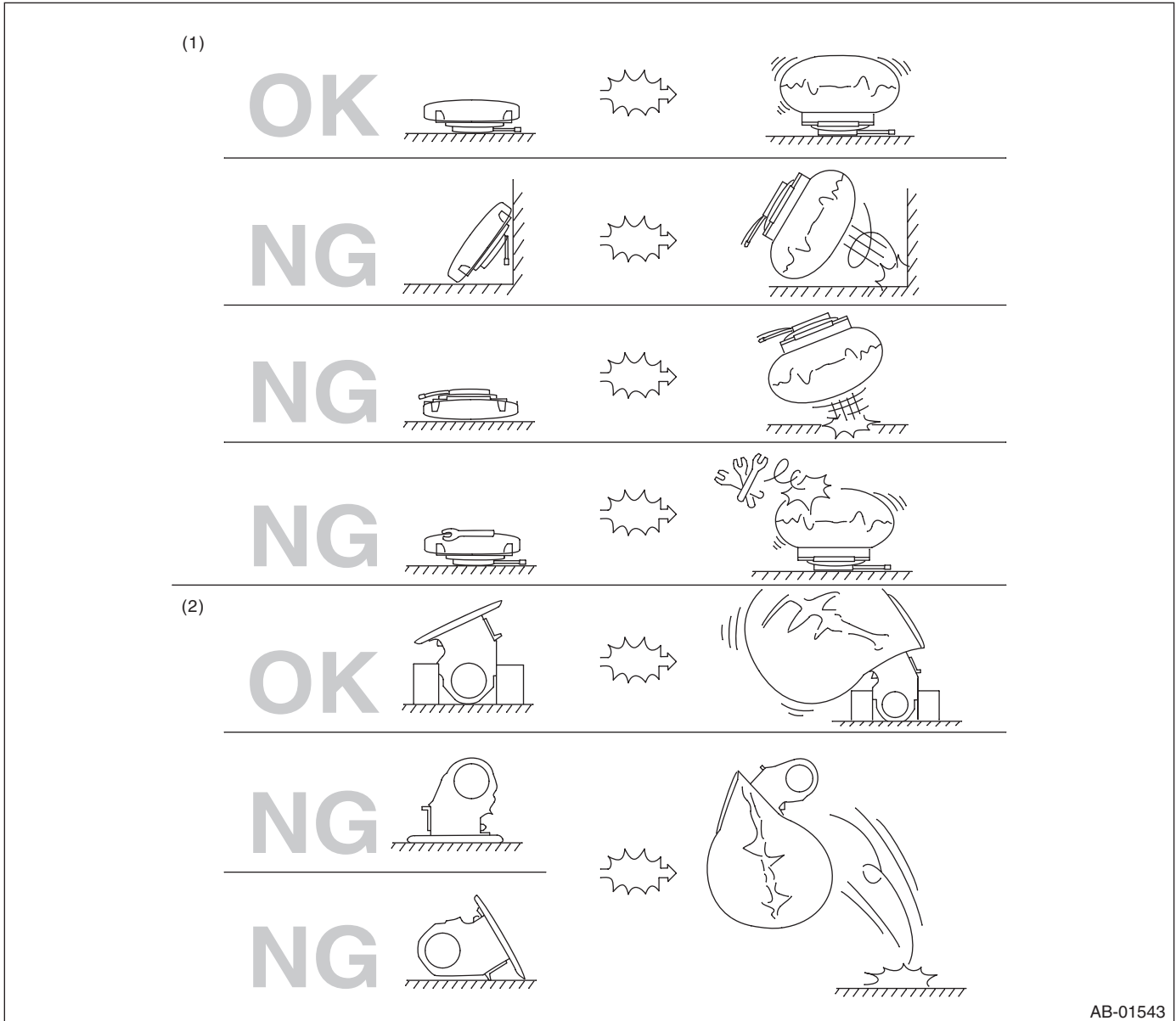

AB-01543

(1) Driver's airbag module

(2) Passenger's airbag module

## C: PREPARATION TOOL

### 1. GENERAL TOOL

TOOL NAME	REMARKS
TORX® T30	Used for removal/installation of drivers airbag module