

3. Datum Dimensions

A: MEASUREMENT

For details concerning points to measure, refer to "Position". <Ref. to BS-3, LOCATION, Datum Points.>

NOTE:

- Using a tram tracking gauge, measure all the dimensions.
- When using a tape measure, carefully measure dimensions without letting the tape measure sag or twist.
- Measure the linear dimensions between cores of holes.
- Suffixes "RH" and "LH" indicate right-hand and left-hand.

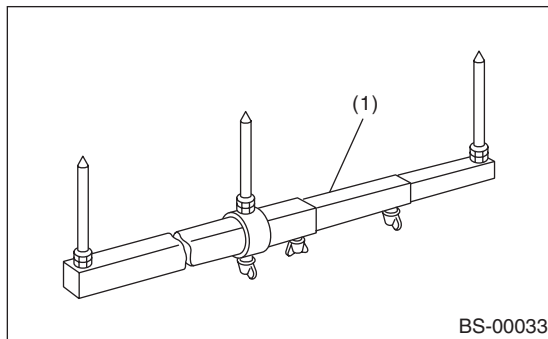

(1) Tram tracking gauge

- Measure at the center of the circle around the outside of the body panel.

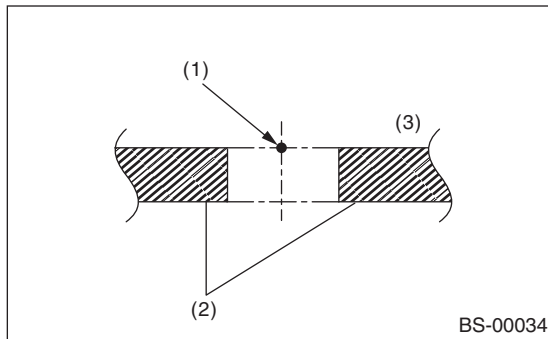

- (1) Datum points
- (2) Body panel
- (3) Outside

1. CENTER STRUCTURE

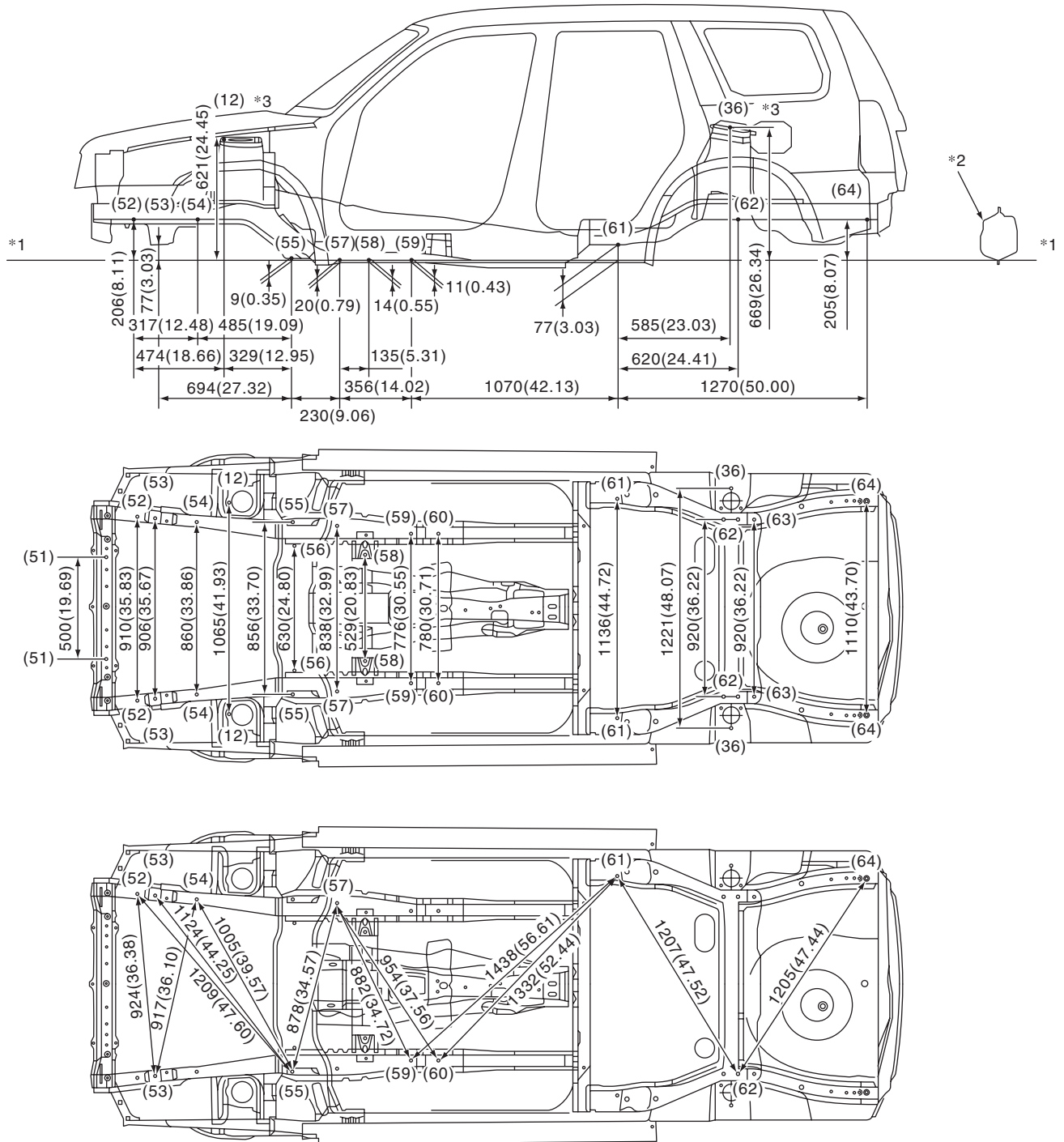

- *1: Standard Line
 - *2: Side sill
 - *3: Upper surface
- Unit: mm (in)

BS-00035

Datum Dimensions

BODY STRUCTURE

2. SUSPENSION CROSSMEMBER

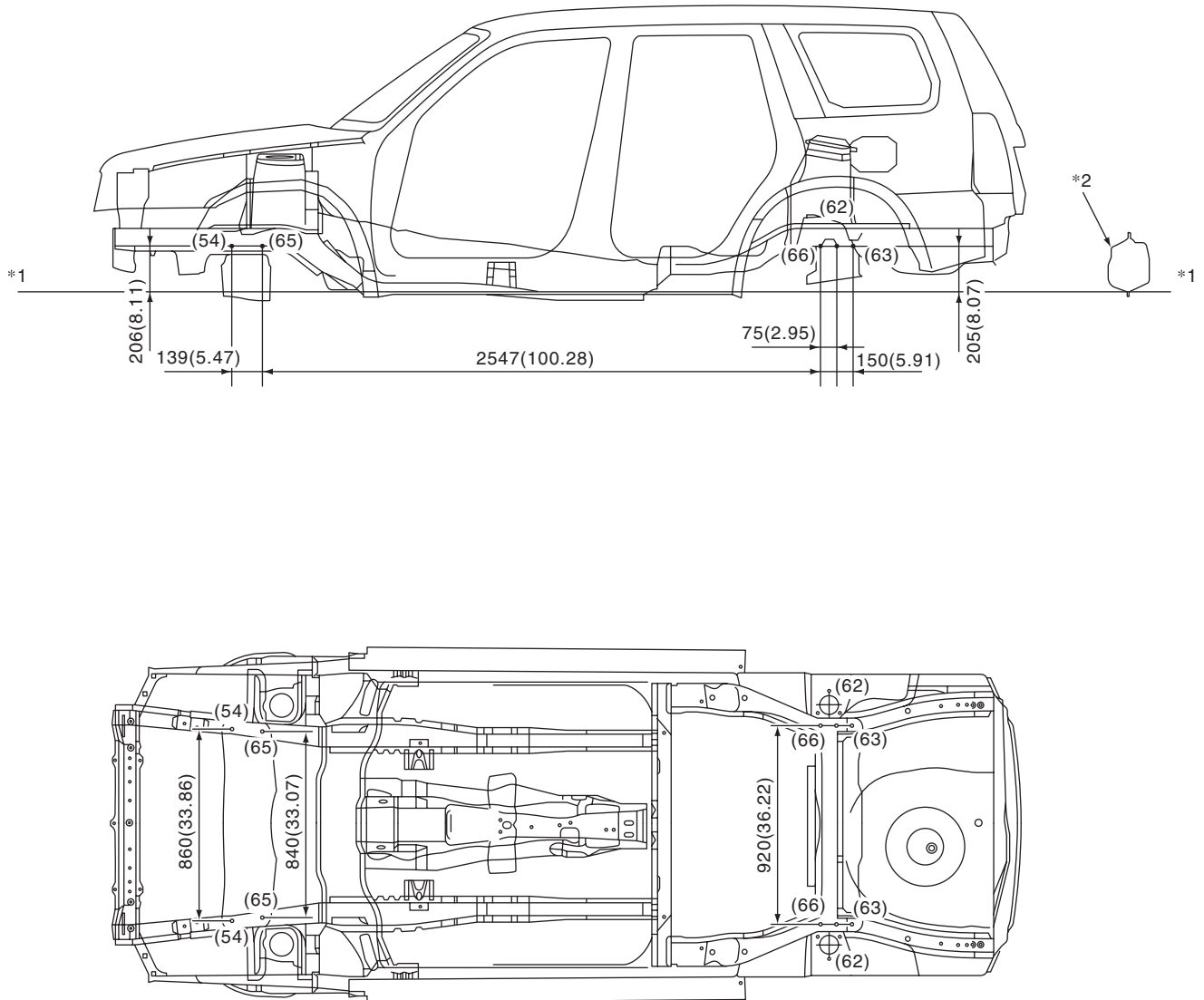

*1: Standard Line
*2: Side sill
Unit: mm (in)

BS-00036

3. FRONT STRUCTURE

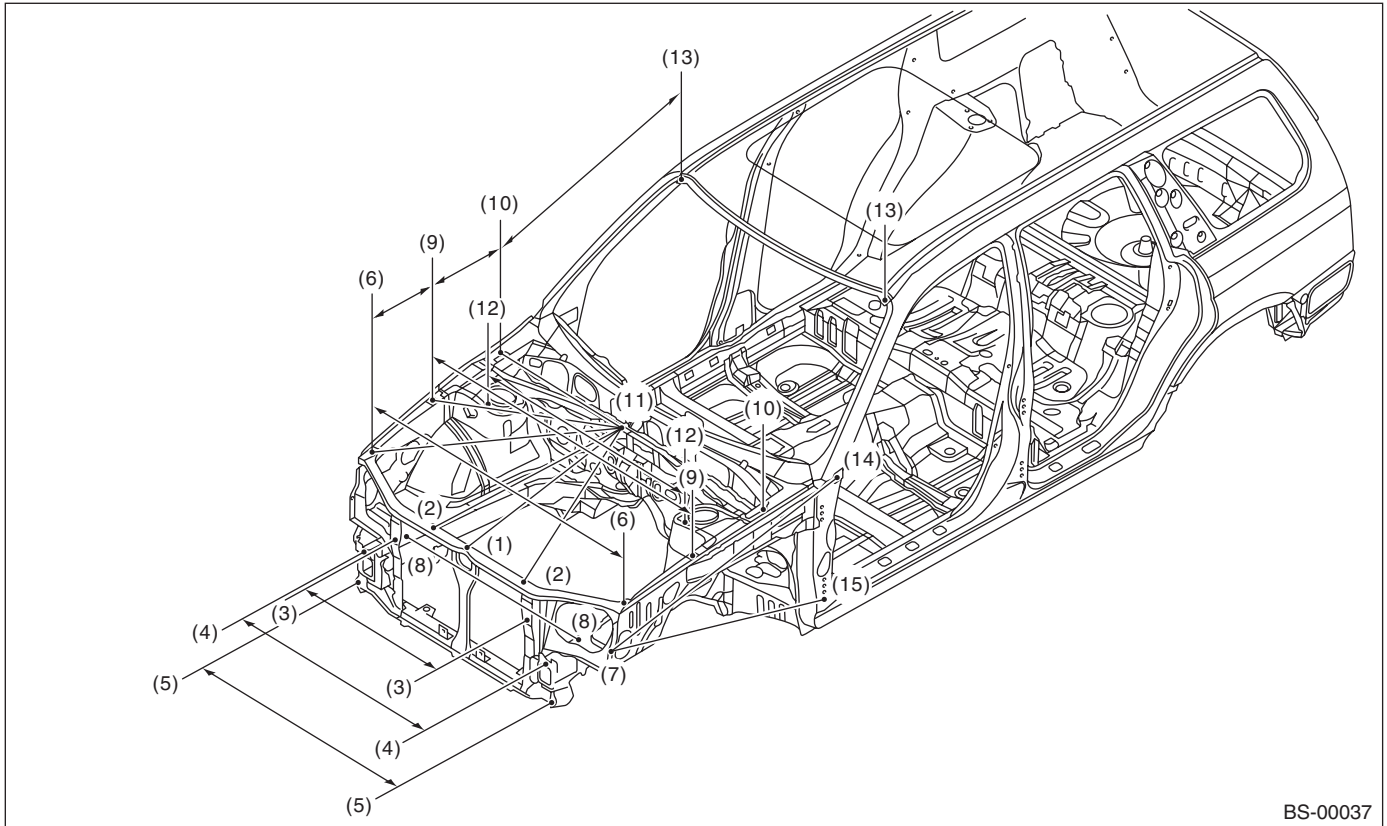

BS-00037

Unit: mm (in)			
Point of measurement	Dimension	Point of measurement	Dimension
(1) to (11)	822 (32.36)	(7) LH to (15) LH	1,092 (42.99)
(2) RH to (11)	842 (33.15)	(8) RH to (8) LH	921 (36.26)
(2) LH to (11)	875 (34.45)	(9) RH to (9) LH	1,396 (54.96)
(3) RH to (3) LH	716 (28.19)	(9) RH to (10) RH	398 (15.67)
(4) RH to (4) LH	978 (38.50)	(9) LH to (10) LH	398 (15.67)
(5) RH to (5) LH	1,049 (41.30)	(9) RH to (11)	767 (30.20)
(6) RH to (6) LH	1,341 (52.80)	(9) LH to (11)	767 (30.20)
(6) RH to (9) RH	349 (13.74)	(10) RH to (11)	722 (28.43)
(6) LH to (9) LH	349 (13.74)	(10) LH to (11)	722 (28.43)
(6) RH to (11)	944 (37.17)	(10) RH to (13) RH	907 (35.71)
(6) LH to (11)	944 (37.17)	(10) LH to (13) LH	907 (35.71)
(7) RH to (14) RH	1,184 (46.61)	(11) to (12) RH	565 (22.24)
(7) LH to (14) LH	1,184 (46.61)	(11) to (12) LH	565 (22.24)
(7) RH to (15) RH	1,092 (42.99)	(12) RH to (12) LH	1,065 (41.93)

Datum Dimensions

BODY STRUCTURE

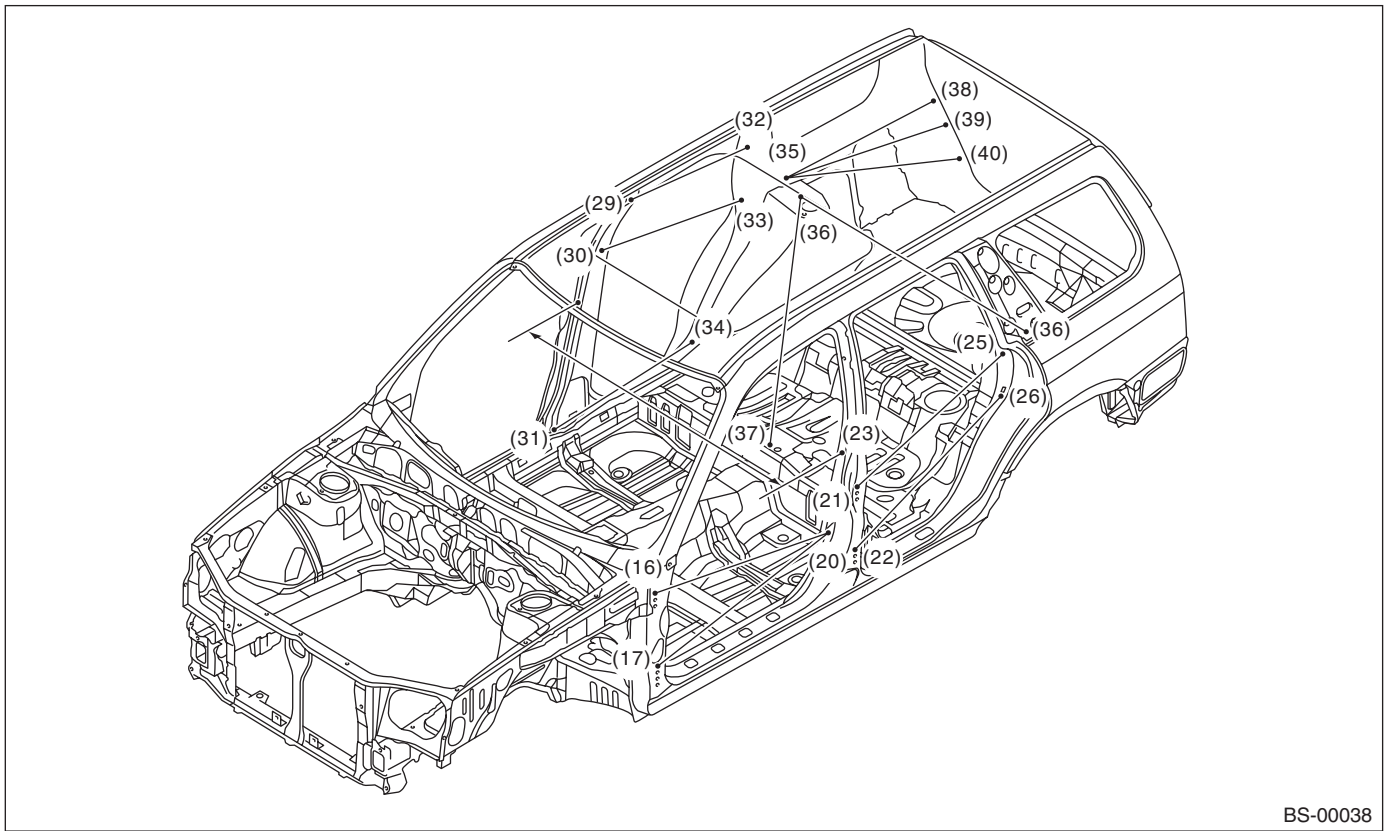

BS-00038

Unit: mm (in)			
Point of measurement	Dimension	Point of measurement	Dimension
(16) RH to (20) RH	980 (38.58)	(30) LH to (33) LH	796 (31.34)
(16) LH to (20) LH	980 (38.58)	(31) RH to (34) RH	759 (29.88)
(17) RH to (20) RH	982 (38.66)	(31) LH to (34) LH	759 (29.88)
(17) LH to (20) LH	982 (38.66)	(35) RH to (38) RH	665 (26.18)
(21) RH to (25) RH	853 (33.58)	(35) LH to (38) LH	665 (26.18)
(21) LH to (25) LH	853 (33.58)	(35) RH to (39) RH	711 (27.99)
(22) RH to (26) RH	895 (35.24)	(35) LH to (39) LH	711 (27.99)
(22) LH to (26) LH	895 (35.24)	(35) RH to (40) RH	784 (30.87)
(23) LH to (23) RH	1,429 (56.26)	(35) LH to (40) LH	784 (30.87)
(29) RH to (32) RH	674 (26.54)	(36) LH to (36) RH	1,221 (48.07)
(29) LH to (32) LH	674 (26.54)	(36) RH to (37) RH	1,067 (42.01)
(30) RH to (33) RH	796 (31.34)	(36) LH to (37) LH	1,067 (42.01)

4. REAR STRUCTURE

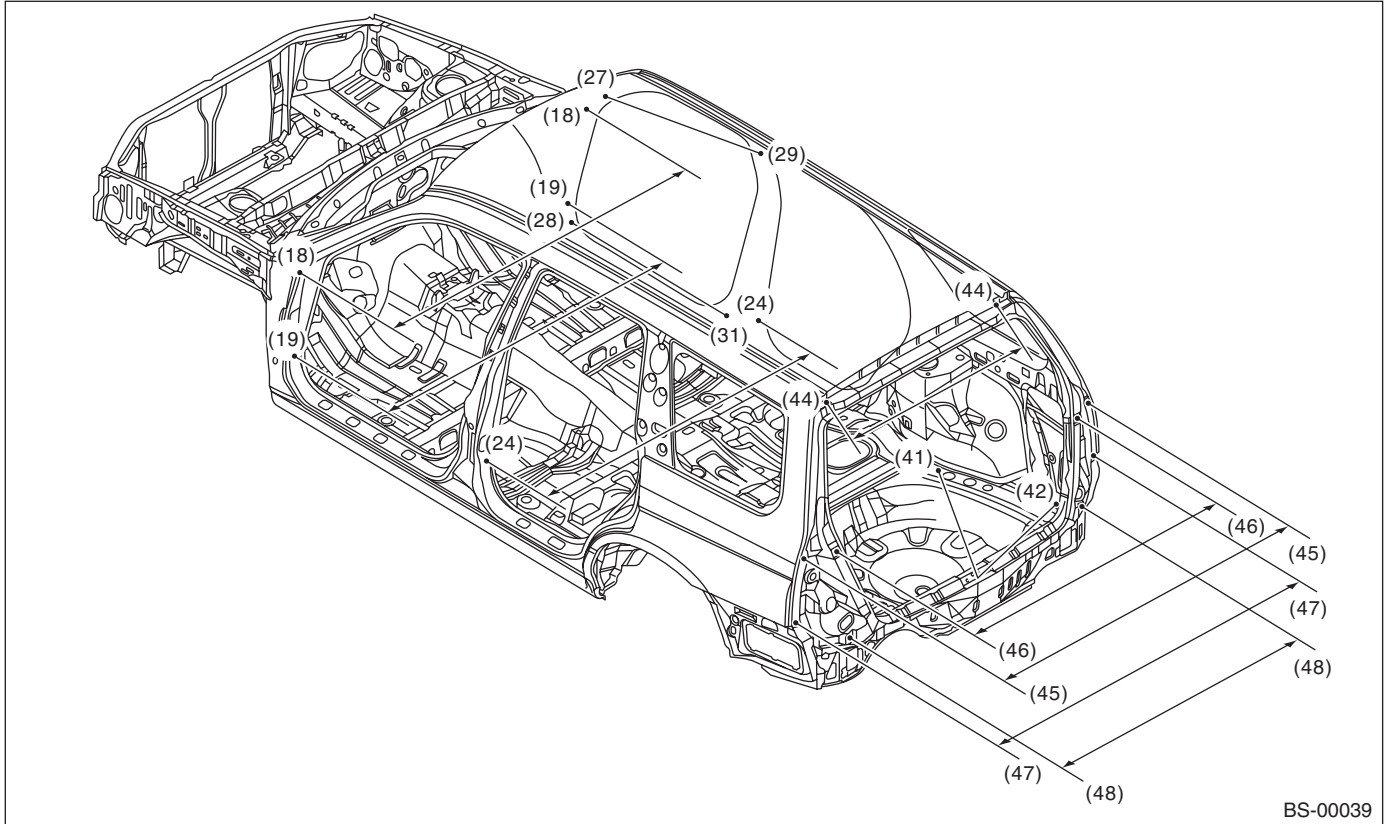

BS-00039

Unit: mm (in)			
Point of measurement	Dimension	Point of measurement	Dimension
(18) RH to (18) LH	1,449 (57.05)	(41) RH to (43) RH	794 (31.26)
(19) RH to (19) LH	1,459 (57.44)	(41) LH to (43) LH	805 (31.69)
(27) RH to (29) RH	1,007 (39.65)	(42) RH to (42) LH	1,110 (43.70)
(27) LH to (29) LH	1,007 (39.65)	(44) RH to (44) LH	878 (34.57)
(28) RH to (31) RH	813 (32.01)	(45) RH to (45) LH	1,474 (58.03)
(28) LH to (31) LH	813 (32.01)	(46) RH to (46) LH	1,252 (49.29)
(24) RH to (24) LH	1,438 (56.61)	(47) RH to (47) LH	1,552 (61.10)
(41) RH to (41) LH	950 (37.40)	(48) RH to (48) LH	1,210 (47.64)

Datum Dimensions

BODY STRUCTURE
