

## 7. Neutral Position Switch

### A: REMOVAL

- 1) Disconnect the ground cable from the battery.
- 2) Disconnect the connector from the neutral position switch, and remove the switch. <Ref. to 5MT-35, BACK-UP LIGHT SWITCH AND NEUTRAL POSITION SWITCH, REMOVAL, Switches and Harness.>

### B: INSTALLATION

Install in the reverse order of removal.

### C: INSPECTION

Measure the resistance of neutral position switch.

- Non-turbo model

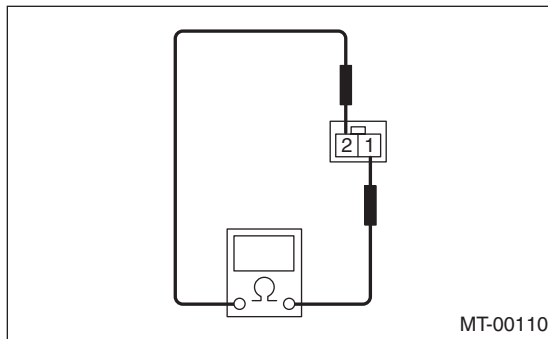

Gear shift position	Terminal No.	Specified resistance
Neutral position	1 and 2	Less than 1 $\Omega$
Other positions		Over 1 M $\Omega$

- Turbo model

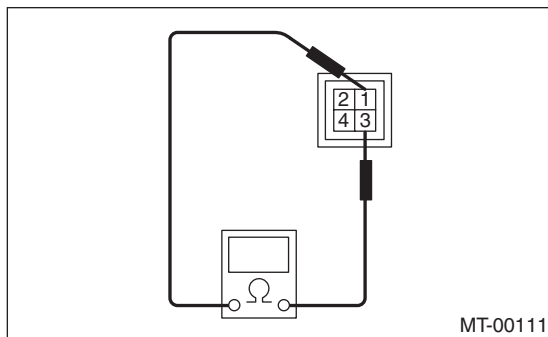

Gear shift position	Terminal No.	Specified resistance
Neutral position	1 and 3	Less than 1 $\Omega$
Other positions		Over 1 M $\Omega$

If NG, replace the neutral position switch.

# Neutral Position Switch

CRUISE CONTROL SYSTEM

---