

Front Door Glass

GLASS/WINDOWS/MIRRORS

9. Front Door Glass

A: REMOVAL

- 1) Remove the front door trim. <Ref. to EI-34, REMOVAL, Front Door Trim.>
- 2) Remove the front speaker. <Ref. to ET-8, REMOVAL, Front Speaker.>
- 3) Remove the sealing cover. <Ref. to EB-13, REMOVAL, Front Sealing Cover.>
- 4) Remove the outer mirror assembly. <Ref. to GW-12, REMOVAL, Outer Mirror Assembly.>
- 5) Remove the front end of door weather strip and gusset.

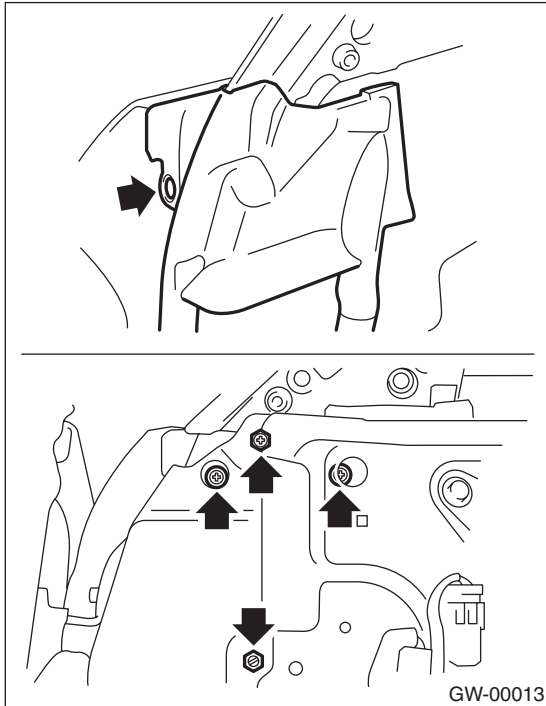

- 6) Remove the stabilizers.

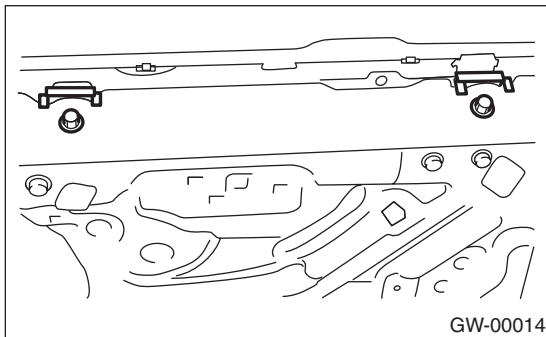

- 7) Remove the rear end of door weather strip and weather strip outer.

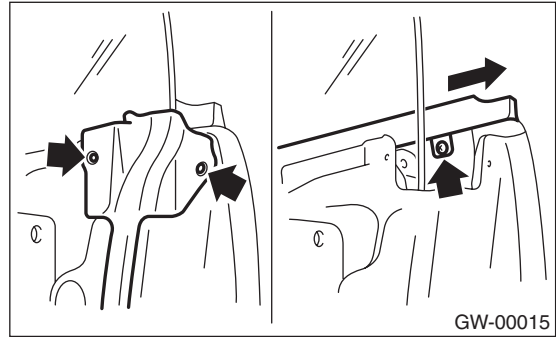

- 8) Operate the power window switch to move glass to position shown in the figure, and then remove the three nuts from the service holes.

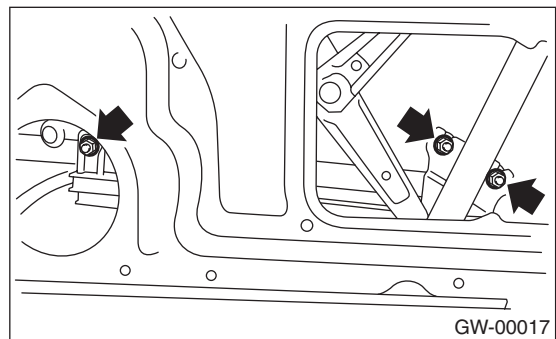

- 9) Remove the door glass.

CAUTION:

- Since the gear may be disengaged, do not turn regulator in the closing direction after removing glass.
- Avoid impact and damage to the glass.

B: INSTALLATION

- 1) Install in the reverse order of removal.

CAUTION:

Make sure that glass holder (front), holder guide, and slider of the regulator are placed securely in sash.

- 2) Adjust the front door glass. <Ref. to GW-17, ADJUSTMENT, Front Door Glass.>

Tightening torque:

Refer to "COMPONENT" of "General Description". <Ref. to GW-3, FRONT DOOR GLASS, COMPONENT, General Description.>

C: ADJUSTMENT

NOTE:

Before adjustment, ensure that all adjusting nuts of stabilizer, upper stopper and sash are loose, and door glass rises up to the point that it comes in contact with weather strip.

1) Temporarily tighten the adjusting nut on one side of rear sash at the midpoint of slotted hole in the inner panel.

2) Temporarily tighten the regulator B channel at the top position of slotted hole.

3) Lower the door glass 10 — 15 mm (0.39 — 0.59 in) from fully closed position. While applying an outward pressure (F) of 45.0 ± 5 N (4.6 ± 0.5 kgf, 10.1 ± 1.1 lb) to the upper edge of glass above midpoint of two outer stabilizers, press the inner stabilizer to the glass at a pressure of 25 ± 5 N (2.5 ± 0.5 kgf, 5.5 ± 1.1 lb) to secure it.

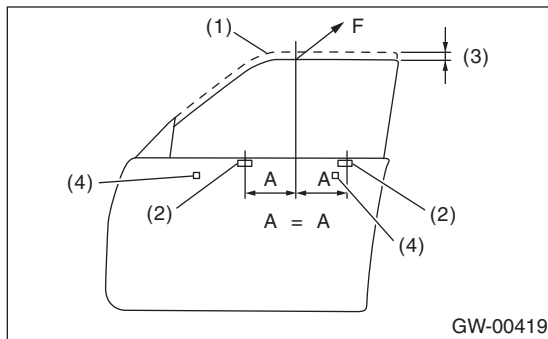

- (1) Fully closed position
- (2) Stabilizer
- (3) 10 — 15 mm (0.39 — 0.59 in)
- (4) Upper stopper

4) To adjust the clearance between front glass and center pillar cover, loosen the nuts (A), and move the rear sash back and forward until clearance becomes the value shown. (Difference up and down: Within 1.5 mm (0.059 in))

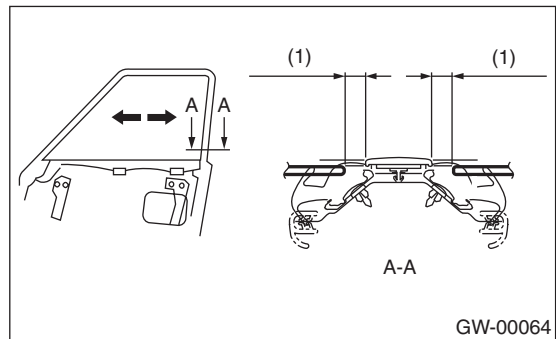
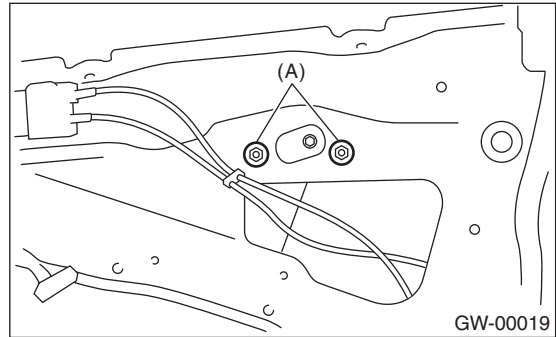

- (1) 12 ± 1 mm (0.472 ± 0.039 in)

5) For adjustment of the upper and lower ends of center pillar, loosen the adjusting nut (A) of B-channel (B).

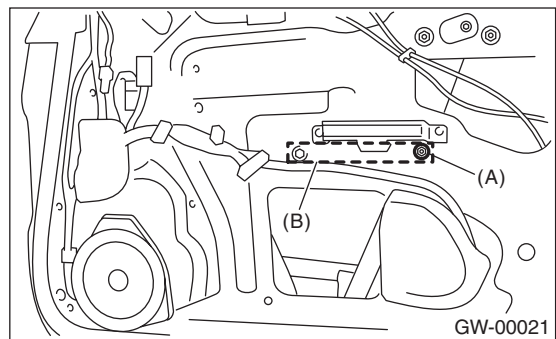

Front Door Glass

GLASS/WINDOWS/MIRRORS

6) Adjust so that the upper and lower ends of center pillar are the same size.

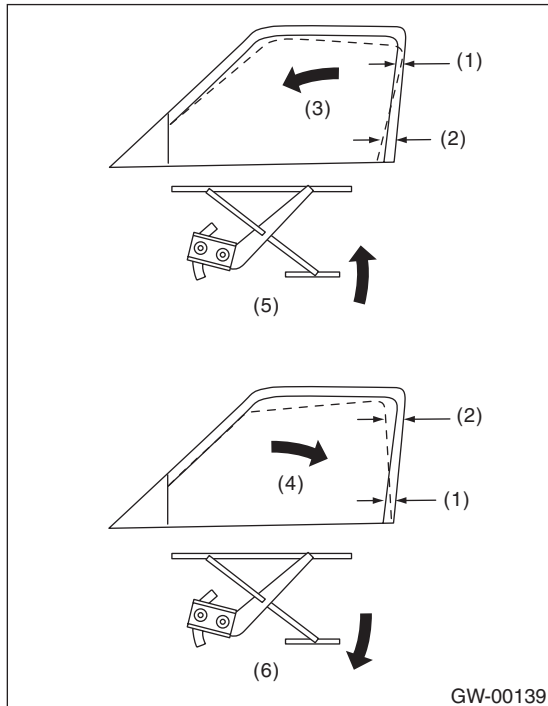

- (1) Narrow
- (2) Wide
- (3) Glass tilts too far rearward
- (4) Glass tilts too far forward
- (5) Raise B channel
- (6) Lower B channel

7) For glass stroke adjustment, attach special tool to the glass, close door, and raise the glass to the top edge using regulator until positional relationship between glass and weather strip becomes as shown. And secure the glass so that the upper stopper touches the glass holder without fail.

ST 61299AE000 SPACER (GLASS THICKNESS: 5 mm (0.197 in) FOR DOOR GLASS)

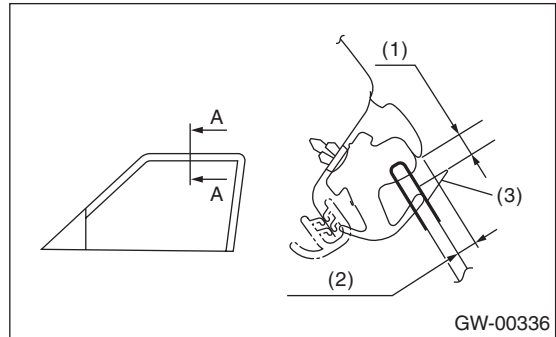

- (1) 2.2 — 3.8 mm (0.087±0.150 in)
- (2) When reusing the weather strip:
8.5 — 10.5 mm (0.335 — 0.413 in)
When replacing the weather strip:
7.5 — 9.5 mm (0.295 — 0.374 in)
- (3) ST

For preventing wind noise, adjust the glass at the position where tip of gusset is raised up a little.

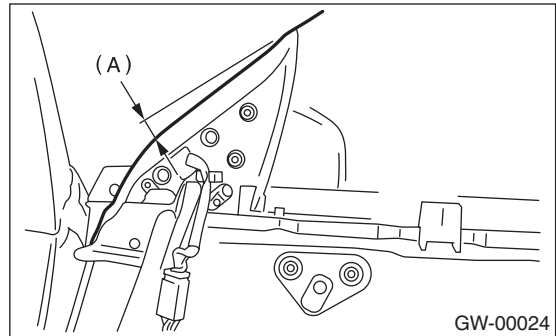

- (A) 0 — 1.5 mm (0 — 0.059 in)

8) After stabilizer adjustment, carry out glass cohesion adjustment. First, visually ensure positional relationship between retainer & molding and glass of the roof side, and then begin with rear sash adjustment. Adjust two adjusting bolts alternately step by step to obtain dimensions shown below (cross-section A).

NOTE:

If two nuts are loosened at the same time, the sash moves back and forth. Therefore, when one nut is adjusted, secure the other.

9) Make the same adjustment of two adjusting bolts of rear sash.

ST 61299AE000 SPACER (GLASS THICKNESS: 5 mm (0.197 in) FOR DOOR GLASS)

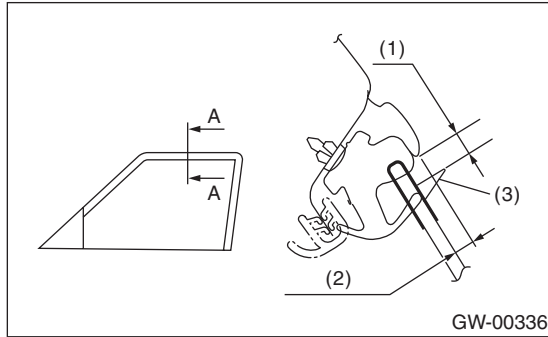

- (1) 2.2 — 3.8 mm (0.087±0.150 in)
- (2) When reusing the weather strip:
8.5 — 10.5 mm (0.335 — 0.413 in)
When replacing the weather strip:
7.5 — 9.5 mm (0.295 — 0.374 in)
- (3) ST

NOTE:

Do not tilt the sash bracket to inner panel during adjustment. If tilting, the regulator does not operate smoothly.

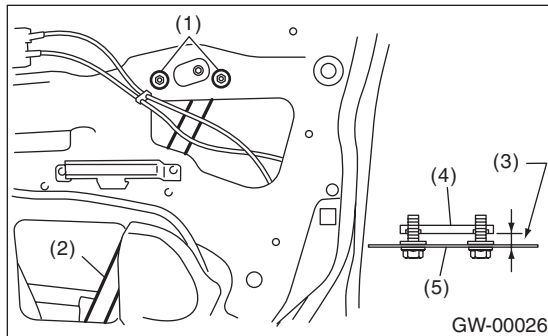

- (1) Sash bracket
- (2) Rear sash
- (3) Adjust the lines parallel
- (4) Rear sash
- (5) Inner panel

10) Make adjustment of front sash in the same manner as that of rear sash.

NOTE:

Although front and rear sashes must, as a rule, be adjusted in the same manner, in some door installation, the adjustment in a different manner may be required. However, adjustment of one sash to the maximum amount and the other to the minimum amount is not permitted. Such adjustment may result in applying excessive load against regulator.

11) After adjustments, tighten the nuts.

12) After adjustment of the glass, close the door. If there is a gap between outer lip of gusset and glass surface, adjust the gap with adjusting nut (A) in lower fitting part of gusset to prevent generation of wind noise.

13) During adjustment, loosen the other three clamping screws.

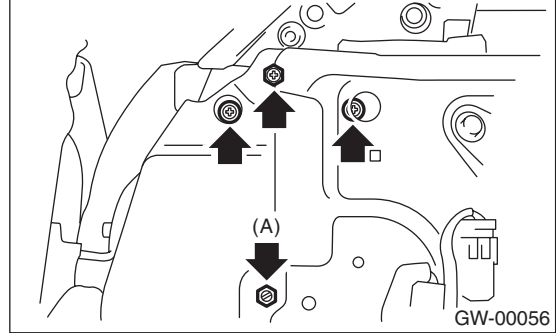

14) After adjustment, tighten the bolts and nuts.