

2. Front Seat

A: REMOVAL

1. DRIVER'S SEAT (STANDARD SEAT)

1) While pressing the headrest lock button, remove the headrest.

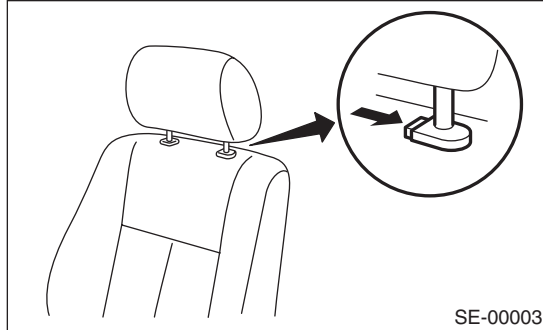

- 2) Tilt forward the backrest.
- 3) Slide the seat to the front end.
- 4) Remove the bolt cover at the rear end of slide rail, and remove the two bolts at the rear side of seat rail.

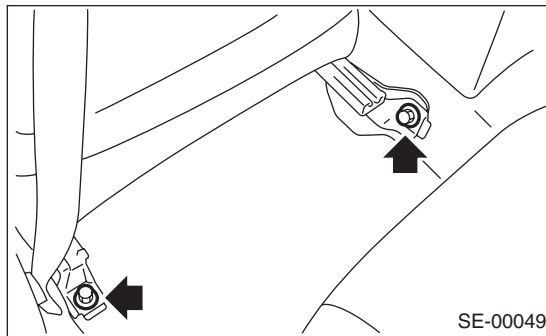

- 5) Slide the seat to the rear end.
- 6) Remove the two bolts at the front side of seat rail.

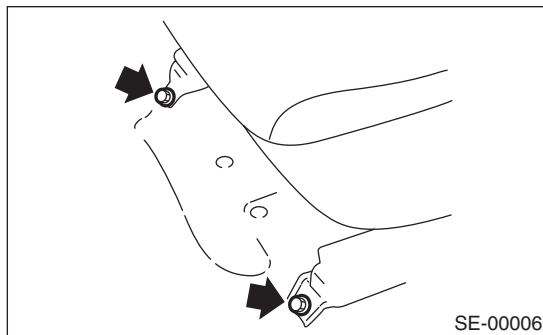

7) Disconnect the ground cable from the battery.

WARNING:

Perform airbag system maintenance at least 20 seconds have passed after removing the battery negative terminal. If the work is started within 20 seconds, the airbag may deploy due to the airbag system backup power supply.

8) Disconnect the connector under the seat.

- Side airbag connector
- Seat belt warning light connector
- Buckle switch connector
- Position sensor connector

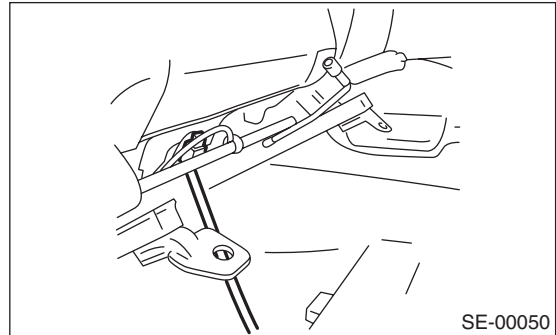

9) Remove the front seat from vehicle.

2. DRIVER'S SEAT (POWER SEAT)

1) While pressing the headrest lock button, remove the headrest.

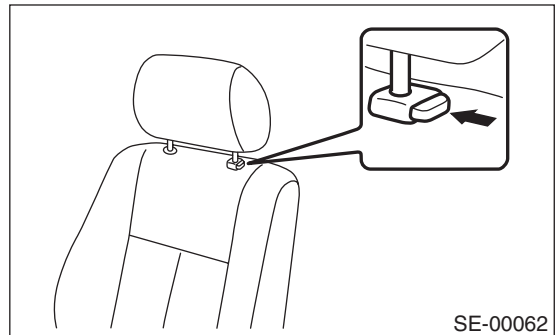

- 2) Tilt forward the backrest.
- 3) Slide the seat to the front end.
- 4) Remove the bolt cover at the rear end of slide rail.

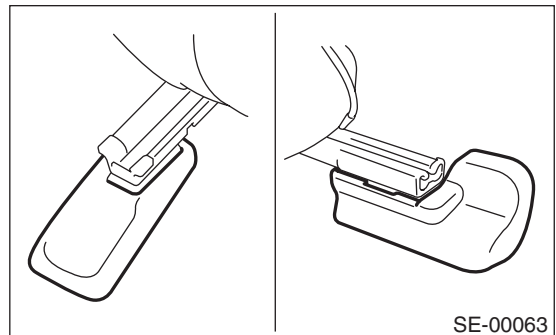

Front Seat

SEATS

5) Remove the two bolts at the rear side of seat rail.

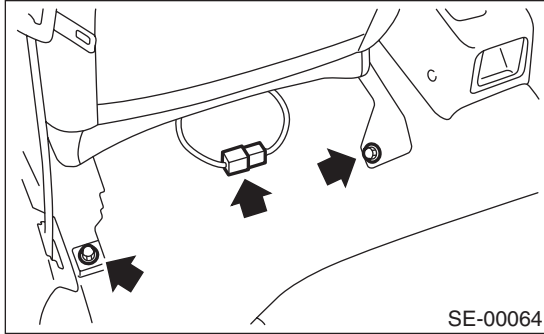

6) Slide the seat to the rear end.

7) Remove the two bolts at the front side of seat rail.

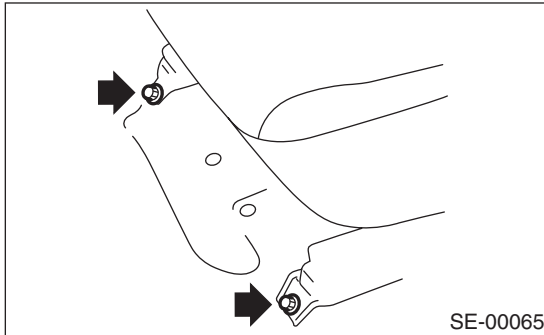

8) Disconnect the ground cable from the battery.

WARNING:

Perform airbag system maintenance at least 20 seconds have passed after removing the battery negative terminal. If the work is started within 20 seconds, the airbag may deploy due to the airbag system backup power supply.

9) Disconnect the connector under the seat.

- Side airbag connector
- Buckle switch connector
- Position sensor connector

10) Disconnect the integrated connector.

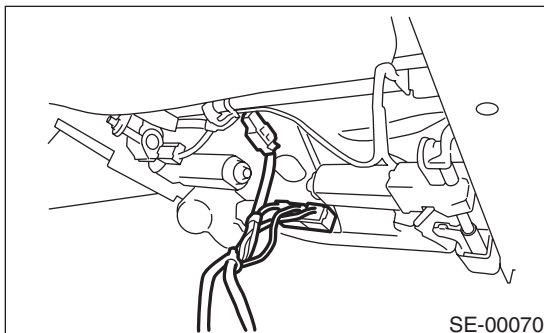

11) Remove the front seat from vehicle.

CAUTION:

Be careful not to damage the body, seat or trim when removing the seat from the vehicle.

3. PASSENGER'S SEAT

CAUTION:

Refer to "CAUTION" of "General Description" before starting the work. <Ref. to SE-6, CAUTION, General Description.>

1) Disconnect the ground cable from the battery.

WARNING:

Perform airbag system maintenance at least 20 seconds have passed after removing the battery negative terminal. If the work is started within 20 seconds, the airbag may deploy due to the airbag system backup power supply.

2) Remove the headrest.

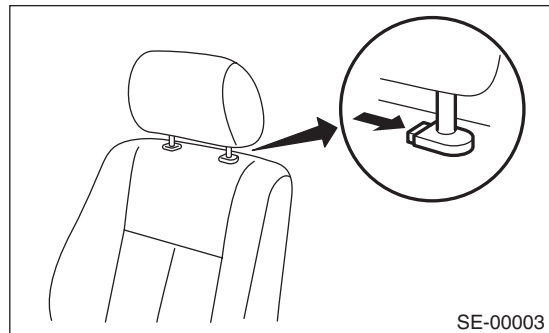

3) Tilt the backrest forward, and move the seat forward.

4) Remove the rear bolt cover, and then remove the rear side of slide rail.

5) Move the seat backward, remove the front bolt cover, and then remove the bolt at the front side of slide rail.

6) Disconnect all the connectors of connector holder in the backside of seat cushion.

- Harness connector of occupant detection control module
- Side airbag connector
- Seat heater connector (model with seat heater)

7) Remove the seat from vehicle.

B: INSTALLATION

Install in the reverse order of removal.

NOTE:

Tighten the slide rail installing bolt gradually in several steps to the specified torque in the order as shown in the figure.

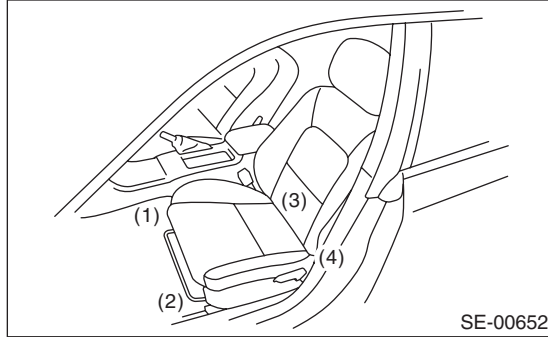

CAUTION:

1. Driver's seat

After installing the driver's seat, use the Subaru Select Monitor to confirm that the seat position sensor LH is operating properly. <Ref. to AB(diag)-30, DISPLAY OF STATUS INFORMATION, OPERATION, Subaru Select Monitor.>

2. Passenger's seat

Be sure to perform system calibration for the occupant detection system after passenger's seat installation. <Ref. to OD(diag)-17, SYSTEM CALIBRATION (REZEROING), OPERATION, Subaru Select Monitor.>

Failure to do so may cause improper operation of the occupant detection system.

Tightening torque:

Refer to "COMPONENT" of "General Description". <Ref. to SE-2, FRONT SEAT, COMPONENT, General Description.>

C: DISASSEMBLY

1. DRIVER'S SEAT

STANDARD SEAT

1) Remove the seat from vehicle. <Ref. to SE-7, REMOVAL, Front Seat.>

2) Remove the reclining lever cover and reclining hinge cover.

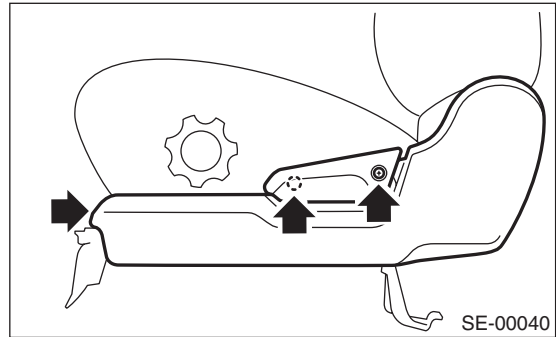

3) Loosen the screws to remove hinge cover.

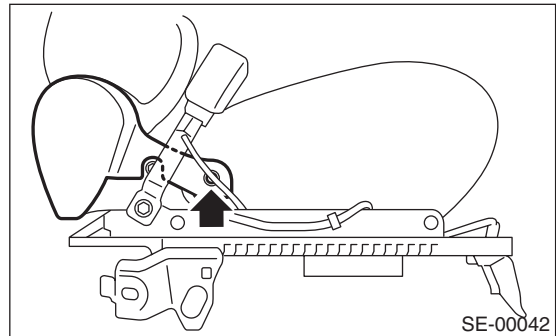

4) Remove the two bolts from the reclining hinge on each left and right side.

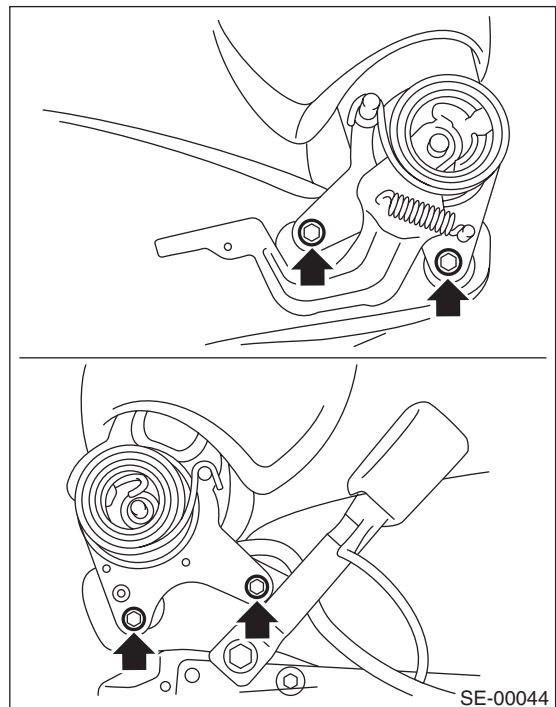

Front Seat

SEATS

5) Remove the hook at bottom of seat backrest.

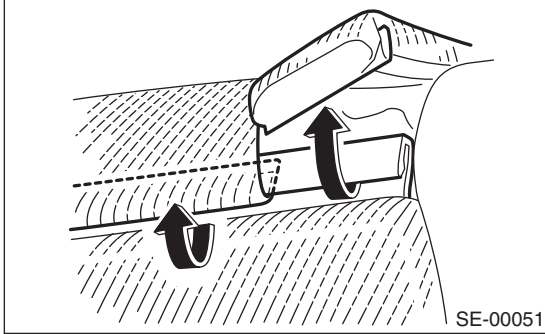

6) Open the fastener at the rear side of backrest.

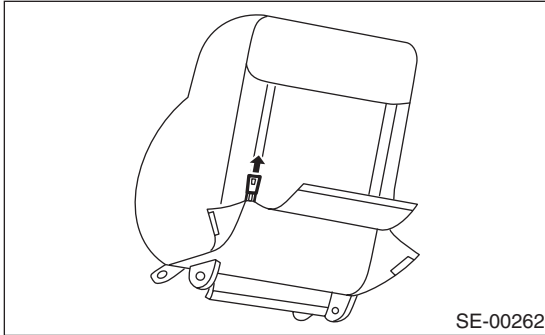

7) Remove the hog rings (A) on the front side of backrest from the backrest frame. (Seat with side airbag)

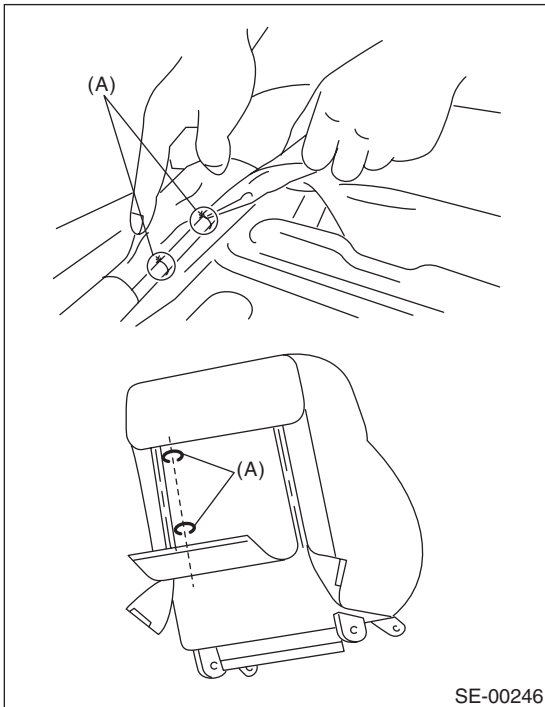

8) Remove the hog ring (A) which secures the backrest cover and backrest pad.

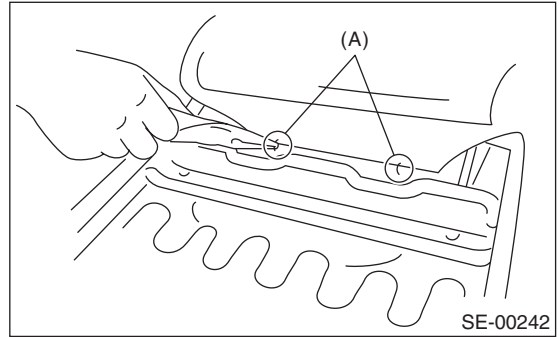

9) Remove the headrest bushing.

NOTE:

Push outside to remove it from the inside of seat.

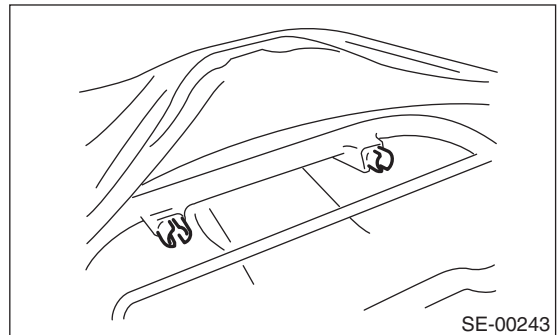

10) Pull out the backrest frame.

11) Remove the lower hog rings (A) on the front side of backrest.

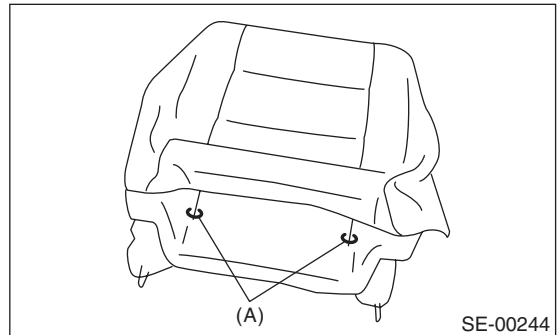

12) Remove the hog rings (A) on the front side of backrest, and then remove the backrest cover from backrest.

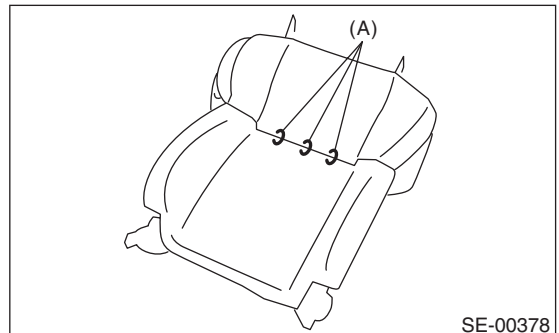

13) Remove the connecting wire (A), then loosen the bolt and nuts to remove slide rail.

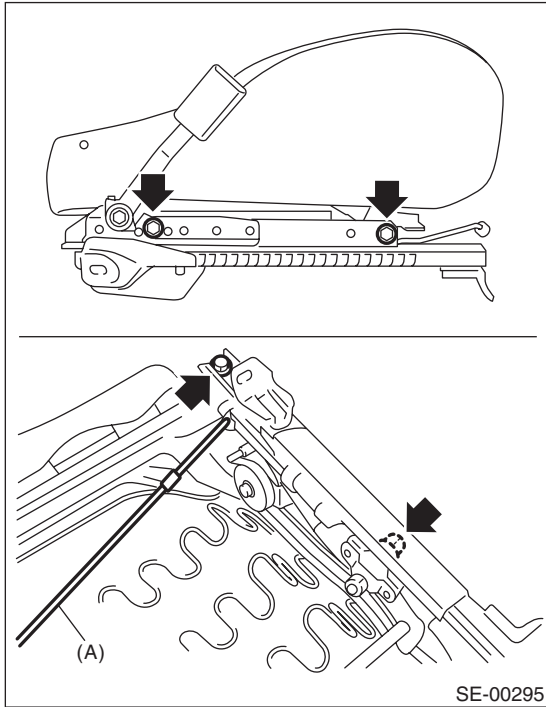

SE-00295

14) Remove the inner seat belt assembly.

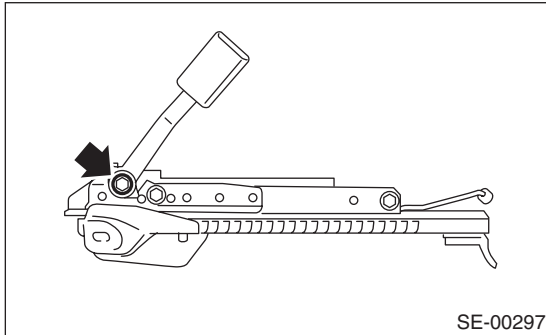

SE-00297

15) Remove the hooks (A), and then remove the seat cushion frame.

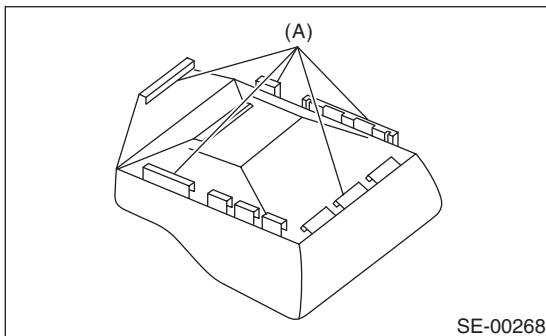

SE-00268

16) Remove the hog rings (A), and then remove the seat cushion cover from seat cushion pad.

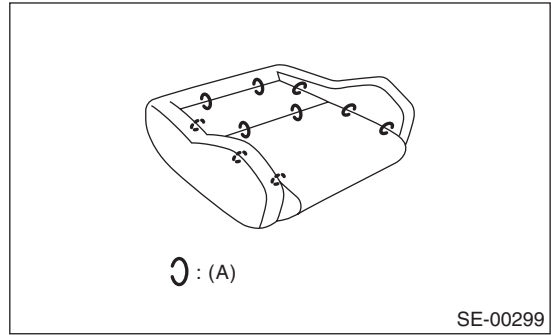

SE-00299

17) Open the fastener on the bottom of the headrest, then remove the headrest cover from the headrest.

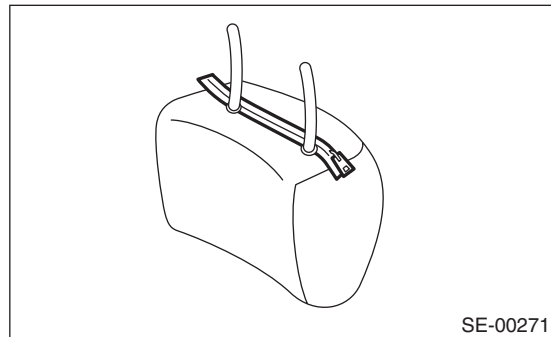

SE-00271

POWER SEAT

- 1) Remove the seat from vehicle. <Ref. to SE-7, REMOVAL, Front Seat.>
- 2) Remove the seat switch knob.

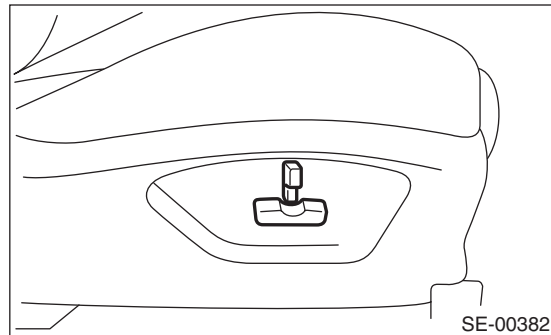

SE-00382

3) Disconnect the connector of reclining motor from the backside of seat cushion.

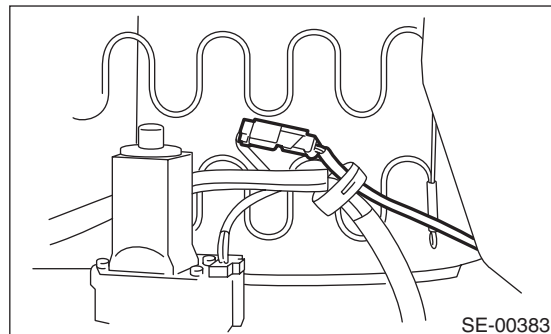

SE-00383

Front Seat

SEATS

4) Remove the screw (A) and clips (B), and then disconnect the seat switch connector to remove seat hinge outer cover.

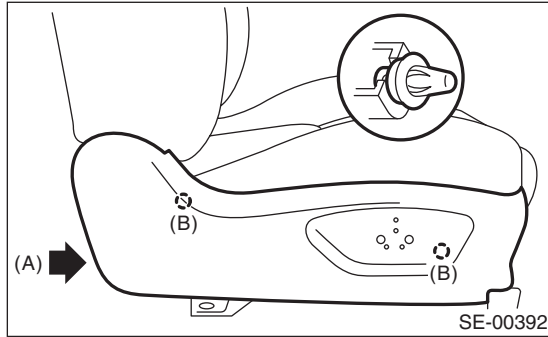

5) Remove the screw (A) and clip (B), and then remove the seat hinge inner cover.

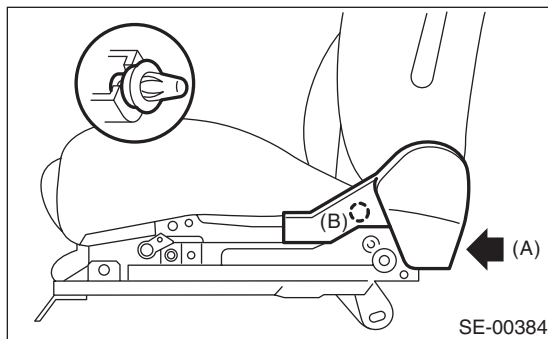

6) Remove the bolts, and then detach the inner seat belt assembly.

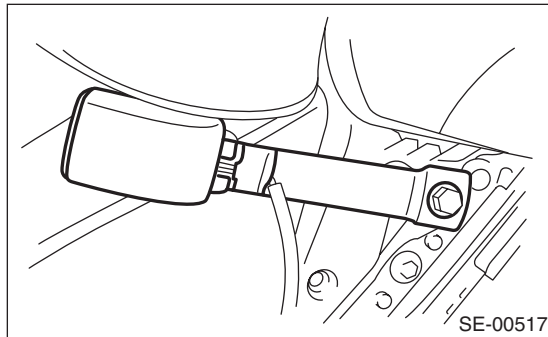

7) Remove the two bolts from the reclining hinge on each left and right side.

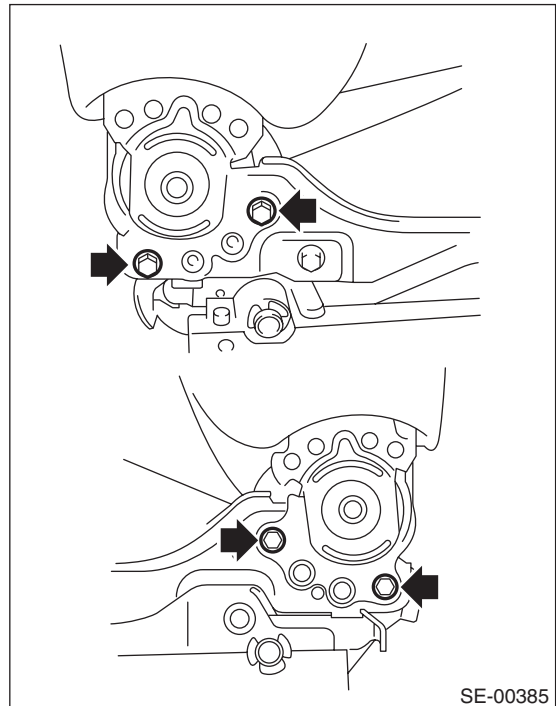

8) Remove the hook at bottom of seat backrest.

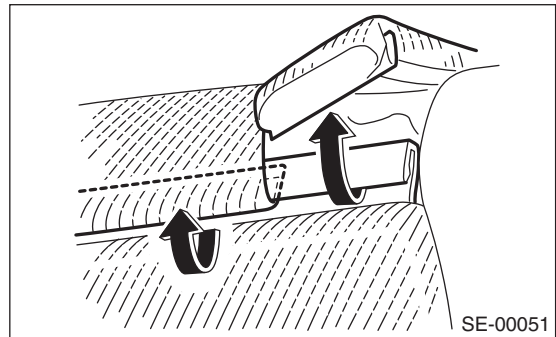

9) Open the fastener at the rear side of backrest.

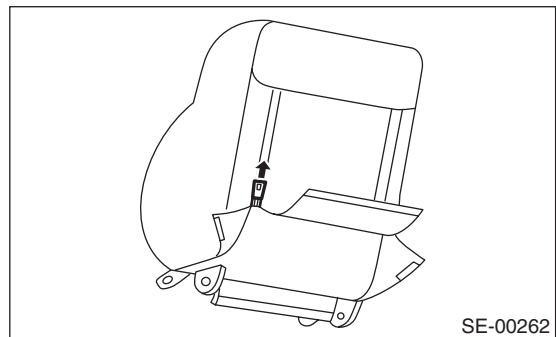

10) Remove the hog rings (A) on the front side of backrest from the backrest frame. (Seat with side airbag)

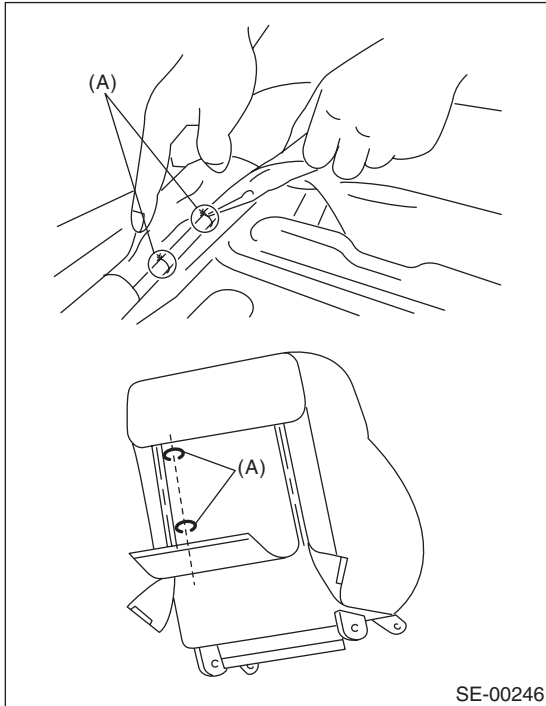

11) Remove the hog ring (A) which secures the backrest cover and backrest pad.

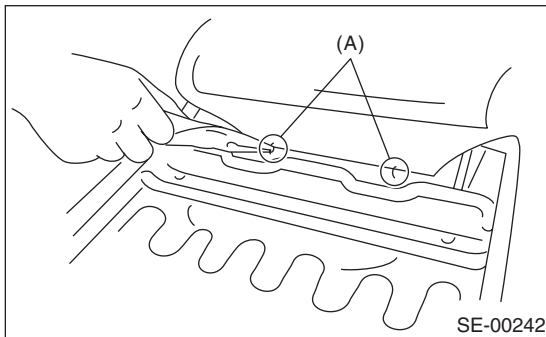

12) Remove the headrest lock bushing.

NOTE:

Push outside to remove it from the inside of seat.

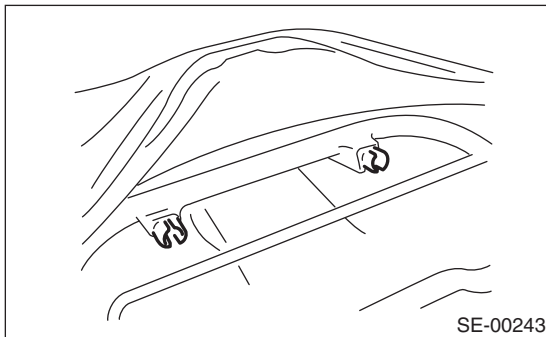

13) Pull out the backrest frame assembly.

14) Remove the two bolts on each left and right side, and then remove the reclining motor assembly.

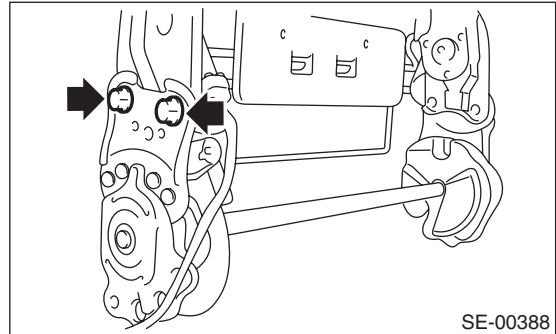

15) Remove the hog rings (A) on the surface side of backrest, and then remove the backrest cover from backrest.

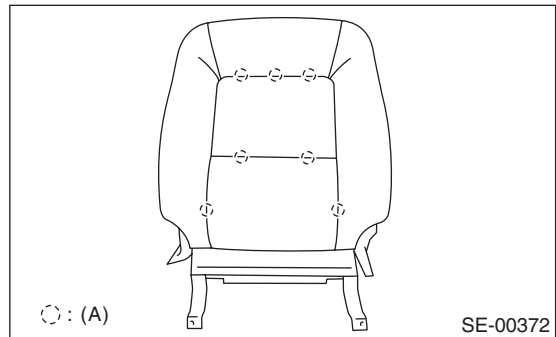

16) Remove the clip (A) and straps (B) on the back of seat cushion.

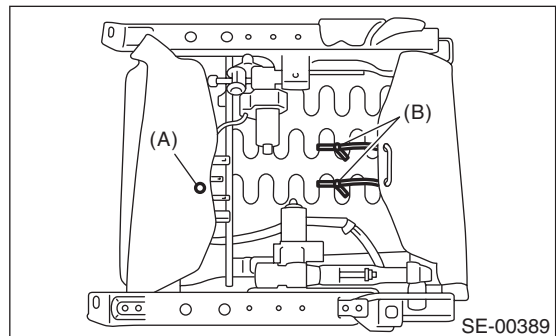

17) Remove the bolt (A) and hook (B) on left and right side, and then remove the seat cushion frame from seat rail assembly.

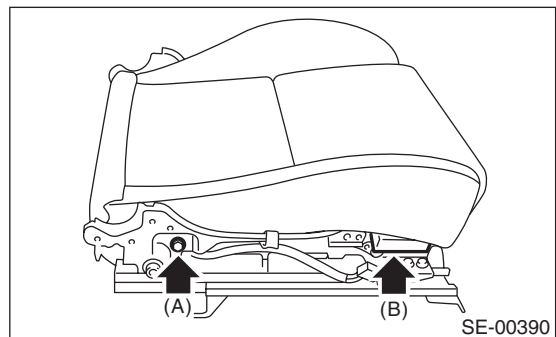

Front Seat

SEATS

18) Remove the hooks (A), and then remove the seat cushion from seat cushion frame.

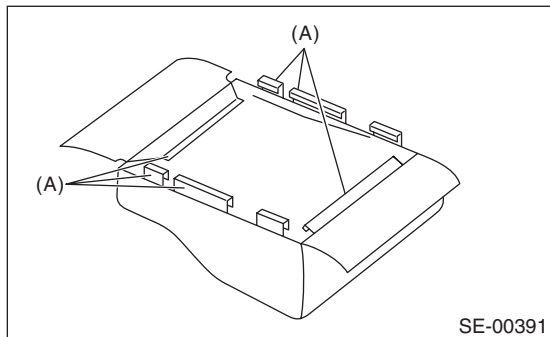

19) Remove the hog rings (A), and then remove the seat cushion cover from seat cushion pad.

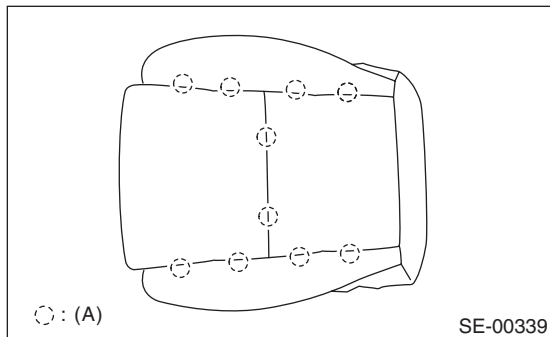

20) Remove the hooks and hog rings at the bottom of headrest, and then remove the headrest cover from headrest.

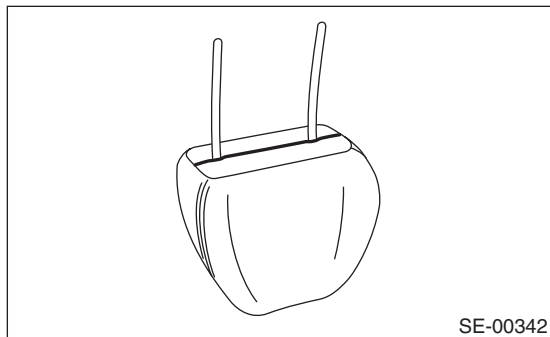

2. PASSENGER'S SEAT

CAUTION:

• If the seat cushion cover is removed or replaced, make sure to perform occupant detection system adjustment after installing the seat. <Ref. to OD(diag)-17, SYSTEM CALIBRATION (REZEROING), OPERATION, Subaru Select Monitor.>

Failure to do so may cause improper activation of passenger's airbag.

• For the passenger's seat, never remove the occupant detection control module and occupant detection sensor from the seat cushion frame. These all are the parts of occupant detection cushion assemblies.

• If the seat cushion cover is removed (including when replacing the heater), always replace the wires of the seat cushion cover with new wires.

- 1) Remove the seat from vehicle.
- 2) Remove the reclining lever cover.

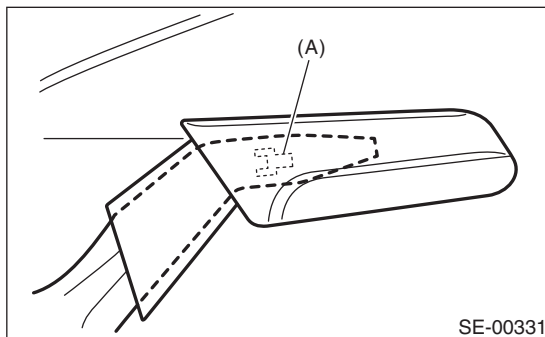

3) Remove the screw (A), clip (B) and claw (C), and then remove the seat side cover outside.

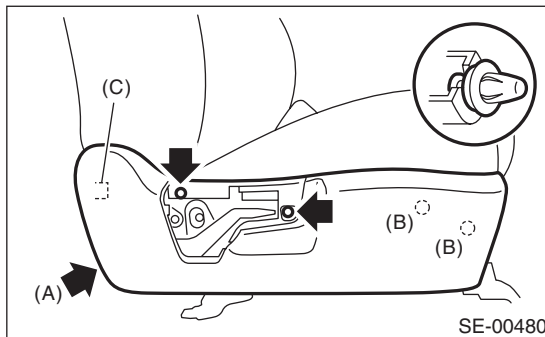

4) Remove the screw (A) and claw (B), and then remove the seat side cover inside.

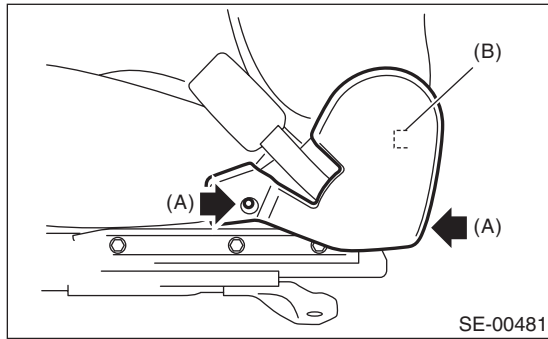

5) Remove TORX® bolt, and then detach the inner seat belt assembly.

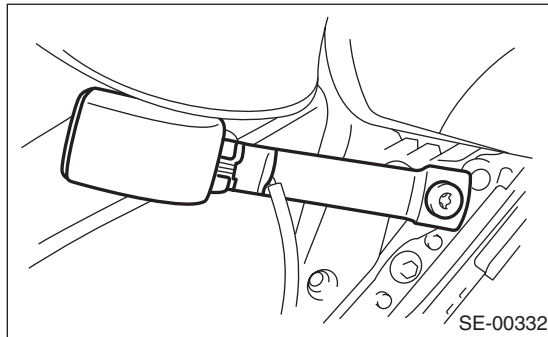

6) Remove the two reclining hinge bolts on each of the left and right sides.

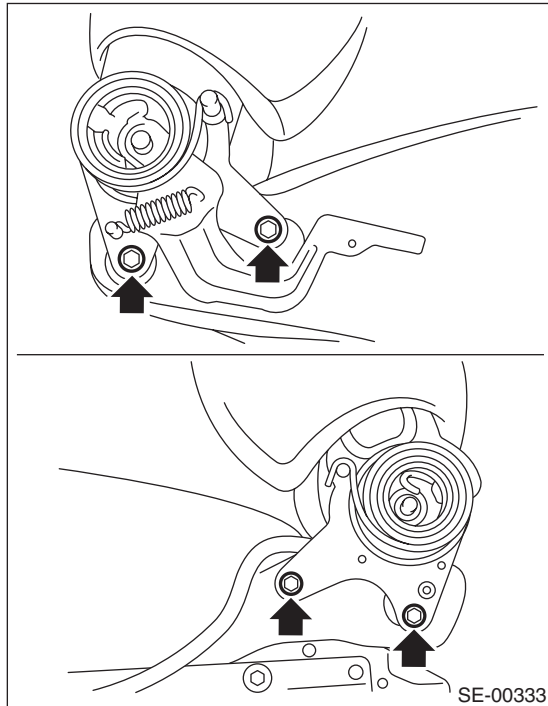

7) Remove the seat cushion pad and cover from seat cushion frame assembly.

8) Remove the hog rings (A), and then remove the seat cushion cover from seat cushion pad.

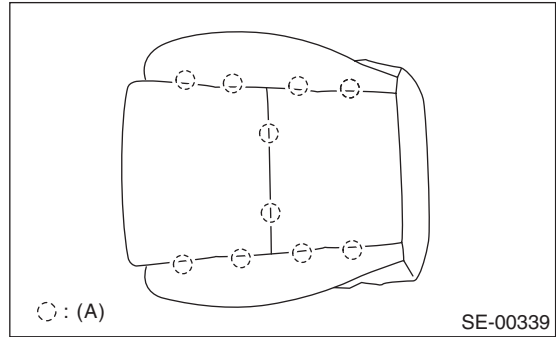

9) Refer to "DRIVER'S SEAT" for disassembly procedures of backrest and headrest.

D: ASSEMBLY

CAUTION:

When the backrest cover is not installed securely, the side airbag module may not be deployed properly, therefore keep strictly to the following procedure.

- Be careful not to stain or damage the backrest cover during assembly.
- Do not reuse hog rings.
- Secure the hog ring using hog ring pliers.
- Install the hog rings to the specified points securely and make sure that no wrinkle or twisting on backrest cover.

1. DRIVER'S SIDE

Assemble in the reverse order of disassembly.

2. PASSENGER'S SIDE

CAUTION:

- If the seat cushion cover is removed or replaced, make sure to perform occupant detection system adjustment after installing the seat. <Ref. to OD(diag)-17, SYSTEM CALIBRATION (REZEROING), OPERATION, Subaru Select Monitor.>

- Failure to do so may cause improper activation of passenger's airbag.

1) Assemble the seat cushion in the reverse order of disassembly.

2) Assemble the backrest in the reverse order of disassembly.

3) When installing the backrest assembly to the seat cushion assembly, fill the gap in the front side of slide rail LH and in the rear side of slide rail RH with cloth etc. in order to stabilize the seat cushion assembly.

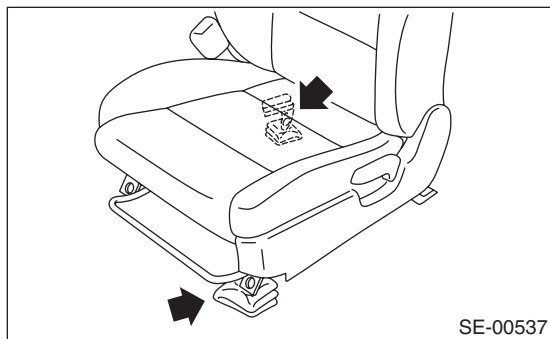

4) Temporarily tighten the reclining hinge bolts in the order of (1) through (4) to an extent that the seat backrest assembly is not held securely.

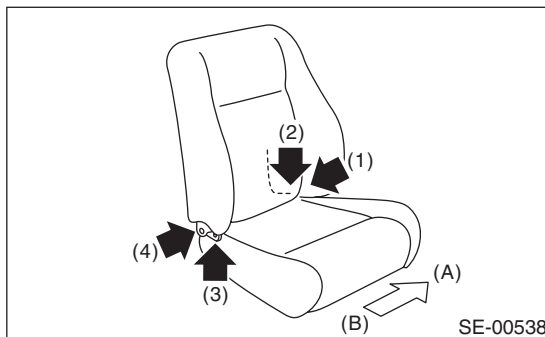

(A) Inside the vehicle

(B) Outside the vehicle

5) Use the reclining lever to place the backrest in the most upright position, and check the first lock position of recliner.

6) Hold the seat cushion assembly securely, and tighten the reclining hinge bolts in the order described above until they reach the specified torque.

CAUTION:

Do not touch the backrest assembly when tightening the reclining hinge bolts.

7) Assemble each harness, inner seat belt assembly and each cover in the reverse order of removal.

Tightening torque:

Refer to "COMPONENT" of "General Description". <Ref. to SE-2, FRONT SEAT, COMPONENT, General Description.>

E: INSPECTION

Check that no tear or fray is on the backrest cover assembly.

NOTE:

When the door side of backrest cover assembly is torn or frayed, the side airbag may not be deployed properly. Replace it with new part in such a case.