

# Wastegate Control Solenoid Valve

FUEL INJECTION (FUEL SYSTEMS)

## 14. Wastegate Control Solenoid Valve

### A: REMOVAL

1) Disconnect the ground cable from the battery.

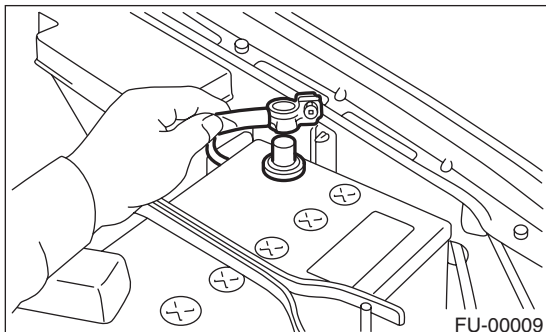

2) Remove the engine harness connector (A) from bracket.

3) Disconnect the connector (B) from wastegate control solenoid valve.

4) Remove the front oxygen (A/F) sensor connector (C) from the bracket.

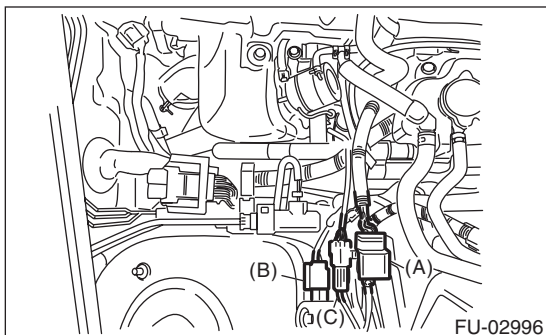

5) Remove the bracket from vehicle body.

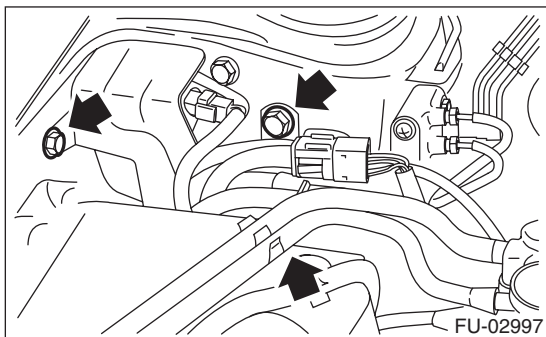

6) Disconnect pressure hose (D) from the wastegate control solenoid valve.

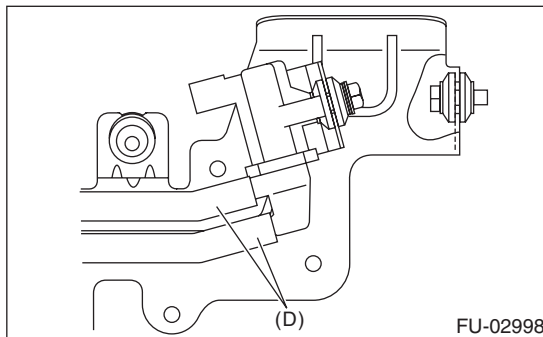

7) Remove the wastegate control solenoid valve from the bracket.

### B: INSTALLATION

Install in the reverse order of removal.

**Tightening torque:**

**6.5 N·m (0.66 kgf-m, 4.8 ft-lb)**

