

Front Oxygen (A/F) Sensor

FUEL INJECTION (FUEL SYSTEMS)

15. Front Oxygen (A/F) Sensor

A: REMOVAL

- 1) Set the vehicle on a lift.
- 2) Disconnect the ground cable from the battery.

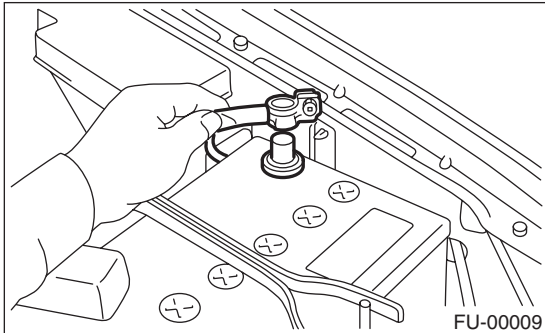

- 3) Disconnect the connector from front oxygen (A/F) sensor.

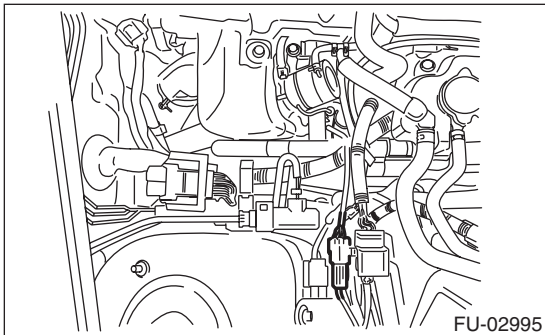

- 4) Disconnect the engine harness fixed by clip (A) from the bracket (B).

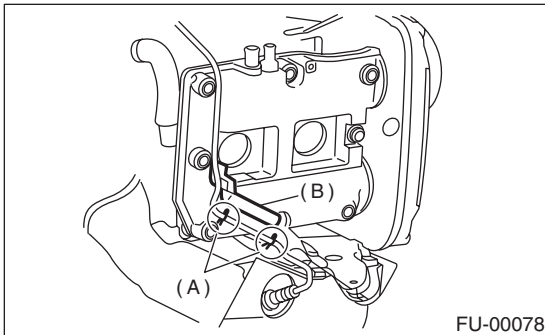

- 5) Remove the front right side wheel.
- 6) Lift-up the vehicle.
- 7) Remove the service hole cover.

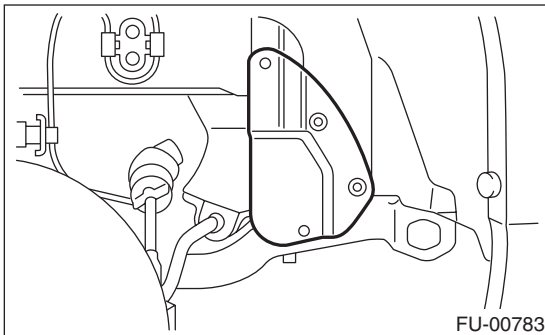

- 8) Apply spray-type lubricant to the threaded portion of front oxygen (A/F) sensor, and leave it for one minute or more.
- 9) Remove the front oxygen (A/F) sensor.

CAUTION:

When removing the oxygen (A/F) sensor, wait until exhaust pipe cools, otherwise it will damage the exhaust pipe.

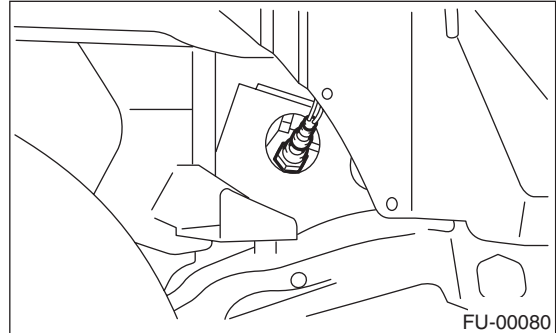

B: INSTALLATION

- 1) Before installing front oxygen (A/F) sensor, apply the anti-seize compound only to the threaded portion of front oxygen (A/F) sensor. This facilitates the next removal.

Anti-seize compound:

NEVER-SEEZ NSN, JET LUBE SS-30 or the equivalent

CAUTION:

Never apply anti-seize compound to the protector of front oxygen (A/F) sensor.

- 2) Install the front oxygen (A/F) sensor.

Tightening torque:

30 N·m (3.1 kgf-m, 22.1 ft-lb)

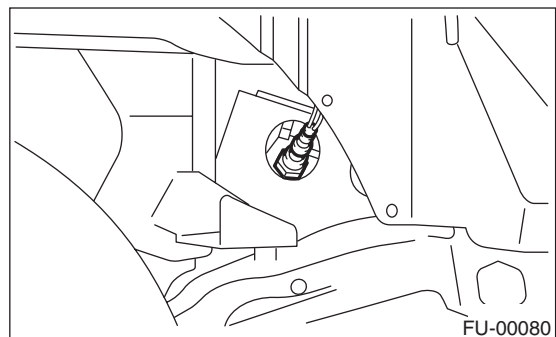

Front Oxygen (A/F) Sensor

FUEL INJECTION (FUEL SYSTEMS)

3) Install the service hole cover.

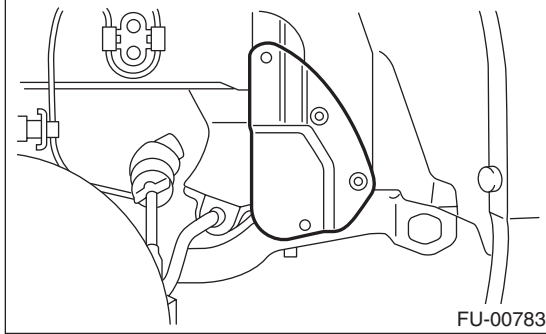

4) Lower the vehicle.

5) Install the front right side wheel.

Tightening torque:

100 N·m (10.2 kgf-m, 73.8 ft-lb)

6) Connect the engine harness to the bracket (B) using the clip (A).

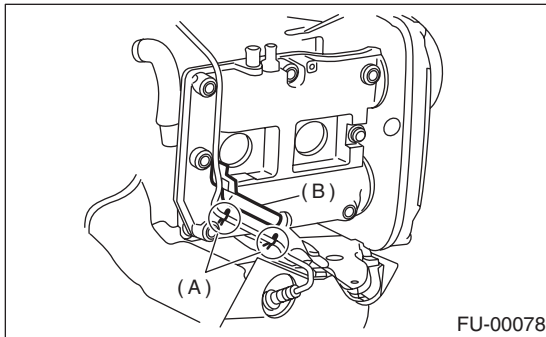

7) Connect the connector of front oxygen (A/F) sensor.

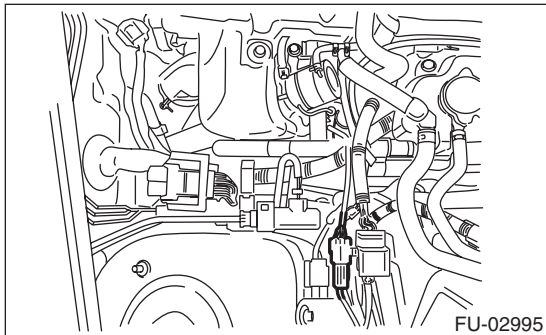

8) Connect the ground cable to the battery.

