

## 11. Coolant Filler Tank

### A: REMOVAL

#### NOTE:

Mount the coolant filler tank only to the turbo model.

#### WARNING:

**The radiator is pressurized. Wait until engine cools down before working on the radiator.**

- 1) Remove the collector cover.
- 2) Drain approximately 3.0 ℓ (3.2 US qt, 2.6 Imp qt) of engine coolant. <Ref. to CO(H4SO)-18, DRAINING OF ENGINE COOLANT, REPLACEMENT, Engine Coolant.>
- 3) Remove the air cleaner upper cover and the air intake duct. <Ref. to IN (H4SO)-5, REMOVAL, Air Cleaner Case.>
- 4) Remove the air cleaner element.
- 5) Disconnect the engine coolant hoses from coolant filler tank.

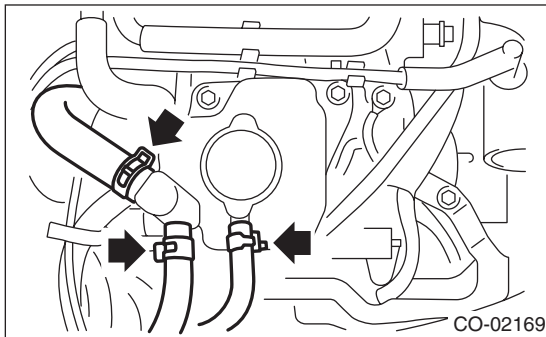

- 6) Remove the bolts and nut which install coolant filler tank.
- 7) Disconnect the engine coolant hose which connects the under side of coolant filler tank.

- 8) Remove the coolant filler tank.

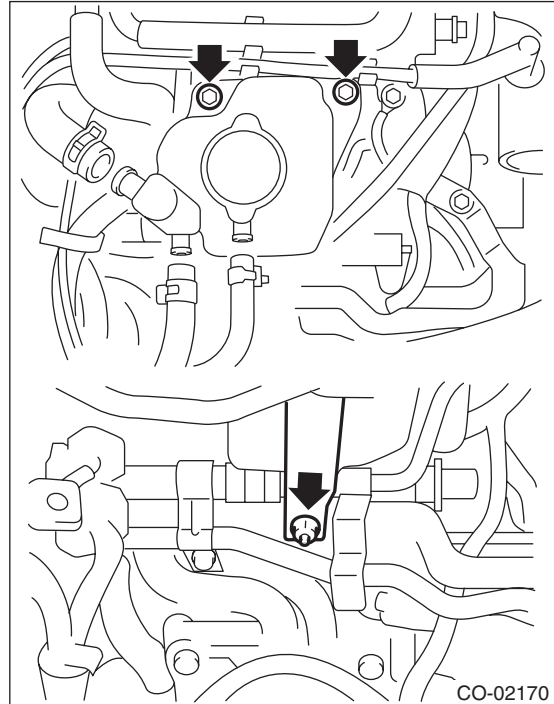

### B: INSTALLATION

- 1) Install in the reverse order of removal.

#### Tightening torque:

**T1: 16 N·m (1.6 kgf·m, 11.8 ft·lb)**

**T2: 13 N·m (1.3 kgf·m, 9.6 ft·lb)**

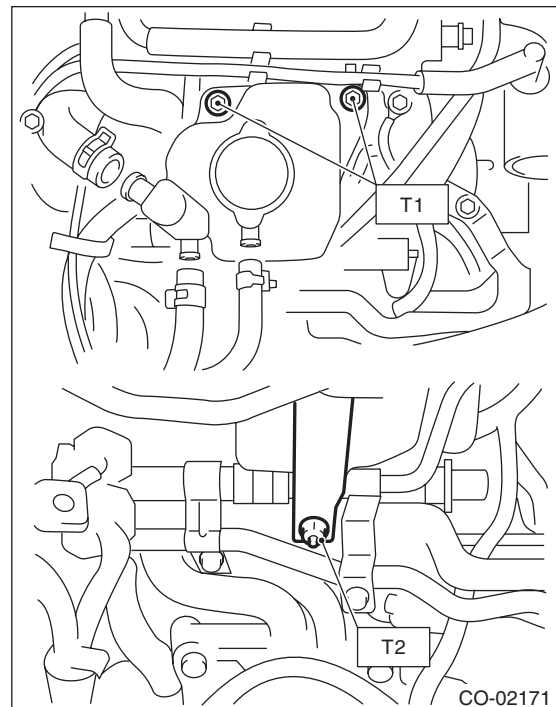

- 2) Fill engine coolant. <Ref. to CO(H4SO)-18, FILLING OF ENGINE COOLANT, REPLACEMENT, Engine Coolant.>