

# Pressure Control Solenoid Valve

EMISSION CONTROL (AUX. EMISSION CONTROL DEVICES)

## 11. Pressure Control Solenoid Valve

### A: REMOVAL

- 1) Set the vehicle on a lift.
- 2) Disconnect the ground cable from the battery.

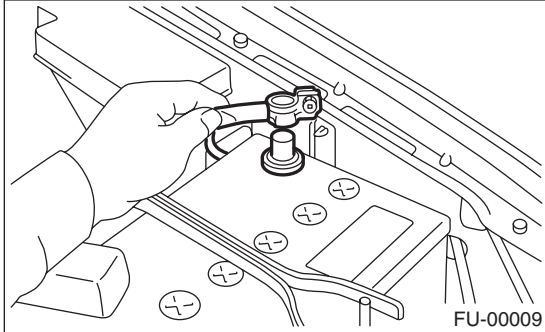

- 3) Lift-up the vehicle.
- 4) Remove the canisters. <Ref. to EC(H4SO)-6, REMOVAL, Canister.>
- 5) Remove the bolt which installs the pressure control solenoid valve holding bracket to the body.

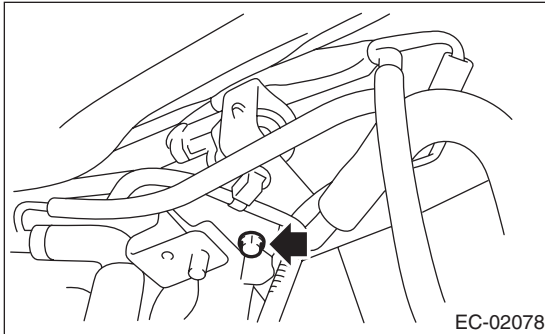

- 6) Remove the pressure control solenoid valve and the bracket as a unit.
- 7) Disconnect the connector from the pressure control solenoid valve.

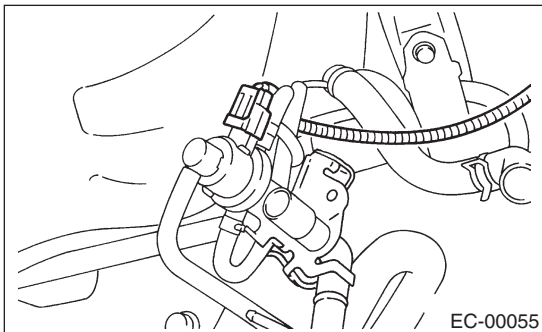

- 8) Disconnect the two evaporation hoses from the pressure control solenoid valve.

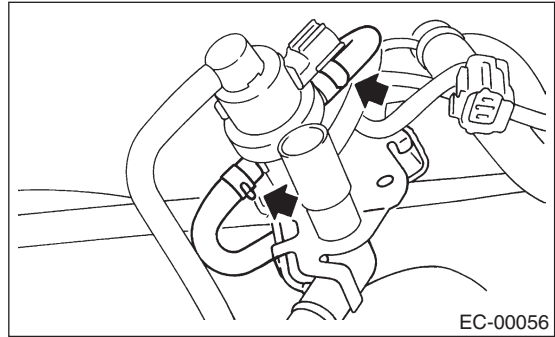

- 9) Remove the pressure control solenoid valve from the bracket.

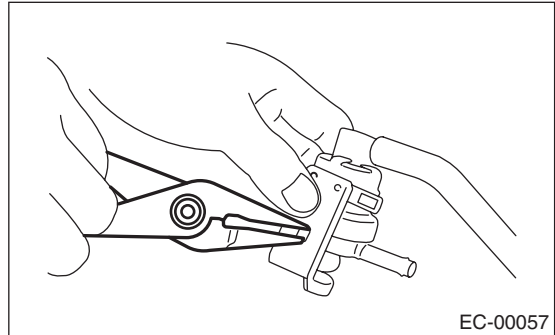

- 10) Disconnect the hose from the pressure control solenoid valve.

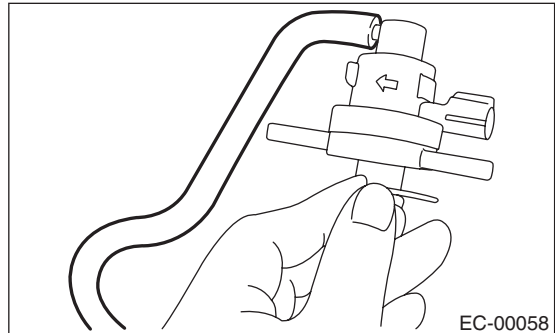

# Pressure Control Solenoid Valve

EMISSION CONTROL (AUX. EMISSION CONTROL DEVICES)

## B: INSTALLATION

Install in the reverse order of removal.

**Tightening torque:**

**25 N·m (2.5 kgf-m, 18.4 ft-lb)**

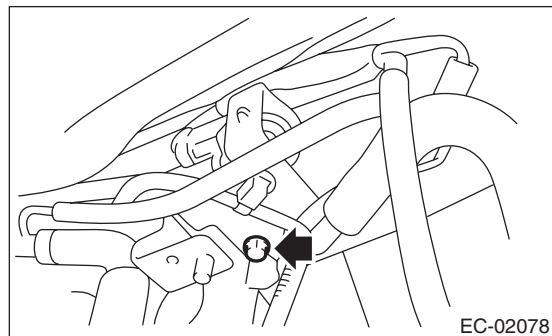

## C: INSPECTION

Make sure the hoses are not cracked or loose.