

22. Oil Switching Solenoid Valve

A: REMOVAL

1. RH SIDE

1) Disconnect the ground cable from the battery.

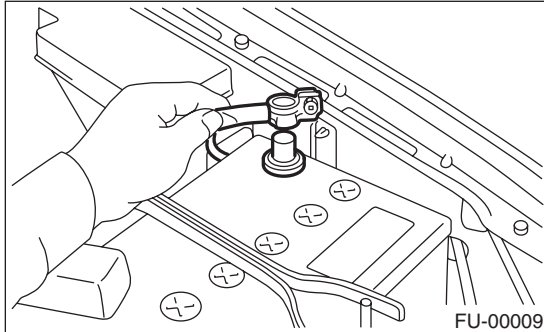

- 2) Remove the air intake chamber.
 <Ref. to IN (H4SO)-6, REMOVAL, Air Intake Chamber.>
 3) Remove the engine harness connector from the bracket.

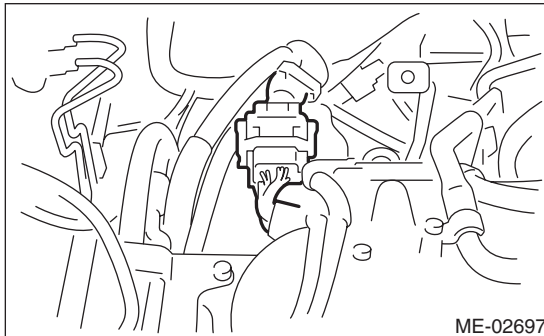

- 4) Disconnect the connector from the oil switching solenoid valve.
 5) Remove the oil switching solenoid valve.
 6) Remove the variable valve lift diagnosis oil pressure switch.
 <Ref. to FU(H4SO)-34, REMOVAL, Variable Valve Lift Diagnosis Oil Pressure Switch.>
 7) Remove the oil temperature sensor.
 <Ref. to FU(H4SO)-35, REMOVAL, Oil Temperature Sensor.>

8) Remove the oil switching solenoid valve holder from the cylinder head.

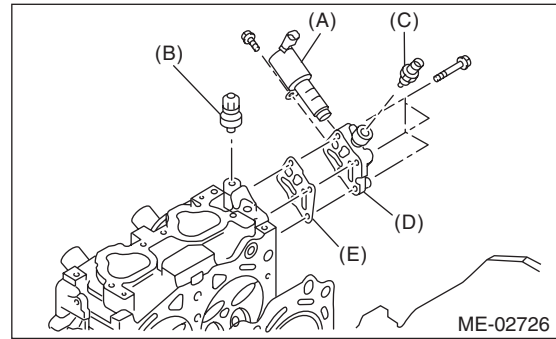

- (A) Oil switching solenoid valve
 (B) Variable valve lift diagnosis oil pressure switch
 (C) Oil temperature sensor
 (D) Oil switching solenoid valve holder
 (E) Gasket

2. LH SIDE

1) Disconnect the ground cable from the battery.

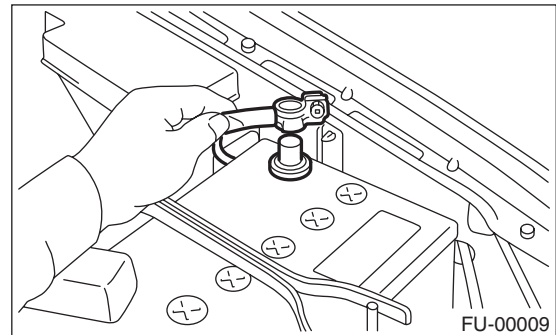

- 2) Remove the V-belts.
 <Ref. to ME(H4SO)-40, REMOVAL, V-belt.>
 3) Remove the crank pulley.
 <Ref. to ME(H4SO)-42, REMOVAL, Crank Pulley.>
 4) Remove the timing belt cover.
 <Ref. to ME(H4SO)-43, REMOVAL, Timing Belt Cover.>
 5) Remove the timing belt.
 <Ref. to ME(H4SO)-44, REMOVAL, Timing Belt.>
 6) Remove the cam sprocket.
 <Ref. to ME(H4SO)-49, REMOVAL, Cam Sprocket.>
 7) Remove the timing belt cover No. 2 (LH).
 8) Disconnect the connector from the oil switching solenoid valve.
 9) Remove the oil switching solenoid valve.
 10) Remove the variable valve lift diagnosis oil pressure switch.
 <Ref. to FU(H4SO)-34, REMOVAL, Variable Valve Lift Diagnosis Oil Pressure Switch.>

Oil Switching Solenoid Valve

MECHANICAL

11) Remove the oil switching solenoid valve holder from the cylinder head.

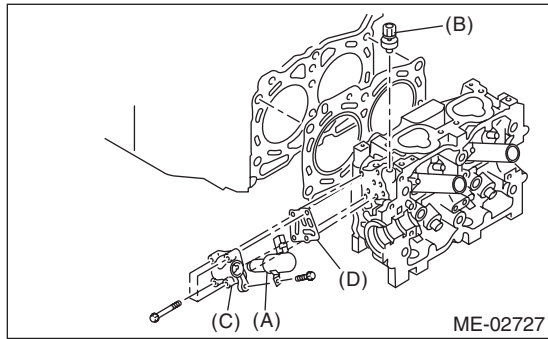

- (A) Oil switching solenoid valve
- (B) Variable valve lift diagnosis oil pressure switch
- (C) Oil switching solenoid valve holder
- (D) Gasket

B: INSTALLATION

1. RH SIDE

Install in the reverse order of removal.

NOTE:

- Use a new gasket.
- Apply liquid gasket to the bolt threads of oil temperature sensor.

Liquid gasket:

THREE BOND 1324 (Part No. 004403042) or equivalent

Tightening torque:

T1

8 N·m (0.8 kgf-m, 5.9 ft-lb)

T2

10 N·m (1.0 kgf-m, 7.4 ft-lb)

T3

17 N·m (1.7 kgf-m, 12.5 ft-lb)

T4

18 N·m (1.8 kgf-m, 13.3 ft-lb)

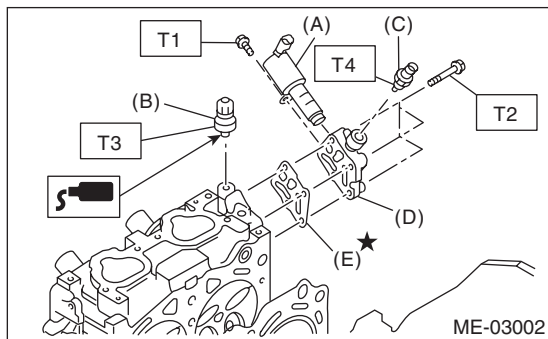

- (A) Oil switching solenoid valve
- (B) Variable valve lift diagnosis oil pressure switch
- (C) Oil temperature sensor
- (D) Oil switching solenoid valve holder
- (E) Gasket

2. LH SIDE

Install in the reverse order of removal.

NOTE:

- Use a new gasket.
- Apply liquid gasket to the bolt threads of oil temperature sensor.

Liquid gasket:

THREE BOND 1324 (Part No. 004403042) or equivalent

Tightening torque:

T1

8 N·m (0.8 kgf-m, 5.9 ft-lb)

T2

10 N·m (1.0 kgf-m, 7.4 ft-lb)

T3

17 N·m (1.7 kgf-m, 12.5 ft-lb)

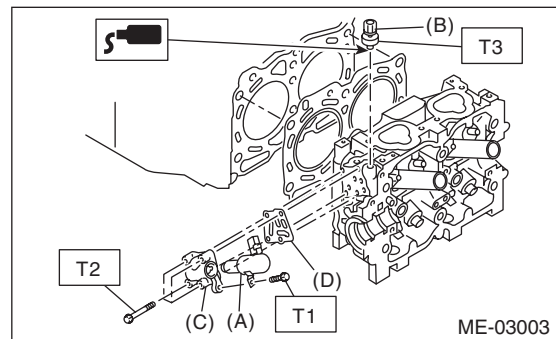

- (A) Oil switching solenoid valve
- (B) Variable valve lift diagnosis oil pressure switch
- (C) Oil switching solenoid valve holder
- (D) Gasket