

7. Clutch Pipe and Hose

A: REMOVAL

- 1) Remove the air cleaner chamber and the air intake duct. (Non-turbo model) <Ref. to IN (H4SO)-6, REMOVAL, Air Intake Chamber.>
- 2) Remove the intercooler. (Turbo model) <Ref. to IN(H4DOTC)-11, REMOVAL, Intercooler.>
- 3) Drain the clutch fluid. <Ref. to CL-22, Clutch Fluid.>
- 4) Remove the clutch pipe from the clutch hose and master cylinder.
- 5) Pull out the clamp, then remove the clutch hose from the bracket.

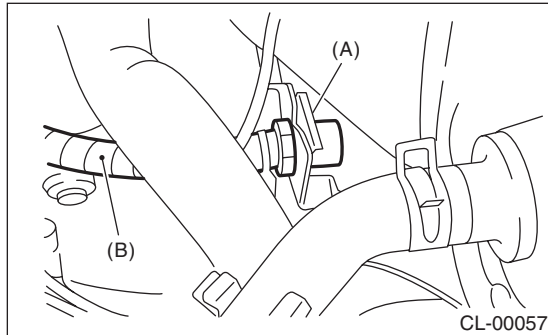

- (A) Clamp
- (B) Clutch hose

- 6) Remove the hose from operating cylinder.
- 7) Remove the bracket.

B: INSTALLATION

Install in the reverse order of removal.

Tightening torque:

T1: 15 N·m (1.5 kgf·m, 10.8 ft·lb)

T2: 18 N·m (1.8 kgf·m, 13.0 ft·lb)

T3: 25 N·m (2.5 kgf·m, 18.1 ft·lb)

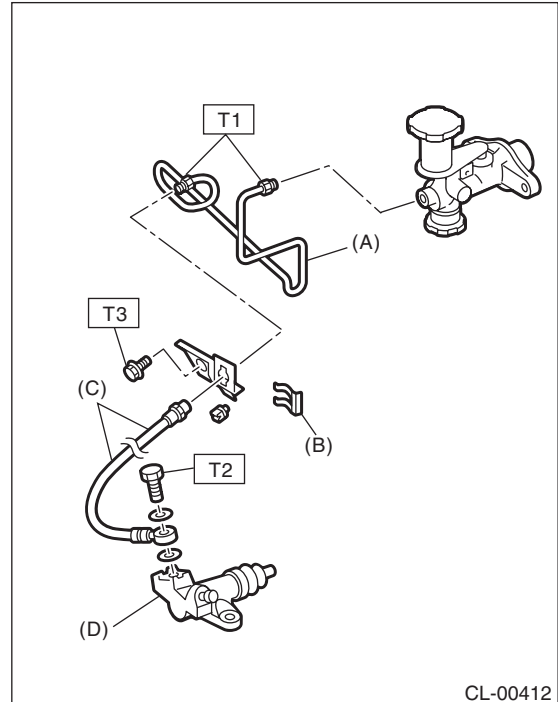

- (A) Clutch pipe
- (B) Clip
- (C) Clutch hose
- (D) Operating cylinder

C: INSPECTION

Check pipes and hoses for cracks, breakage or damage. Check joints for fluid leakage. If any cracks, breakage, damage or leakage is found, repair or replace the abnormal pipe or hose.