

9. Rear Quarter Trim Panel (Wagon)

A: REMOVAL

- 1) Set rear seat cushion up.
- 2) Remove rear seat backrest.
- 3) Remove sideshelf and rear skirt trim.
- 4) Remove clip and screw of rear quarter lower trim.
- 5) Remove rear quarter lower trim.

B: INSTALLATION

Installation is in the reverse order of removal.

CAUTION:

Be careful not to ride trim panel over harness, insulators, etc.

10. Floor Mat **AIRBAG**

Supplemental Restraint System "Airbag"

Airbag system wiring harness is routed near floor mat.

CAUTION:

- All Airbag system wiring harness and connectors are colored yellow. Do not use electrical test equipment on these circuit.
- Be careful not to damage Airbag system wiring harness when servicing floor mat.

The following procedure is applicable to all models.

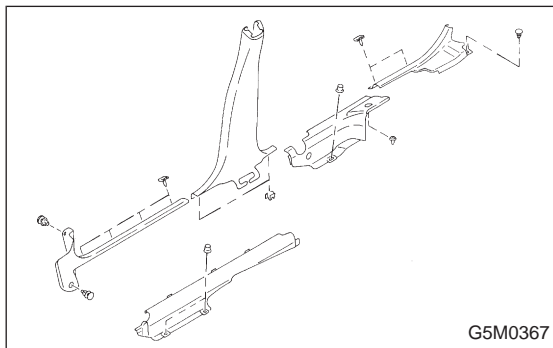

A: REMOVAL

- 1) Remove front seats.
- 2) Remove rear seat cushion.
- 3) Remove center tray, indicator cover, cover assembly, and console box, depending on the specifications.
- 4) Remove front pillar lower trim panel.
- 5) Remove center pillar lower trim panel.
- 6) Remove three clips under rear seat cushion.
- 7) Remove rear cover side plate and rear pillar lower trim.
- 8) Pull out edge in the groove of side sill cover.

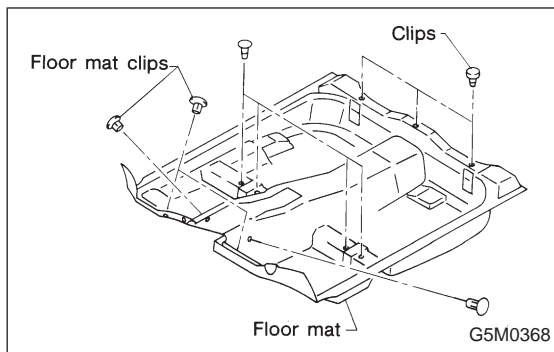

- 9) Remove four clips under front seat.
- 10) Remove four clips in toe board area.

NOTE:

When pulling out edge, do not pull mat alone; pull mat together with edge.

Pry off two steel clips on side sill front cover and one on side sill rear cover using screwdriver.

- 11) Remove mat hook.
- 12) Remove mat from toe board area.
- 13) Remove mat from heater unit.
- 14) Roll mat, and take it out of opened rear door.

B: INSTALLATION

Installation is in the reverse order of removal.

- 1) Secure mat firmly with hook and velcro tape.
- 2) Insert mat edge firmly into the groove of side sill cover.