

5) Remove instrument panel console. <Ref. to 5-4 [W1A0].> Disconnect 12-pin yellow connector (AB6) from airbag control unit. <Ref. to 5-5 [M2-6].>

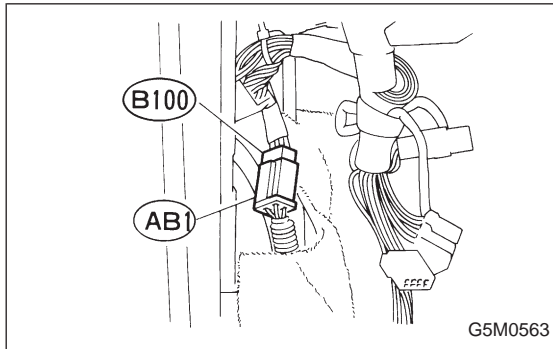

6) Disconnect body harness connector (B39) from connector (AB1).

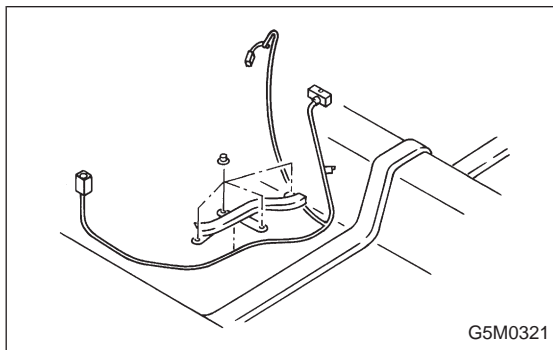

7) Roll up floor mat and side sill cover. (LH side). Remove main harness from clip and protector.

B: INSTALLATION

Installation is in reverse order of removal procedures.

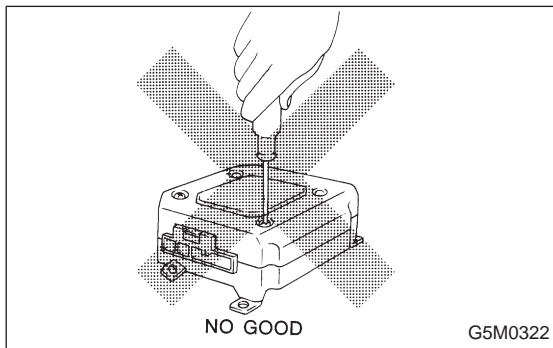

4. Airbag Control Module

CAUTION:

- Do not disassemble the airbag control module.

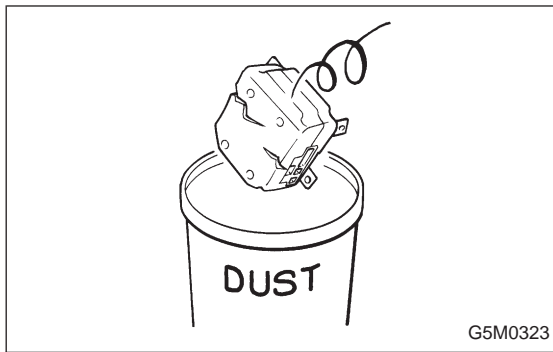

- If the airbag control module is deformed, or if water damage is suspected, replace the airbag control module with a new genuine part.

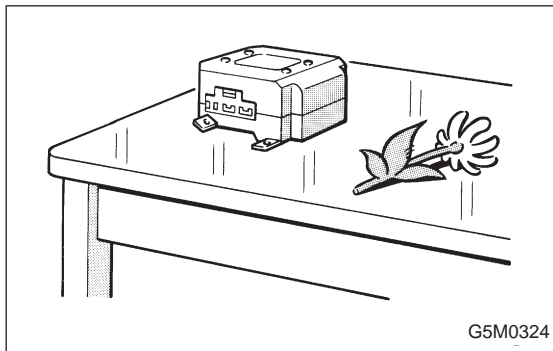

- After removal, keep the airbag control module on a dry, clean surface away from heat and light sources, and moisture and dust.

A: REMOVAL

- 1) Turn ignition switch off.
- 2) Disconnect ground cable from battery and wait for at least 20 seconds before starting work.

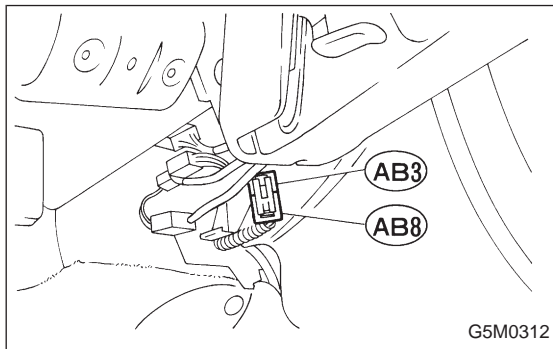

- 3) Remove lower cover. <Ref. to 5-4 [W1A0].> Disconnect airbag connector (AB3) and (AB8) below steering column.

CAUTION:
Do not reconnect airbag connector at steering column until airbag control module is securely re-installed.

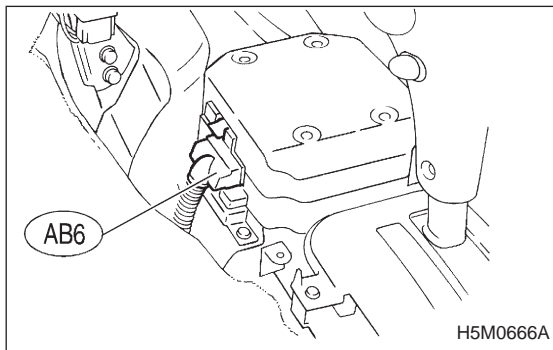

- 4) Remove instrument panel console. <Ref. to 5-4 [W1A0].>
- 5) Disconnect 12-pin yellow connector (AB6) from airbag control module. <Ref. to 5-5 [M2-6].>

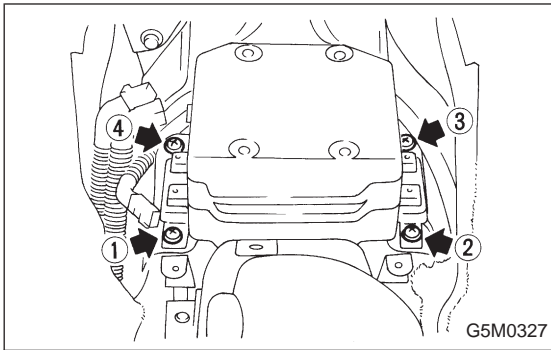

6) Using TORX® BIT T30, remove four TORX® bolts in numerical sequence shown in figure. Discard the old TORX® bolts.

CAUTION:

Use new TORX® bolts during re-assembly.

B: INSTALLATION

Installation is in reverse order of removal procedures.

CAUTION:

Be sure to fully secure all airbag system connectors during re-assembly and confirm that all green double lock mechanisms are engaged.

5. Combination Switch**1. CENTERING ROLL CONNECTOR**

Before installing combination switch and steering wheel, make sure to center roll connector built into combination switch.

1) Make sure that front wheels are positioned straight ahead.

2) Install steering gearbox, steering shaft and combination switch properly. Turn roll connector pin ① **clockwise** until it stops.

3) Then, back off roll connector pin ① approximately 2.65 turns until “▲” marks aligned.

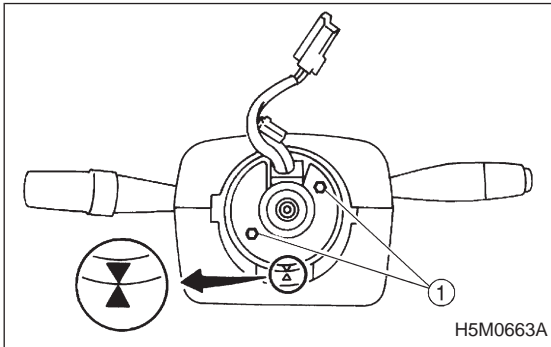
**A: REMOVAL**

1) Turn ignition switch off.

2) Disconnect ground cable from battery and wait for at least 20 seconds before starting work.