

Check continuity between terminals (indicated in table below) when terminal (1) is connected to battery and terminal (2) is grounded.

When current flows.	Between terminals (3) and (5)	Continuity does not exist.
	Between terminals (3) and (4)	Continuity exists.
When current does not flow.	Between terminals (3) and (5)	Continuity exists.
	Between terminals (1) and (2)	Continuity exists.

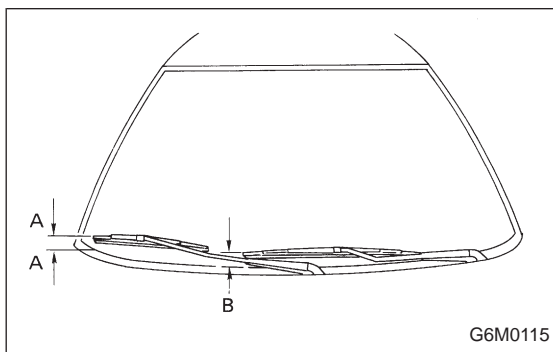

5. Front Wiper and Washer

A: ON-CAR SERVICES

1. ADJUSTMENT

1) When wiper switch is in "OFF" position, adjust blades in original position as shown in figure by changing wiper arm installation.

Original position:

A: 15 — 30 mm (0.59 — 1.18 in)

B: 25 — 40 mm (0.98 — 1.57 in)

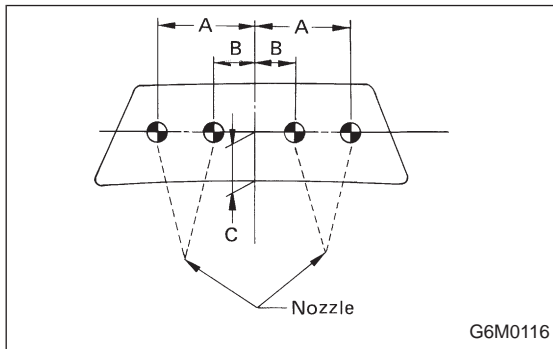

2) Adjust washer ejecting point on windshield glass as shown in figure when car stops.

Ejecting point:

A: 375 mm (14.76 in)

B: 150 mm (5.91 in)

C: 350 mm (13.78 in)

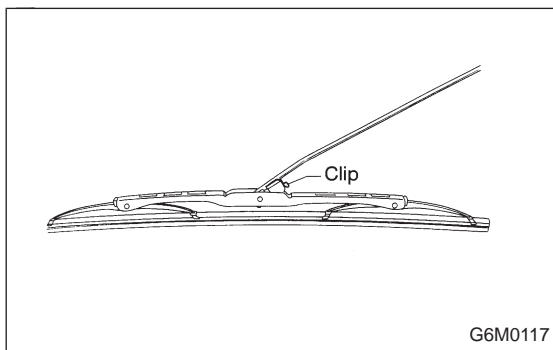

B: REMOVAL AND INSTALLATION

1. BLADE

Pull out blade from arm while pushing up clip.

5. Front Wiper and Washer

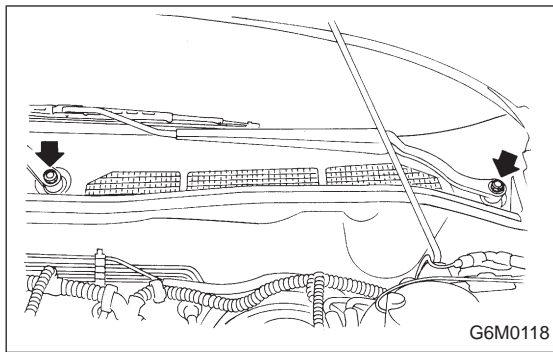
**2. WIPER ARM**

- 1) Open front hood.
- 2) Remove cap. Remove the nut which secure wiper arm, and remove wiper arm.

Tightening torque:

10 — 18 N·m (1.0 — 1.8 kg-m, 7 — 13 ft-lb)

3. WIPER MOTOR AND LINK

- 1) Detach weatherstrip and cowl net. <Ref. to 5-1.>

NOTE:

Apply silicone oil or soap water to both sides of cowl net to facilitate removal.

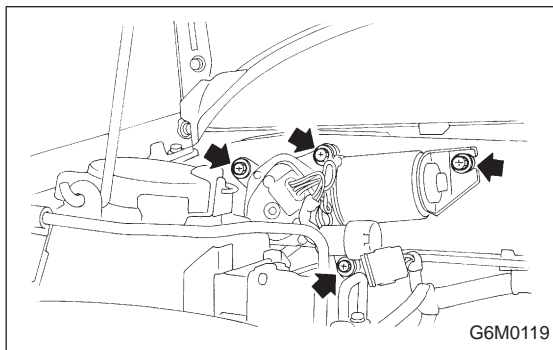

- 2) Disconnect electric connector, and remove motor attaching bolts.

Tightening torque:

4.4 — 7.4 N·m (0.45 — 0.75 kg-m, 3.3 — 5.4 ft-lb)

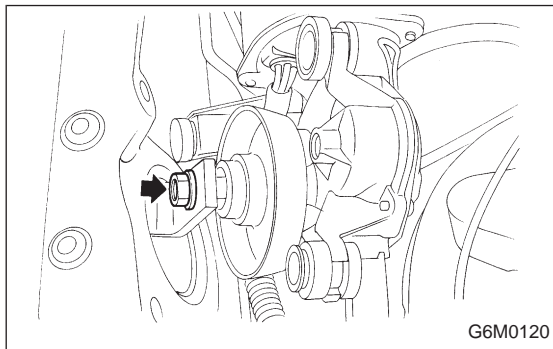

- 3) Remove nut securing motor link on the back side of motor.

Tightening torque:

12 — 18 N·m (1.2 — 1.8 kg-m, 9 — 13 ft-lb)

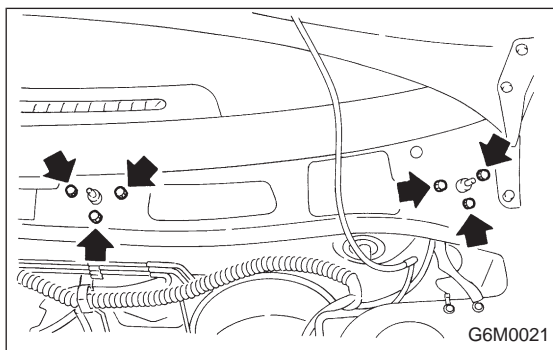

- 4) Remove nuts which secure sleeve unit.

Tightening torque:

4.4 — 7.4 N·m (0.45 — 0.75 kg-m, 3.3 — 5.4 ft-lb)

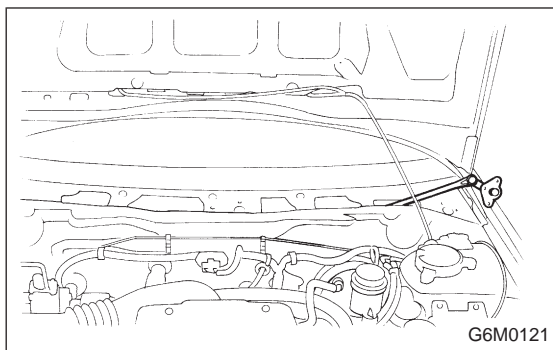

5) Remove wiper link from service hole in front panel.

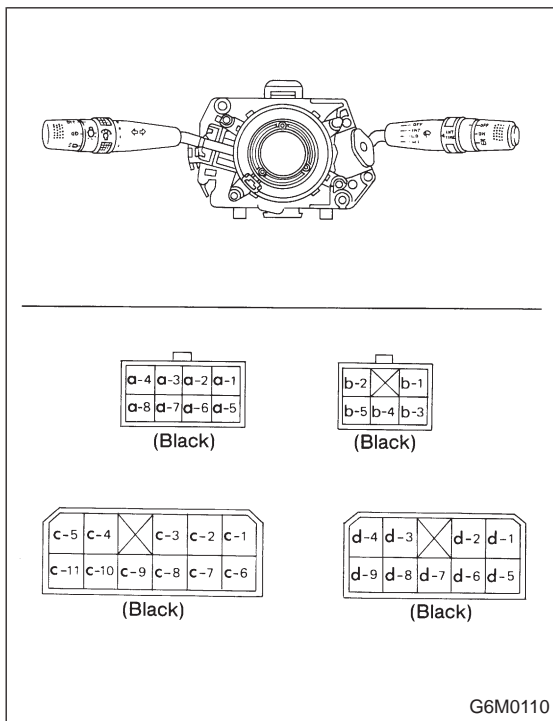

C: INSPECTION

1. FRONT WIPER AND WASHER SWITCH

Set wiper switch to each position and check continuity between terminals (indicated in table below).

Wiper switch

Terminal (Wire color)		d-9 (Y)	d-8 (L)	d-6 (LY)	d-7 (LW)	INT1	INT2
Switch position							
OFF	OFF	○—○					
	MIST	x—	○—○	x—			
INT	OFF	○—○				○—○	
	MIST	x—	○—○	x—		○—○	
		x—		x—			
LO	OFF		○—○				
	MIST		○—○				
HI	OFF			○—○			
	MIST		○—○	○—○			

Washer switch

Terminal (Wire color)	d-5 (B)	d-2 (W)
Switch position		
OFF		
ON	○—	○—

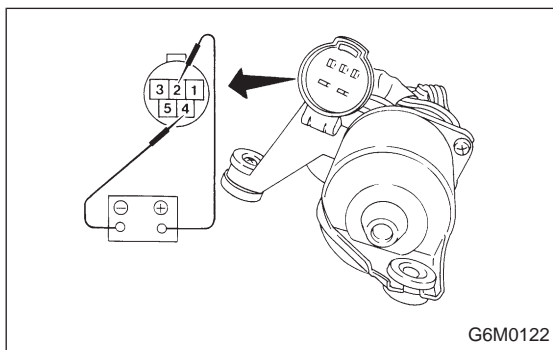

2. WIPER MOTOR

1) Check wiper motor operation at low speed. Connect battery to wiper motor. Check wiper motor for proper operation at low speed.

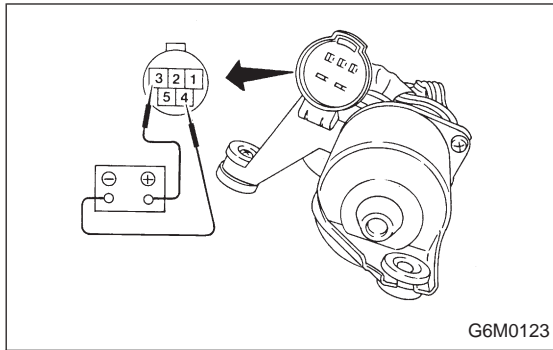

2) Check wiper motor operation at high speed.
Connect battery wiper motor. Check wiper motor for proper operation at high speed.

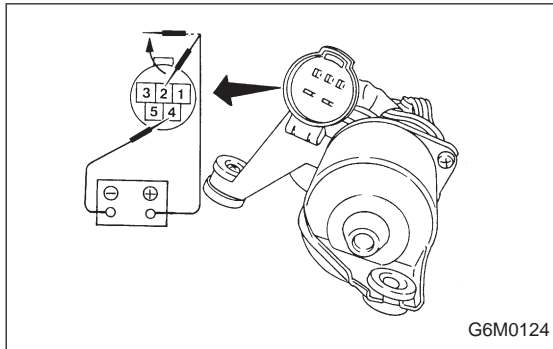

3) Check wiper motor for proper stoppage.
Connect battery to wiper motor. After operating wiper motor at low speed, disconnect battery to stop it.

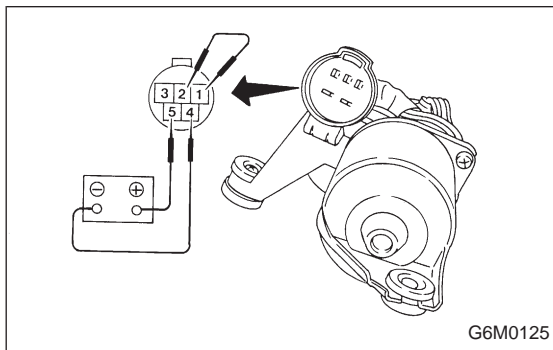

Reconnect battery and ensure that wiper motor stops at "AUTO STOP" after operating at low speed.

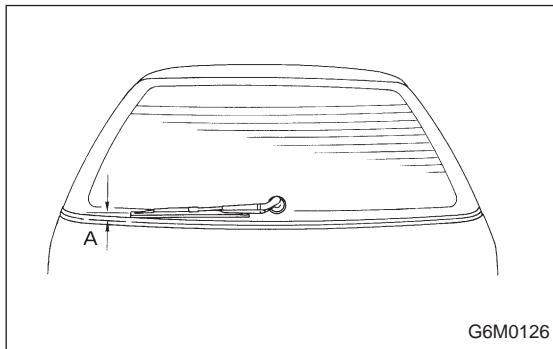

6. Rear Wiper and Washer

A: ON-CAR SERVICES

1. ADJUSTMENT

1) Adjust wiper blade in original position as shown in figure by changing wiper arm installation.

Original position:

A: 25 — 35 mm (0.98 — 1.38 in)

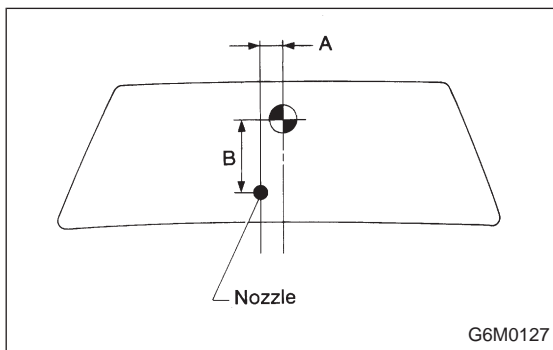

2) Adjust washer ejecting point on rear gate window as shown in figure when the car stops.

Ejecting point:

A: 25 mm (0.98 in)

B: 200 — 300 mm (7.87 — 11.81 in)