

9. Cruise Control **AIRBAG**

A: ADJUSTMENT

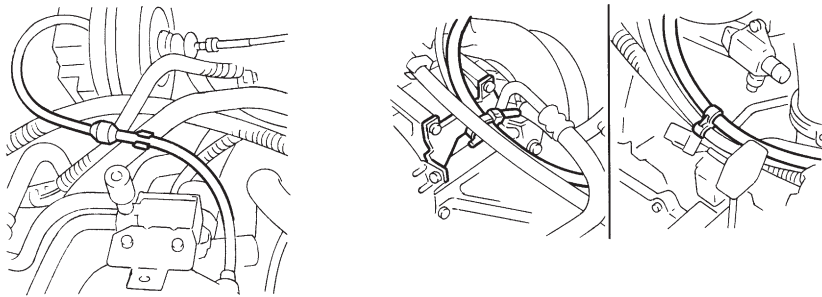

Adjust so that cable deflects  
1 — 8 mm (0.04 — 0.31 in)  
within the specified throttle link  
free play range, and adjust the  
outer end.

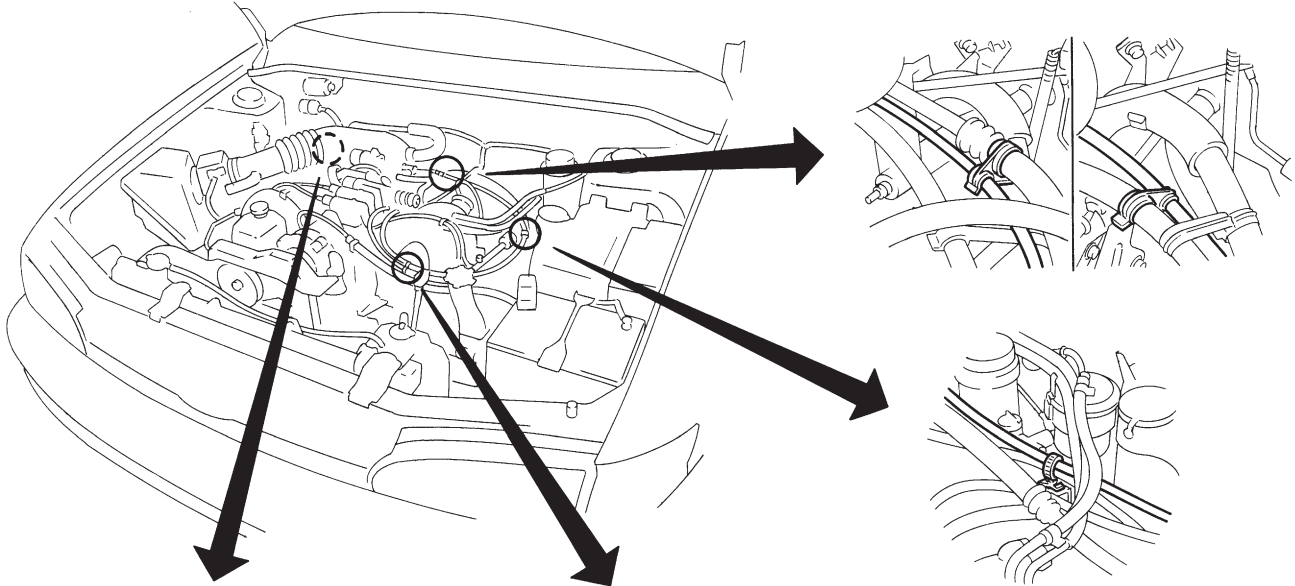
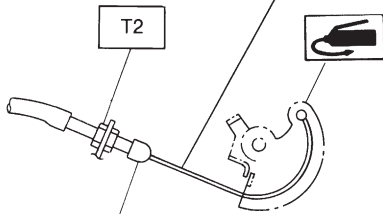

Cover must be inserted securely,  
until top of cable touches  
cover stopper.

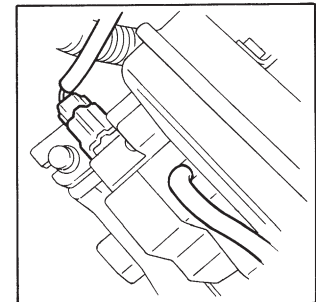
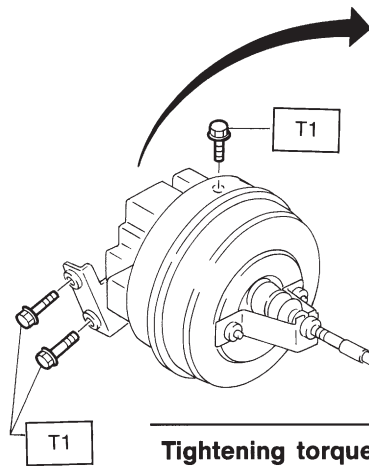

**Tightening torque: N·m (kg-m, ft-lb)**  
**T1: 5.4 — 9.3 (0.55 — 0.95, 4.0 — 6.9)**  
**T2: 10 — 18 (1.0 — 1.8, 7 — 13)**

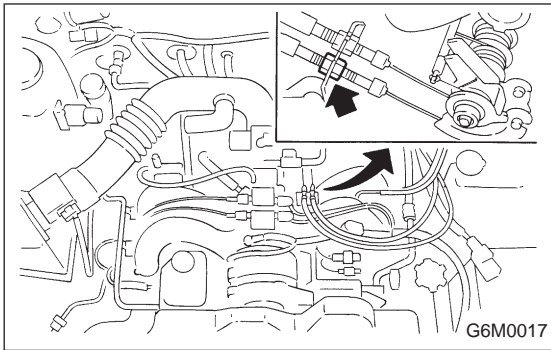
**B: REMOVAL AND INSTALLATION****1. ACTUATOR**

1) Remove air intake duct. Remove the nut which secures control cable end to throttle cam, and remove control cable end.

2) Remove clip bands from control cable.

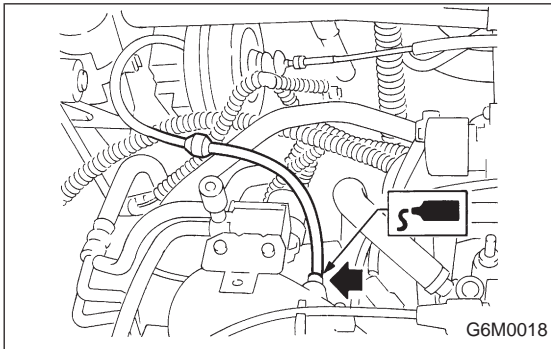

3) Disconnect cruise control hose from intake manifold.

**CAUTION:**

**When inserting hose into intake manifold, apply sealant to hose.**

**Fluid packing:**

**THREE BOND 1105 or equivalent**

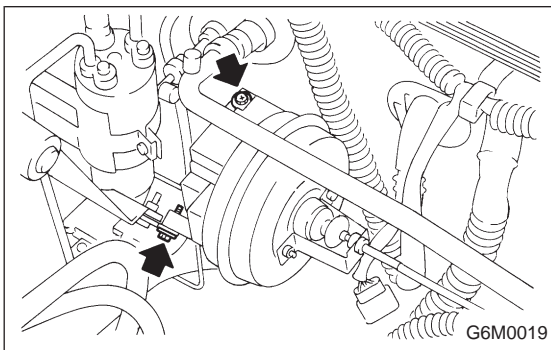

4) Disconnect actuator connector.

5) Remove attaching bolts and actuator.

**Tightening torque:**

**5.4 — 9.3 N·m (0.55 — 0.95 kg-m, 4.0 — 6.9 ft-lb)**

**CAUTION:**

- Be careful not to apply excessive load to the wire cable when adjusting and/or installing; otherwise, the actuator may be deformed or damaged.

- Do not bend cable sharply with a radius less than 100; otherwise, cable may bend permanently, resulting in poor performance.

- When installing cable, be careful not to sharply bend or pinch the inner cable; otherwise, the cable may break.

**2. STOP AND BRAKE SWITCH**

<Ref. to 4-5.>

**3. CLUTCH SWITCH**

<Ref. to 4-5.>

**4. CRUISE CONTROL MAIN SWITCH**

1) Remove meter visor, and then remove cruise control main switch by pushing it outward.

2) Disconnect connector.

**5. CRUISE CONTROL SUB SWITCH**

1) Remove horn pad.

2) Disconnect horn switch connector and remove attaching screws.

**WARNING:**

**Refer to 5-5 when removing or installing the module from the airbag equipped model.**

## C: DRIVING TESTS

Conduct road tests by selecting a smooth, flat road or use free rollers as road test simulation.

### 1. MAIN SWITCH

- 1) Turn ignition switch ON.
- 2) Check that indicator light comes on when main switch is pressed (ON).
- 3) Check that indicator light goes out when main switch is pressed again (OFF).
- 4) Turn ignition switch OFF with main switch ON (which is indicated by illumination). Turn ignition switch ON again to ensure that indicator light remains OFF.

### 2. SUB SWITCH

- 1) Check that sub switch is properly set in "SET/ COAST", "RESUME/ACCEL" or "CANCEL" mode.
- 2) Also check that sub switch returns to the original position when released.

### 3. CONSTANT SPEED TEST

- 1) Turn main switch ON.
- 2) Drive vehicle at speed greater than 40 km/h (25 MPH).
- 3) Press sub switch to set in "SET/COAST" mode.
- 4) Ensure that vehicle is maintained at the speed set when sub switch was pressed.

### 4. ACCELERATION TEST

- 1) Set vehicle speed at speed greater than 40 km/h (25 MPH).
- 2) Ensure that vehicle continues to accelerate while holding sub switch in RESUME/ACCEL mode, and that vehicle maintains that optional speed when sub switch is released.

### 5. DECELERATION TEST

- 1) Set vehicle speed at optional speed greater than 40 km/h (25 MPH).
- 2) Ensure that vehicle continues to decelerate while holding sub switch in SET/COAST mode, and that it maintains that optional speed when sub switch is released.

#### NOTE:

When vehicle speed reaches the lower speed limit of 30 km/h (19 MPH) during deceleration, cruise control will be released.