

1. Supplemental Restraint System "Airbag"

Airbag system wiring harness is routed near the instrument panel, heater unit, blower motor and control unit.

CAUTION:

- All Airbag system wiring harness and connectors are colored yellow. Do not use electrical test equipment on these circuit.
- Be careful not to damage Airbag system wiring harness when servicing the instrument panel, heater unit, blower motor and control unit.

2. Heater Unit

A: REMOVAL

- 1) Disconnect GND cable from battery.
- 2) Remove heater hoses (inlet, outlet) in engine compartment.

NOTE:

Drain as much coolant from heater unit as possible, and plug disconnected hose with cloth.

- 3) Disconnect temperature control cable and mode door control cable from heater unit.
<Ref. to 5-4 [W1A0].>
- 4) Remove instrument panel.
<Ref. to 5-4 [W1A0].>
- 5) Remove steering support beam.
<Ref. to 5-1 [C600].>
- 6) Remove cooling unit.
<Ref. to 4-7 [W14A0].>

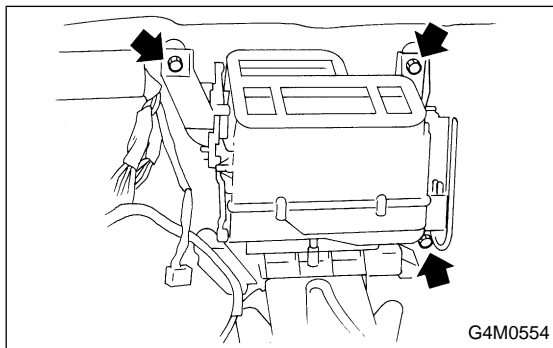

- 7) Remove heater unit.

B: INSTALLATION

Installation is in the reverse order of removal.

Fitted length of heater hose over pipe:
25 — 30 mm (0.98 — 1.18 in)

3. Blower Motor Assembly

A: REMOVAL

- 1) Disconnect GND cable from battery.
- 2) Remove glove box.
- 3) Disconnect blower motor harness connector.
- 4) Disconnect aspirator pipe ①.
- 5) Remove blower motor mounting screw.
- 6) Remove blower motor assembly.

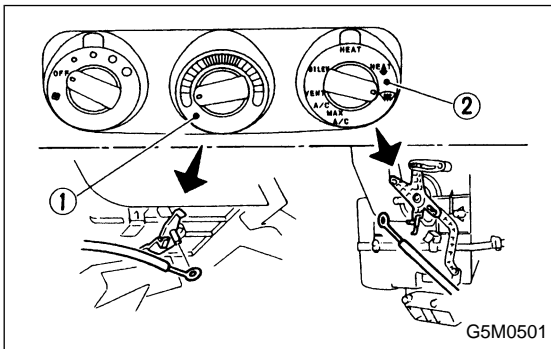
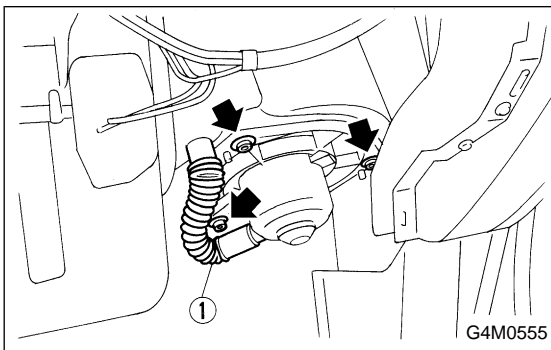
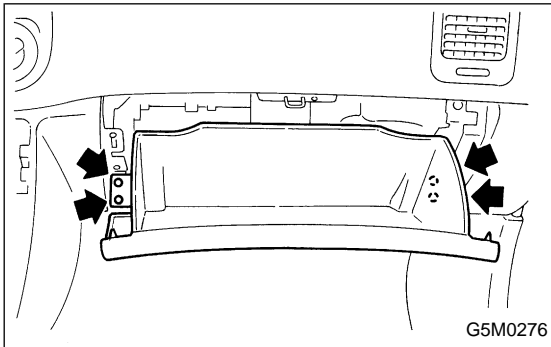

4. Control Unit

A: REMOVAL

- 1) Disconnect GND cable from battery.
- 2) Set temperature control switch ① to “FULL COLD” and mode selector switch ② to “DEF” position.
- 3) Remove temperature control cable and mode door control cable from heater unit.

NOTE:

- Do not attempt to move links during installation.
- Before control unit installation, set temperature control switch to “FULL COLD” and mode selector switch to “DEF” position.