

B: INSTALLATION

Installation is in the reverse order of removal.

Fitted length of heater hose over pipe:
25 — 30 mm (0.98 — 1.18 in)

3. Blower Motor Assembly

A: REMOVAL

- 1) Disconnect GND cable from battery.
- 2) Remove glove box.
- 3) Disconnect blower motor harness connector.
- 4) Disconnect aspirator pipe ①.
- 5) Remove blower motor mounting screw.
- 6) Remove blower motor assembly.

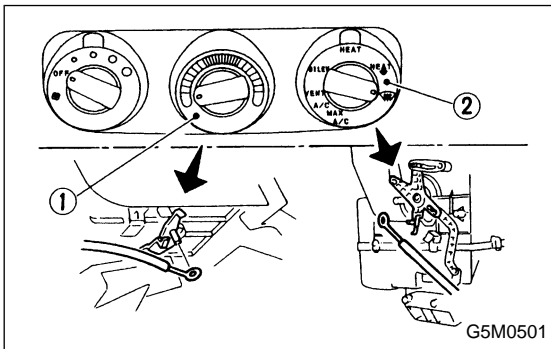
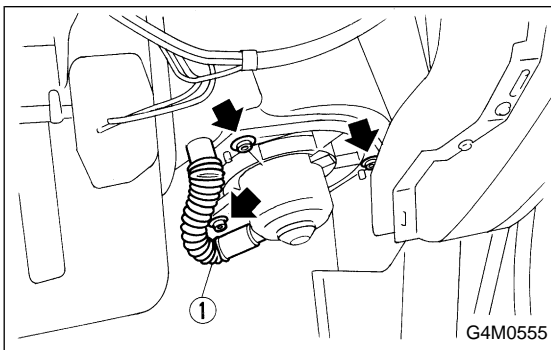
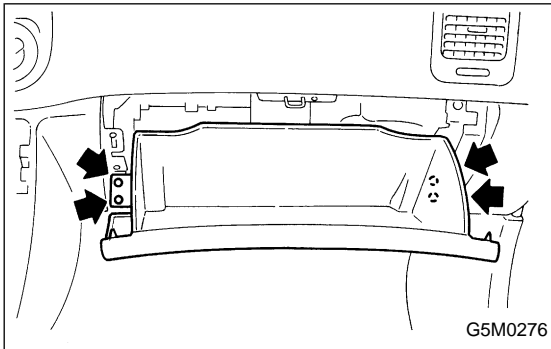

4. Control Unit

A: REMOVAL

- 1) Disconnect GND cable from battery.
- 2) Set temperature control switch ① to “FULL COLD” and mode selector switch ② to “DEF” position.
- 3) Remove temperature control cable and mode door control cable from heater unit.

NOTE:

- Do not attempt to move links during installation.
- Before control unit installation, set temperature control switch to “FULL COLD” and mode selector switch to “DEF” position.