

B: INSTALLATION

Installation is in the reverse order of removal.

Fitted length of heater hose over pipe:
25 — 30 mm (0.98 — 1.18 in)

3. Blower Motor Assembly

A: REMOVAL

- 1) Disconnect GND cable from battery.
- 2) Remove glove box.
- 3) Disconnect blower motor harness connector.
- 4) Disconnect aspirator pipe ①.
- 5) Remove blower motor mounting screw.
- 6) Remove blower motor assembly.

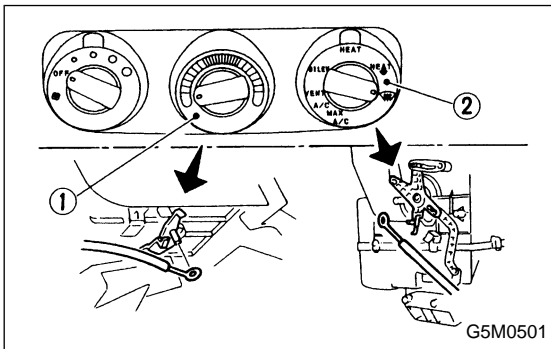
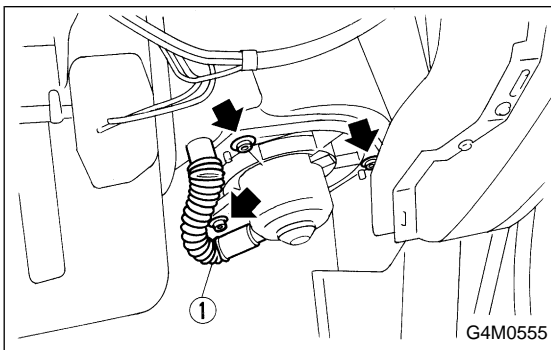
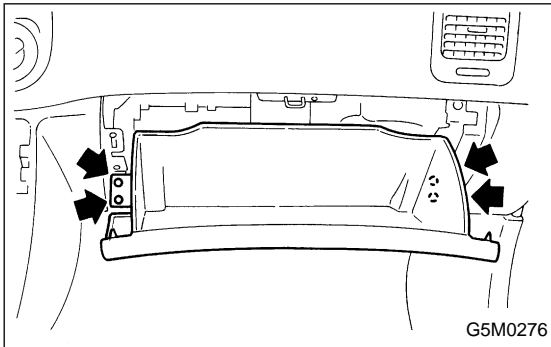

4. Control Unit

A: REMOVAL

- 1) Disconnect GND cable from battery.
- 2) Set temperature control switch ① to “FULL COLD” and mode selector switch ② to “DEF” position.
- 3) Remove temperature control cable and mode door control cable from heater unit.

NOTE:

- Do not attempt to move links during installation.
- Before control unit installation, set temperature control switch to “FULL COLD” and mode selector switch to “DEF” position.

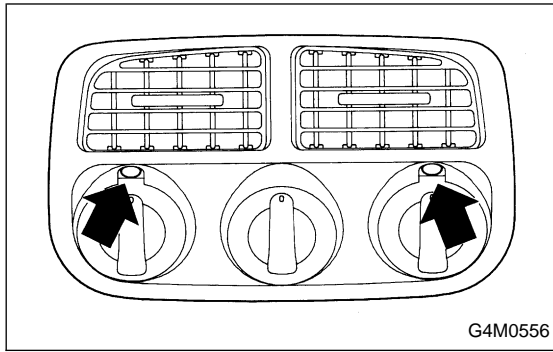

4) Remove center panel.

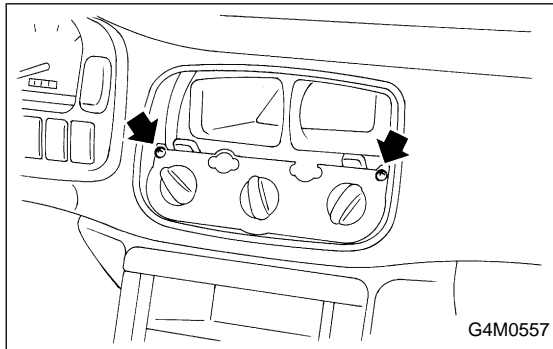

5) Remove control unit assembly and disconnect connector.

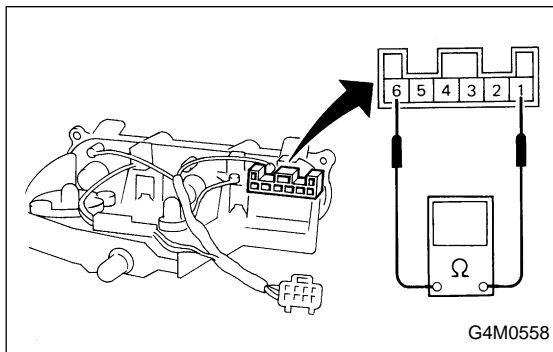

B: INSPECTION

1. FAN SWITCH

Check continuity between terminals at each switch position.

Switch position	Terminals					
	1	2	3	4	5	6
Low	○	○				○
Med. 1	○		○			○
Med. 2	○			○		○
High	○				○	○

2. CONTROL UNIT

- 1) Ignition switch is turned OFF.
- 2) Disconnect connector from control unit.
- 3) Check circuit continuity between each terminal.

Terminal	Mode selector switch position			Illumi.
	MAX A/C (RECIRC)	Except MAX A/C (FRESH)	<ul style="list-style-type: none"> ● MAX A/C ● A/C (A/C ON) 	
1	○	○		
2	○	○		
3		○		
4			○	
5			○	○
6			○	○
7			○	

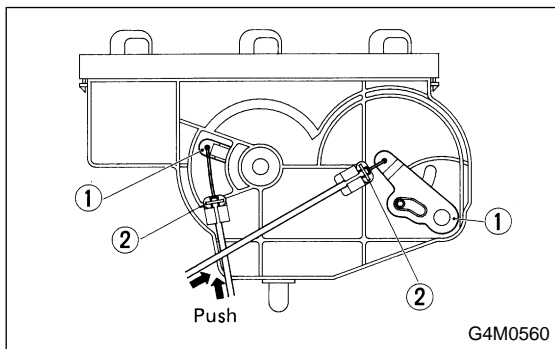
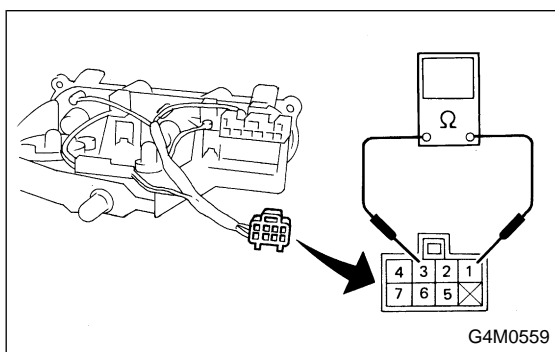

C: ADJUSTMENT

- 1) Operate temperature control switch to "FULL COLD" and mode selector switch to "MAX A/C" position.
- 2) Install control cable to lever ①. While pushing outer cable, secure control cable with clip ②.

D: INSTALLATION

Installation is in the reverse order of removal.