

2. Power Steering System

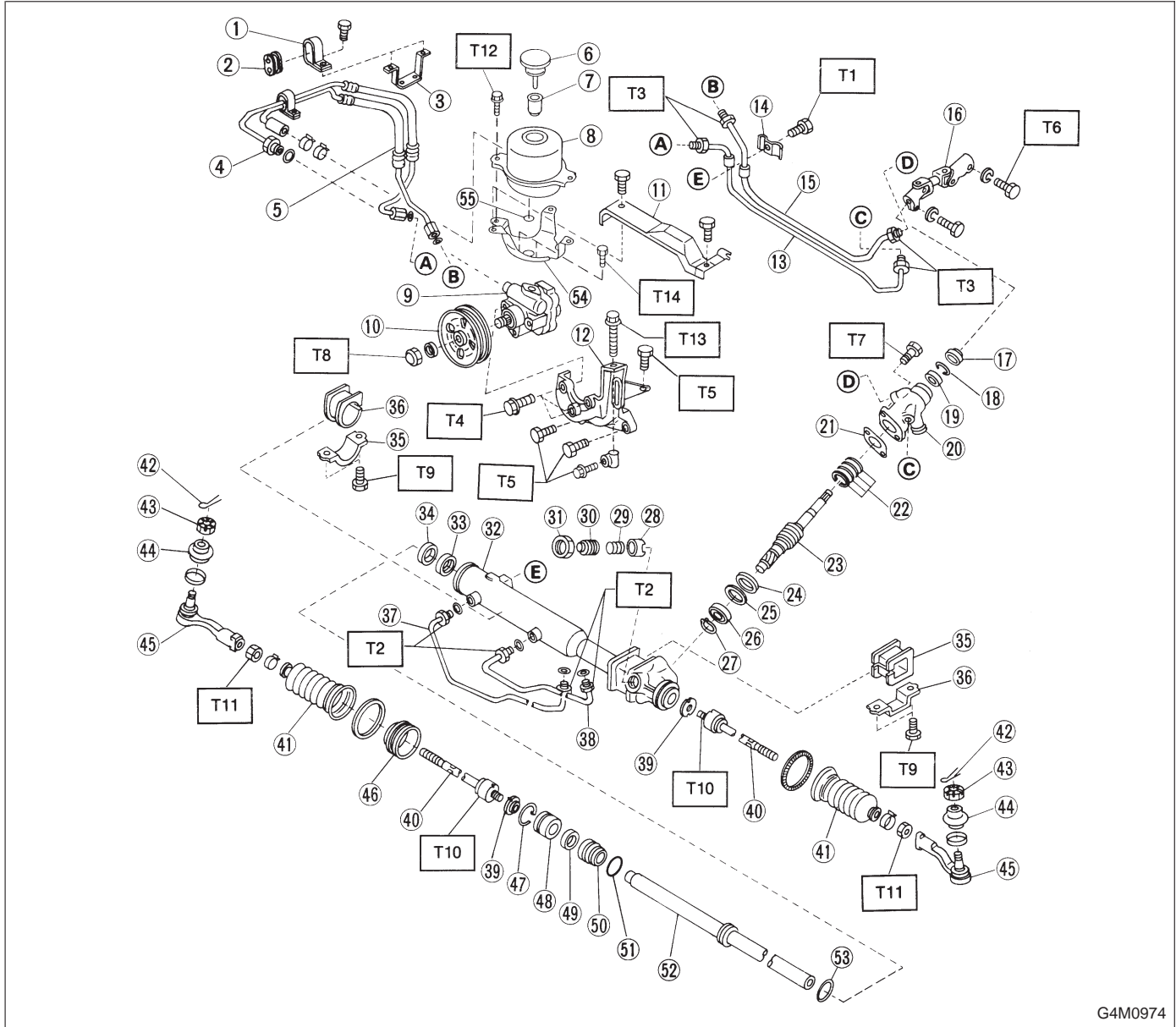

G4M0974

Tightening torque: N·m (kg·m, ft·lb)

- T1: 5.4±1.5 (0.55±0.15, 4.0±1.1)
- T2: 13±3 (1.3±0.3, 9.4±2.2)
- T3: 15±5 (1.5±0.5, 10.8±3.6)
- T4: 20.1±2.5 (2.05±0.25, 14.8±1.8)
- T5: 22±2 (2.2±0.2, 15.9±1.4)
- T6: 24±3 (2.4±0.3, 17.4±2.2)
- T7: 25±5 (2.5±0.5, 18.1±3.6)
- T8: 52±10 (5.3±1.0, 38±7)
- T9: 59±12 (6.0±1.2, 43±9)
- T10: 78±10 (8.0±1.0, 58±7)
- T11: 83±5 (8.5±0.5, 61.5±3.6)
- T12: 7.4±2.0 (0.75±0.20, 5.4±1.4)
- T13: 8±2 (0.8±0.2, 5.8±1.4)
- T14: 18⁺⁵₀ (1.8^{+0.5}₀, 13.0^{+3.6}₀)

- | | |
|-------------------------|--------------------|
| ① Clamp | ②⑨ Spring |
| ② Adapter | ③⑩ Adjusting screw |
| ③ Hose bracket | ④⑪ Lock nut |
| ④ Pipe C | ⑤⑫ Housing ASSY |
| ⑤ Pipe D | ⑥⑬ Back-up washer |
| ⑥ Cap | ⑦⑭ Oil seal |
| ⑦ Strainer | ⑧⑮ Adapter |
| ⑧ Tank | ⑨⑯ Clamp |
| ⑨ Oil pump | ⑩⑰ Pipe A |
| ⑩ Pulley | ⑪⑱ Pipe B |
| ⑪ Belt cover | ⑫⑲ Lock washer |
| ⑫ Bracket | ⑬⑳ Tie-rod |
| ⑬ Pipe E | ⑭㉑ Boot |
| ⑭ Clamp plate | ⑮㉒ Cotter pin |
| ⑮ Pipe F | ⑯㉓ Castle nut |
| ⑯ Universal joint | ⑰㉔ Dust seal |
| ⑰ Dust seal | ⑱㉕ Tie-rod end |
| ⑱ C-ring | ㉒㉖ Spacer |
| ⑲ Oil seal | ㉓㉗ Circlip |
| ⑳ Valve housing | ㉔㉘ Rack stopper |
| ㉑ Packing | ㉕㉙ Oil seal |
| ㉒ Seal ring | ㉖㉚ Rack bushing |
| ㉓ Pinion and valve ASSY | ㉗㉛ O-ring |
| ㉔ Oil seal | ㉘㉜ Rack |
| ㉕ Back-up washer | ㉙㉝ Piston ring |
| ㉖ Ball bearing | ㉚㉞ Tank bracket |
| ㉗ Snap ring | ㉛㉟ O-ring |
| ㉘ Sleeve | |