

8. Lateral Link

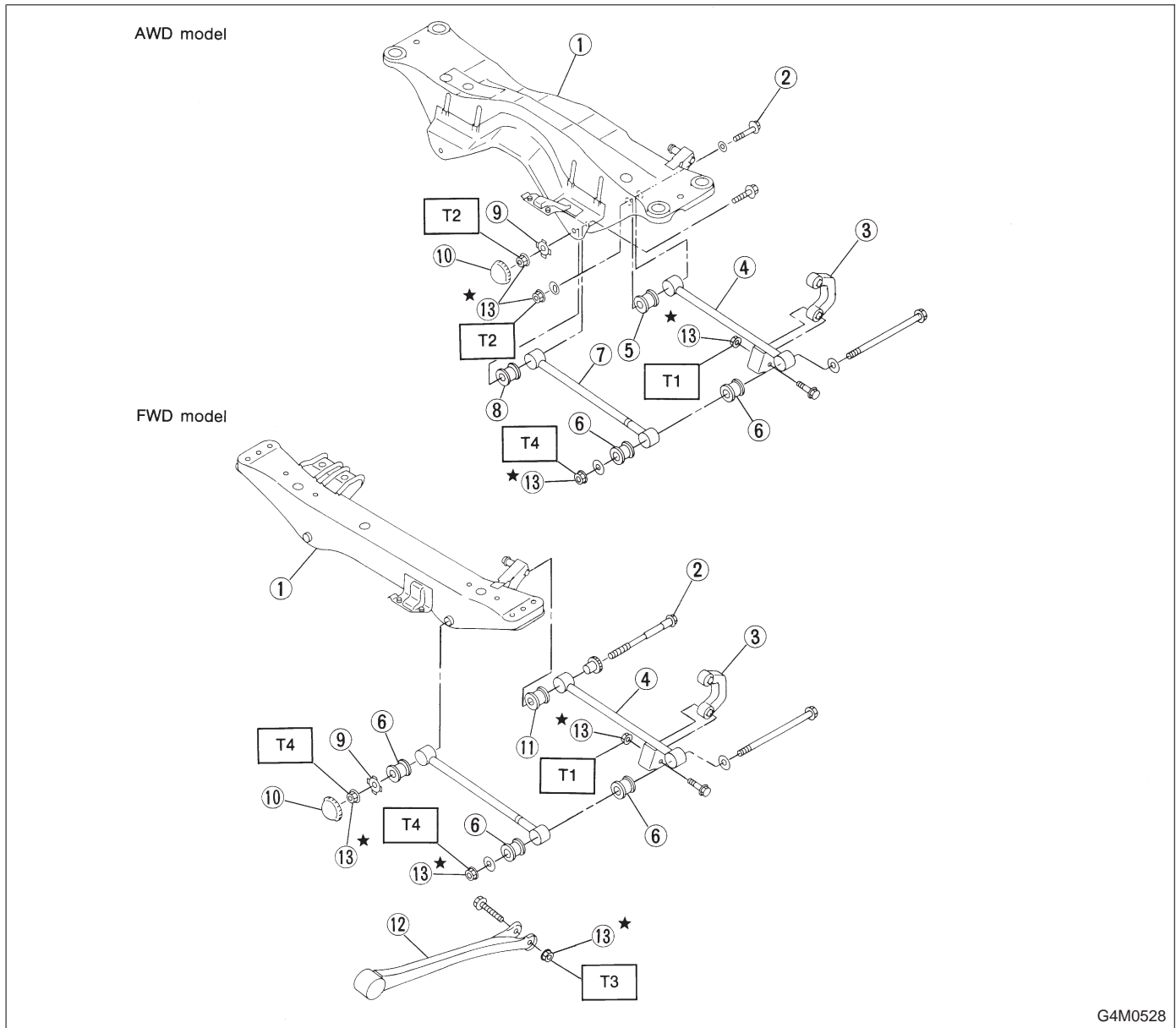

G4M0528

- ① Crossmember
- ② Adjusting bolt
- ③ Stabilizer link
- ④ Rear lateral link
- ⑤ Bushing (C)
- ⑥ Bushing (A)
- ⑦ Front lateral link

- ⑧ Bushing (B)
- ⑨ Washer
- ⑩ Cap
- ⑪ Bushing (D)
- ⑫ Trailing link
- ⑬ Self-locking nut

Tightening torque: N·m (kg·m, ft·lb)
T1: 44±6 (4.5±0.6, 32.5±4.3)
T2: 98±15 (10.0±1.5, 72±11)
T3: 113±15 (11.5±1.5, 83±11)
T4: 137±20 (14.0±2.0, 101±14)

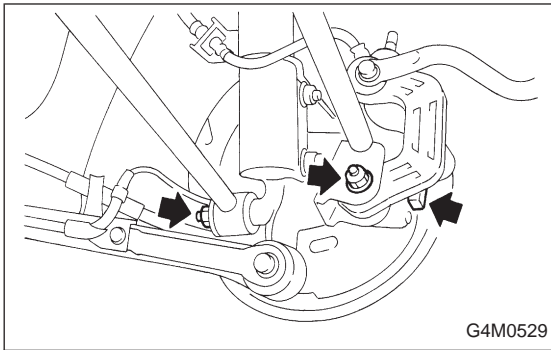
**A: REMOVAL****1. FWD MODEL**

- 1) Remove rear exhaust pipe and muffler.
- 2) Remove stabilizer from rear lateral link.
- 3) Scribe an aligning mark on adjusting bolt, adjusting wheel and crossmember.
- 4) Remove bolts securing lateral links to housing.
- 5) Turn cap (lateral link) counterclockwise until it contacts stopper, then remove cap.
- 6) While holding adjusting bolt head with a wrench, loosen self-locking nut.

CAUTION:

Always loosen self-locking nut before turning adjusting bolt.

7) Lateral link removal

(1) Left lateral links

Remove adjusting bolt and front and rear lateral links.

(2) Right lateral links

Remove bolts securing crossmember to car body.

Remove adjusting bolt and front and rear lateral links.

2. AWD MODEL

- 1) Loosen wheel nuts. Jack-up vehicle and remove wheel.
- 2) Remove stabilizers.
- 3) (Models equipped with A.B.S.)
Remove A.B.S. sensor harness from trailing link.

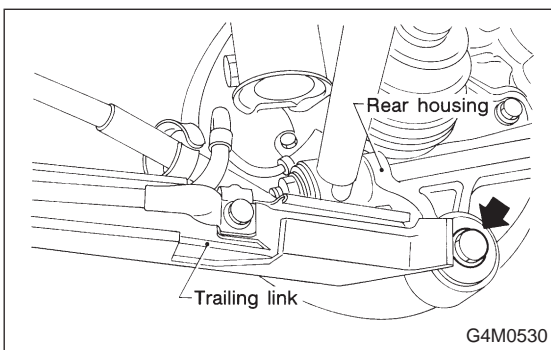

- 4) Remove bolt securing trailing link to housing.
- 5) Remove DOJ from differential. <Ref. to 4-2 [W4A2].>
- 6) Scribe an alignment mark on rear lateral link adjusting bolt and crossmember.
- 7) Remove outer lateral link bolt securing lateral link to housing.
- 8) Remove bolts securing front and rear lateral links to crossmember, detach lateral links.

CAUTION:

To loosen adjusting bolt, always loosen nut while holding the head of adjusting bolt.

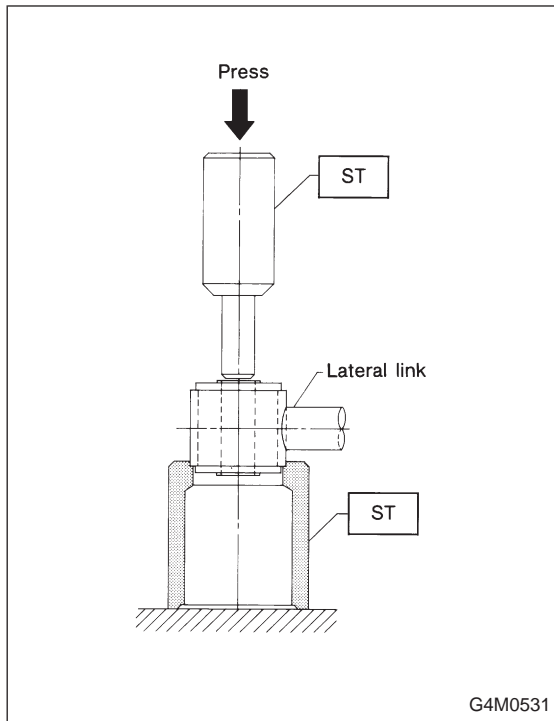

B: DISASSEMBLY

Using ST, press bushing out of place.

NOTE:

- Using the following figure as a guide, verify the type of bushings.
- Select ST according to the type of bushings used.

Bushing	INSTALLER & REMOVER SET
Bushing A	927700000
Bushing B	927690000
Bushing C	927700000
Bushing D	927710000

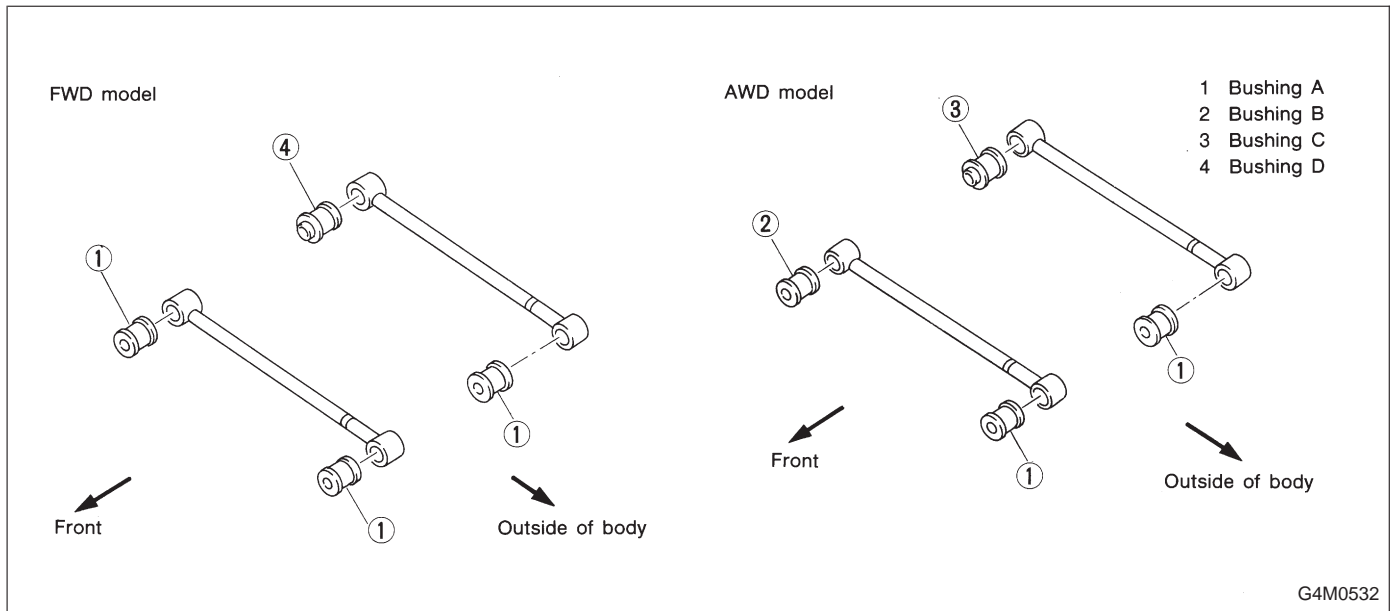

C: INSPECTION

Visually check lateral links for damage or bends.

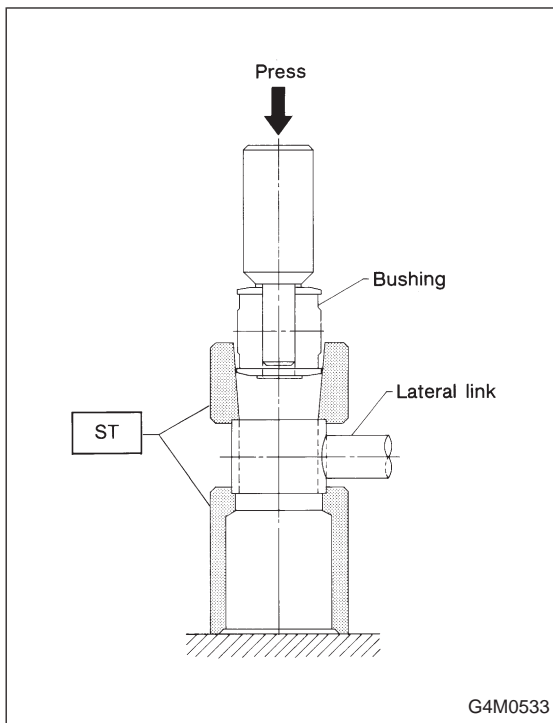

D: ASSEMBLY

Using ST, press bushing into place.

CAUTION:

Select ST according to the type of bushings used.

NOTE:

Use the same ST as that used during disassembly.

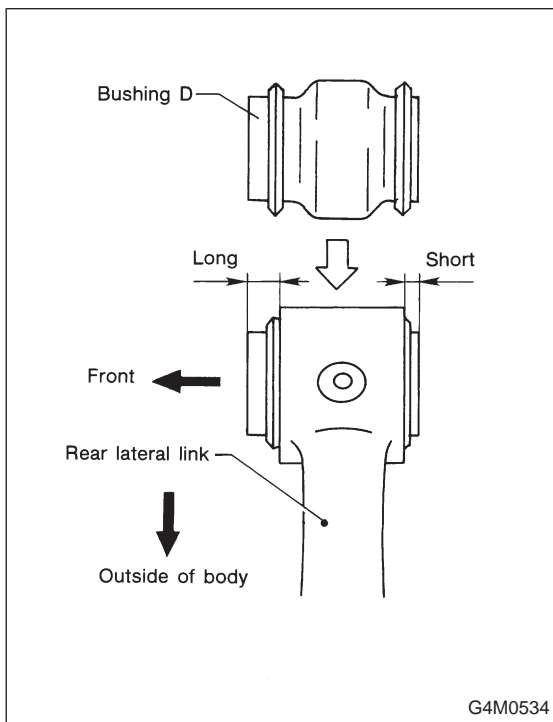

NOTE:

Pay attention to the direction of bushing "D" as shown in figure.

E: INSTALLATION

To install, reverse removal procedures, observing the following instructions.

CAUTION:

- **Always tighten rubber bushing location when wheels are in full contact with the ground and vehicle is curb weight.**
- **Tighten nut when installing adjusting bolt.**
- **Replace self-locking nut and DOJ circlip with new ones.**

NOTE:

- Lateral link washers for FWD and AWD models can be identified by colors, as follows:
 - Olive (FWD model)
 - Gold (AWD model)
- Check wheel alignment and adjust if necessary.