

# 10. Rear Crossmember (FWD Model)

## A: REMOVAL

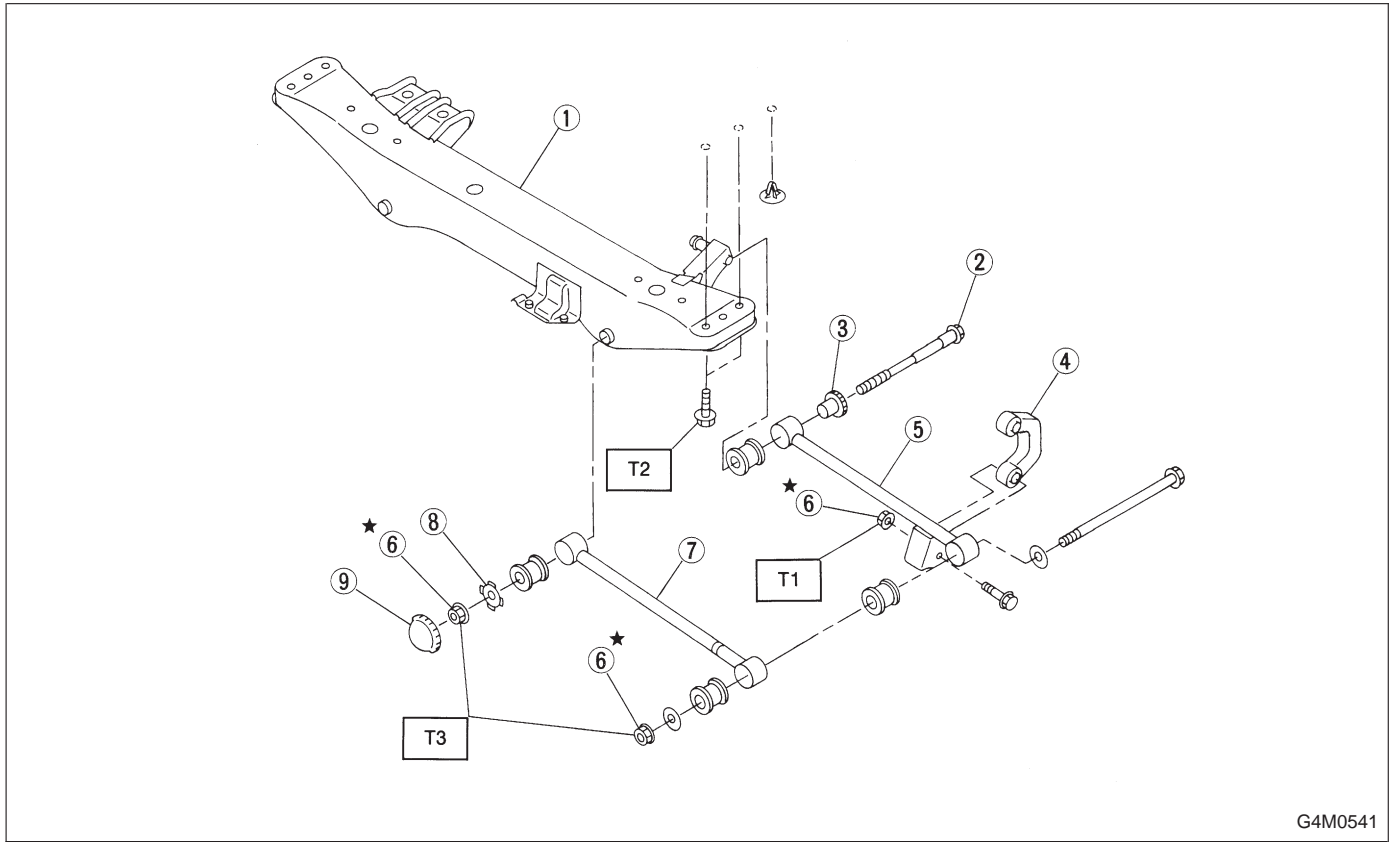

G4M0541

- |                     |                      |
|---------------------|----------------------|
| ① Crossmember       | ⑥ Self-locking nut   |
| ② Adjusting bolt    | ⑦ Front lateral link |
| ③ Adjusting wheel   | ⑧ Washer             |
| ④ Stabilizer link   | ⑨ Cap                |
| ⑤ Rear lateral link |                      |

**Tightening torque: N·m (kg·m, ft·lb)**  
**T1: 44±6 (4.5±0.6, 32.5±4.3)**  
**T2: 127±20 (13.0±2.0, 94±14)**  
**T3: 137±20 (14.0±2.0, 101±14)**

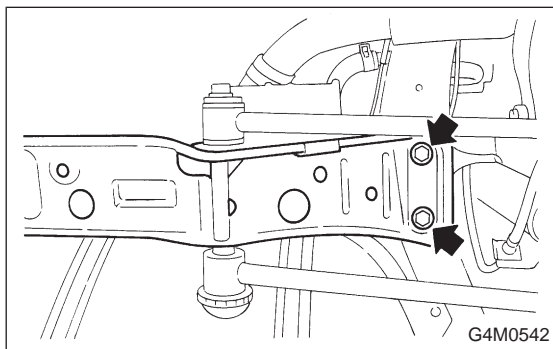

G4M0542

- 1) Disconnect lateral links from housing.
- 2) Remove rear exhaust pipe and muffler.
- 3) Remove heat-shield cover.
- 4) Remove four bolts securing crossmember to body.

**B: INSPECTION**

Check removed parts for wear, damage and cracks, and correct or replace if defective.

**C: INSTALLATION**

Installation is in reverse order of removal procedure.

**CAUTION:**

- Discard loosened self-locking nut and replace with a new one.
- Always tighten nut (not adjusting bolt), when tightening adjusting bolt.
- Always tighten rubber bushing location when wheels are in full contact with the ground and vehicle is curb weight.

**NOTE:**

Check wheel alignment and adjust if necessary.