

5. Drive Pinion Assembly

1. AWD MODEL

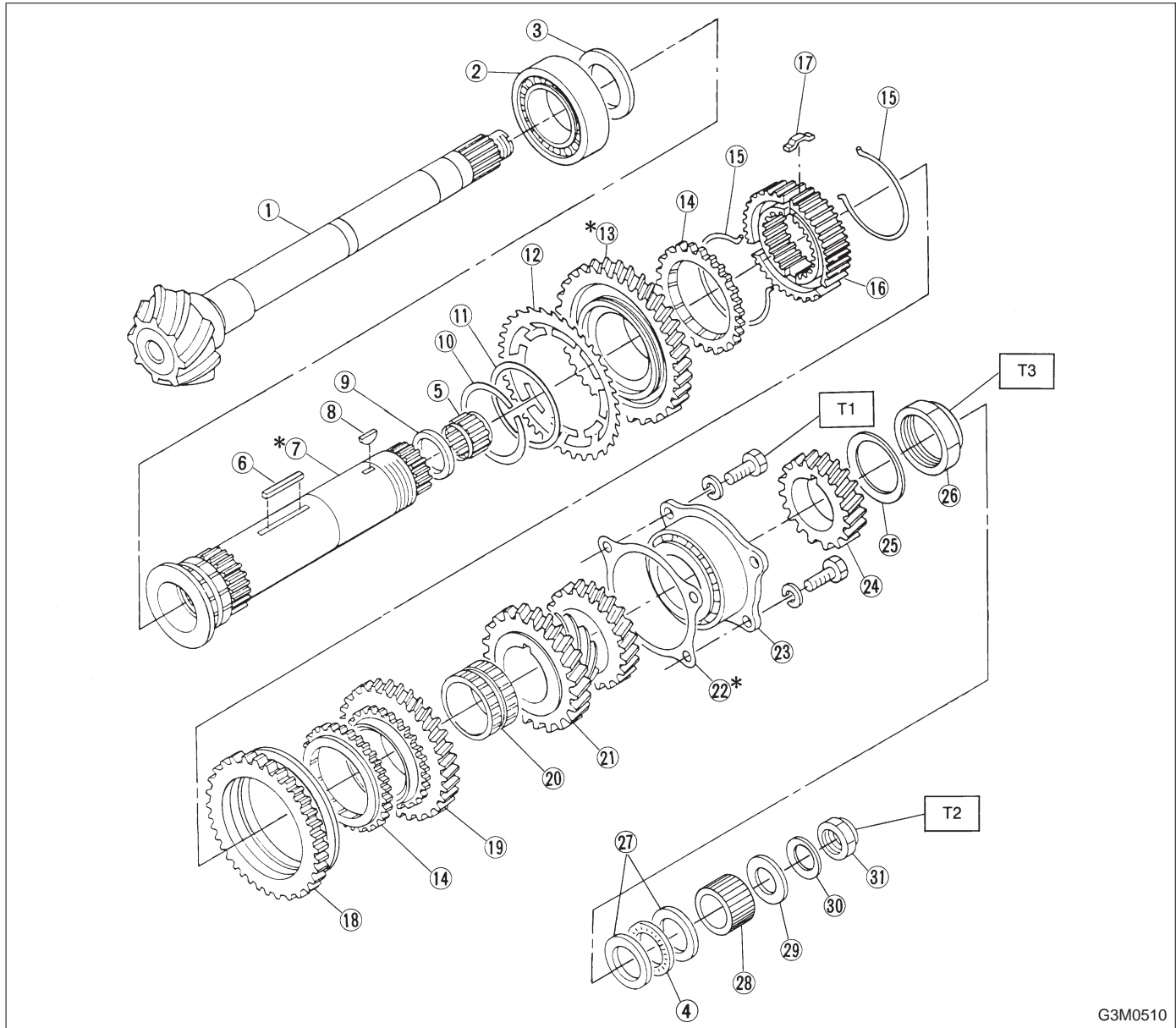

G3M0510

- | | |
|-----------------------|----------------------------|
| ① Drive pinion shaft | ⑭ Bulk ring |
| ② Roller bearing | ⑮ Spring |
| ③ Washer | ⑯ 1st-2nd synchronizer hub |
| ④ Thrust bearing | ⑰ Insert |
| ⑤ Needle bearing | ⑱ Reverse driven gear |
| ⑥ Key | ⑲ 2nd driven gear |
| ⑦ Driven shaft | ⑳ 2nd driven gear bush |
| ⑧ Woodruff key | ㉑ 3rd-4th driven gear |
| ⑨ Drive pinion collar | ㉒ Drive pinion shim |
| ⑩ Snap ring (Outer) | ㉓ Roller bearing |
| ⑪ Washer | ㉔ 5th driven gear |
| ⑫ Sub gear | ㉕ Lock washer |
| ⑬ 1st driven gear | ㉖ Lock nut |

- | |
|----------------------------------|
| ⑳ Washer |
| ㉑ Differential bevel gear sleeve |
| ㉒ Washer |
| ㉓ Lock washer |
| ㉔ Lock nut |

Tightening torque: N·m (kg·m, ft·lb)
T1: 26 — 32 (2.7 — 3.3, 20 — 24)
T2: 110 — 126
(11.2 — 12.8, 81 — 93)
T3: 235 — 255
(24 — 26, 174 — 188)

2. FWD MODEL

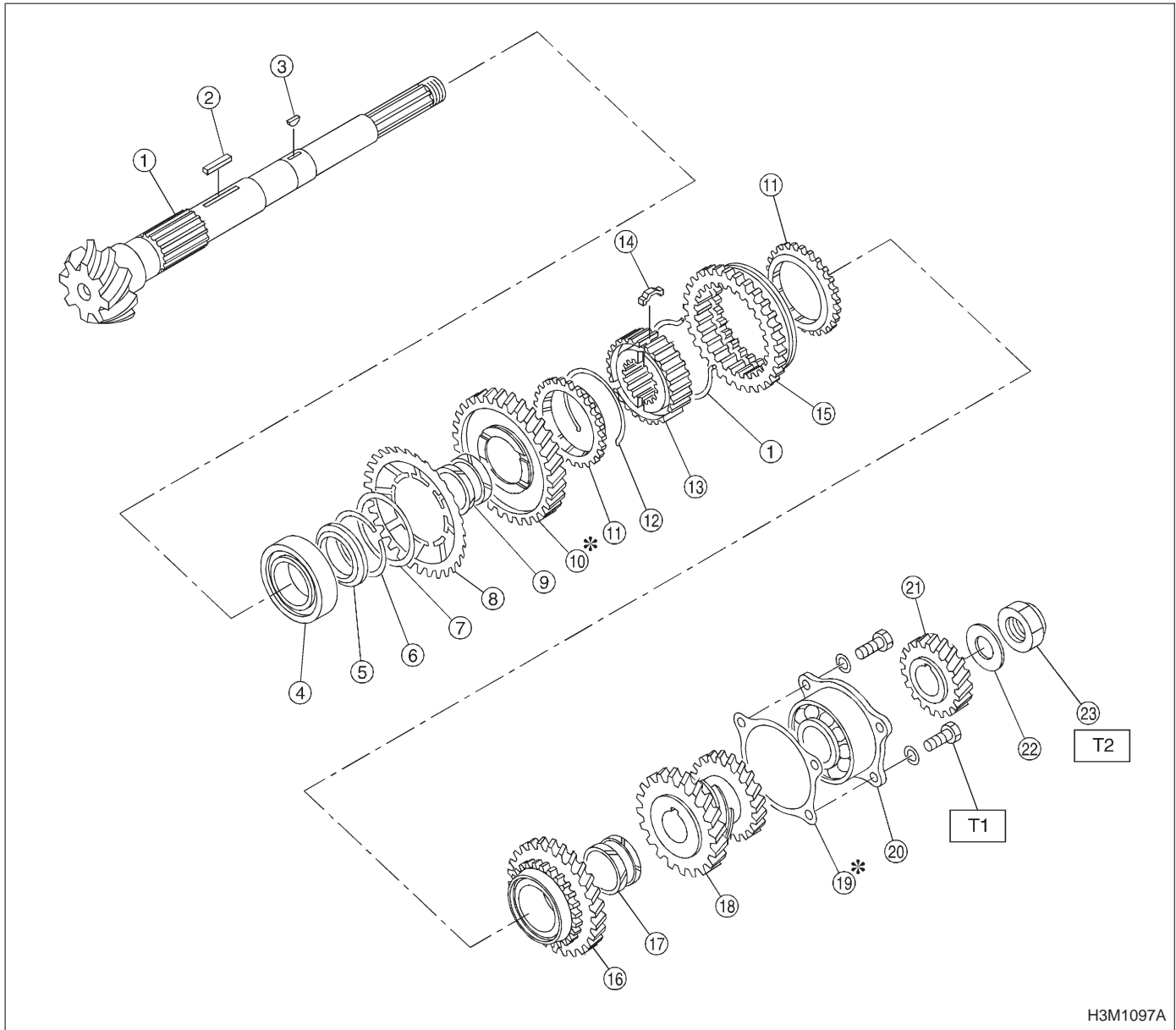

- ① Drive pinion shaft
- ② Key
- ③ Woodruff key
- ④ Roller bearing
- ⑤ 1st gear thrust plate
- ⑥ Snap ring (Outer)
- ⑦ Washer
- ⑧ 1st sub gear
- ⑨ 1st gear bushing
- ⑩ 1st driven gear

- ⑪ 1st-2nd baulk ring
- ⑫ 1st-2nd synchronizer spring
- ⑬ 1st-2nd synchronizer hub
- ⑭ 1st-2nd shifting insert
- ⑮ Reverse driven gear
- ⑯ 2nd driven gear
- ⑰ 2nd gear bushing
- ⑱ 3rd-4th driven gear
- ⑲ Drive pinion shim
- ⑳ Ball bearing

- ㉑ 5th driven gear
- ㉒ Lock washer
- ㉓ Lock nut

Tightening torque: N·m (kg·m, ft·lb)
T1: 29±3 (3.0±0.3, 22±2)
T2: 118±6 (12.0±0.6, 86.8±4.3)