

6. Rear Gate and Glass

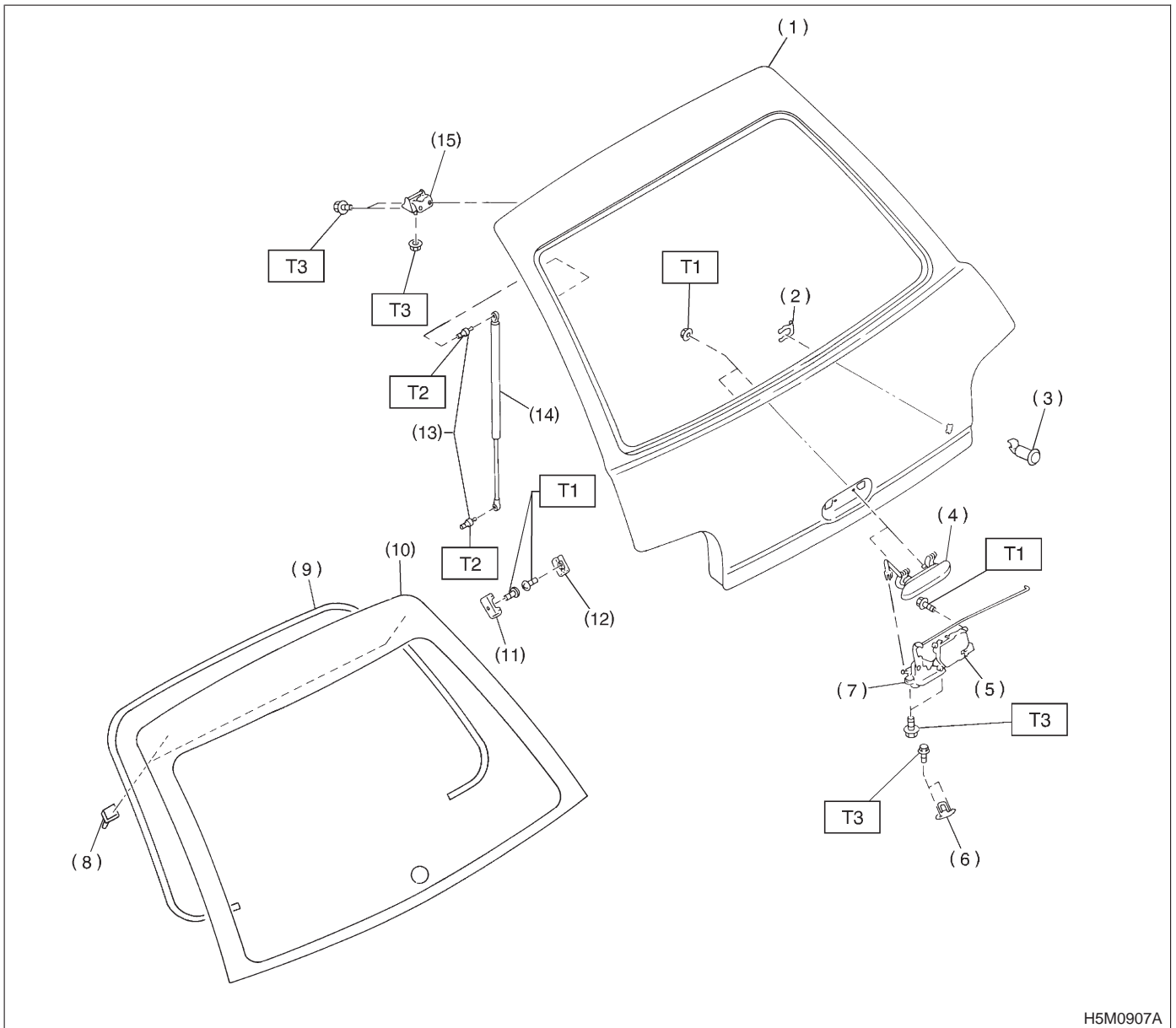

- (1) Rear gate
- (2) Clip
- (3) Key cylinder
- (4) Outer handle
- (5) Auto-door lock actuator
- (6) Striker
- (7) Latch
- (8) Glass pin
- (9) Trim
- (10) Glass
- (11) Buffer
- (12) Rear gate side buffer
- (13) Stud
- (14) Gas stay

- (15) Hinge

Tightening torque: N-m (kg-m, ft-lb)
T1: 7.4±2.0 (0.75±0.2, 5.4±1.4)
T2: 14±4 (1.4±0.4, 10.1±2.9)
T3: 25±5 (2.5±0.5, 18.1±3.6)