

B: INSTALLATION

CAUTION:

Leave fuel filler cap open when tightening nuts, to prevent fuel from flowing out through fuel delivery and return pipes. Close fuel filler cap after tightening nuts.

Installation is in the reverse order of removal. Do the following:

- 1) Install the fuel level sensor onto the mounting bracket.

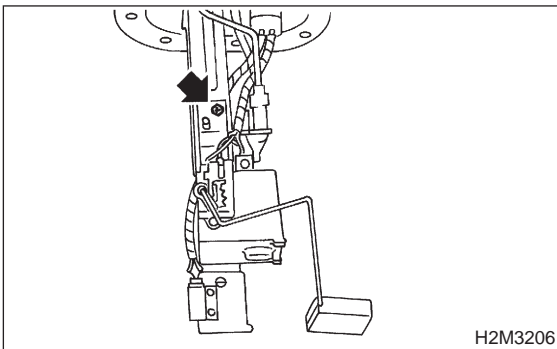

- 2) Always use new gaskets.
- 3) Ensure sealing portion is free from fuel or foreign particles before installation.
- 4) Tighten nuts in alphabetical sequence shown in figure to specified torque.

Tightening torque:

$4.4 \pm 1.5 \text{ N}\cdot\text{m}$ ($0.45 \pm 0.15 \text{ kg}\cdot\text{m}$, $3.3 \pm 1.1 \text{ ft}\cdot\text{lb}$)

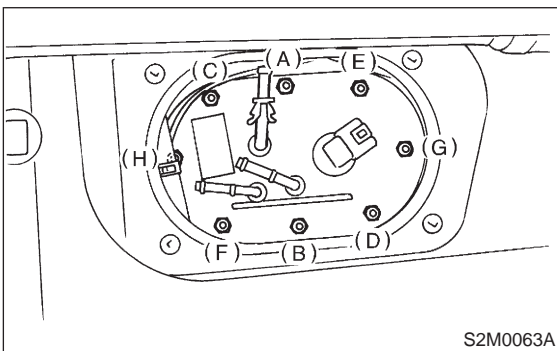

9. Air Filter

A: REMOVAL AND INSTALLATION

- 1) Disconnect battery ground cable.

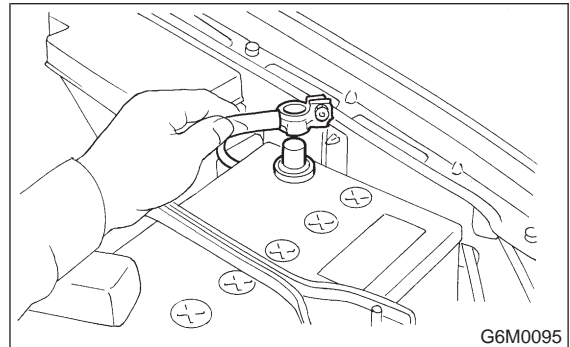

- 2) Lift-up the vehicle.
- 3) Remove canister. <Ref. to 2-1 [W3A0].>

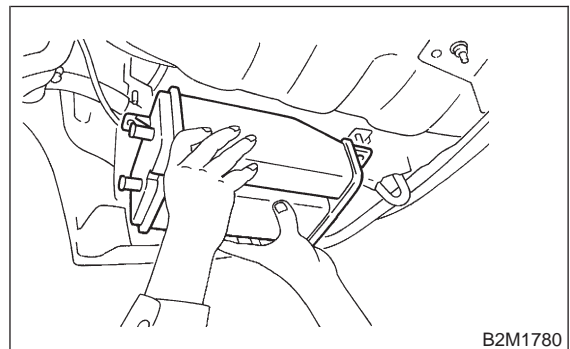

- 4) Disconnect connector from drain valve.

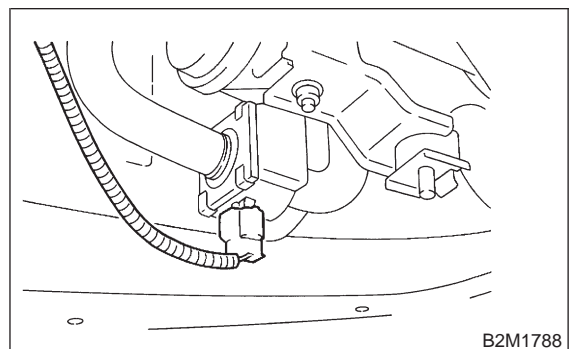

- 5) Disconnect evaporation hoses (A) from joint pipes.

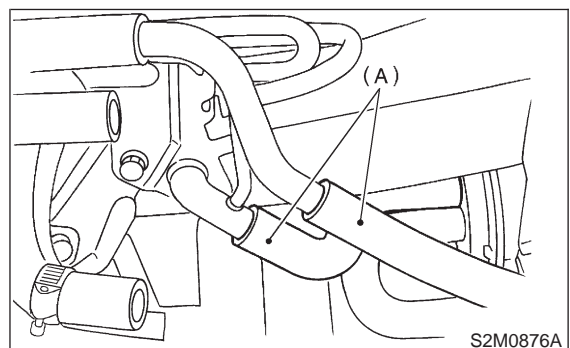

10. Sub Fuel Level Sensor

6) Remove nut which installs air filter and drain valve brackets on body, and remove them as a unit.

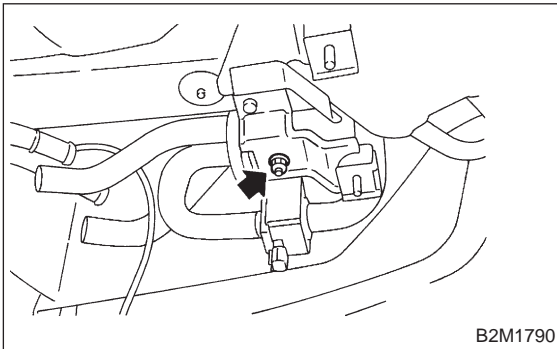

7) Disconnect evaporation hoses, and remove air filter.

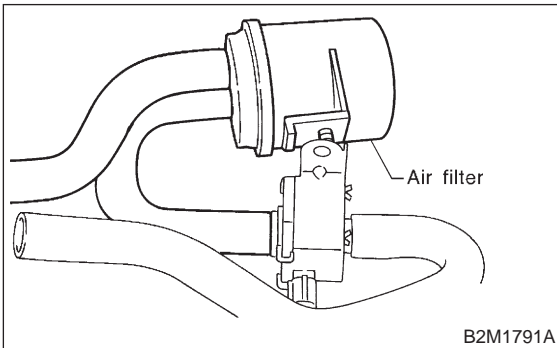

8) Installation is in the reverse order of removal.

Tightening torque:

22.5±7 N·m (2.3±0.7 kg·m, 16.6±5.1 ft·lb)

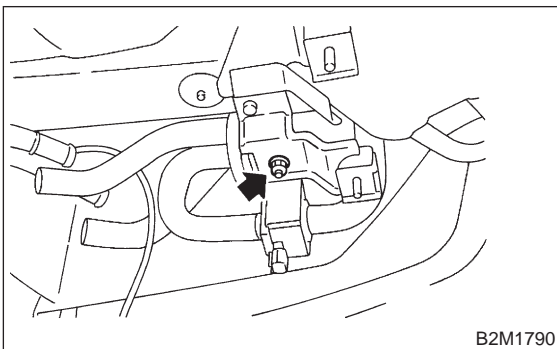

10. Sub Fuel Level Sensor

A: REMOVAL AND INSTALLATION

- 1) Release fuel pressure. <Ref. to 2-8 [W1B0].>
- 2) Open fuel flap lid, and remove fuel filler cap.

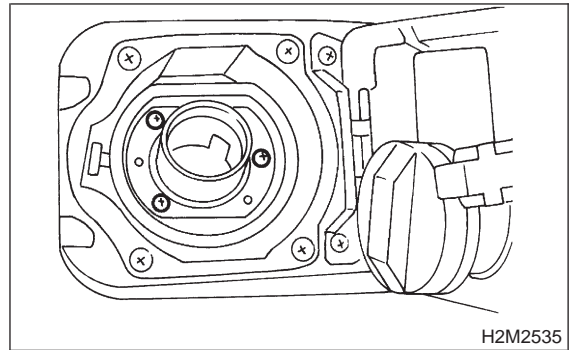

- 3) Disconnect battery ground cable.

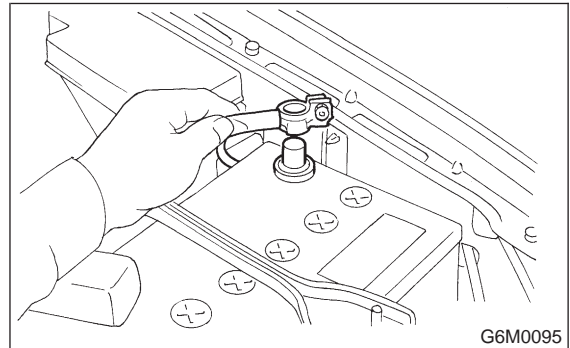

- 4) Remove service hole cover.

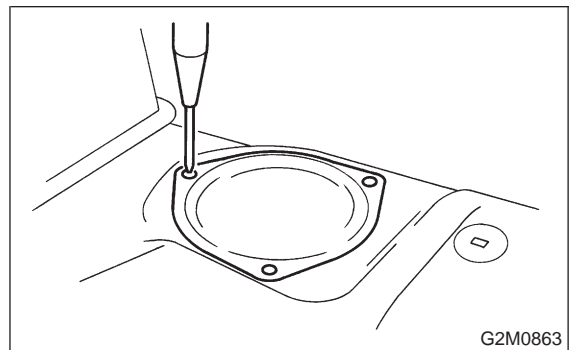

- 5) Disconnect connector from fuel sub meter, and disconnect jet pump hose.

