

5. Fuel Temperature Sensor

A: REMOVAL

- 1) Release fuel pressure. <Ref. to 2-8 [W1B0].>
- 2) Open fuel filler lid, and remove fuel filler cap.

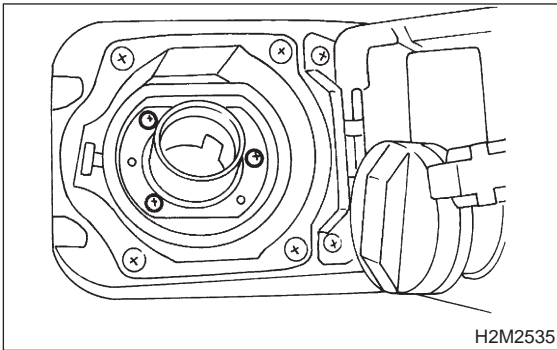

- 3) Disconnect battery ground cable.

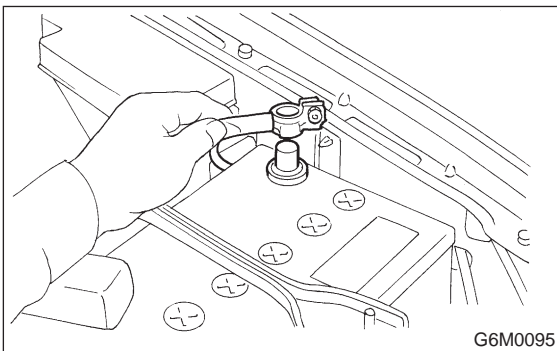

- 4) Disconnect connector from fuel pump.

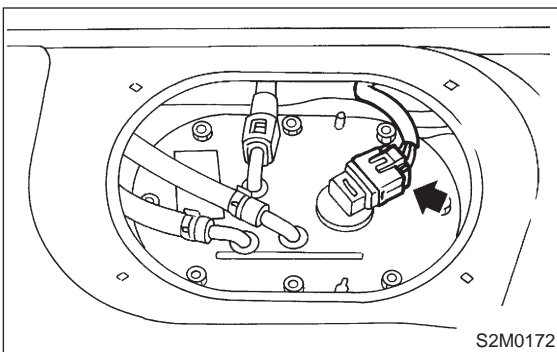

- 5) Move clips, and then disconnect fuel delivery hose (A), return hose (B) and jet pump hose (C).
- 6) Disconnect quick connector, and then disconnect fuel delivery hose (A). <Ref. to 2-8 [W7A0].>

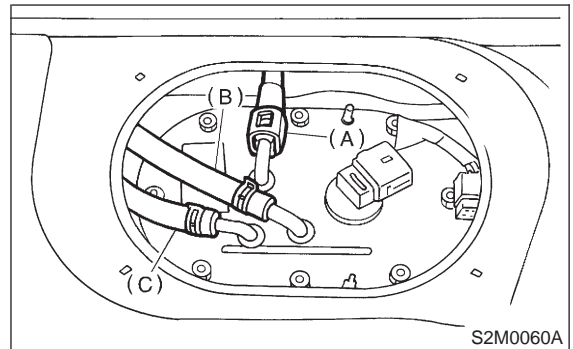

- 7) Remove nuts which install fuel pump assembly onto fuel tank.

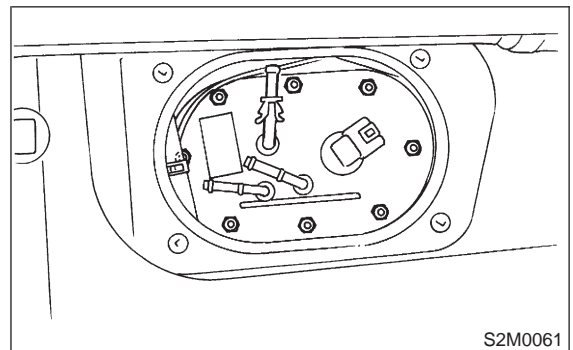

- 8) Take off fuel pump assembly from fuel tank.

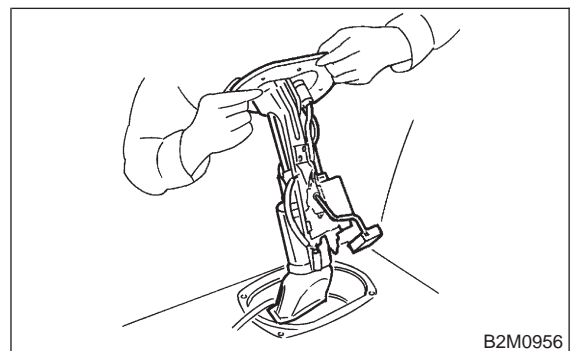

2-1 [W5B0]

5. Fuel Temperature Sensor

SERVICE PROCEDURE

9) Disconnect connector from fuel pump bracket.

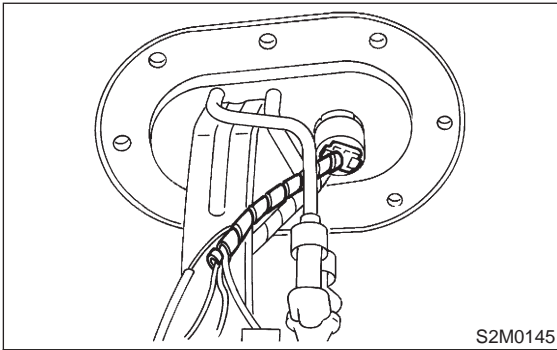

10) Remove main fuel level sensor from fuel pump assembly. <Ref. to 2-1 [W8A0].>

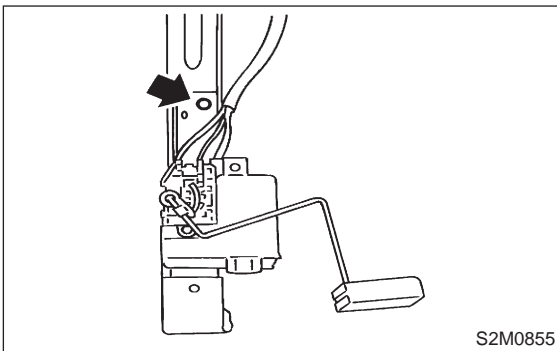

NOTE:

Fuel temperature sensor is a unit with fuel pump.
If replacing it, replace as a fuel pump.

B: INSTALLATION

CAUTION:

Leave fuel filler cap open when tightening nuts, to prevent fuel from flowing out through fuel delivery and return pipes. Close fuel filler cap after tightening nuts.

Installation is in the reverse order of removal. Do the following:

- (1) Always use new gaskets.
- (2) Ensure sealing portion is free from fuel or foreign particles before installation.
- (3) Tighten nuts in alphabetical sequence shown in figure to specified torque.

Tightening torque:

$4.4 \pm 1.5 \text{ N}\cdot\text{m}$ ($0.45 \pm 0.15 \text{ kg}\cdot\text{m}$, $3.3 \pm 1.1 \text{ ft}\cdot\text{lb}$)

