

4) Installation is in the reverse order of removal.

Tightening torque:

$4.4 \pm 0.5 \text{ N}\cdot\text{m}$ ($0.45 \pm 0.05 \text{ kg}\cdot\text{m}$, $3.3 \pm 0.4 \text{ ft}\cdot\text{lb}$)

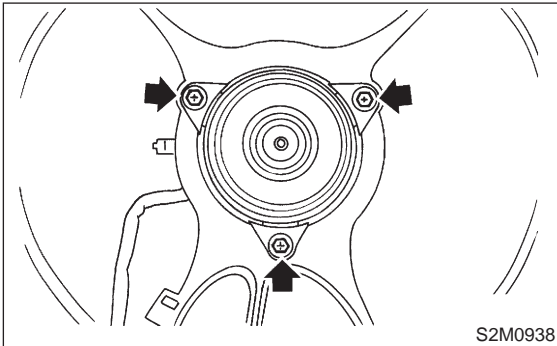

Tightening torque:

$3.4 \pm 0.5 \text{ N}\cdot\text{m}$ ($0.35 \pm 0.05 \text{ kg}\cdot\text{m}$, $2.5 \pm 0.4 \text{ ft}\cdot\text{lb}$)

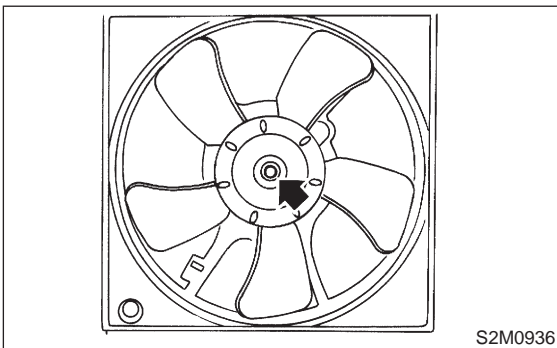

7. Radiator Sub Fan and Fan Motor

A: REMOVAL AND INSTALLATION

1) Disconnect battery ground cable.

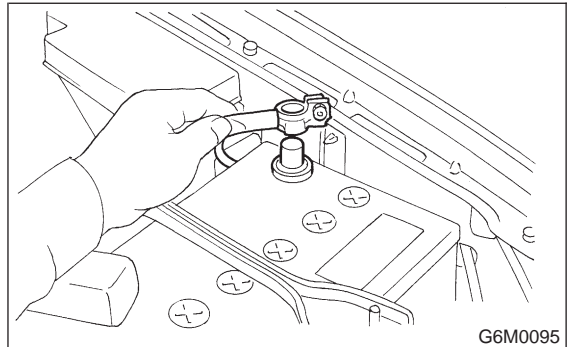

2) Lift-up the vehicle.
3) Remove under cover.

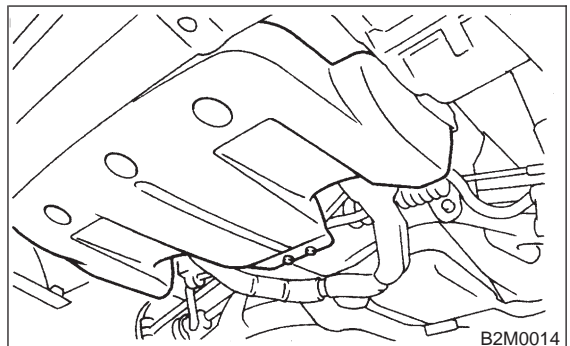

4) Disconnect connector of sub fan motor.

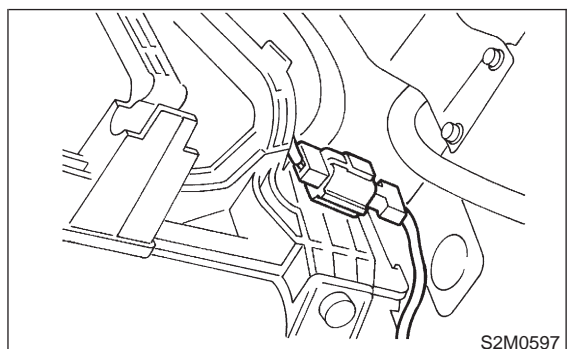

7. Radiator Sub Fan and Fan Motor

- 5) Lower the vehicle.
- 6) Remove V-belt covers.

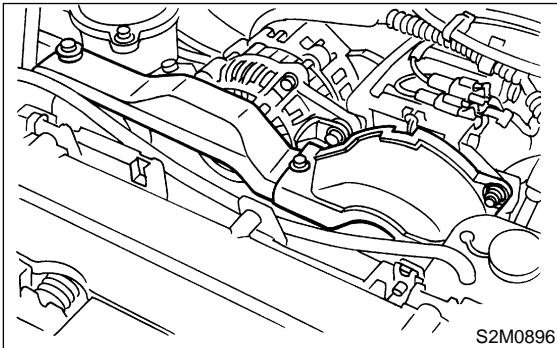

- 7) Remove bolts which hold sub fan shroud to radiator.
- 8) Remove radiator sub fan motor assembly.

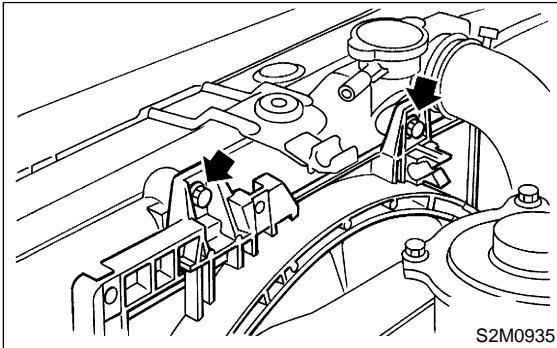

- 9) Installation is in the reverse order of removal.

Tightening torque:

$4.9 \pm 1.5 \text{ N}\cdot\text{m}$ ($0.50 \pm 0.15 \text{ kg}\cdot\text{m}$, $3.6 \pm 1.1 \text{ ft}\cdot\text{lb}$)

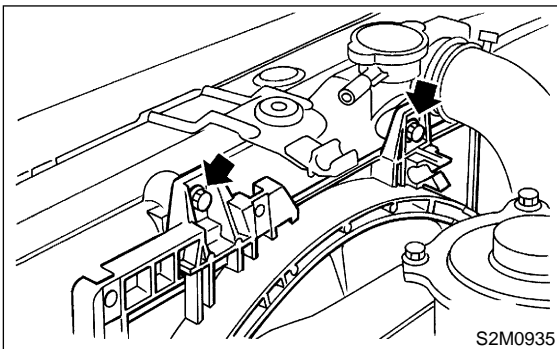

B: DISASSEMBLY AND ASSEMBLY

- 1) Remove clip which holds motor harness onto shroud.

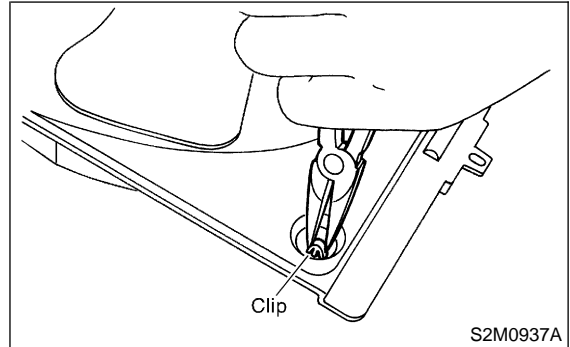

- 2) Remove nut which install fan itself onto fan motor and shroud assembly.

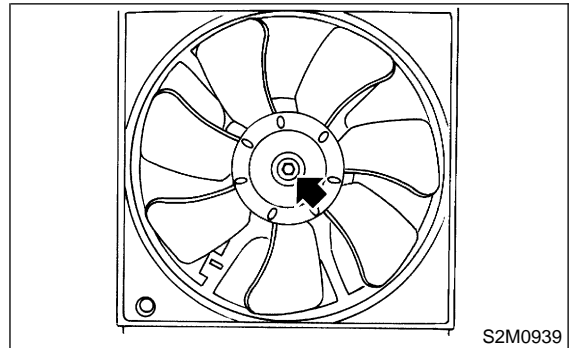

- 3) Remove bolts which install fan motor onto shroud.

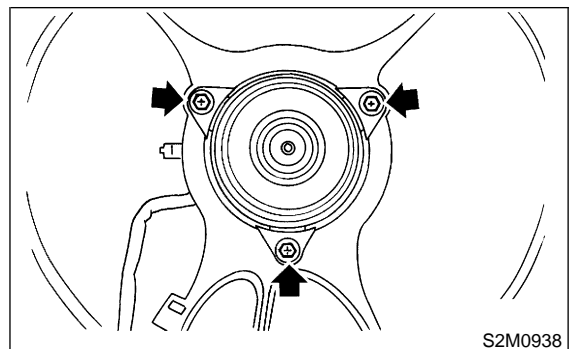

4) Installation is in the reverse order of removal.

Tightening torque:

$4.4 \pm 0.5 \text{ N}\cdot\text{m}$ ($0.45 \pm 0.05 \text{ kg}\cdot\text{m}$, $3.3 \pm 0.4 \text{ ft}\cdot\text{lb}$)

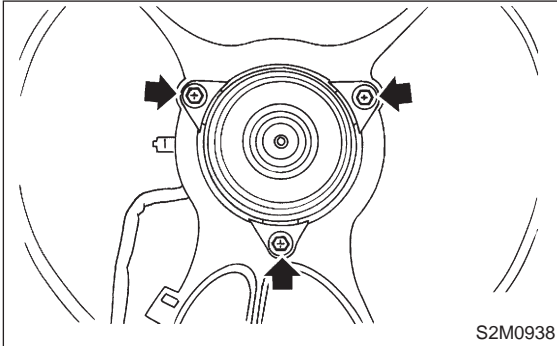

Tightening torque:

$3.4 \pm 0.5 \text{ N}\cdot\text{m}$ ($0.35 \pm 0.05 \text{ kg}\cdot\text{m}$, $2.5 \pm 0.4 \text{ ft}\cdot\text{lb}$)

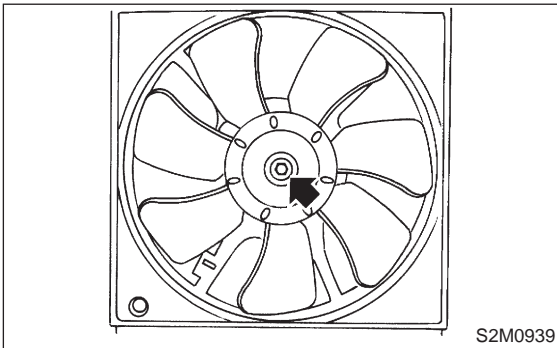

8. Water Pipe

A: REMOVAL

- 1) Release fuel pressure.
<Ref. to 2-8 [W1B0].>
- 2) Open fuel flap lid, and remove fuel filler cap.

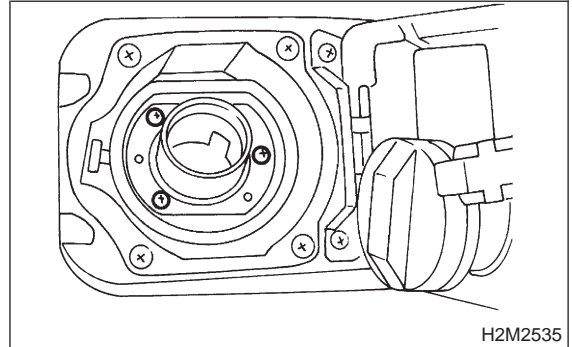

- 3) Disconnect ground cable from battery.

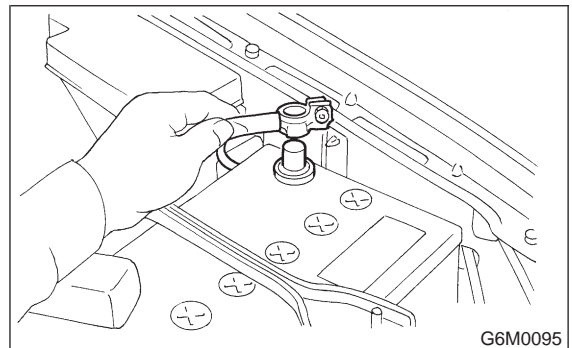

- 4) Lift-up the vehicle.
- 5) Remove under cover.

