

11. Pressure Sensor

A: REMOVAL AND INSTALLATION

- 1) Disconnect battery ground cable.

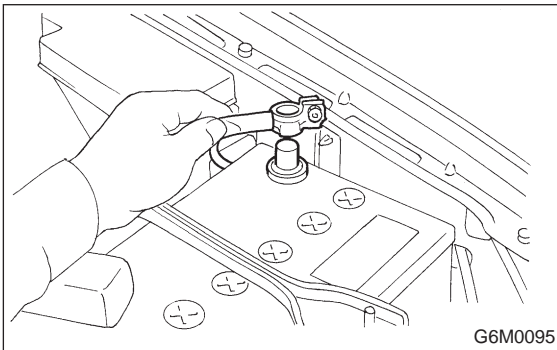

- 2) Disconnect connector from pressure sensor.
- 3) Disconnect hose from pressure sensor.

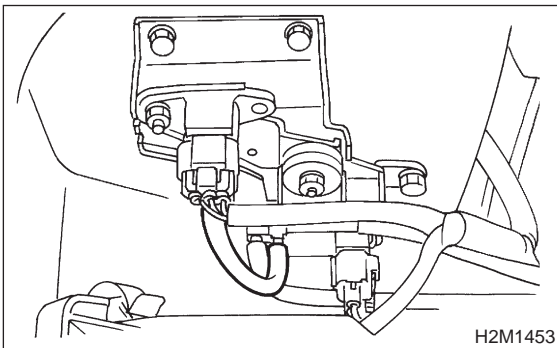

- 4) Remove pressure sensor from bracket.

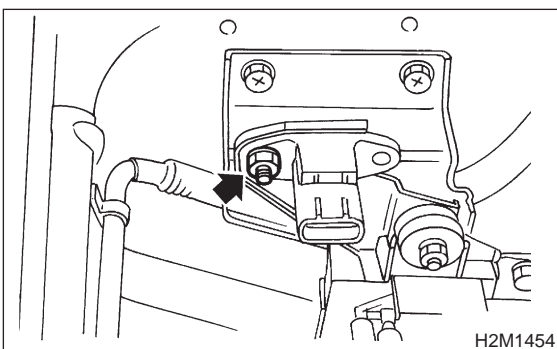

- 5) Installation is in the reverse order of removal.

Tightening torque:

$6.4 \pm 0.5 \text{ N}\cdot\text{m}$ ($0.65 \pm 0.05 \text{ kg}\cdot\text{m}$, $4.7 \pm 0.4 \text{ ft}\cdot\text{lb}$)

12. Idle Air Control Solenoid Valve

A: REMOVAL AND INSTALLATION

1. 2200 cc CALIFORNIA SPEC. VEHICLES

- 1) Disconnect battery ground cable.

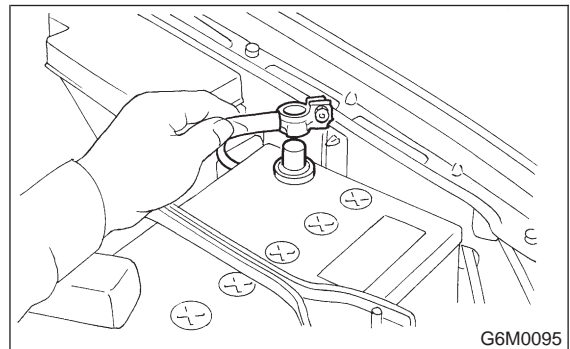

- 2) Disconnect connector from idle air control solenoid valve.

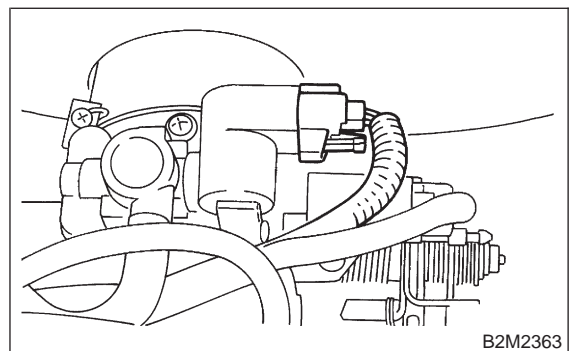

- 3) Disconnect air by-pass hose from idle air control solenoid valve.

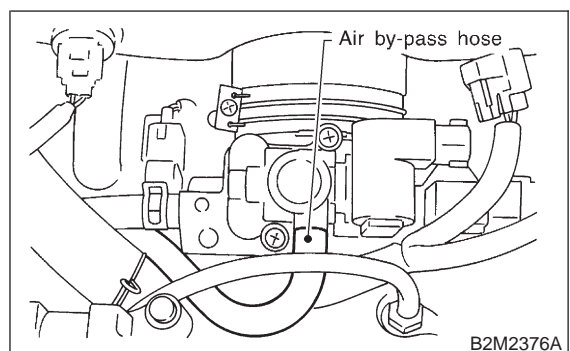

2-7 [W12A2]

SERVICE PROCEDURE

12. Idle Air Control Solenoid Valve

4) Remove idle air control solenoid valve from throttle body.

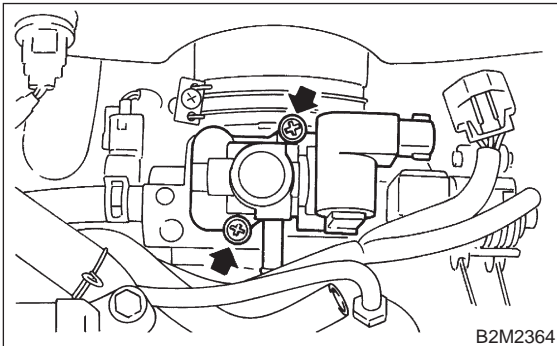

2) Disconnect connector from idle air control solenoid valve.

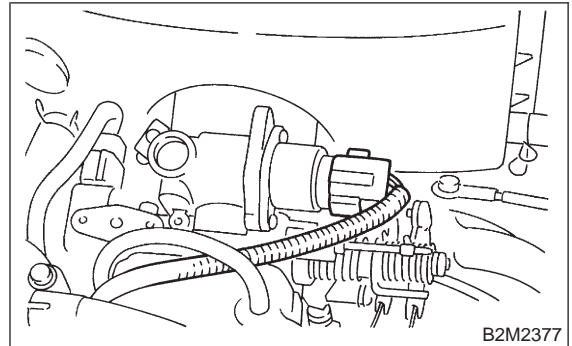

5) Installation is in the reverse order of removal.

CAUTION:

Replace gasket with a new one.

Tightening torque:

3.3 ± 0.4 N·m (0.34 ± 0.045 kg·m, 2.5 ± 0.3 ft·lb)

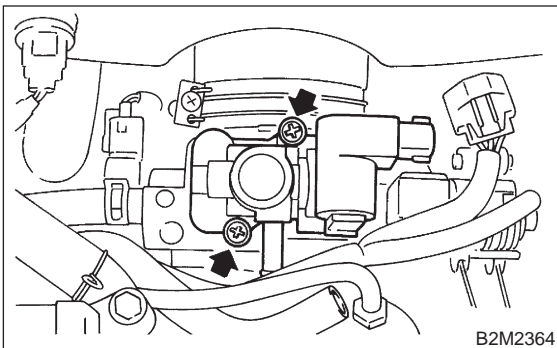

3) Remove idle air control solenoid valve from throttle body.

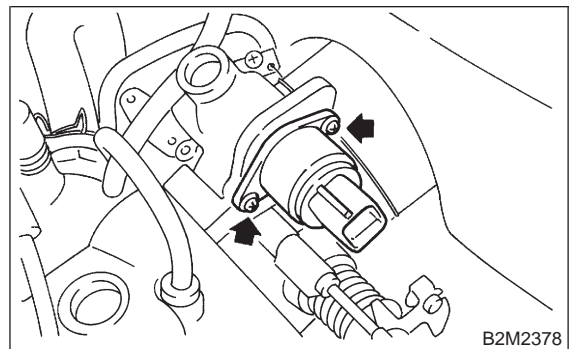

4) Installation is in the reverse order of removal.

CAUTION:

Replace gasket with a new one.

Tightening torque:

6.0 ± 0.8 N·m (0.61 ± 0.08 kg·m, 4.4 ± 0.6 ft·lb)

2. EXCEPT 2200 cc CALIFORNIA SPEC. VEHICLES

1) Disconnect battery ground cable.

