

9. Fuel Cut Valve

A: REMOVAL AND INSTALLATION

- 1) Remove fuel tank. <Ref. to 2-8 [W2A0].>

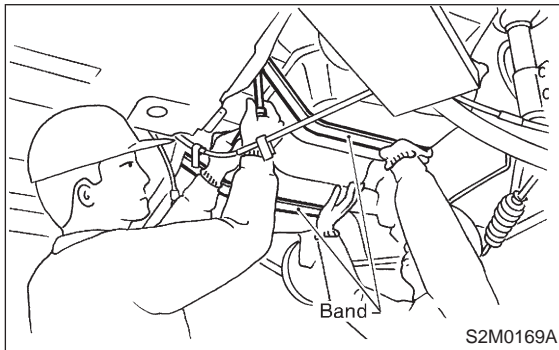

- 2) Disconnect evaporation hose from fuel cut valve.
- 3) Remove fuel cut valve.

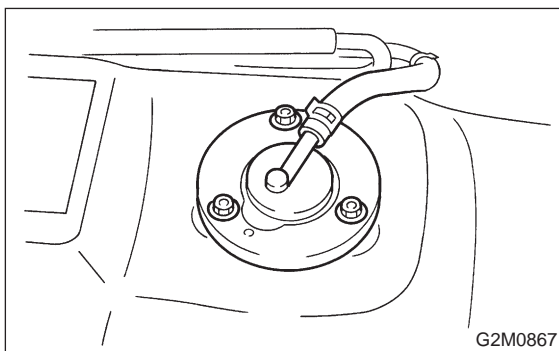

- 4) Installation is in the reverse order of removal procedure.

Tightening torque:

$4.4 \pm 1.5 \text{ N}\cdot\text{m}$ ($0.45 \pm 0.15 \text{ kg}\cdot\text{m}$, $3.3 \pm 1.1 \text{ ft}\cdot\text{lb}$)

10. Fuel Sub Meter Unit

A: REMOVAL AND INSTALLATION

- 1) Disconnect battery ground cable.

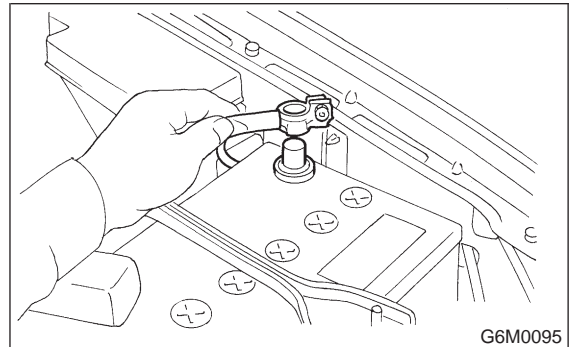

- 2) Remove fuel filler cap.
- 3) Remove service hole cover.

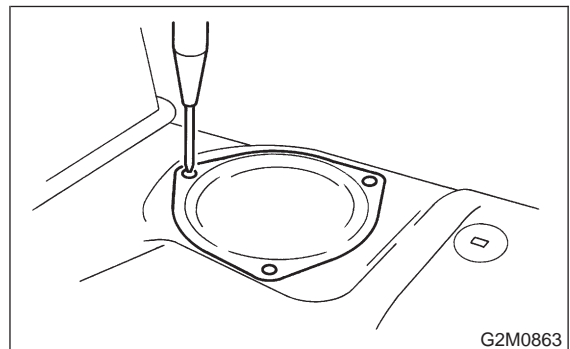

- 4) Disconnect connector from fuel sub meter, and disconnect jet pump hose.

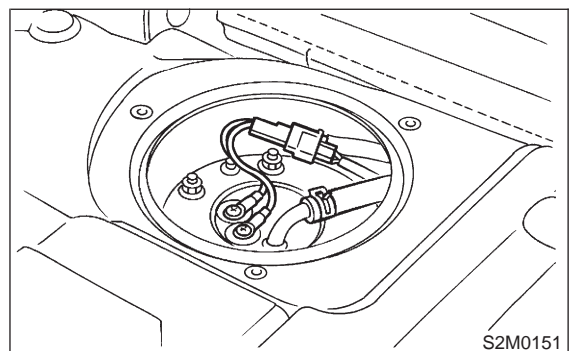

2-8 [W10A0]

10. Fuel Sub Meter Unit

SERVICE PROCEDURE

5) Remove bolts which install fuel sub meter unit on fuel tank.

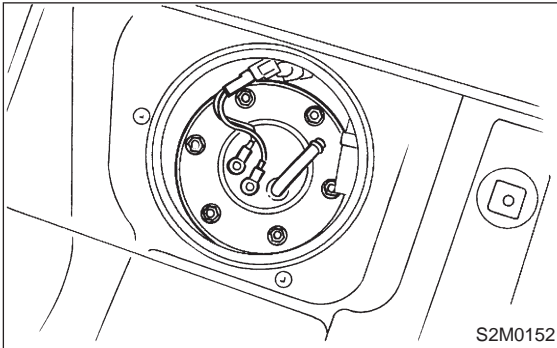

6) Remove fuel sub meter unit.

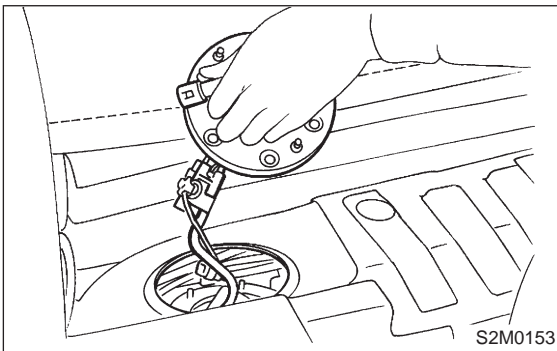

7) Installation is in the reverse order of removal.

Tightening torque:

T: 4.4 ± 1.5 N·m (0.45 ± 0.15 kg·m, 3.3 ± 1.1 ft·lb)

