

2. Power Steering System

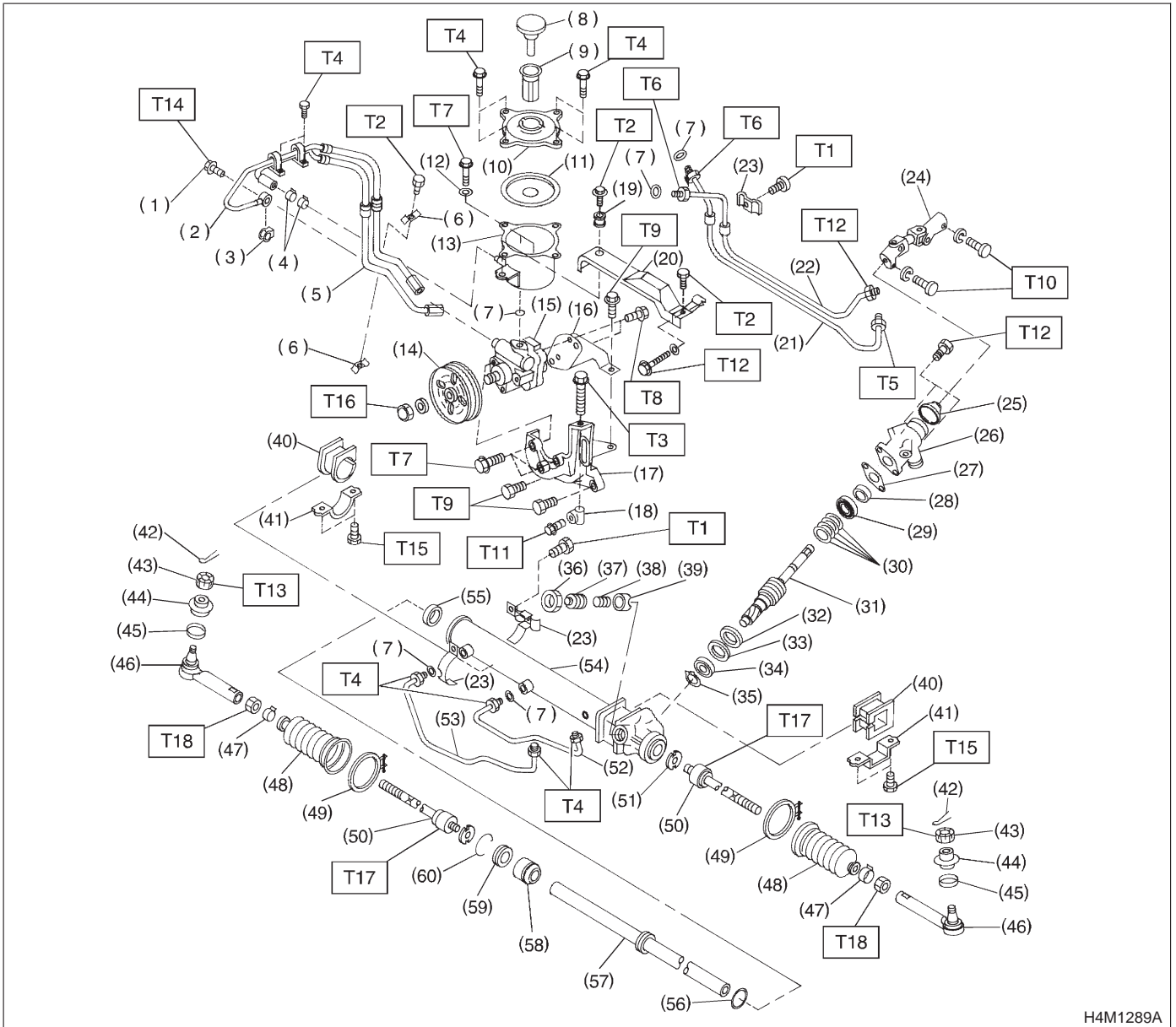

H4M1289A

## 4-3 [C200]

### 2. Power Steering System

## COMPONENT PARTS

---

(1) Eye bolt	(29) Special bearing	(57) Rack
(2) Pipe C	(30) Seal ring	(58) Rack bushing
(3) Gasket	(31) Pinion and valve ASSY	(59) Rack stopper
(4) Clip	(32) Oil seal	(60) Circlip
(5) Pipe D	(33) Back-up washer	
(6) Clamp E	(34) Ball bearing	<hr/>
(7) O-ring	(35) Snap ring	<b>Tightening torque: N-m (kg-m, ft-lb)</b>
(8) Cap	(36) Lock nut	<b>T1: 6±1 (0.6±0.1, 4.3±0.7)</b>
(9) Strainer	(37) Adjusting screw	<b>T2: 7.4±2.0 (0.75±0.20, 5.4±1.4)</b>
(10) Shell upper	(38) Spring	<b>T3: 8±2 (0.8±0.2, 5.8±1.4)</b>
(11) Baffle	(39) Sleeve	<b>T4: 13±3 (1.3±0.3, 9.4±2.2)</b>
(12) Seal washer	(40) Adapter	<b>T5: 15±3 (1.5±0.3, 10.8±2.2)</b>
(13) Shell lower	(41) Clamp	<b>T6: 15±5 (1.5±0.5, 10.8±3.6)</b>
(14) Pulley	(42) Cotter pin	<b>T7: 18<sup>+5</sup>/<sub>0</sub> (1.8<sup>+0.5</sup>/<sub>0</sub>, 13.0<sup>+3.6</sup>/<sub>0</sub>)</b>
(15) Oil pump	(43) Castle nut	<b>T8: 20.1±2.5 (2.05±0.25, 14.8±1.8)</b>
(16) Stiffener	(44) Dust seal	<b>T9: 22±2 (2.2±0.2, 15.9±1.4)</b>
(17) Bracket	(45) Clip	<b>T10: 24±3 (2.4±0.3, 17.4±2.2)</b>
(18) Belt tension nut	(46) Tie-rod end	<b>T11: 25±2 (2.5±0.2, 18.1±1.4)</b>
(19) Bush	(47) Clip	<b>T12: 25±5 (2.5±0.5, 18.1±3.6)</b>
(20) Belt cover	(48) Boot	<b>T13: 27.0±2.5 (2.75±0.25, 19.9±1.8)</b>
(21) Pipe E	(49) Band	<b>T14: 39±5 (4.0±0.5, 28.9±3.6)</b>
(22) Pipe F	(50) Tie-rod	<b>T15: 59±12 (6.0±1.2, 43±9)</b>
(23) Clamp plate	(51) Lock washer	<b>T16: 61±7 (6.2±0.7, 44.8±5.1)</b>
(24) Universal joint	(52) Pipe B	<b>T17: 78±10 (8.0±1.0, 58±7)</b>
(25) Dust cover	(53) Pipe A	<b>T18: 83±5 (8.5±0.5, 61.5±3.6)</b>
(26) Valve housing	(54) Steering body	<hr/>
(27) Gasket	(55) Oil seal	
(28) Oil seal	(56) Piston ring	