

Brought to you by Eris Studios
NOT FOR RESALE

CRUISE CONTROL SYSTEM

1. General Description

A: COMPONENT

1. NON-TURBO MODEL AND TURBO MODEL (EXCEPT FOR STI MODEL)

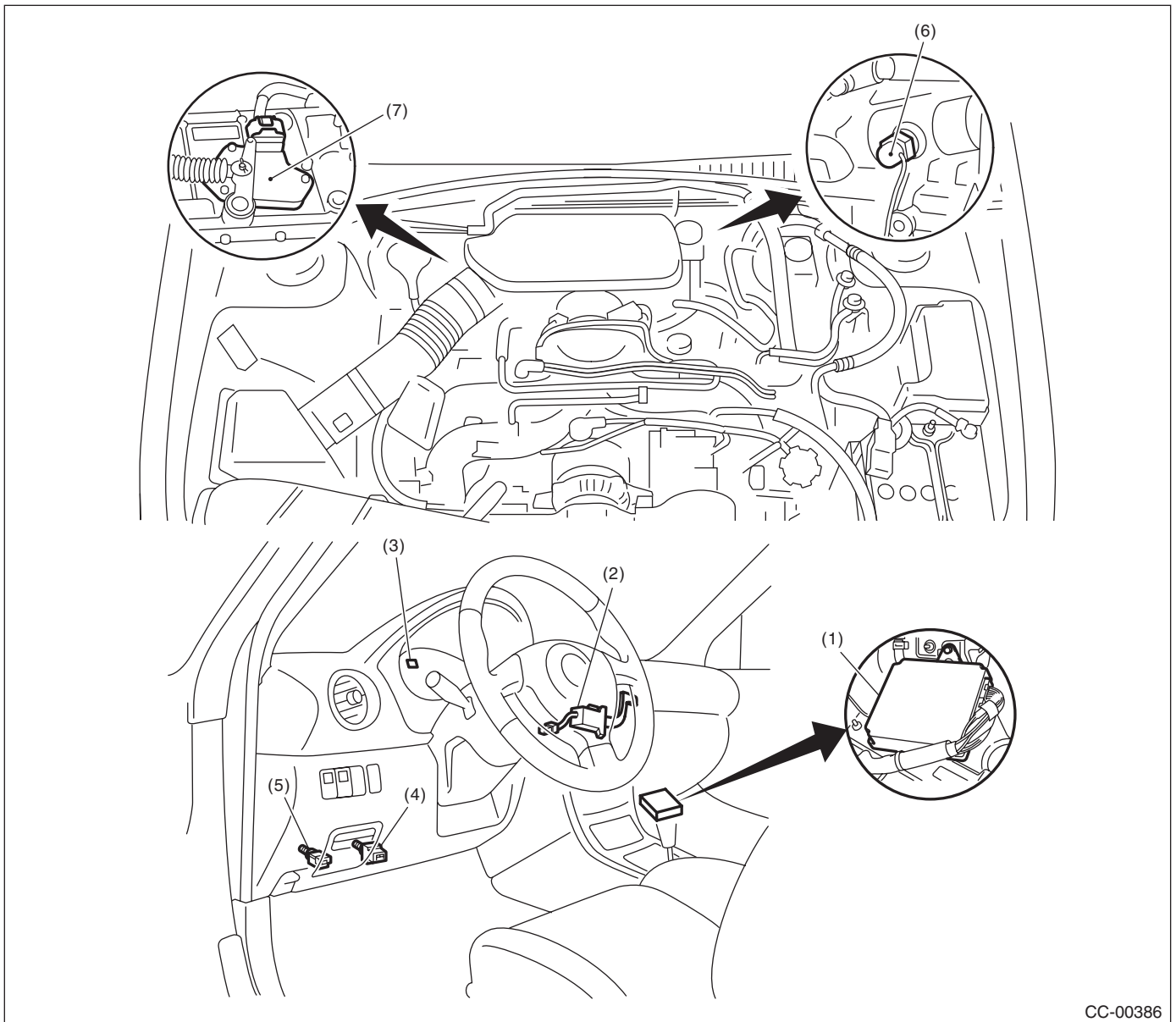

CC-00386

- (1) Engine control module (ECM)
- (2) Cruise control command switch (with built-in main switch)
- (3) Cruise indicator light and cruise set indicator light
- (4) Stop light and brake switch
- (5) Clutch switch (MT model)
- (6) Neutral position switch (MT model)
- (7) Inhibitor switch (AT model)

2. STI MODEL

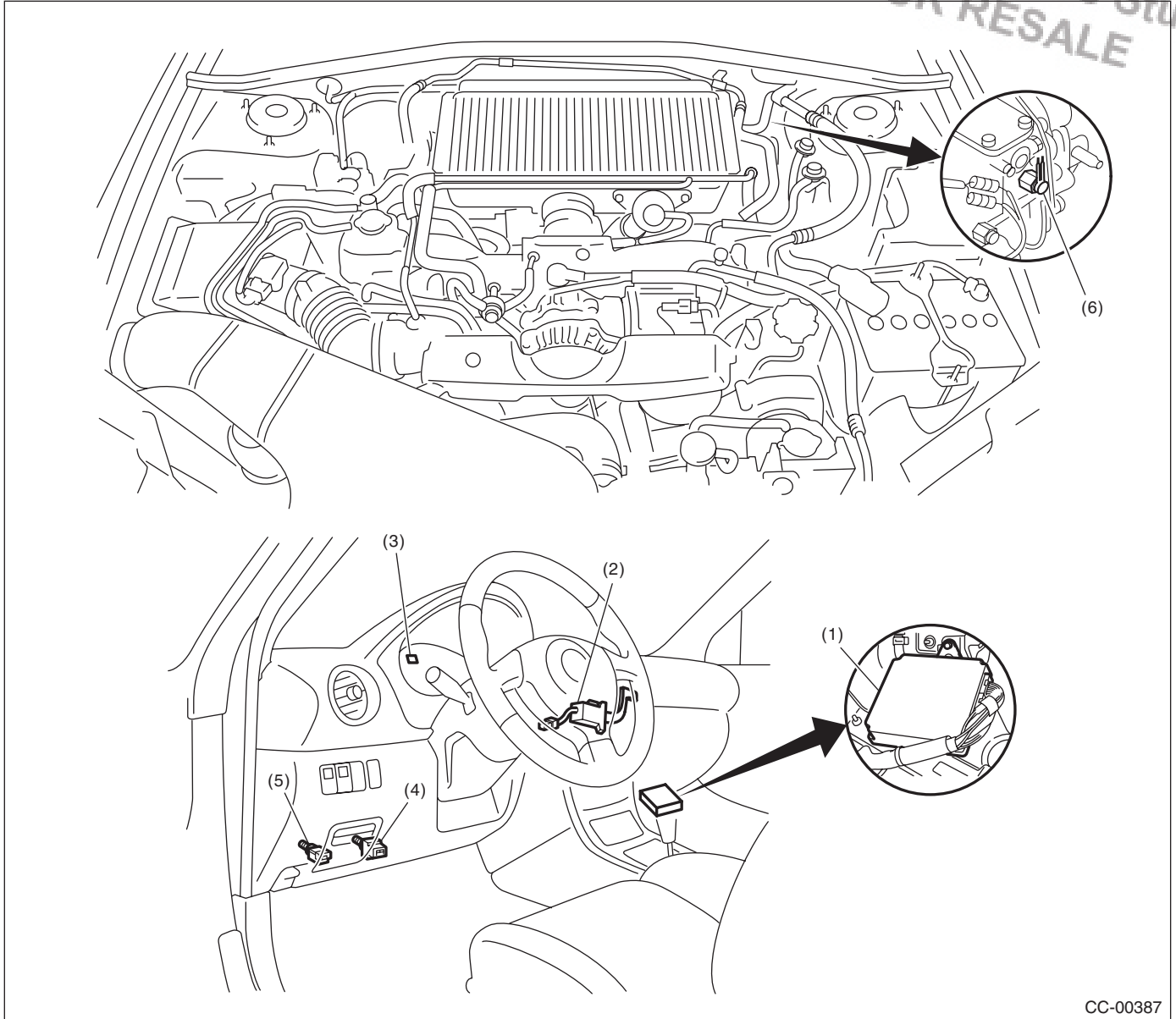

CC-00387

- (1) Engine control module (ECM)
- (2) Cruise control command switch (with built-in main switch)
- (3) Cruise indicator light and cruise set indicator light
- (4) Stop light and brake switch
- (5) Clutch switch
- (6) Neutral position switch

B: CAUTION

- Before disassembling or reassembling parts, always disconnect the battery ground cable from battery. When repairing the radio, control module, etc. which are provided with memory functions, record the memory contents before disconnecting the ground cable from battery.
- Reassemble the parts in the reverse order of disassembly unless otherwise indicated.
- Adjust the parts to specifications specified in this manual.
- Connect the connectors and hoses securely during reassembly.

- After reassembly, ensure functional parts operate properly.

C: PREPARATION TOOL

TOOL NAME	REMARKS
Circuit tester	Used for measuring resistance and voltage.

2. Cruise Control Unit

A: REMOVAL

NOTE:

The control of cruise control system is carried out in engine control module (ECM).

1. NON-TURBO MODEL

<Ref. to FU(H4SO)-39, REMOVAL, Engine Control Module (ECM).>

2. TURBO MODEL

<Ref. to FU(H4DOTC)-50, REMOVAL, Engine Control Module (ECM).>

3. STI MODEL

<Ref. to FU(H4DOTC)-50, REMOVAL, Engine Control Module (ECM).>

B: INSTALLATION

1. NON-TURBO MODEL

<Ref. to FU(H4SO)-39, INSTALLATION, Engine Control Module (ECM).>

2. TURBO MODEL

<Ref. to FU(H4DOTC)-50, INSTALLATION, Engine Control Module (ECM).>

3. STI MODEL

<Ref. to FU(H4DOTC)-50, INSTALLATION, Engine Control Module (ECM).>

3. Cruise Control Command Switch

A: REMOVAL

WARNING:

Before servicing, be sure to read the notes in the "AB" section for proper handling of the driver's airbag module. <Ref. to AB-3, CAUTION, General Description.>

- 1) Set the front wheels in straight ahead position.
- 2) Turn the ignition switch to OFF.
- 3) Disconnect the ground cable from battery and wait for at least 20 seconds before starting work.
- 4) Using TORX® bit T30 (1), loosen two TORX® bolts which secure the driver's airbag module.

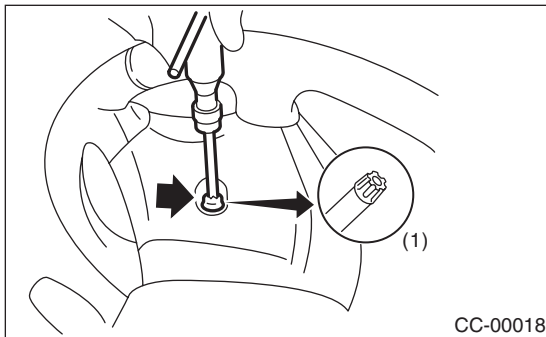

- 5) Disconnect the airbag module connector on back of the airbag module.
- 6) Remove the steering wheel. <Ref. to PS-18, REMOVAL, Steering Wheel.>
- 7) Remove the four screws to remove the lower cover from steering wheel.

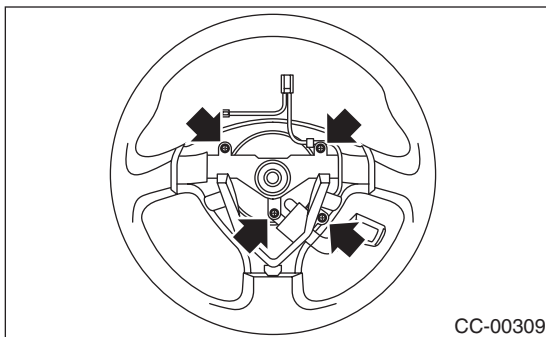

- 8) Remove one screw to remove the cruise control command switch from lower cover.

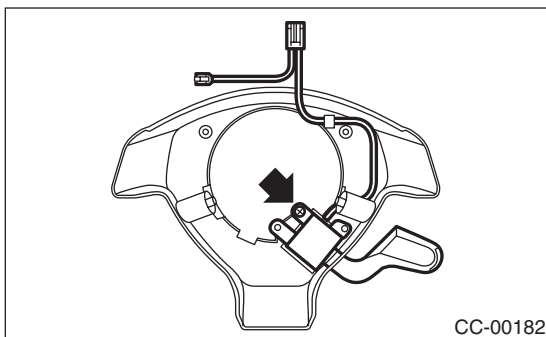

B: INSTALLATION

Install in the reverse order of removal.

C: INSPECTION

Measure the cruise control command switch resistance.

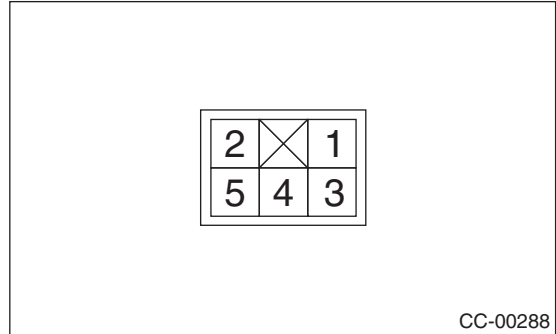

Switch	Position	Terminal No.	Standard
CANCEL	ON	1 (+) and 2 (-)	Less than 1 Ω
	ON	1 (+) and 3 (-)	Less than 1 Ω
SET/COAST	OFF	1 and 2	1 MΩ or more
	ON	1 and 2	Less than 1 Ω
RESUME/ ACCEL	OFF	1 and 3	1 MΩ or more
	ON	1 and 3	Less than 1 Ω
MAIN SWITCH	OFF	5 and 4	1 MΩ or more
	ON	5 and 4	Less than 1 Ω

If NG, replace the cruise control command switch.

Brought to you by Eris Studios
NOT FOR RESALE

4. Stop light and brake Switch

A: REMOVAL

- 1) Disconnect the ground cable from the battery.
- 2) Disconnect the connector from the stop light and brake switch, and then remove the switch. <Ref. to BR-55, REMOVAL, Stop Light Switch.>

B: INSTALLATION

Install in the reverse order of removal.

C: INSPECTION

Measure the resistance of brake switch (A) and stop light switch (B).

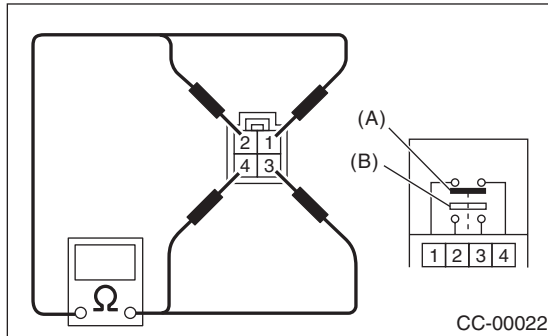

Switch	Pedal	Terminal No.	Standard
Brake	Released	1 and 4	Less than 1 Ω
	Depressed	1 and 4	1 MΩ or more
Stop light	Released	2 and 3	1 MΩ or more
	Depressed	2 and 3	Less than 1 Ω

If NG, replace the stop light and brake switch.

5. Clutch Switch

A: REMOVAL

- 1) Disconnect the ground cable from the battery.
- 2) Disconnect the connector from the clutch switch, and then remove the switch. <Ref. to CL-30, REMOVAL, Clutch Pedal.>

B: INSTALLATION

Install in the reverse order of removal.

C: INSPECTION

Measure the clutch switch resistance.

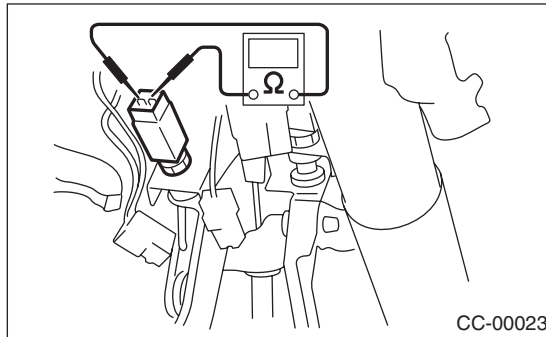

Switch	Pedal	Terminal No.	Standard
Clutch	Released	1 and 2	Less than 1 Ω
	Depressed	1 and 2	1 M Ω or more

If NG, replace the clutch switch.

Brought to you by Eris Studios
NOT FOR RESALE

6. Inhibitor Switch

A: REMOVAL

- 1) Disconnect the ground cable from the battery.
- 2) Disconnect the connector from inhibitor switch, then remove the switch. <Ref. to 4AT-47, REMOVAL, Inhibitor Switch.>

B: INSTALLATION

Install in the reverse order of removal.

C: INSPECTION

Measure the inhibitor switch resistance.

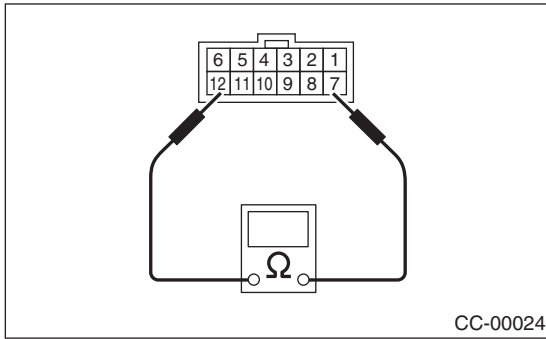

Select lever position	Terminal No.	Standard
P	7 and 12	Less than 1 Ω
N		Less than 1 Ω
Except for P or N		1 MΩ or more

If NG, replace the inhibitor switch.

7. Neutral Position Switch

A: REMOVAL

- 1) Disconnect the ground cable from the battery.
- 2) Disconnect the connector from the neutral position switch, and remove the switch.

5MT model :

<Ref. to 5MT-35, BACK-UP LIGHT SWITCH AND NEUTRAL POSITION SWITCH, REMOVAL, Switches and Harness.>

6MT model :

<Ref. to 6MT-42, REMOVAL, Neutral Position Switch.>

B: INSTALLATION

Install in the reverse order of removal.

C: INSPECTION

Measure the resistance of neutral position switch.

- Non-turbo model

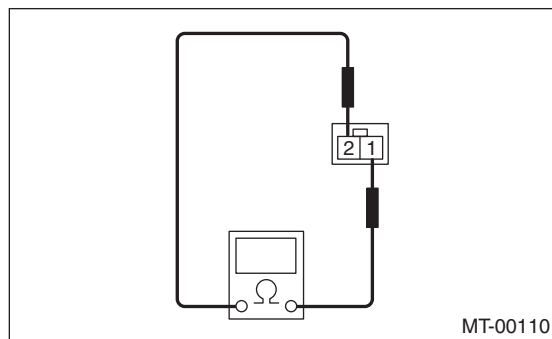

Gear shift position	Terminal No.	Specified resistance
Neutral position	1 and 2	Less than 1 Ω
Other positions		1 MΩ or more

- Turbo model

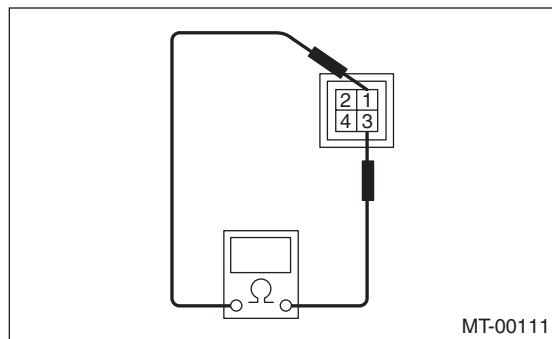

Gear shift position	Terminal No.	Specified resistance
Neutral position	1 and 3	Less than 1 Ω
Other positions		1 MΩ or more

- STI model

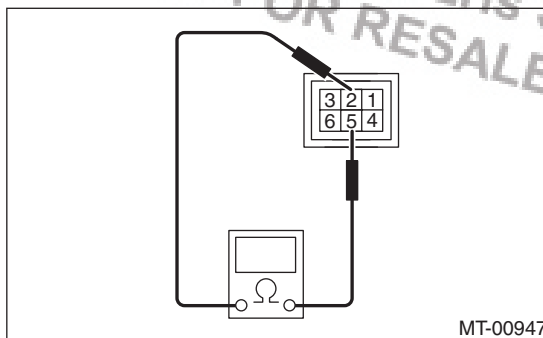

Gear shift position	Terminal No.	Standard
Neutral position	2 and 5	Less than 1 Ω
Other positions		1 MΩ or more

If NG, replace the neutral position switch.

Neutral Position Switch

CRUISE CONTROL SYSTEM

Brought to you by Eris Studios
NOT FOR RESALE