

# 1. Collector Chamber and Intake Manifold

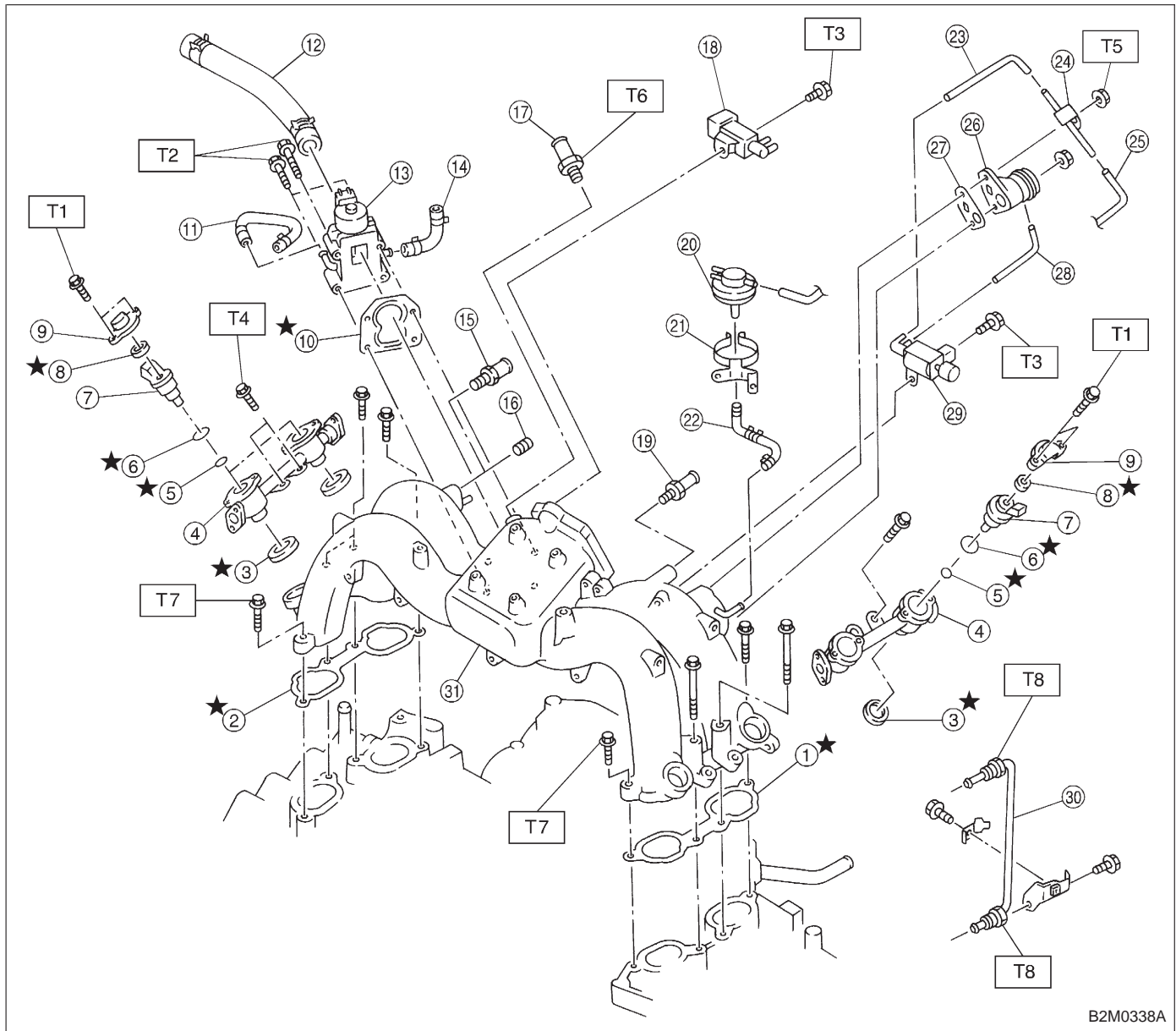

B2M0338A

- |                                   |                      |
|-----------------------------------|----------------------|
| ① Intake manifold gasket RH       | ⑮ Nipple (AT model)  |
| ② Intake manifold gasket LH       | ⑯ Plug               |
| ③ Fuel injector pipe insulator    | ⑰ PCV valve          |
| ④ Fuel injector pipe              | ⑱ Nipple             |
| ⑤ O-ring A                        | ⑳ BPT                |
| ⑥ O-ring B                        | ㉑ BPT holder bracket |
| ⑦ Fuel injector                   | ㉒ Back pressure hose |
| ⑧ Insulator                       | ㉓ EGR vacuum hose A  |
| ⑨ Fuel injector cap               | ㉔ EGR vacuum pipe    |
| ⑩ Gasket                          | ㉕ EGR vacuum hose C  |
| ⑪ Engine coolant hose B           | ㉖ EGR valve          |
| ⑫ Air by-pass hose                | ㉗ Gasket             |
| ⑬ Idle air control solenoid valve | ㉘ EGR vacuum hose B  |
| ⑭ Engine coolant hose A           |                      |

- |                      |
|----------------------|
| ㉚ EGR solenoid valve |
| ⑳ EGR pipe           |
| ㉛ Intake manifold    |

**Tightening torque: N·m (kg·m, ft·lb)**

- T1: 3.4±0.5 (0.35±0.05, 2.5±0.4)  
 T2: 6.4±0.5 (0.65±0.05, 4.7±0.4)  
 T3: 16±1.5 (1.6±0.15, 11.6±1.1)  
 T4: 19±1 (1.9±0.1, 13.7±0.7)  
 T5: 19±1.5 (1.9±0.15, 13.7±1.1)  
 T6: 23±3 (2.3±0.3, 16.6±2.2)  
 T7: 25±2 (2.5±0.2, 18.1±1.4)  
 T8: 34±2 (3.5±0.2, 25.3±1.4)