

2. Power Steering System

1. LHD MODEL

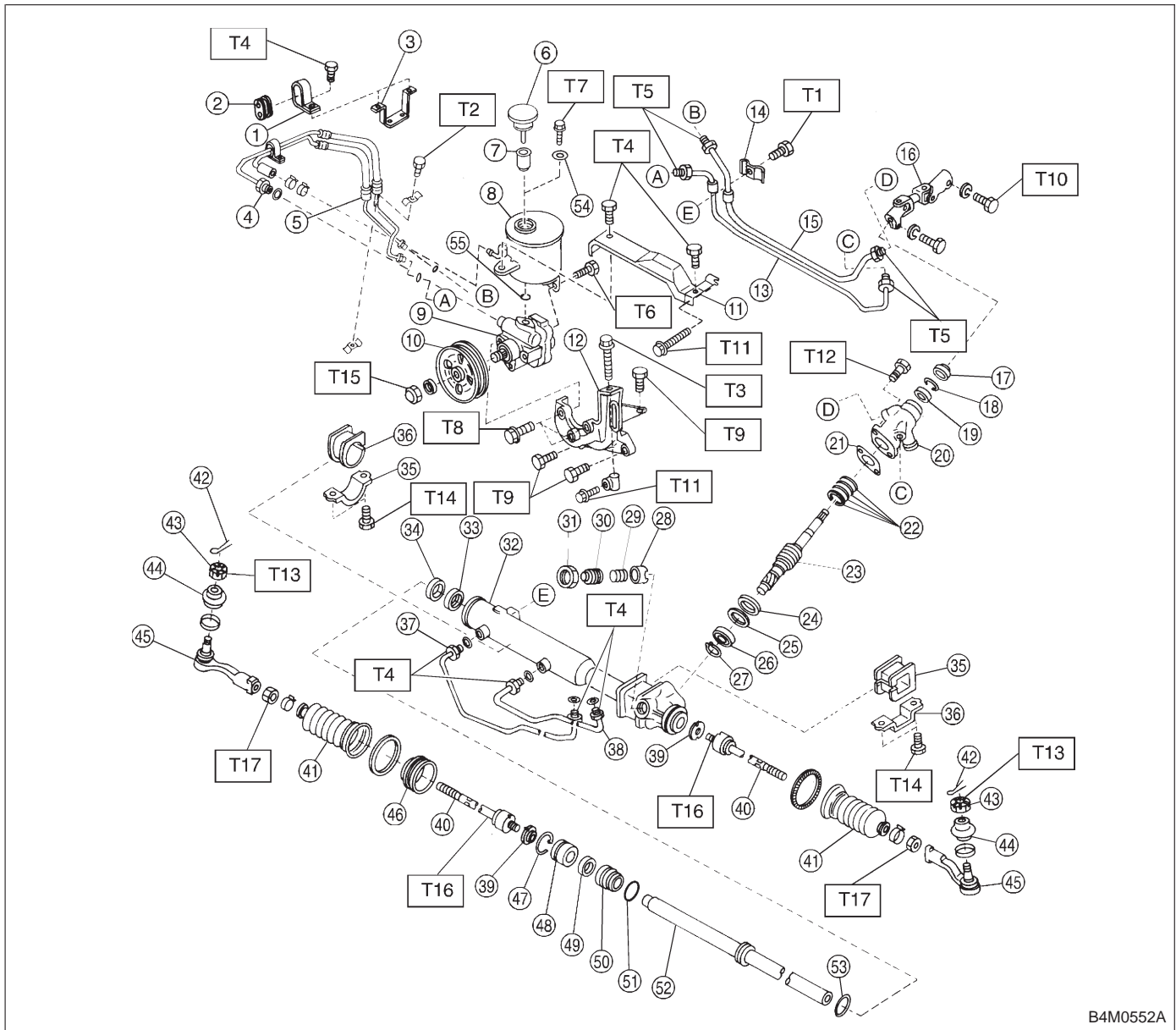

B4M0552A

Tightening torque: N·m (kg·m, ft·lb)

- T1: 5.4±1.5 (0.55±0.15, 4.0±1.1)
- T2: 7.4±2.0 (0.75±0.20, 5.4±1.4)
- T3: 8±2 (0.8±0.2, 5.8±1.4)
- T4: 13±3 (1.3±0.3, 9.4±2.2)
- T5: 15±5 (1.5±0.5, 10.8±3.6)
- T6: 15.7±2.4 (1.60±0.24, 11.58±1.77)
- T7: 18.1±2.5 (1.85±0.25, 13.35±1.84)
- T8: 20.1±2.5 (2.05±0.25, 14.8±1.8)
- T9: 22±2 (2.2±0.2, 15.9±1.4)

- T10: 24±3 (2.4±0.3, 17.4±2.2)
- T11: 24.5±2.0 (2.50±0.2, 18.07±1.48)
- T12: 25±5 (2.5±0.5, 18.1±3.6)
- T13: 27.0±2.5 (2.75±0.25, 19.92±1.84)
- T14: 59±12 (6.0±1.2, 43±9)
- T15: 60.8±6.9 (6.2±0.7, 44.8±5.1)
- T16: 78±10 (8.0±1.0, 58±7)
- T17: 83±5 (8.5±0.5, 61.5±3.6)

2. Power Steering System

- | | |
|-------------------------|--------------------|
| ① Clamp | ②⑨ Spring |
| ② Adapter | ③⑩ Adjusting screw |
| ③ Hose bracket | ④⑪ Lock nut |
| ④ Pipe C | ⑤⑫ Housing ASSY |
| ⑤ Pipe D | ⑥⑬ Back-up washer |
| ⑥ Cap | ⑦⑭ Oil seal |
| ⑦ Strainer | ⑧⑮ Adapter |
| ⑧ Tank | ⑨⑯ Clamp |
| ⑨ Oil pump | ⑩⑰ Pipe A |
| ⑩ Pulley | ⑪⑱ Pipe B |
| ⑪ Belt cover | ⑫⑲ Lock washer |
| ⑫ Bracket | ⑬⑳ Tie-rod |
| ⑬ Pipe E | ⑭㉑ Boot |
| ⑭ Clamp plate | ⑮㉒ Cotter pin |
| ⑮ Pipe F | ⑯㉓ Castle nut |
| ⑯ Universal joint | ⑰㉔ Dust seal |
| ⑰ Dust seal | ⑱㉕ Tie-rod end |
| ⑱ C-ring | ㉖㉑ Spacer |
| ⑲ Oil seal | ㉗㉒ Circlip |
| ⑳ Valve housing | ㉘㉓ Rack stopper |
| ㉑ Packing | ㉙㉔ Oil seal |
| ㉒ Seal ring | ㉚㉕ Rack bushing |
| ㉓ Pinion and valve ASSY | ㉛㉖ O-ring |
| ㉔ Oil seal | ㉜㉑ Rack |
| ㉕ Back-up washer | ㉝㉒ Piston ring |
| ㉖ Ball bearing | ㉞㉓ Seal washer |
| ㉗ Snap ring | ㉟㉔ O-ring |
| ㉘ Sleeve | |

2. RHD MODEL

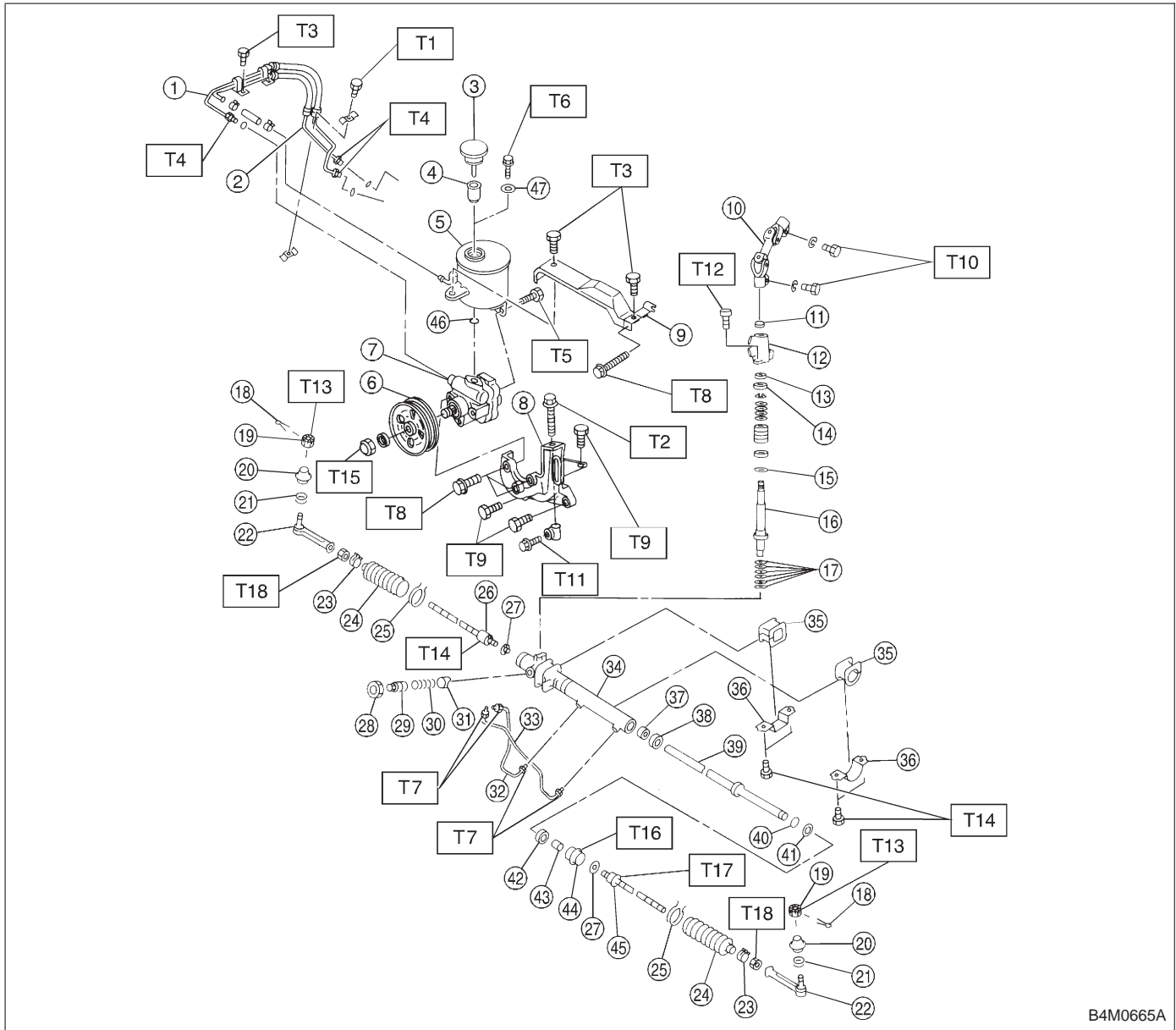

B4M0665A

Tightening torque: N·m (kg·m, ft·lb)

- T1: 7.4±2.0 (0.75±0.2, 5.4±1.4)
- T2: 8±2 (0.8±0.2, 5.8±1.4)
- T3: 13±3 (1.3±0.3, 9.4±2.2)
- T4: 15±5 (1.5±0.5, 10.8±3.6)
- T5: 15.7±2.4 (1.60±0.24, 11.58±1.77)
- T6: 18.1±2.5 (1.85±0.26, 13.35±1.84)
- T7: 20±4 (2.0±0.4, 14±2.9)
- T8: 20.1±2.5 (2.05±0.25, 14.8±1.8)
- T9: 22±2 (2.2±0.2, 15.9±1.4)
- T10: 24±3 (2.4±0.3, 17.4±2.2)
- T11: 24.5±2.0 (2.50±0.20, 18.07±1.48)
- T12: 25±5 (2.5±0.5, 18.1±3.6)
- T13: 27.0±2.5 (2.75±0.26, 19.92±1.84)
- T14: 59±12 (6.0±1.2, 43±9)
- T15: 61±7 (6.2±0.7, 44.8±5.1)
- T16: 64±10 (6.5±1.0, 47±7)
- T17: 78±10 (8.0±1.0, 58±7)
- T18: 83±5 (8.5±0.5, 61.5±3.6)

2. Power Steering System

- | | |
|-------------------|--------------------|
| ① Pipe C | ②⑤ Wire |
| ② Pipe D | ②⑥ Tie-rod RH |
| ③ Cap | ②⑦ Lock washer |
| ④ Strainer | ②⑧ Lock nut |
| ⑤ Tank | ②⑨ Adjusting screw |
| ⑥ Pulley | ②⑩ Spring |
| ⑦ Oil pump | ②⑪ Sleeve |
| ⑧ Bracket | ②⑫ Pipe B |
| ⑨ Belt cover | ②⑬ Pipe A |
| ⑩ Universal joint | ②⑭ Housing ASSY |
| ⑪ Dust cover | ②⑮ Adapter |
| ⑫ Valve housing | ②⑯ Clamp |
| ⑬ Y-packing | ②⑰ Back-up washer |
| ⑭ Ball bearing | ②⑱ Oil seal |
| ⑮ Spacer | ②⑲ Rack |
| ⑯ Pinion | ②⑳ O-ring |
| ⑰ Shim | ②㉑ Oil seal |
| ⑱ Cotter pin | ②㉒ Y-packing |
| ⑲ Castle nut | ②㉓ Bush |
| ⑳ Dust seal | ②㉔ Holder |
| ㉑ Clip | ②㉕ Tie-rod LH |
| ㉒ Tie-rod end | ②㉖ O-ring |
| ㉓ Clip | ②㉗ Seal washer |
| ㉔ Boot | |