

2) Install center exhaust pipe to front catalytic converter.

**Tightening torque:**

**$35\pm 5$  N·m ( $3.6\pm 0.5$  kg-m,  $26.0\pm 3.6$  ft-lb)**

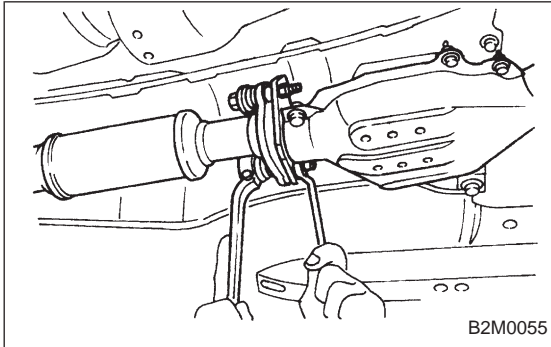

3) Install center exhaust pipe to rear exhaust pipe.

**Tightening torque:**

**$18\pm 5$  N·m ( $1.8\pm 0.5$  kg-m,  $13.0\pm 3.6$  ft-lb)**

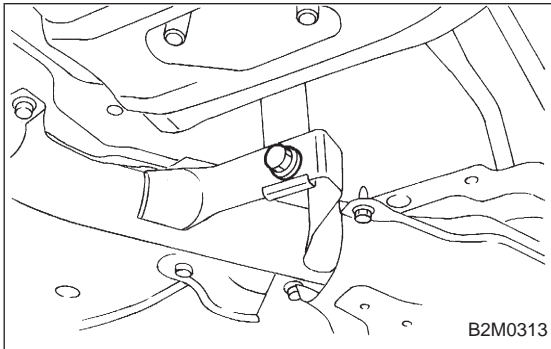

4) Tighten bolt which holds center exhaust pipe to hanger bracket.

**Tightening torque:**

**$35\pm 5$  N·m ( $3.6\pm 0.5$  kg-m,  $26.0\pm 3.6$  ft-lb)**

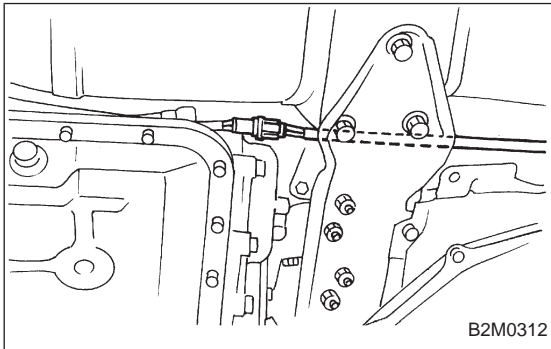

5) Connect rear oxygen sensor connector. (Except California 2200 cc model)

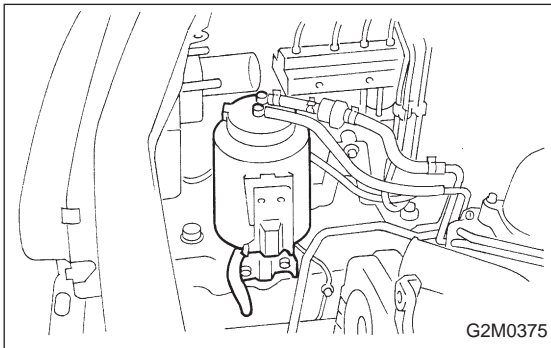

### 3. Canister

#### A: REMOVAL AND INSTALLATION

##### 1. 2200 cc FWD AND 2500 cc MODEL

- 1) Disconnect canister hoses from evaporation pipes.
- 2) Remove canister with bracket.

3) Installation is in the reverse order of removal.

**CAUTION:**

**Insert air vent hose of canister into the hole on body.**

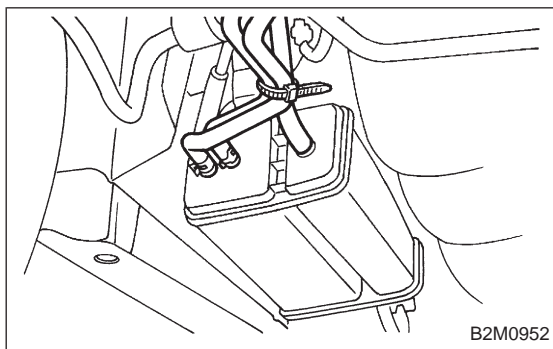

**2. 2200 cc AWD MODEL**

- 1) Lift-up the vehicle.
- 2) Disconnect evaporation hoses from canister.

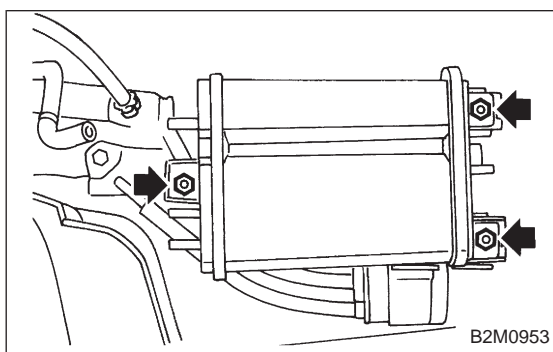

- 3) Remove canister from body.
- 4) Installation is in the reverse order of removal.

**Tightening torque:**

***25±7 N·m (2.5±0.7 kg-m, 18.1±5.1 ft-lb)***

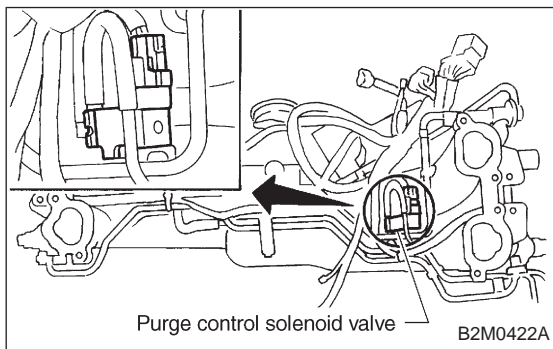

**4. Purge Control Solenoid Valve**

**A: REMOVAL AND INSTALLATION**

- 1) Remove bolt which installs purge control solenoid valve onto intake manifold.

**NOTE:**

This figure shows the rear side of intake manifold.

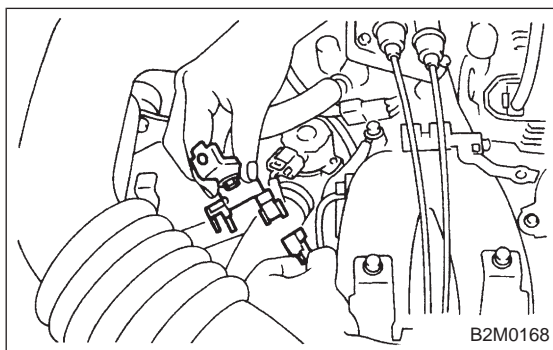

- 2) Take out purge control solenoid valve through the bottom of the intake manifold.
- 3) Disconnect connector and hoses from purge control solenoid valve.