

1. Front Hood and Hood Lock

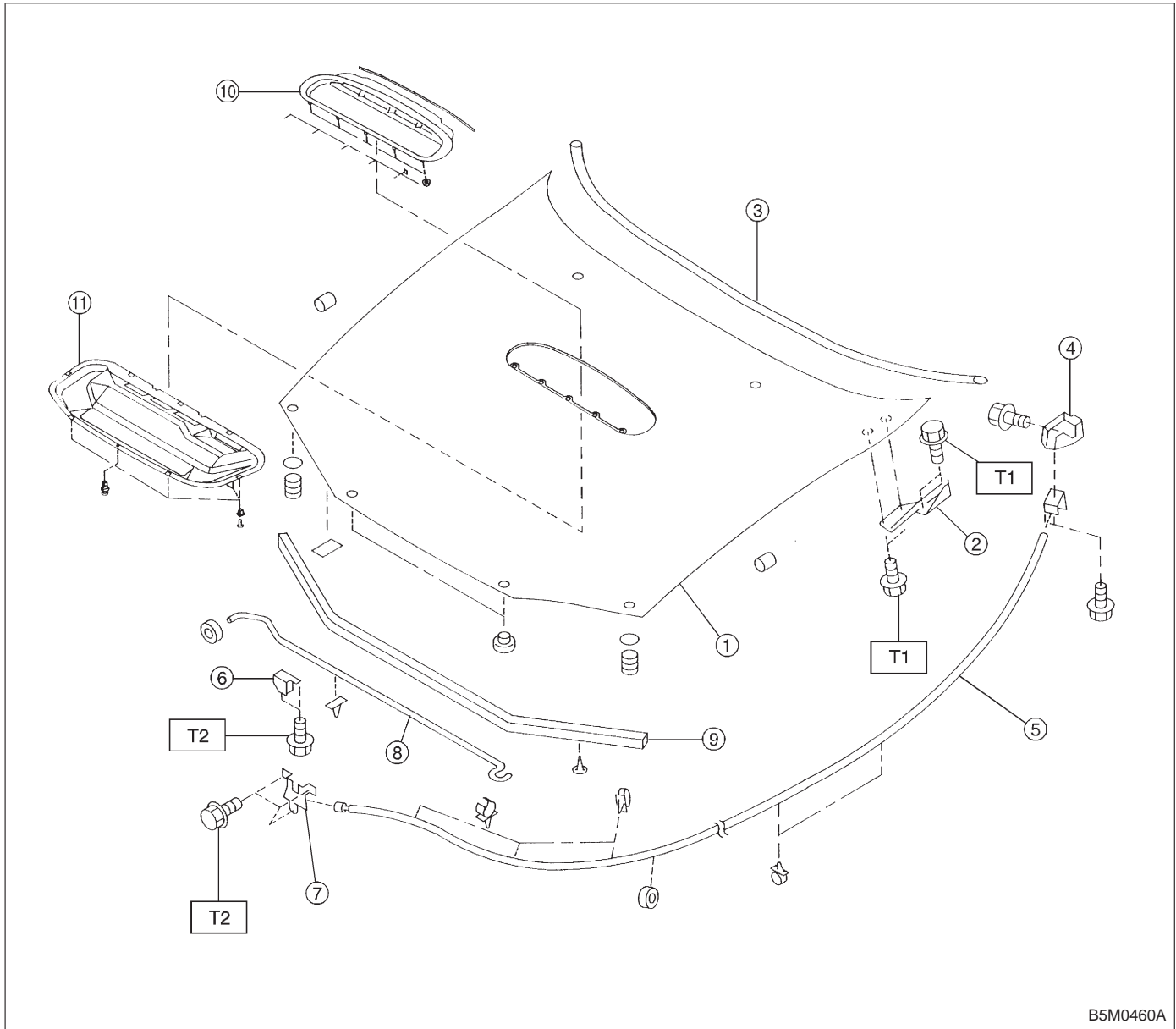

- | | |
|-------------------|-------------------------------------|
| ① Front hood | ⑧ Front hood stay |
| ② Hinge (RH, LH) | ⑨ Front hood seal CTR |
| ③ Front hood seal | ⑩ Hood duct (Outback and GT model) |
| ④ Lever ASSY | ⑪ Hood inner (Outback and GT model) |
| ⑤ Cable | |
| ⑥ Striker | |
| ⑦ Hood lock ASSY | |

Tightening torque: N·m (kg·m, ft·lb)

T1: 14±9 (1.4±0.9, 10.1±6.5)

T2: 32±1 (3.3±0.1, 23.9±0.7)