

7. EGR Solenoid Valve

A: REMOVAL AND INSTALLATION

1. 2200 cc MODEL

- 1) Disconnect connector from EGR solenoid valve.
- 2) Disconnect vacuum hoses from EGR solenoid valve.
- 3) Remove bolt which installs EGR solenoid valve.
- 4) Take out EGR solenoid valve.
- 5) Installation is in the reverse order of removal.

Tightening torque:

$16 \pm 1.5 \text{ N}\cdot\text{m}$ ($1.6 \pm 0.15 \text{ kg}\cdot\text{m}$, $11.6 \pm 1.1 \text{ ft}\cdot\text{lb}$)

2. 2500 cc MODEL

- 1) Remove bolt which installs EGR solenoid valve onto intake manifold.
- 2) Take out EGR solenoid valve.
- 3) Disconnect connector from EGR solenoid valve.
- 4) Disconnect vacuum hoses from EGR solenoid valve.
- 5) Remove EGR solenoid valve.

NOTE:

This figure shows the under side of intake manifold.

- 6) Installation is in the reverse order of removal.

Tightening torque:

$16 \pm 1.5 \text{ N}\cdot\text{m}$ ($1.6 \pm 0.15 \text{ kg}\cdot\text{m}$, $11.6 \pm 1.1 \text{ ft}\cdot\text{lb}$)

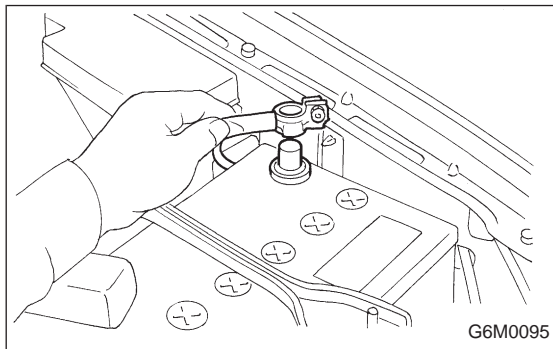

8. Fuel Temperature Sensor (2200 cc AWD Model)

A: REMOVAL

- 1) Disconnect battery ground cable.

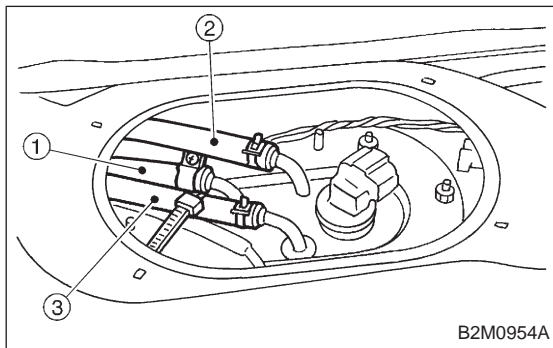

- 2) Release fuel pressure. <Ref. to 2-8 [W1A0].>

- 3) Disconnect fuel delivery hose ①, return hose ② and jet pump hose ③.