

- 2) Detach floor mat of front passenger seat.
- 3) Remove protect cover.

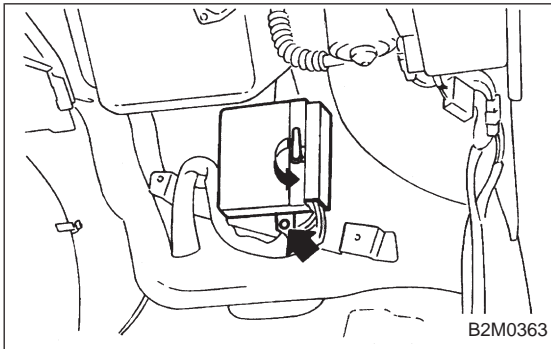

- 4) Release the lock of ECM connector and disconnect it.
- 5) Remove nuts which install ECM onto body.
- 6) Take out ECM.

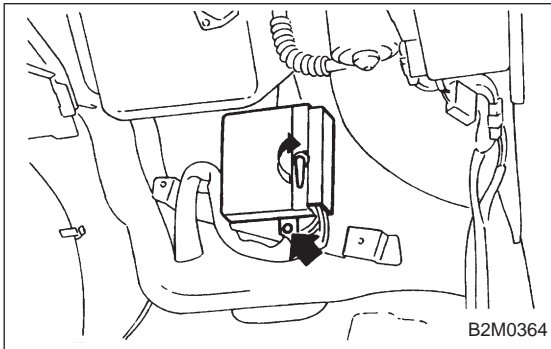

- 7) Connect ECM connector and lock it.
- 8) Installation is in the reverse order of removal.

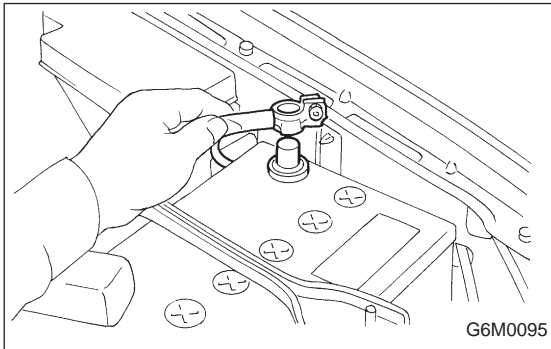

## 16. Main Relay

### A: REMOVAL AND INSTALLATION

- 1) Disconnect battery ground cable.

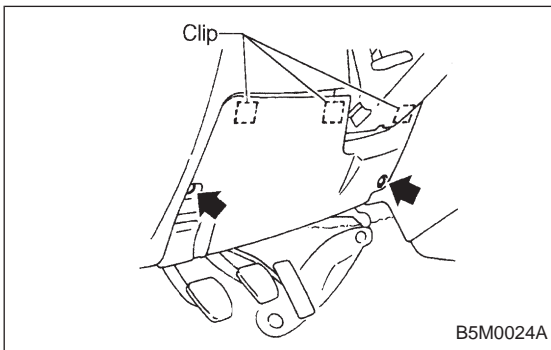

- 2) Remove lower cover and then disconnect connectors.
- 3) Lower transmission control module.
- 4) Remove the front pillar lower trim.  
<Ref. to 5-3 [W5A1].>
- 5) Remove fuse box mounting nuts.
- 6) Lower fuse box.
- 7) Remove fuse box mounting bracket.

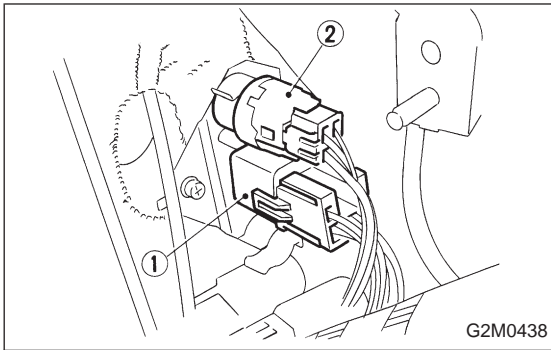

- 8) Remove screw which retains bracket of main relay ① and fuel pump relay ②.
- 9) Disconnect connector from main relay.

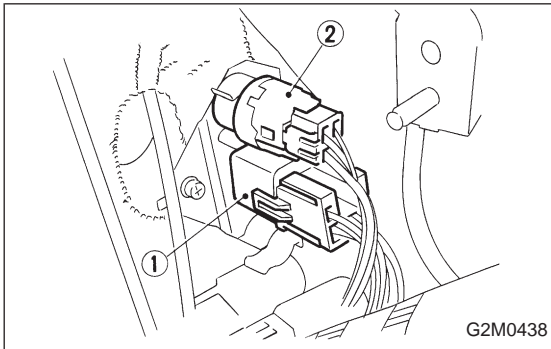

- 10) Installation is in the reverse order of removal.
- ① Main relay
  - ② Fuel pump relay

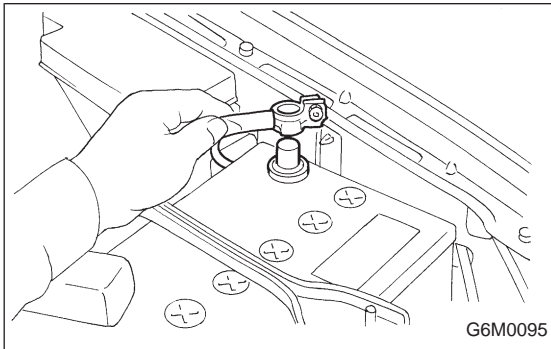

## 17. Fuel Pump Relay

### A: REMOVAL AND INSTALLATION

- 1) Disconnect battery ground cable.

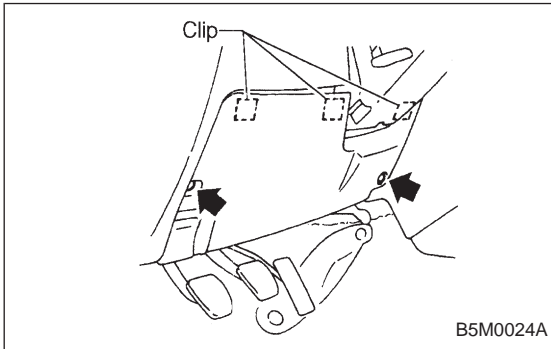

- 2) Remove lower cover and then disconnect connectors.
- 3) Lower transmission control module.
- 4) Remove the front pillar lower trim.  
<Ref. to 5-3 [W5A1].>
- 5) Remove fuse box mounting nuts.
- 6) Lower fuse box.
- 7) Remove fuse box mounting bracket.

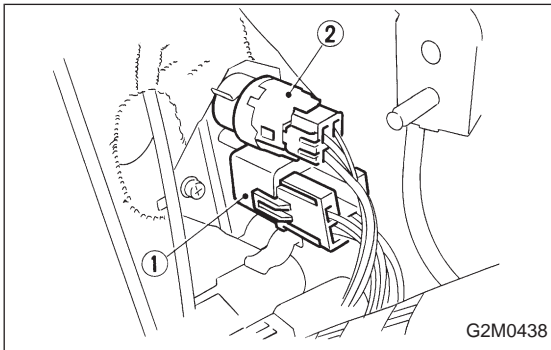

- 8) Remove fuel pump relay from main relay and fuel pump relay mounting bracket.
- 9) Disconnect connector from fuel pump relay.