

2. Power Steering System

1. LHD MODEL

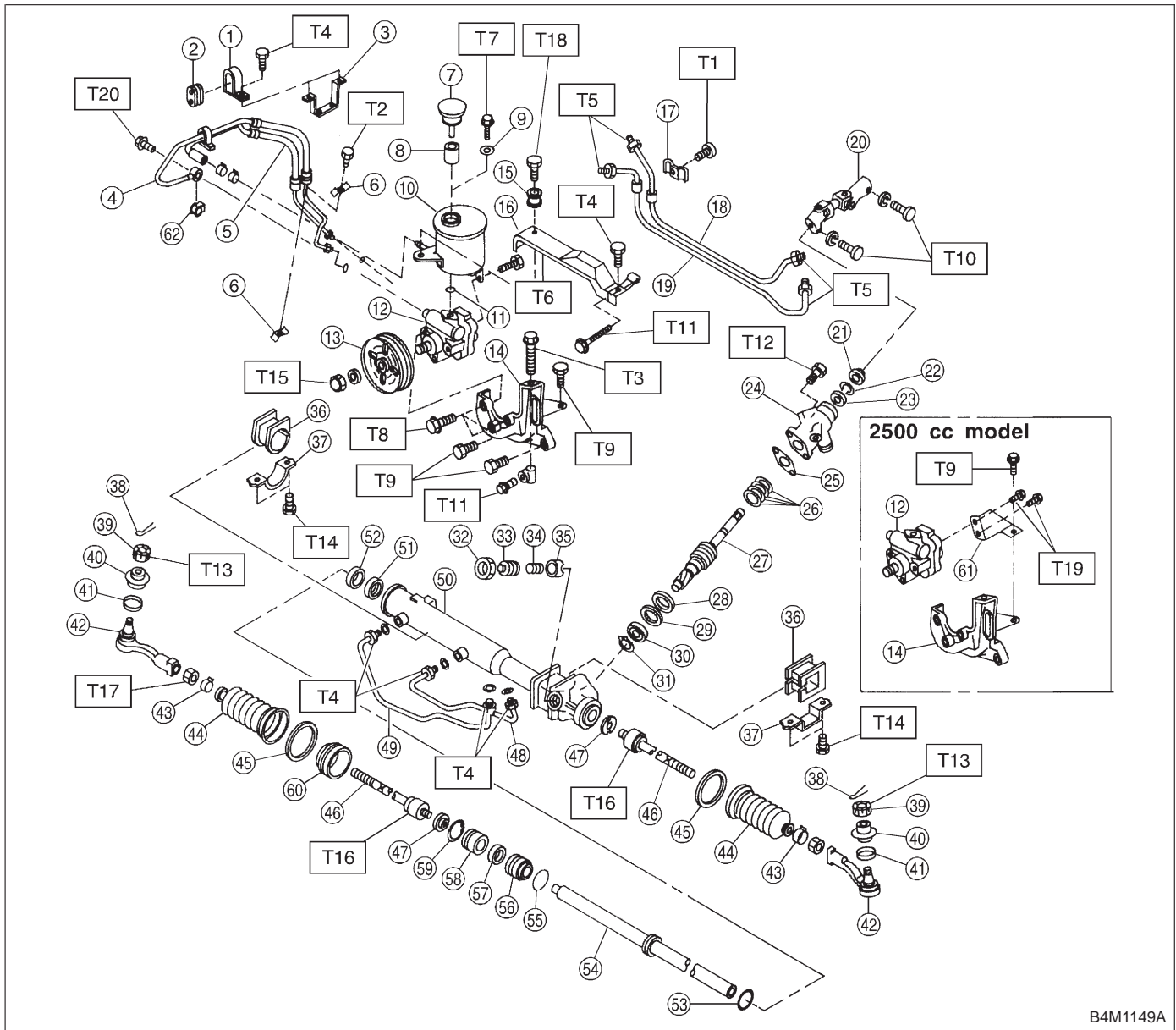

B4M1149A

Tightening torque: N·m (kg·m, ft·lb)

- T1: 5.4±1.5 (0.55±0.15, 4.0±1.1)
- T2: 7.4±2.0 (0.75±0.20, 5.4±1.4)
- T3: 8±2 (0.8±0.2, 5.8±1.4)
- T4: 13±3 (1.3±0.3, 9.4±2.2)
- T5: 15±5 (1.5±0.5, 10.8±3.6)
- T6: 15.7±2.4 (1.60±0.24, 11.58±1.77)
- T7: 18.1±2.5 (1.85±0.25, 13.35±1.84)
- T8: 20.1±2.5 (2.05±0.25, 14.8±1.8)
- T9: 22±2 (2.2±0.2, 15.9±1.4)

- T10: 24±3 (2.4±0.3, 17.4±2.2)
- T11: 24.5±2.0 (2.50±0.2, 18.07±1.48)
- T12: 25±5 (2.5±0.5, 18.1±3.6)
- T13: 27.0±2.5 (2.75±0.25, 19.92±1.84)
- T14: 59±12 (6.0±1.2, 43±9)
- T15: 60.8±6.9 (6.2±0.7, 44.8±5.1)
- T16: 78±10 (8.0±1.0, 58±7)
- T17: 83±5 (8.5±0.5, 61.5±3.6)
- T18: 6.35±1.0 (0.65±0.1, 4.7±0.7)
- T19: 15.7±2.5 (1.6±0.25, 11.6±1.8)
- T20: 34±5 (3.5±0.5, 25.3±3.6)

2. Power Steering System

- | | |
|-------------------------|------------------------------|
| ① Clamp | ③② Lock nut |
| ② Adapter | ③③ Adjusting screw |
| ③ Hose bracket | ③④ Spring |
| ④ Pipe C | ③⑤ Sleeve |
| ⑤ Pipe D | ③⑥ Adapter |
| ⑥ Clamp E | ③⑦ Clamp |
| ⑦ Cap | ③⑧ Cotter pin |
| ⑧ Strainer | ③⑨ Castle nut |
| ⑨ Seal washer | ④① Dust seal |
| ⑩ Tank | ④② Clip |
| ⑪ O-ring | ④③ Tie-rod end |
| ⑫ Oil pump | ④④ Small clip |
| ⑬ Pulley | ④⑤ Boot |
| ⑭ Bracket | ④⑥ Large clip |
| ⑮ Bush | ④⑦ Tie-rod |
| ⑯ Belt cover | ④⑧ Lock washer |
| ⑰ Clamp plate | ④⑨ Pipe B |
| ⑱ Pipe F | ④⑩ Pipe A |
| ⑲ Pipe E | ⑤① Housing ASSY |
| ⑳ Universal joint | ⑤② Back-up washer |
| ㉑ Dust seal | ⑤③ Oil seal |
| ㉒ C-ring | ⑤④ Piston ring |
| ㉓ Oil seal | ⑤⑤ Rack |
| ㉔ Valve housing | ⑤⑥ O-ring |
| ㉕ Packing | ⑤⑦ Rack bushing |
| ㉖ Seal ring | ⑤⑧ Oil seal |
| ㉗ Pinion and valve ASSY | ⑤⑨ Rack stopper |
| ㉘ Oil seal | ⑤⑩ Circlip |
| ㉙ Back-up washer | ⑥① Spacer |
| ㉚ Ball bearing | ⑥② Stay (2500 cc model only) |
| ㉛ Snap ring | ⑥③ Gasket |

2. RHD MODEL

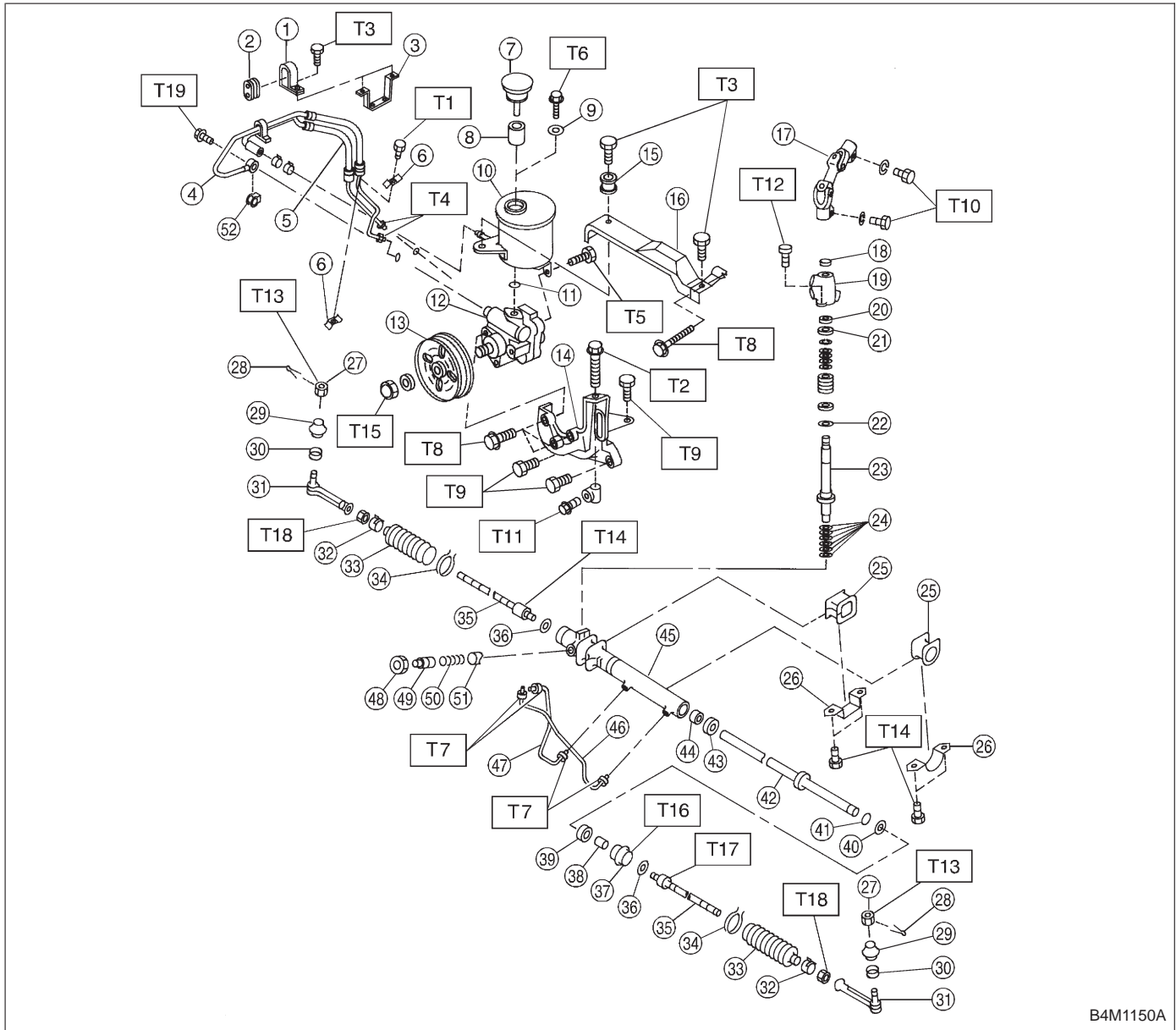

B4M1150A

Tightening torque: N-m (kg-m, ft-lb)

- T1: 7.4±2.0 (0.75±0.2, 5.4±1.4)
- T2: 8±2 (0.8±0.2, 5.8±1.4)
- T3: 13±3 (1.3±0.3, 9.4±2.2)
- T4: 15±5 (1.5±0.5, 10.8±3.6)
- T5: 15.7±2.4 (1.60±0.24, 11.58±1.77)
- T6: 18.1±2.5 (1.85±0.26, 13.35±1.84)
- T7: 20±4 (2.0±0.4, 14±2.9)
- T8: 20.1±2.5 (2.05±0.25, 14.8±1.8)
- T9: 22±2 (2.2±0.2, 15.9±1.4)

- T10: 24±3 (2.4±0.3, 17.4±2.2)
- T11: 24.5±2.0 (2.50±0.20, 18.07±1.48)
- T12: 25±5 (2.5±0.5, 18.1±3.6)
- T13: 27.0±2.5 (2.75±0.26, 19.92±1.84)
- T14: 59±12 (6.0±1.2, 43±9)
- T15: 61±7 (6.2±0.7, 44.8±5.1)
- T16: 64±10 (6.5±1.0, 47±7)
- T17: 78±10 (8.0±1.0, 58±7)
- T18: 83±5 (8.5±0.5, 61.5±3.6)
- T19: 34±5 (3.5±0.5, 25.3±3.6)

2. Power Steering System

- | | | | |
|---|-----------------|----|-----------------|
| ① | Clamp | ②7 | Castle nut |
| ② | Adapter | ②8 | Cotter pin |
| ③ | Hose bracket | ②9 | Dust seal |
| ④ | Pipe C | ③0 | Clip |
| ⑤ | Pipe D | ③1 | Tie-rod end |
| ⑥ | Clamp E | ③2 | Clip |
| ⑦ | Cap | ③3 | Boot |
| ⑧ | Strainer | ③4 | Wire |
| ⑨ | Seal washer | ③5 | Tie-rod |
| ⑩ | Tank | ③6 | Lock washer |
| ⑪ | O-ring | ③7 | Holder |
| ⑫ | Oil pump | ③8 | Bush |
| ⑬ | Pulley | ③9 | Y-packing |
| ⑭ | Bracket | ④0 | Oil seal |
| ⑮ | Bush | ④1 | O-ring |
| ⑯ | Belt cover | ④2 | Rack |
| ⑰ | Universal joint | ④3 | Oil seal |
| ⑱ | Dust cover | ④4 | Back-up washer |
| ⑲ | Valve housing | ④5 | Housing ASSY |
| ⑳ | Y-packing | ④6 | Pipe A |
| ㉑ | Ball bearing | ④7 | Pipe B |
| ㉒ | Spacer | ④8 | Lock nut |
| ㉓ | Pinion | ④9 | Adjusting screw |
| ㉔ | Shim | ⑤0 | Spring |
| ㉕ | Adapter | ⑤1 | Sleeve |
| ㉖ | Clamp | ⑤2 | Gasket |